

RECEIVED

JAN 14 2004

Form C-1
December 2002

For KCC Use: 1-21-04
Effective Date: _____
District # _____
SGA? Yes No

KANSAS CORPORATION COMMISSION
OIL & GAS CONSERVATION DIVISION
NOTICE OF INTENT TO DRILL

KCC WICHITA
Form must be Typed
Form must be Signed
All blanks must be Filled

Must be approved by KCC five (5) days prior to commencing well

Ap 50' wof

Expected Spud Date 2/11/04
month day year

Spot SW SE NE Sec. 6 Twp. 30 S. R. 11 East West
2970 feet from N / S Line of Section
1040 feet from E / W Line of Section

OPERATOR: License# 32192
Name: Pride Energy Company
Address: PO Box 701950
City/State/Zip: Tulsa OK 74170-1950
Contact Person: John W. Pride
Phone: 9185249200

Is SECTION Regular Irregular?

(Note: Locate well on the Section Plat on reverse side)

CONTRACTOR: License# 5123
Name: Pickrell Drilling Company, Inc.

County: Barber
Lease Name: McGuire Well #: 2-6

Field Name: Harding pe KGS
Is this a Prorated / Spaced Field? Yes No
Target Formation(s): Douglas, Burlingame, Indian Cave, Red Eagle

Well Drilled For: Oil Enh Rec Infield Mud Rotary
 Gas Storage Pool Ext. Air Rotary
 OWWO Disposal Wildcat Cable
 Seismic; # of Holes Other
 Other

Nearest Lease or unit boundary: 330' South
Ground Surface Elevation: Est. 1847' feet MSL

Water well within one-quarter mile: Yes No
Public water supply well within one mile: Isabel? Yes No

Depth to bottom of fresh water: 180
Depth to bottom of usable water: 200 220

Surface Pipe by Alternate: 1 2
Length of Surface Pipe Planned to be set: 300

If OWWO: old well information as follows:
Operator: _____
Well Name: _____
Original Completion Date: _____ Original Total Depth: _____

Length of Conductor Pipe required: None
Projected Total Depth: 3950

Directional, Deviated or Horizontal wellbore? Yes No

Formation at Total Depth: Douglas
Water Source for Drilling Operations:
 Well Farm Pond Other

If Yes, true vertical depth: _____
Bottom Hole Location: _____
KCC DKT #: _____

DWR Permit #: Drilling Contractor applying for
(Note: Apply for Permit with DWR)

Will Cores be taken? Yes No
If Yes, proposed zone: _____

AFFIDAVIT

The undersigned hereby affirms that the drilling, completion and eventual plugging of this well will comply with K.S.A. 55 et. seq.
It is agreed that the following minimum requirements will be met:

- 1. Notify the appropriate district office **prior** to spudding of well;
- 2. A copy of the approved notice of intent to drill **shall be** posted on each drilling rig;
- 3. The minimum amount of surface pipe as specified below **shall be set** by circulating cement to the top; in all cases surface pipe **shall be set** through all unconsolidated materials plus a minimum of 20 feet into the underlying formation.
- 4. If the well is dry hole, an agreement between the operator and the district office on plug length and placement is necessary **prior to plugging**;
- 5. The appropriate district office will be notified before well is either plugged or production casing is cemented in;
- 6. If an ALTERNATE II COMPLETION, production pipe shall be cemented from below any usable water to surface within **120 days** of spud date. Or pursuant to Appendix "B" - Eastern Kansas surface casing order #133,891-C, which applies to the KCC District 3 area, alternate II cementing must be completed within 30 days of the spud date or the well shall be plugged. **In all cases, NOTIFY district office** prior to any cementing.

I hereby certify that the statements made herein are true and to the best of my knowledge and belief.
Date: 1/12/04 Signature of Operator or Agent: John W. Pride Title: Pres. of Pride Oil & Gas Co., Inc., as General Partner of Pride Energy Company

For KCC Use ONLY
API # 15 - 007-22793-00-00
Conductor pipe required NONE feet
Minimum surface pipe required 240 feet per Alt. (1)
Approved by: RJP 1-16-04
This authorization expires: 7-16-04
(This authorization void if drilling not started within 6 months of effective date.)
Spud date: _____ Agent: _____

Remember to:
- File Drill Pit Application (form CDP-1) with Intent to Drill;
- File Completion Form ACO-1 within 120 days of spud date;
- File acreage attribution plat according to field proration orders;
- Notify appropriate district office 48 hours prior to workover or re-entry;
- Submit plugging report (CP-4) after plugging is completed;
- Obtain written approval before disposing or injecting salt water.
- If this permit has expired (See: authorized expiration date) please check the box below and return to the address below.
 Well Not Drilled - Permit Expired
Signature of Operator or Agent: _____
Date: _____

Mail to: KCC - Conservation Division, 130 S. Market - Room 2078, Wichita, Kansas 67202

jp3529.hq

6
30
113

RECEIVED

JAN 14 2004

KCC WICHITA

IN ALL CASES PLOT THE INTENDED WELL ON THE PLAT BELOW

Plat of acreage attributable to a well in a prorated or spaced field

If the intended well is in a prorated or spaced field, please fully complete this side of the form. If the intended well is in a prorated or spaced field complete the plat below showing that the well will be properly located in relationship to other wells producing from the common source of supply. Please show all the wells and within 1 mile of the boundaries of the proposed acreage attribution unit for gas wells and within 1/2 mile of the boundaries of the proposed acreage attribution unit for oil wells.

API No. 15 - _____
Operator: Pride Energy Company
Lease: McGuire
Well Number: 2-6
Field: Harding

Location of Well: County: Barber
2970 feet from [] N / [x] S Line of Section
1040 feet from [x] E / [] W Line of Section
Sec. 6 Twp. 30 S. R. 11 [] East [x] West

Number of Acres attributable to well: _____
QTR / QTR / QTR of acreage: SW - SE - NE

Is Section: [x] Regular or [] Irregular

If Section is Irregular, locate well from nearest corner boundary.

Section corner used: [] NE [] NW [] SE [] SW

PLAT

(Show location of the well and shade attributable acreage for prorated or spaced wells.)

(Show footage to the nearest lease or unit boundary line.)

Section 6

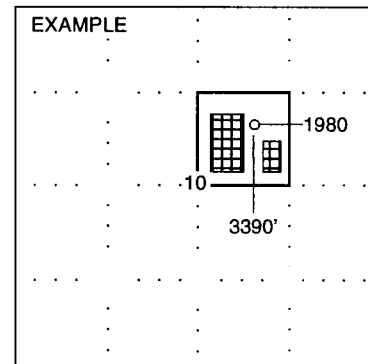
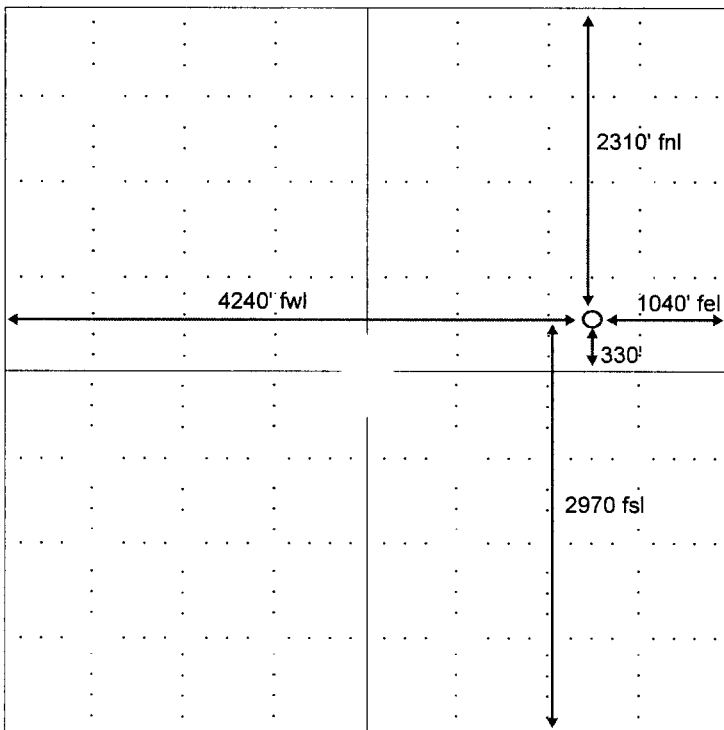

NOTE: In all cases locate the spot of the proposed drilling locaton.

330' from North to nearest unit boundary line

In plotting the proposed location of the well, you must show:

- 1. The manner in which you are using the depicted plat by identifying section lines, i.e. 1 section, 1 section with 8 surrounding sections, 4 sections, etc.
2. The distance of the proposed drilling location from the section's south / north and east / west.
3. The distance to the nearest lease or unit boundary line.
4. If proposed location is located within a prorated or spaced field a certificate of acreage attribution plat must be attached: (CO-7 for oil wells; CG-8 for gas wells).



KANSAS

CORPORATION COMMISSION

KATHLEEN SEBELIUS, GOVERNOR
BRIAN J. MOLINE, CHAIR
JOHN WINE, COMMISSIONER
ROBERT E. KREHBIEL, COMMISSIONER

January 16, 2004

John W Pride
Pride Energy Company
PO Box 701950
Tulsa OK 74170-1950

Re: Drilling Pit Application
McGuire Lease Well No. 2-6
NE/4 06-30S-11W
Barber County, Kansas

Dear Mr. Pride:

District staff has inspected the above referenced location and has determined that the reserve pit shall be constructed **without slots**, the bottom shall be flat and reasonably level and the free fluids must be removed. The fluids are to be removed from the reserve pit as soon as the Hutchinson Salt section has been drilled through and displacement of the fluids into the reserve pit has occurred. The fluids should be removed again as soon as practical after drilling operations have ceased.

If production casing is set all completion fluids shall be removed on a daily basis.

The fluids should be taken to an authorized disposal well. Please call the District Office at (620) 225-8888 when the fluids have been removed. Also, please file the enclosed Surface Pond Waste Transfer, form CDP-5, within 30 days of fluid removal.

A copy of this letter should be posted in the doghouse along with the approved Intent to Drill. If you have any questions or concerns please feel free to contact the undersigned at the above address.

Sincerely,



Jonelle Rains, Supervisor
Department of Environmental Protection and Remediation

cc: Steve Durrant
File