

FOR KCC USE: 11-12-03

Effective Date: 11-12-03

District #: 1

SGA? Yes No

KANSAS CORPORATION COMMISSION

OIL & GAS CONSERVATION DIVISION

NOTICE OF INTENT TO DRILL

Must be approved by the K.C.C. five (5) days prior to commencing well.

RECEIVED

NOV 03 2003

KCC WICHITA

FORM C-1

September 1999

Form must be Typed

Form must be Signed

All blanks must be Filled

Expected Spud Date 12 1 2003
month day year

OPERATOR:

License # 32198
Name: PetroSantander (USA) Inc.
Address: 6363 Woodway, Ste. 350
City/State/Zip: Houston, TX 77057
Contact Person: Jason Sizemore
Phone: (713) 784-8700

CONTRACTOR:

License # 5382
Name: Cheyenne Drilling

Well Drilled For: Oil Gas OWWO Seismic; Other
Well Class: Enh Rec Storage Disposal # of Holes Other
Type Equipment: Infield Pool Ext. Wildcat Other
 Mud Rotary Air Rotary Cable

If OWWO: old well information as follows:
Operator: _____
Well Name: _____
Original Completion Date: _____ Original Total Depth: _____

Directional, Deviated or Horizontal wellbore? Yes No

If Yes, true vertical depth: _____
Bottom Hole Location: _____
KCC DKT #: _____

Spot 1065' W and 2' S of C of Section East

NW - NE - SW Sec. 36 Twp. 32S R. 30 West
2640 feet from S N (circle one) line of Section
1575 feet from W E (circle one) line of Section

IS SECTION REGULAR IRREGULAR?
Note: Locate well on the Section Plat on reverse side)

County: Meade
Lease Name: Stevens (Morrow) Unit Well #: 3606
Field Name: Stevens

Is this a Prorated/Spaced Field? Yes No

Target Formation(s): Morrow
Nearest Lease or unit boundary: 1065'
Ground Surface Elevation: 2708' feet MSL

Water well within one-quarter mile: Yes No

Public water supply well within one mile: Yes No

Depth to bottom of fresh water: ~460 feet

Depth to bottom of usable water: 570 feet

Surface pipe by Alternate: 1 2

Length of Surface Pipe-Planned to be set: 1500'

Length of Conductor Pipe required: (none)

Projected Total Depth: 5800'

Producing Formation Target: Mississippian

Water Source for Drilling Operations: well farm pond other

DWR Permit #: _____

(Note: Apply for Permit with DWR)

Will Cores be Taken? Yes No

If Yes, proposed zone: _____

* See att. notice of unit AFFIDAVIT

The undersigned hereby affirms that the drilling, completion and eventual plugging of this well will comply with K.S.A. 55-101, et. seq.
It is agreed that the following minimum requirements will be met:

- 1. Notify the appropriate district office prior to spudding of well;
- 2. A copy of the approved notice of intent to drill shall be posted on each drilling rig;
- 3. The minimum amount of surface pipe as specified below shall be set by circulating cement to the top; in all cases surface pipe shall be set through all unconsolidated materials plus a minimum of 20 feet into the underlying formation.
- 4. If the well is dry hole, an agreement between the operator and the district office on plug length and placement is necessary prior to plugging;
- 5. The appropriate district office will be notified before well is either plugged or production casing is cemented in;
- 6. If an ALTERNATE II COMPLETION, production pipe shall be cemented from below any usable water to surface within 120 days of spud date. In all cases NOTIFY district office prior to any cementing

I hereby certify that the statements made herein are true and to the best of my knowledge and belief.

Date: 10/28/2003 Signature of Operator or Agent: [Signature] Title: Vice President Operations

For KCC Use ONLY
API # 15 - 119-21120.00-00
Conductor Pipe required NONE feet
Minimum surface pipe required 600 feet per Alt. 1
Approved by: RJP 11-7-03
This authorization expires: 5-7-03
(This authorization void if drilling not started within 6 months of effective date.)
Spud date: _____ Agent: _____

Remember to:

- File Drill Pit Application (form CDP-1) with Intent to Drill;
- File Completion Form ACO-1 within 120 days of spud date;
- File acreage attribution plat according to field proration orders;
- Notify appropriate district office 48 hours prior to workover or re-entry;
- Submit plugging report (CP-4) after plugging is completed;
- Obtain written approval before disposing or injecting salt water.

36
32
302

IN ALL CASES PLOT THE INTENDED WELL IN A PRORATED OR SPACED FIELD

PLAT OF ACREAGE ATTRIBUTABLE TO A WELL IN A PRORATED OR SPACED FIELD

If the intended well is in a prorated or spaced field, please fully complete this side of the form. If the intended well is in a prorated or spaced field complete the plat below showing that the well will be properly located in relationship to other wells producing from the common source of supply. Please show all the wells and within 1 mile of the boundaries of the proposed acreage attribution unit for gas wells and within 1/2 mile of the boundaries of the proposed acreage attribution unit for oil wells.

API No. 15- _____
 Operator: PetroSantander (USA) Inc.
 Lease: Stevens (Morrow) Unit
 Well Number: 3606
 Field: Stevens

Location of Well: County: Meade
2640 feet from

S	N
W	E

 (circle one) Line of Section
1575 feet from _____ (circle one) Line of Section
 Sec. 36 Twp. 32S R. 30 East West

NUMBER OF ACRES ATTRIBUTABLE TO WELL _____

IS SECTION X REGULAR or _____ IRREGULAR

QTR/QTR/QTR OF ACREAGE NW-NE-SW

If Section is irregular, locate well from nearest corner boundary
 Section corner used: _____ NE _____ NW _____ SE _____ SW

PLAT

(Show location of the well and shade attributable acreage for prorated or spaced wells.)
 (Show footage to the nearest lease or unit boundary line.)

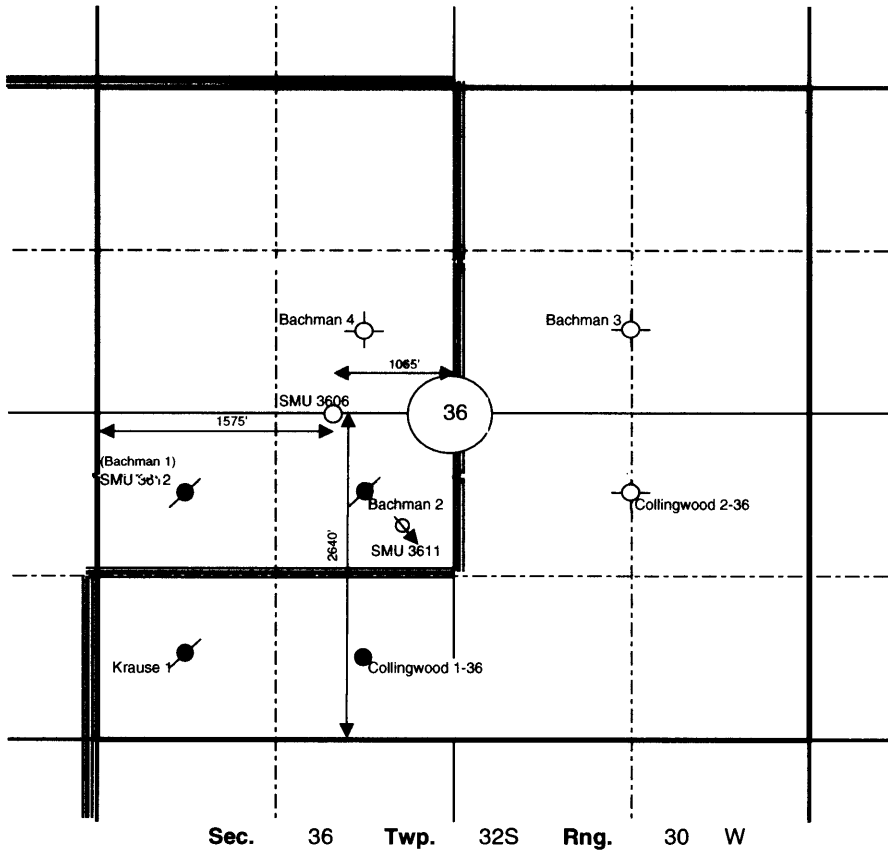

PLAT SHOWS : 1 SECTION

RECEIVED
 NOV 03 2003
 KCC WICHITA

In plotting the proposed location of the well, you must show:

1. The manner in which you are using the depicted plat by identifying section lines, i.e. 1 section, 1 section with 8 surrounding sections, 4 sections, etc.
2. The distance of the proposed drilling location from the section's south / north and east / west.
3. The distance to the nearest lease or unit boundary line.
4. If proposed location is located within a prorated or space field a certificate of acreage attribution plat must be attached: (C0-7 for oil wells; CG-8 for gas wells).