

Replaces → API 15-125-30391-00-00
expired 2-6-04

Re-submission of Intent

For KCC Use: 2-15-04
Effective Date: 3
District # 3
SGA? ☐ Yes ☒ No

KANSAS CORPORATION COMMISSION
OIL & GAS CONSERVATION DIVISION
NOTICE OF INTENT TO DRILL

Must be approved by KCC five (5) days prior to commencing well

Form C-1

December 2002

Form must be Typed

Form must be Signed

All blanks must be Filled

Expected Spud Date March 2004

OPERATOR: License# 33074
Name: Dart Cherokee Basin Operating Co. LLC
Address: 3541 County Rd 5400
City/State/Zip: Independence KS 67301
Contact Person: Tracy Williams
Phone: 620-331-7870

CONTRACTOR: License# 5675
Name: McPherson Drilling

Well Drilled For: ☒ Oil ☐ Enh Rec ☐ Infield ☐ Mud Rotary
☒ Gas ☐ Storage ☒ Pool Ext. ☒ Air Rotary
☐ OWWO ☐ Disposal ☐ Wildcat ☐ Cable
☐ Seismic; # of Holes ☐ Other

Spot Ap. W/2 W/2 SE SE Sec. 7 Twp. 33 S. R. 15 ☒ East ☐ West
660 feet from ☐ N / ☒ S Line of Section
1100 feet from ☒ E / ☐ W Line of Section
Is SECTION ☒ Regular ☐ Irregular?

(Note: Locate well on the Section Plat on reverse side)

County: Montgomery
Lease Name: Gay Well #: D4-7
Field Name: Cherokee Basin Coal Gas Area

Is this a Prorated / Spaced Field? ☐ Yes ☒ No

Target Information(s): Mississippian

Nearest Lease or unit boundary: 660

Ground Surface Elevation: 854 feet MSL

Water well within one-quarter mile: ☐ Yes ☐ No

Public water supply well within one mile: ☐ Yes ☐ No

Depth to bottom of fresh water: 100 +

Depth to bottom of usable water: 200 +

Surface Pipe by Alternate: ☐ 1 ☒ 2

Length of Surface Pipe Planned to be set: 20'

Length of Conductor Pipe required: NONE

Projected Total Depth: 1534

Formation at Total Depth: Mississippian

Water Source for Drilling Operations:

☐ Well ☒ Farm Pond ☐ Other

DWR Permit #: _____

(Note: Apply for Permit with DWR ☐)

Will Cores be taken? ☐ Yes ☒ No

If Yes, proposed zone: _____

If OWWO: old well information as follows:

Operator: _____

Well Name: _____

Original Completion Date: _____ Original Total Depth: _____

Directional, Deviated or Horizontal wellbore? ☐ Yes ☒ No

If Yes, true vertical depth: RECEIVED

Bottom Hole Location: KANSAS CORPORATION COMMISSION

KCC DKT #: FEB 10 2004

CONSERVATION DIVISION
WICHITA, KS

AFFIDAVIT

The undersigned hereby affirms that the drilling, completion and eventual plugging of this well will comply with K.S.A. 55 et. seq.

It is agreed that the following minimum requirements will be met:

1. Notify the appropriate district office **prior** to spudding of well;
2. A copy of the approved notice of intent to drill **shall be** posted on each drilling rig;
3. The minimum amount of surface pipe as specified below **shall be set** by circulating cement to the top; in all cases surface pipe **shall be set** through all unconsolidated materials plus a minimum of 20 feet into the underlying formation.
4. If the well is dry hole, an agreement between the operator and the district office on plug length and placement is necessary **prior to plugging**;
5. The appropriate district office will be notified before well is either plugged or production casing is cemented in;
6. If an ALTERNATE II COMPLETION, production pipe shall be cemented from below any usable water to surface within **120 days** of spud date. Or pursuant to Appendix "B" - Eastern Kansas surface casing order #133,891-C, which applies to the KCC District 3 area, alternate II cementing must be completed within 30 days of the spud date or the well shall be plugged. **In all cases, NOTIFY district office** prior to any cementing.

I hereby certify that the statements made herein are true and to the best of my knowledge and belief.

Date: February 9, 2004 Signature of Operator or Agent: [Signature] Title: E & O Manager

For KCC Use ONLY

API # 15 - 125-30484-00 00

Conductor pipe required NONE feet

Minimum surface pipe required 20 feet per Alt. 2

Approved by: RJP 2-10-04

This authorization expires: 8-10-04

(This authorization void if drilling not started within 6 months of effective date.)

Spud date: _____ Agent: _____

Remember to:

- File Drill Pit Application (form CDP-1) with Intent to Drill;
- File Completion Form ACO-1 within 120 days of spud date;
- File acreage attribution plat according to field proration orders;
- Notify appropriate district office 48 hours prior to workover or re-entry;
- Submit plugging report (CP-4) after plugging is completed;
- Obtain written approval before disposing or injecting salt water.
- If this permit has expired (See: authorized expiration date) please check the box below and return to the address below.

☐ Well Not Drilled - Permit Expired

Signature of Operator or Agent: _____

Date: _____

Mail to: KCC - Conservation Division, 130 S. Market - Room 2078, Wichita, Kansas 67202

7
33
15E

IN ALL CASES PLOT THE INTENDED WELL ON THE PLAT BELOW*Plat of acreage attributable to a well in a prorated or spaced field*

If the intended well is in a prorated or spaced field, please fully complete this side of the form. If the intended well is in a prorated or spaced field complete the plat below showing that the well will be properly located in relationship to other wells producing from the common source of supply. Please show all the wells and within 1 mile of the boundaries of the proposed acreage attribution unit for gas wells and within 1/2 mile of the boundaries of the proposed acreage attribution unit for oil wells.

API No. 15 - _____

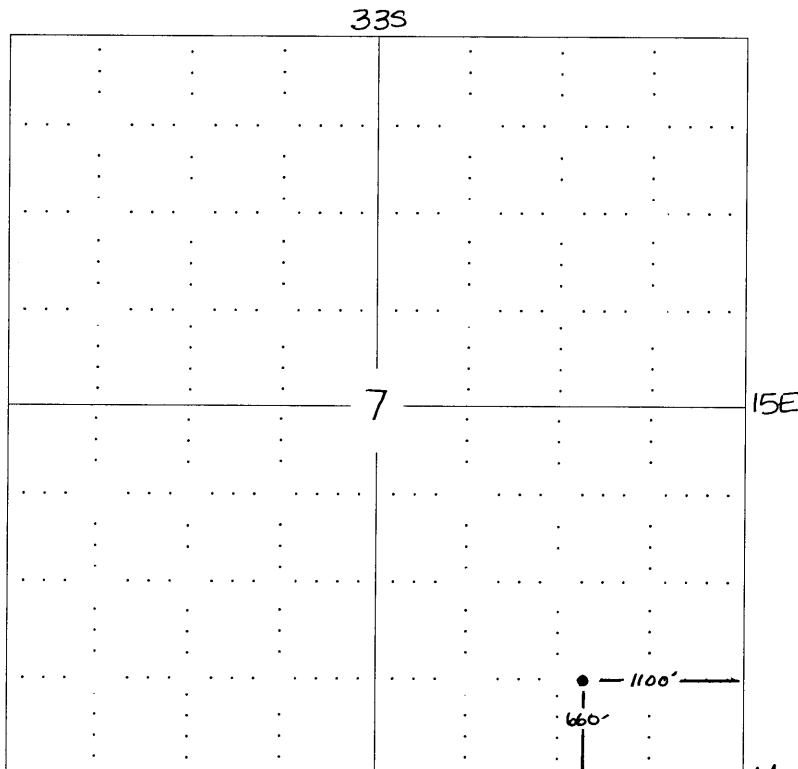
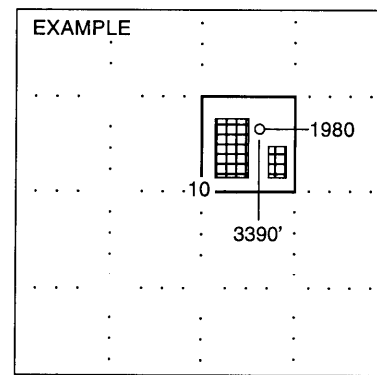
Operator: Dart Cherokee Basin Operating Co. LLCLease: GayWell Number: D4-7Field: Cherokee Basin Coal Gas AreaNumber of Acres attributable to well: 40QTR / QTR / QTR of acreage: _____ - SE - SELocation of Well: County: Montgomery660 feet from ☐ N / ☒ S Line of Section1100 feet from ☒ E / ☐ W Line of SectionSec. 7 Twp. 33 S. R. 15 ☒ East ☐ WestIs Section: ☒ Regular or ☐ Irregular**If Section is Irregular, locate well from nearest corner boundary.**Section corner used: ☐ NE ☐ NW ☐ SE ☐ SW**PLAT***(Show location of the well and shade attributable acreage for prorated or spaced wells.)**(Show footage to the nearest lease or unit boundary line.)***RECEIVED**
KANSAS CORPORATION COMMISSION**FEB 10 2004****CONSERVATION DIVISION**
WICHITA, KS*Montgomery County***NOTE: In all cases locate the spot of the proposed drilling location.****In plotting the proposed location of the well, you must show:**

1. The manner in which you are using the depicted plat by identifying section lines, i.e. 1 section, 1 section with 8 surrounding sections, 4 sections, etc.
2. The distance of the proposed drilling location from the section's south / north and east / west.
3. The distance to the nearest lease or unit boundary line.
4. If proposed location is located within a prorated or spaced field a certificate of acreage attribution plat must be attached: (C0-7 for oil wells; CG-8 for gas wells).