

RECEIVED

KANSAS CORPORATION COMMISSION

KANSAS CORPORATION COMMISSION

OIL & GAS CONSERVATION DIVISION

FEB 17 2004

Form C-1

December 2002

Form must be Typed

Form must be Signed

All blanks must be Filled

For KCC Use: 2.22.04
Effective Date: 2.22.04
District #: 1
SGA? Yes No

Must be approved by KCC five (5) days prior to commencing work

CONSERVATION DIVISION

WICHITA, KS

Expected Spud Date: 2/24/04
month day year

OPERATOR: License# 4549
Name: Anadarko Petroleum Corporation
Address: 1201 Lake Robbins Drive
City/State/Zip: The Woodlands, TX 77380
Contact Person: Jerry N. Blossom
Phone: (832) 636-3128

CONTRACTOR: License# 30606
Name: Murfin Drilling Co., Inc.

Well Drilled For: Oil Enh Rec Infield Mud Rotary
 Gas Storage Pool Ext. Air Rotary
 OWWO Disposal Wildcat Cable
 Seismic; # of Holes Other
 Other

If OWWO: old well information as follows:
Operator:
Well Name:
Original Completion Date: Original Total Depth:

Directional, Deviated or Horizontal wellbore? Yes No
If Yes, true vertical depth:
Bottom Hole Location:
KCC DKT #:

* Prorated & space Hugoton

Spot SE - SW - NW Sec. 8 Twp. 33 S. R. 34
2210 feet from N / S Line of Section
1130 feet from E / W Line of Section
Is SECTION Regular Irregular?

(Note: Locate well on the Section Plat on reverse side)

County: Seward
Lease Name: Hitch "H" Well #: 3
Field Name: ~~Cherokee~~

Is this a Prorated / Spaced Field? Yes No
Target Information(s): Basal Chester Sand

Nearest Lease or unit boundary: 430
Ground Surface Elevation: 2917 feet MSL

Water well within one-quarter mile: Yes No
Public water supply well within one mile: Yes No

Depth to bottom of fresh water: 500
Depth to bottom of usable water: 620

Surface Pipe by Alternate: 1 2
Length of Surface Pipe Planned to be set: 1660'

Length of Conductor Pipe required: NONE
Projected Total Depth: 6400'

Formation at Total Depth: St. Louis

Water Source for Drilling Operations:
 Well Farm Pond Other

DWR Permit #:
(Note: Apply for Permit with DWR)

Will Cores be taken? Yes No
If Yes, proposed zone:

AFFIDAVIT

The undersigned hereby affirms that the drilling, completion and eventual plugging of this well will comply with K.S.A. 55 et. seq.
It is agreed that the following minimum requirements will be met:

- 1. Notify the appropriate district office prior to spudding of well;
- 2. A copy of the approved notice of intent to drill shall be posted on each drilling rig;
- 3. The minimum amount of surface pipe as specified below shall be set by circulating cement to the top; in all cases surface pipe shall be set through all unconsolidated materials plus a minimum of 20 feet into the underlying formation.
- 4. If the well is dry hole, an agreement between the operator and the district office on plug length and placement is necessary prior to plugging;
- 5. The appropriate district office will be notified before well is either plugged or production casing is cemented in;
- 6. If an ALTERNATE II COMPLETION, production pipe shall be cemented from below any usable water to surface within 120 days of spud date. Or pursuant to Appendix "B" - Eastern Kansas surface casing order #133,891-C, which applies to the KCC District 3 area, alternate II cementing must be completed within 30 days of the spud date or the well shall be plugged. In all cases, NOTIFY district office prior to any cementing.

I hereby certify that the statements made herein are true and to the best of my knowledge and belief.

Date: 2-16-04 Signature of Operator or Agent: [Signature] Title: Staff Environmental & Regulatory Analyst

For KCC Use ONLY
API # 15 - 175-21918-00-00
Conductor pipe required NONE feet
Minimum surface pipe required 640 feet per Alt. ①
Approved by RJP 2.17.04
This authorization expires: 8.17.04
(This authorization void if drilling not started within 6 months of effective date.)
Spud date: Agent:

Remember to:

- File Drill Pit Application (form CDP-1) with Intent to Drill;
- File Completion Form ACO-1 within 120 days of spud date;
- File acreage attribution plat according to field proration orders;
- Notify appropriate district office 48 hours prior to workover or re-entry;
- Submit plugging report (CP-4) after plugging is completed;
- Obtain written approval before disposing or injecting salt water.
- If this permit has expired (See: authorized expiration date) please check the box below and return to the address below.

Well Not Drilled - Permit Expired
Signature of Operator or Agent:
Date:

Mail to: KCC - Conservation Division, 130 S. Market - Room 2078, Wichita, Kansas 67202

8
33
34

IN ALL CASES PLOT THE INTENDED WELL ON THE PLAT BELOW

Plat of acreage attributable to a well in a prorated or spaced field

If the intended well is in a prorated or spaced field, please fully complete this side of the form. If the intended well is in a prorated or spaced field complete the plat below showing that the well will be properly located in relationship to other wells producing from the common source of supply. Please show all the wells and within 1 mile of the boundaries of the proposed acreage attribution unit for gas wells and within 1/2 mile of the boundaries of the proposed acreage attribution unit for oil wells.

API No. 15 - _____
 Operator: Anadarko Petroleum Corporation
 Lease: Hitch "H"
 Well Number: 3
 Field: Shuck
 Number of Acres attributable to well: 320
 QTR / QTR / QTR of acreage: _____ - _____ - N/2

Location of Well: County: Seward
2210 _____ feet from N / S Line of Section
1130 _____ feet from E / W Line of Section
 Sec. 8 Twp. 33 S. R. 34 East West
 Is Section: Regular or Irregular
 If Section is Irregular, locate well from nearest corner boundary.
 Section corner used: NE NW SE SW

PLAT

*(Show location of the well and shade attributable acreage for prorated or spaced wells.)
 (Show footage to the nearest lease or unit boundary line.)*

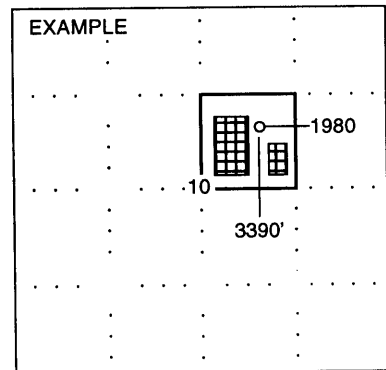
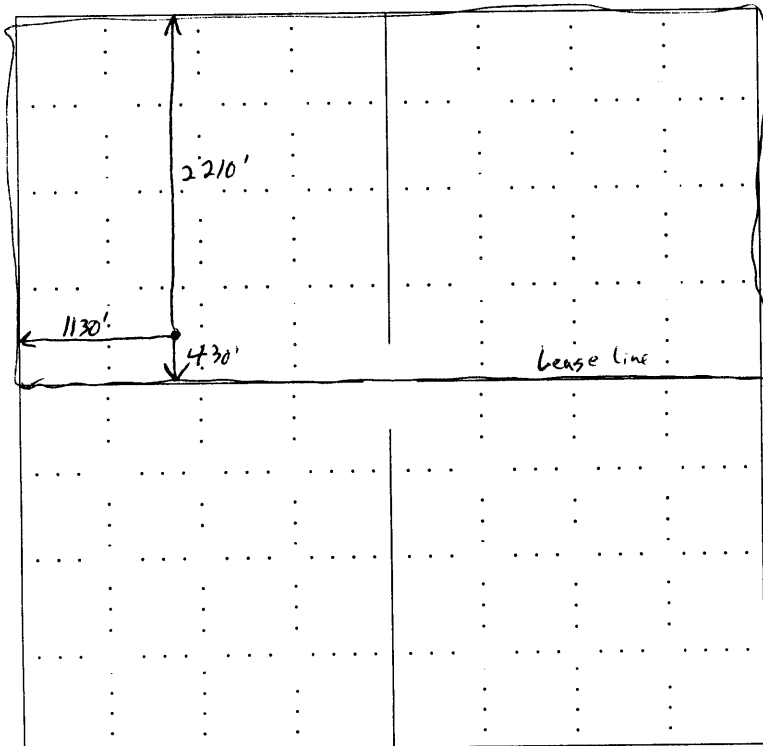

SEWARD CO.

NOTE: In all cases locate the spot of the proposed drilling location.

In plotting the proposed location of the well, you must show:

1. The manner in which you are using the depicted plat by identifying section lines, i.e. 1 section, 1 section with 8 surrounding sections, 4 sections, etc.
2. The distance of the proposed drilling location from the section's south / north and east / west.
3. The distance to the nearest lease or unit boundary line.
4. If proposed location is located within a prorated or spaced field a certificate of acreage attribution plat must be attached: (CO-7 for oil wells; CG-8 for gas wells).