

RECEIVED
FEB 17 2004
KCC WICHITA

KANSAS CORPORATION COMMISSION
OIL & GAS CONSERVATION DIVISION
WELL PLUGGING APPLICATION
Please TYPE Form and File ONE Copy

Form CP-1
September 2003
This Form must be Typed
Form must be Signed
All blanks must be Filled

API # 15 - 151-10054-0000 (Identifier Number of this well). This must be listed for wells drilled since 1967; if no API # was issued,

indicate original spud or completion date 3-31-1945

Well Operator: MICA Energy Corp. KCC License #: 32047 2/05
(Owner / Company Name) (Operator's)

Address: P.O. Box 20707 City: Oklahoma City

State: OK Zip Code: 73156 Contact Phone: (405) 942 - 4552

Lease: Kerr, F.H. Well #: 2 Sec. 27 Twp. 29S S. R. 14 East West

SW/4 - SE - SW Spot Location / QQQQ County: Pratt

330 Feet (in exact footage) From North / South (from nearest outside section corner) Line of Section (Not Lease Line)

1650 900 Feet (in exact footage) From East / West (from nearest outside section corner) Line of Section (Not Lease Line)

Check One: Oil Well Gas Well D&A Cathodic Water Supply Well
 SWD Docket # _____ ENHR Docket # _____ Other: _____

Conductor Casing Size: _____ Set at: _____ Cemented with: _____ Sacks

Surface Casing Size: 8 5/8" Set at: 763" Cemented with: 300 Sacks

Production Casing Size: 5 1/2" Set at: 4523' Cemented with: 200 Sacks

List (ALL) Perforations and Bridgeplug Sets: Open hole 4523 - 4530'. Located hole in 5 1/2" @2937'. Squeezed with 225 sacks.

Elevation: 1949 (G.L. / K.B.) T.D.: 4530' PBTD: _____ Anhydrite Depth: _____
(Stone Corral Formation)

Condition of Well: Good Poor Casing Leak Junk in Hole

Proposed Method of Plugging (attach a separate page if additional space is needed): Set CIBP @4510' - Spot 2 sacks cement on top of plug.

.Take stretch in casing. Cut off and plug - setting proper plug as you lay down casing. Dig out well head and cap.

As per KCC recommendations.

Is Well Log attached to this application as required? Yes No Is ACO-1 filed? Yes No

If not explain why? _____

Plugging of this Well will be done in accordance with K.S.A. 55-101 et. seq. and the Rules and Regulations of the State Corporation Commission.

List Name of Company Representative authorized to be in charge of plugging operations: Clyde D. Jowery
Phone: (405) 942 - 4552

Address: P.O. Box 20707 City / State: Oklahoma City, OK 73156

Plugging Contractor: Quality Well Service KCC License #: 31925
(Company Name) (Contractor's)

Address: 401 W. Main, Lyons, KS 67554 Phone: (620) 727 - 3410

Proposed Date and Hour of Plugging (if known?): _____

Payment of the Plugging Fee (K.A.R. 82-3-118) will be guaranteed by Operator or Agent

Date: 2-12-04 Authorized Operator / Agent: Clyde D. Jowery
(Signature)

Mail to: KCC - Conservation Division, 130 S. Market - Room 2078, Wichita, Kansas 67202

KANSAS

CORPORATION COMMISSION

Kathleen Sebelius, Governor Brian J. Moline, Chair John Wine, Commissioner Robert E. Krehbiel, Commissioner

NOTICE OF RECEIPT OF WELL PLUGGING APPLICATION (CP-1)

MICA Energy Corp.
P. O. Box 20707
Oklahoma City, OK 73156

February 19, 2004

Re: KERR F H #2
API 15-151-10054-00-00
SWSESW 27-29S-14W, 330 FSL 1650 FWL
PRATT COUNTY, KANSAS

Dear Operator:

This letter is to notify you that the Conservation Division is in receipt of your plugging proposal, form CP-1, for the above-captioned well.

Your CP-1 has been reviewed by the Conservation Division central office for completeness and to verify license numbers. The plugging proposal will now be forwarded to the district office listed below for review of your proposed method of plugging.

Please contact the district office for approval of your proposed plugging method at least five (5) days before plugging the well, pursuant to K.A.R. 82-3-113 (b). If a workover pit will be used during the plugging of the well it must be permitted. A CDP-1 form must be filed and approved prior to the use of the pit.

The Conservation Division's review of form CP-1, either in the central or district office, does not include an inquiry into well ownership or the filing operator's legal right to plug the well.

This notice in no way constitutes authorization to plug the above-captioned well by persons not having legal rights of ownership or interest in the well. This notice is void after ninety (90) days from the above date.

District: #1
210 E Frontview, Suite A
Dodge City, KS 67801
(620) 225-8888

Sincerely

David P. Williams
Production Supervisor

SKELLY OIL COMPANY

RECEIVED
FEB 17 2004
KCC WICHITA

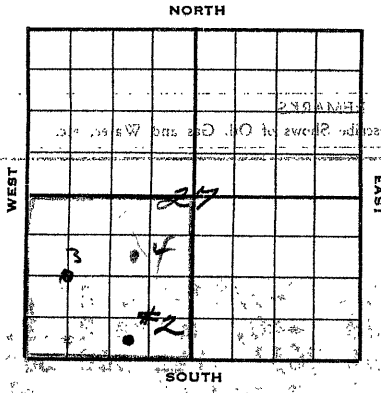

MOTTOB FORMATION

Lease Name and No. Prod. 27-293-147 Well No. 2 Elev. 1948

Lease Description Oil & Gas 27-293-147, 1948

Location made March 28 1945 by Wagon County, Oklahoma

feet from North line 790 feet from East line _____

330 feet from South line _____ feet from West line of 14200

Work com'd Mar. 31 1945 Rig comp'd Apr. 1 1945 Drlg. com'd Apr. 2 1945 Drlg. comp'd May 22 1945

Rig Contractor Russ Drilling Company

Drilling Contractor Russ Drilling Company, Tulsa, Oklahoma

Rotary Drilling from Top to 4327' Cable Tool Drilling from 4327' to 4330'

Commenced Producing May 23 1945 Initial Prod. before shot or acid 24 bbl. S.S.C. 24 bbl.

Initial Prod. after shot or acid 1570 barrels oil, no str. Bbls.

Dry Gas Well Press _____ Volume _____ Cu. ft.

Casing Head Gas Pressure _____ Volume _____ Cu. ft.

Braden Head (8-5/8" x 251" OD) Gas Pressure _____ Volume _____ Cu. ft.

Braden Head (_____) Gas Pressure _____ Volume _____ Cu. ft.

PRODUCING FORMATION Simpson Sand Top 4323' Bottom 4330' TOTAL DEPTH 4330'

CASING RECORD

Size	Wt.	Thds.	Where Set	PULLED OUT			LEFT IN			KIND	Cond'n	CEMENTING	
				Jts.	Feet	In.	Jts.	Feet	In.			Sacks Used	Method Employed
8-5/8" OD 23#		BR	763'				24	764'	6	HE 23# RBW A		300	Halliburton
5-1/2" OD 17#		BR	4323'				124	4334'	6	HE 17# SB A		200	Halliburton
(8-5/8" casing set 6' in collar & 5' casing ceased to Derrick floor)													
(Used 1 - 5/8" OD Baker Combination Galcs and Float 2500)													

Liner Set at _____ Length _____ Perforated at _____

Liner Set at _____ Length _____ Perforated at _____

Packer Set at _____ Size and Kind _____

Packer Set at _____ Size and Kind _____

SHOT OR ACID TREATMENT RECORD

	FIRST		SECOND		THIRD		FOURTH	
Date								
Acid Used								
Size Shot		Gals. Qts.		Gals. Qts.		Gals. Qts.		Gals. Qts.
Shot Between	Ft. and Ft.		Ft. and Ft.		Ft. and Ft.		Ft. and Ft.	
Size of Shell								
Put in by (Co.)								
Length anchor								
Distance below Cas'g								
Damage to Casing or Casing Shoulder								

SIGNIFICANT GEOLOGICAL FORMATIONS

NAME	Top	Bottom	GAS		OIL		REMARKS
			From	To	From	To	
<u>Flora lime</u>	<u>4404'</u>						
<u>Simpson Sand</u>	<u>4323'</u>				<u>4323'</u>	<u>4327'</u>	<u>Porous and saturated</u>

CLEANING OUT RECORDS

	DATE COMMENCED	DATE COMPLETED	PROD. BEFORE	PROD. AFTER	REMARKS
1st					
2nd					See Reverse for other details.
3rd					" " " " "
4th					" " " " "

PLUGGING BACK AND DEEPENING RECORDS

	Date Commenced	Date Completed	No. Feet Plugged Back or Deepened	Prod. Before	Prod. After	REMARKS
1st						
2nd						See Reverse for other details.
3rd						" " " " "
4th						" " " " "

(See Reverse for Record of Formation)

