

STATE CORPORATION COMMISSION OF KANSAS
OIL & GAS CONSERVATION DIVISION

WELL COMPLETION OR RECOMPLETION FORM
ACO-1 WELL HISTORY

DESCRIPTION OF WELL AND LEASE

Operator: License # 9123
Name Diamond Shamrock Exploration
Address P.O. Box 400
City/State/Zip Amarillo, Texas 79188

Purchaser.....

Operator Contact Person Todd Lovett
Phone (806) 378-3848

Contractor: License # 5381
Name Big Springs Drilling, Inc.

Wellsite Geologist Mike Russell
Phone 776-0133

Designate Type of Completion
 New Well Re-Entry Workover
 Oil SWD Temp Abd
 Gas Inj Delayed Comp.
 Dry Other (Core, Water Supply etc.)

If OWWO: old well info as follows:
Operator
Well Name
Comp. Date Old Total Depth.....

WELL HISTORY

Drilling Method:
 Mud Rotary Air Rotary Cable
12-22-84 1-1-85 1-01-85
Spud Date Date Reached TD Completion Date
3650'
Total Depth PBTD
Amount of Surface Pipe Set and Cemented at 329' feet
Multiple Stage Cementing Collar Used? Yes No
If yes, show depth set.....feet
If alternate 2 completion, cement circulated
from.....feet depth to.....w/.....SX cmt

API NO. 15-147-20,467-00-00
County Phillips
SW NE SW 11 1S 18W
Soc. Twp. Rge. West

1650'
3630' Ft North from Southeast Corner of Section
Ft West from Southeast Corner of Section
(Note: Locate well in section plat below)

Lease Name Allen R. Adee Trust Well # 2

Field Name.....

Producing Formation.....

Elevation: Ground 2115' KB 2120'

Section Plat

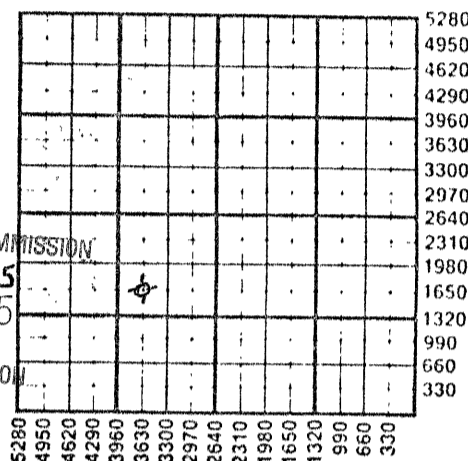

WATER SUPPLY INFORMATION

Disposition of Produced Water: Disposal
Docket # Repressuring

Questions on this portion of the ACO-1 call:
Water Resources Board (913) 296-3717

Source of Water: Hauled
Division of Water Resources Permit #.....
 Groundwater.....Ft North from Southeast Corner
(Well)Ft West from Southeast Corner of
Sec Twp Rge East West
 Surface Water 4950 Ft North from Southeast Corner
(Stream, pond etc) 4950 Ft West from Southeast Corner
Sec 11 Twp 1S Rge 18W East West
 Other (explain).....
(purchased from city, R.W.D. #)

INSTRUCTIONS: This form shall be completed in duplicate and filed with the Kansas Corporation Commission, 200 Colorado Derby Building, Wichita, Kansas 67202, within 90 days after completion or recompletion of any well. Rule 82-3-130 and 82-3-107 apply. Information on side two of this form will be held confidential for a period of 12 months if requested in writing and submitted with the form. See rule 82-3-107 for confidentiality in excess of 12 months. One copy of all wireline logs and drillers time log shall be attached with this form. Submit CP-4 form with all plugged wells. Submit CP-111 form with all temporarily abandoned wells.

All requirements of the statutes, rules and regulations promulgated to regulate the oil and gas industry have been fully complied with and the statements herein are complete and correct to the best of my knowledge.

Signature Todd Lovett
Title Drilling Engineer Date 1-18-85

Subscribed and sworn to before me this 18 day of January 1985
Notary Public Patti Jones
Date Commission Expires 5-06-85

K.C.C. OFFICE USE ONLY
 Letter of Confidentiality Attached
 Wireline Log Received
 Drillers Timelog Received
Distribution
 KCC SWD/Rep NCPA
 KGS Plug Other
(Specify)

Operator Name Diamond Shamrock Exploration Lease Name Allen R. Adee Trust Well # 2

Sec. 11 Twp. 1S Rge. 18W East West County Phillips

WELL LOG

INSTRUCTIONS: Show important tops and base of formations penetrated. Detail all cores. Report all drill stem tests giving interval tested, time tool open and closed, flowing and shut-in pressures, whether shut-in pressure reached static level, hydrostatic pressures, bottom hole temperature, fluid recovery, and flow rates if gas to surface during test. Attach extra sheet if more space is needed. Attach copy of log.

Drill Stem Tests Taken Yes No
Samples Sent to Geological Survey Yes No
Cores Taken Yes No

Formation Description
 Log Sample

DST#1 - 3388-3424 - 30/60/15/30. 1st open weak blow 1/4" decrease to surf. blow. FP 40/40, SIP 996. 2nd open very weak sur. blow died in 10 min. FP 50/50, SIP 916. Rec 30' specked mud.

Name	Top	Bottom
Topeka	3118	
Heebner	3332	
Toronto	3362	
Lansing	3382	
B/KC	3615	

DSE#2 - 3441-3475 - 30/60/30/60 - 1st period IFP 60 FFP 111, SIP 876. wnd Period. IFP 161, FFP 192, SIP 866, FHP 1877. DP rec'y 2' oil, 28' oil cut mud 330' salt water.

DST#3 - 3441-3465 - 30/60/30/60 - 1st open weak 1/4" blow decrease to surf. blow. FP 30/50, SIP 756, snd open very weak surf blow dead in 20 min. FP 80/101, SIP 732. Rec. 1' clean cut oil, 49' oil cut mud 3% oil, 60' watery mud & 120' muddy water.

CASING RECORD Now Used
Report all strings set-conductor, surface, intermediate, production, etc.

Purpose of String	Size Hole Drilled	Size Casing Set (in O.D.)	Weight Lbs/Ft.	Setting Depth	Type of Cement	#Sacks Used	Type and Percent Additives
Surface	12 1/4"	8 5/8"	24#	330	Common	225SX	2% gel 3%cc

Shots Per Foot	Specify Footage of Each Interval Perforated	Acid, Fracture, Shot, Cement Squeeze Record (Amount and Kind of Material Used)	Depth

TUBING RECORD Size Set At Packer at Liner Run Yes No

Date of First Production Producing Method Flowing Pumping Gas Lift Other (explain).....

Estimated Production Per 24 Hours	Oil Bbls	Gas MCF	Water Bbls	Gas-Oil Ratio	Gravity CFPB

METHOD OF COMPLETION Production Interval

Disposition of gas: Vented Open Hole Perforation
 Sold Other (Specify)
 Used on Lease Dually Completed
 Commingled