

RECEIVED

FEB 05 2004

Form C-1

December 2002

Form must be Typed

Form must be Signed

All blanks must be Filled

For KCC Use: Effective Date: 2-22-04 District # 3 SGA? Yes No

KANSAS CORPORATION COMMISSION OIL & GAS CONSERVATION DIVISION

NOTICE OF INTENT TO DRILL

Must be approved by KCC five (5) days prior to commencing well

KCC WICHITA

Expected Spud Date 2 20 2004 month day year

Spot NE SW SE Sec. 15 Twp. 5 S. R. 15 East West 810 feet from N / S Line of Section 1830 feet from E / W Line of Section Is SECTION Regular Irregular?

OPERATOR: License# 33233 Name: Heartland Oil & Gas, Inc. Address: c/o BAM Energy, Inc., 6286 East Long Circle North City/State/Zip: Englewood, Colorado 80112 Contact Person: Mr. Bill Hayworth Phone: 303-221-4768

(Note: Locate well on the Section Plat on reverse side) County: Jackson Lease Name: Amon Well #: 15-15 Field Name: wildcat

CONTRACTOR: License# [Redacted] Name: [Redacted]

ADVISE ON ACO-1; MUST BE LICENSED WITH KCC

Is this a Prorated / Spaced Field? Yes No

Well Drilled For: Oil Gas OWWO Seismic; # of Holes Other Well Class: Enh Rec Storage Disposal Infield Pool Ext Wildcat Other Type Equipment: Mud Rotary Air Rotary Cable

Target Formation(s): Cherokee Nearest Lease or unit boundary: 810' Ground Surface Elevation: 1120' feet MSL Water well within one-quarter mile: Yes No Public water supply well within one mile: Yes No Depth to bottom of fresh water: 100 150 Depth to bottom of usable water: 100 200

If OWWO: old well information as follows: Operator: Well Name: Original Completion Date: Original Total Depth:

Surface Pipe by Alternate: 1 2 Length of Surface Pipe Planned to be set: 200 220 M.I. Length of Conductor Pipe required: none Projected Total Depth: 2700' Formation at Total Depth: Mississippian

Directional, Deviated or Horizontal wellbore? Yes No If Yes, true vertical depth: Bottom Hole Location: KCC DKT #:

Water Source for Drilling Operations: Well Farm Pond Other or haul water in DWR Permit #: Will Cores be taken? Yes No If Yes, proposed zone:

AFFIDAVIT

The undersigned hereby affirms that the drilling, completion and eventual plugging of this well will comply with K.S.A. 55 et. seq. It is agreed that the following minimum requirements will be met:

- 1. Notify the appropriate district office prior to spudding of well; 2. A copy of the approved notice of intent to drill shall be posted on each drilling rig; 3. The minimum amount of surface pipe as specified below shall be set by circulating cement to the top; in all cases surface pipe shall be set through all unconsolidated materials plus a minimum of 20 feet into the underlying formation. 4. If the well is dry hole, an agreement between the operator and the district office on plug length and placement is necessary prior to plugging; 5. The appropriate district office will be notified before well is either plugged or production casing is cemented in; 6. If an ALTERNATE II COMPLETION, production pipe shall be cemented from below any usable water to surface within 120 days of spud date. Or pursuant to Appendix "B" - Eastern Kansas surface casing order #133,891-C, which applies to the KCC District 3 area, alternate II cementing must be completed within 30 days of the spud date or the well shall be plugged. In all cases, NOTIFY district office prior to any cementing.

I hereby certify that the statements made herein are true and to the best of my knowledge and belief. Date: 4/31/04 Signature of Operator or Agent: [Signature] Title: Consultant

For KCC Use ONLY API # 15 - 085-200740000 Conductor pipe required NONE feet Minimum surface pipe required 220 feet per Alt. 1 Approved by: RJP 2-17-04 This authorization expires: 8-17-04 (This authorization void if drilling not started within 6 months of effective date.) Spud date: Agent:

Remember to: - File Drill Pit Application (form CDP-1) with Intent to Drill; - File Completion Form ACO-1 within 120 days of spud date; - File acreage attribution plat according to field proration orders; - Notify appropriate district office 48 hours prior to workover or re-entry; - Submit plugging report (CP-4) after plugging is completed; - Obtain written approval before disposing or injecting salt water. - If this permit has expired (See: authorized expiration date) please check the box below and return to the address below. Well Not Drilled - Permit Expired Signature of Operator or Agent: Date:

Mail to: KCC - Conservation Division, 130 S. Market - Room 2078, Wichita, Kansas 67202

15-5-15E

IN ALL CASES PLOT THE INTENDED WELL ON THE PLAT BELOW

Plat of acreage attributable to a well in a prorated or spaced field

If the intended well is in a prorated or spaced field, please fully complete this side of the form. If the intended well is in a prorated or spaced field complete the plat below showing that the well will be properly located in relationship to other wells producing from the common source of supply. Please show all the wells and within 1 mile of the boundaries of the proposed acreage attribution unit for gas wells and within 1/2 mile of the boundaries of the proposed acreage attribution unit for oil wells.

API No. 15 - _____
Operator: Heartland Oil & Gas, Inc.
Lease: Amon
Well Number: 15-15
Field: wildcat

Number of Acres attributable to well: 40
QTR / QTR / QTR of acreage: NE - SW - SE

Location of Well: County: Jackson
810 feet from N / S Line of Section
1830 feet from E / W Line of Section
Sec. 15 Twp. 5 S. R. 15 East West

Is Section: Regular or Irregular

If Section is Irregular, locate well from nearest corner boundary.
Section corner used: NE NW SE SW

PLAT

*(Show location of the well and shade attributable acreage for prorated or spaced wells.)
(Show footage to the nearest lease or unit boundary line.)*

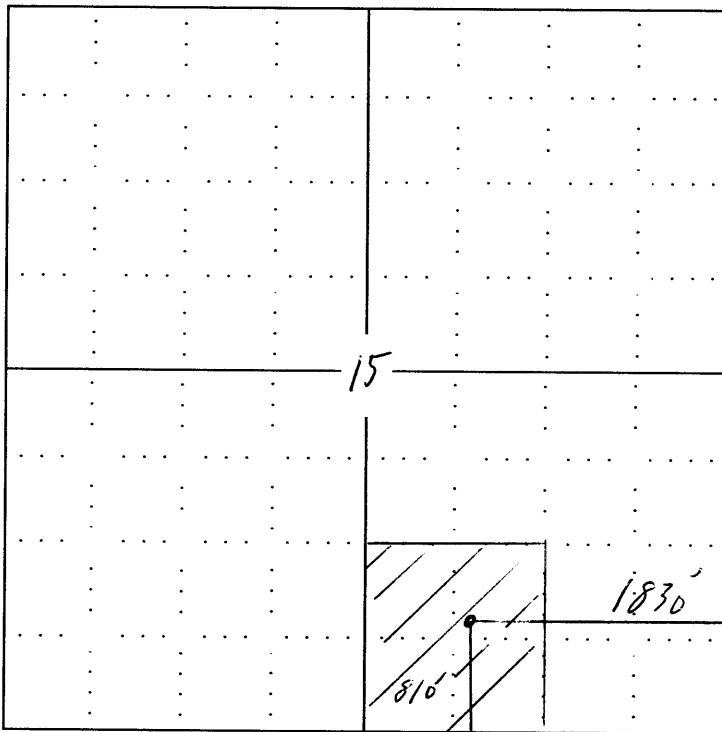

NOTE: In all cases locate the spot of the proposed drilling locaton.

RECEIVED
FEB 05 2004
KCC WICHITA

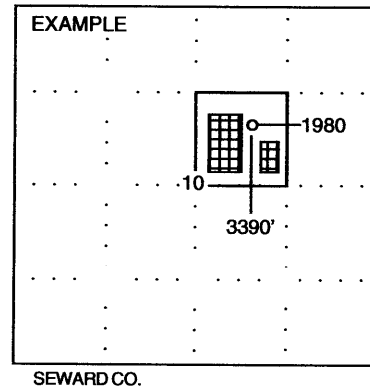

In plotting the proposed location of the well, you must show:

1. The manner in which you are using the depicted plat by identifying section lines, i.e. 1 section, 1 section with 8 surrounding sections, 4 sections, etc.
2. The distance of the proposed drilling location from the section's south / north and east / west.
3. The distance to the nearest lease or unit boundary line.
4. If proposed location is located within a prorated or spaced field a certificate of acreage attribution plat must be attached: (C0-7 for oil wells; CG-8 for gas wells).