

For KCC Use:
 Effective Date: 3-10-04
 District #: 3
 SGA? Yes No

KANSAS CORPORATION COMMISSION
 OIL & GAS CONSERVATION DIVISION
NOTICE OF INTENT TO DRILL

Form C-1
 December 2002
 Form must be Typed
 Form must be Signed
 All blanks must be Filled

Must be approved by KCC five (5) days prior to commencing well

Expected Spud Date Mach 11, 2004
month day year

OPERATOR: License# 33344
 Name: Quest Cherokee, LLC
 Address: P. O. Box 100
 City/State/Zip: Benedict, Ks 66714
 Contact Person: Doug Lamb
 Phone: 405-840-9894

CONTRACTOR: License# W
 Name: ADVISE ON ACO-1; MUST BE LICENSED WITH KCC

Well Drilled For:	Well Class:	Type Equipment:
<input type="checkbox"/> Oil	<input type="checkbox"/> Enh Rec	<input type="checkbox"/> Infield
<input checked="" type="checkbox"/> Gas	<input type="checkbox"/> Storage	<input checked="" type="checkbox"/> Pool Ext.
<input type="checkbox"/> OWWO	<input type="checkbox"/> Disposal	<input type="checkbox"/> Wildcat
<input type="checkbox"/> Seismic; # of Holes	<input type="checkbox"/> Other	<input type="checkbox"/> Cable
<input type="checkbox"/> Other		

If OWWO: old well information as follows:
 Operator: _____
 Well Name: _____
 Original Completion Date: _____ Original Total Depth: _____

Directional, Deviated or Horizontal wellbore? Yes No
 If Yes, true vertical depth: _____
 Bottom Hole Location: _____
 KCC DKT #: _____

CONSERVATION DIVISION
 WICHITA, KS

AFFIDAVIT

The undersigned hereby affirms that the drilling, completion and eventual plugging of this well will comply with K.S.A. 55 et. seq.
 It is agreed that the following minimum requirements will be met:

1. Notify the appropriate district office **prior** to spudding of well;
2. A copy of the approved notice of intent to drill **shall be** posted on each drilling rig;
3. The minimum amount of surface pipe as specified below **shall be set** by circulating cement to the top; in all cases surface pipe **shall be set** through all unconsolidated materials plus a minimum of 20 feet into the underlying formation.
4. If the well is dry hole, an agreement between the operator and the district office on plug length and placement is necessary **prior to plugging**;
5. The appropriate district office will be notified before well is either plugged or production casing is cemented in;
6. If an ALTERNATE II COMPLETION, production pipe shall be cemented from below any usable water to surface within **120 days** of spud date. Or pursuant to Appendix "B" - Eastern Kansas surface casing order #133,891-C, which applies to the KCC District 3 area, alternate II cementing must be completed within 30 days of the spud date or the well shall be plugged. **In all cases, NOTIFY district office** prior to any cementing.

I hereby certify that the statements made herein are true and to the best of my knowledge and belief.

Date: 3/4/04 Signature of Operator or Agent: Richard Markin Title: Operations Manager

For KCC Use ONLY
 API # 15 - 099-23435-00-00
 Conductor pipe required NONE feet
 Minimum surface pipe required 20 feet per Alt. + 2
 Approved by: RJP 3-5-04
 This authorization expires: 9-5-04
(This authorization void if drilling not started within 6 months of effective date.)
 Spud date: _____ Agent: _____

Spot Ap 115' S & 40' W of
 _____ SE se Sec. 28 Twp. 31 S. R. 18 East West
2000 S25 feet from N / S Line of Section per
700 feet from E / W Line of Section op
 Is SECTION Regular Irregular? 3-5-0P

(Note: Locate well on the Section Plat on reverse side)
 County: Labette
 Lease Name: Bowen Rev. Trust Well #: 28-1
 Field Name: Dennis
 Is this a Prorated / Spaced Field? Yes No
 Target Information(s): Arbuckle Dolomite
 Nearest Lease or unit boundary: 640
 Ground Surface Elevation: 944 feet MSL
 Water well within one-quarter mile: Yes No
 Public water supply well within one mile: Yes No
 Depth to bottom of fresh water: 100
 Depth to bottom of usable water: 200
 Surface Pipe by Alternate: 1 2
 Length of Surface Pipe Planned to be set: 25
 Length of Conductor Pipe required: NONE
 Projected Total Depth: 1500
 Formation at Total Depth: Arbuckle Dolomite
 Water Source for Drilling Operations:
 Well Farm Pond Other Air
 DWR Permit #: _____
 (Note: Apply for Permit with DWR)
 Will Cores be taken? Yes No
 If Yes, proposed zone: _____

28
31
18E

IN ALL CASES PLOT THE INTENDED WELL ON THE PLAT BELOW

Plat of acreage attributable to a well in a prorated or spaced field

If the intended well is in a prorated or spaced field, please fully complete this side of the form. If the intended well is in a prorated or spaced field complete the plat below showing that the well will be properly located in relationship to other wells producing from the common source of supply. Please show all the wells and within 1 mile of the boundaries of the proposed acreage attribution unit for gas wells and within 1/2 mile of the boundaries of the proposed acreage attribution unit for oil wells.

API No. 15 - _____
 Operator: Quest Cherokee, LLC
 Lease: Bowen Rev. Trust
 Well Number: 28-1
 Field: Dennis
 Number of Acres attributable to well: _____
 QTR / QTR / QTR of acreage: _____ - ne - se

Location of Well County: Labette
~~2800~~ 525 feet from N / S Line of Section
 700 feet from E / W Line of Section
 Sec. 28 Twp. 31 S. R. 18 East West

Is Section: Regular or Irregular

If Section is Irregular, locate well from nearest corner boundary.
 Section corner used: NE NW SE SW

PLAT

(Show location of the well and shade attributable acreage for prorated or spaced wells.)
(Show footage to the nearest lease or unit boundary line.)

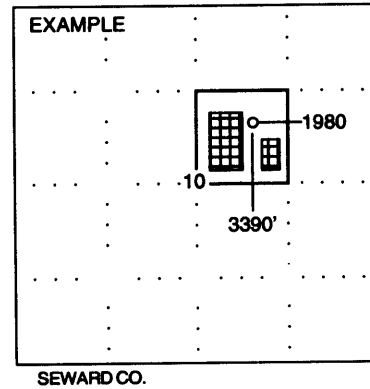
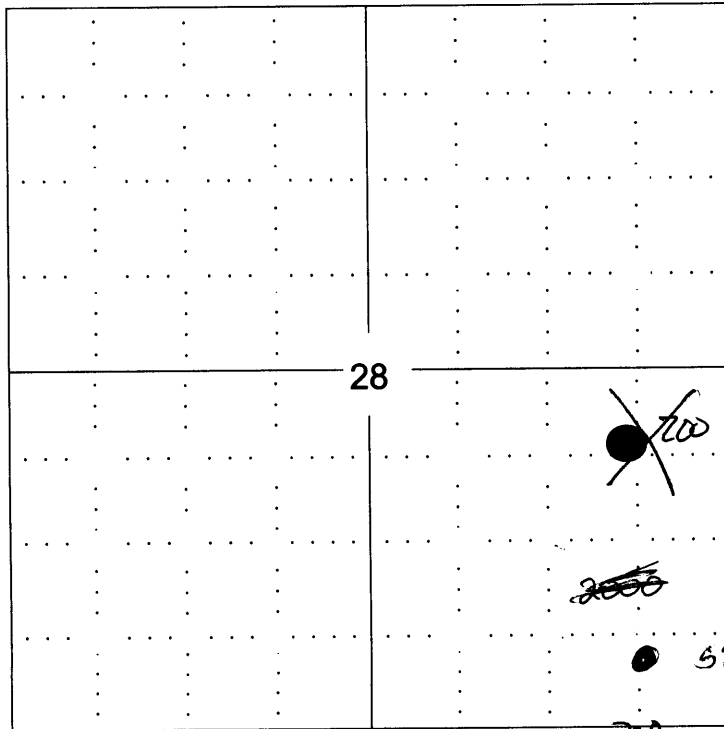

NOTE: In all cases locate the spot of the proposed drilling location.

In plotting the proposed location of the well, you must show:

1. The manner in which you are using the depicted plat by identifying section lines, i.e. 1 section, 1 section with 8 surrounding sections, 4 sections, etc.
2. The distance of the proposed drilling location from the section's south / north and east / west.
3. The distance to the nearest lease or unit boundary line.
4. If proposed location is located within a prorated or spaced field a certificate of acreage attribution plat must be attached: (C0-7 for oil wells; CG-8 for gas wells).