

CARD MUST BE TYPED

State of Kansas
NOTICE OF INTENTION TO DRILL
HUGOTON INFILL

CARD MUST BE SIGNED

SCA-NG

EFFECTIVE DATE 3-24-04

Starting Date 05 01 04
month day year

API Number 15- 129.21731.00.00
IS SECTION X REGULAR IRREGULAR

OPERATOR: License # 5952
Name BP AMERICA PRODUCTION COMPANY
Address P. O. BOX 3092, WL1, RM 3.201
City/State/Zip HOUSTON, TX 77253-3092
Contact Person SUE SELLERS
Phone (281)366-2052

AP NE NE NW SW Sec 24 Twp 31S S, Rg 40W W
2450' S Ft. from South Line of Section
1250' W Ft. from WEST Line of Section

CONTRACTOR License # 5382
Name CHEYENNE DRILLING
City/State _____

Note: Attach acreage attribution plat locating both Chase (Hugoton) wells
Total number of acres attributed to unit 640

Well Drilled as: X New Recompletion OWWO
Projected Total Depth 2715 feet
Formation HUGOTON/CHASE

Nearest producing well from
same common source of supply 2100' feet
Nearest lease or unit boundary line 1250' W feet

If OWWO or Recompletion: old well info as follows:
Operator _____
Well Name _____
Comp. Date _____ Old Total Depth _____

County MORTON
Lease Name BREEDING 'A' Well # 4HI
Ground surface elevation 3265 feet MSL
Depth to bottom of fresh water 400
Depth to bottom of usable water 560
Surface pipe by Alternate: 1 X 2
Surface pipe planned to be set 580' MIN
Water Source for Drilled Operations:
DWR Permit #: _____ well _____ farm pond X other _____

I certify that well will comply with K.S.A. 55-101, et seq., plus eventually plugging hole to KCC specifications.
Date 03/08/04 Signature of Operator or Agent Sue Sellers Title _____

REGULATORY STAFF
ASSISTANT

For KCC Use:
Conductor Pipe Required NONE feet; Minimum Surface Pipe Required 580 feet per Alt (1)
This Authorization Expires 9-19-04 Approved By RJP 3-19-04

9/95

RECEIVED

Must be filed with K.C.C. five (5) days prior to commencing well
This card void if drilling not started within six (6) months of date received by K.C.C.

MAR 15 2004

KCC WICHITA

A Regular Section of Land
1 Mile = 5,280 Ft.

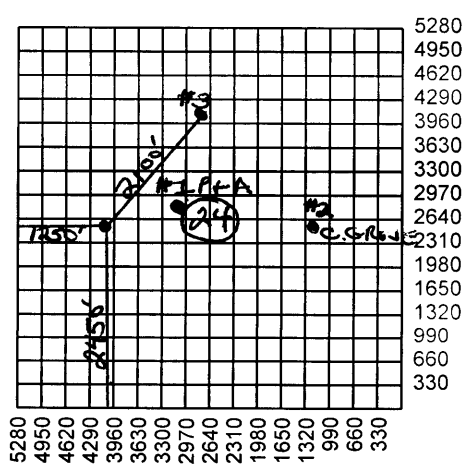

- Important procedures to follow:
1. Notify District office before setting surface casing.
 2. Set surface casing by circulating cement to the top.
 3. File completion forms ACO-1 with K.C.C. within 120 days of well spud date, following instructions on ACO-1, side I, and including copies of wireline logs.
 4. Notify District office 48 hours prior to old well workover or re-entry.
 5. Submit plugging report (CP-4) to K.C.C. after plugging is completed.
 6. If an alternate 2 completion, cement in the production pipe from below any useable water to surface within 120 day of spud date.

State Corporation Commission of Kansas
Conservation Division
130 S. Market Room 2078
Wichita, Kansas 67202-1212
(316) 337-6231

24
31
40W
MOF TS F2