

For KCC Use: 3-1-04  
Effective Date: \_\_\_\_\_  
District # \_\_\_\_\_  
SGA?  Yes  No

KANSAS CORPORATION COMMISSION  
OIL & GAS CONSERVATION DIVISION

RECEIVED

KANSAS CORPORATION COMMISSION

Form C-1  
September 1999

NOTICE OF INTENT TO DRILL

FEB 23 2004

Form must be Typed  
Form must be Signed  
All blanks must be Filled

Must be approved by KCC five (5) days prior to commencing well

Ap - N/2 SE NW SW

CONSERVATION DIVISION  
WICHITA, KS

Expected Spud Date 03/05/04  
month / day year

Spot E/2 - NW - SW Sec. 6 Twp. 31 S. R. 11  East  West

1800 feet from (S) (circle one) Line of Section  
1000 feet from E / (W) (circle one) Line of Section

Is SECTION  Regular  Irregular?

(Note: Locate well on the Section Plat on reverse side)

County: Barber

Lease Name: Chain Ranch Well #: 2

Field Name: Wildcat - NURSE

Is this a Prorated / Spaced Field?  Yes  No

Target Formation(s): Mississippi

Nearest Lease or unit boundary: 1000'

Ground Surface Elevation: TBD feet MSL

Water well within one-quarter mile:  Yes  No

Public water supply well within one mile:  Yes  No

Depth to bottom of fresh water: 120 - 150'

Depth to bottom of usable water: 180'

Surface Pipe by Alternate: X 1 2

Length of Surface Pipe Planned to be set: 250'

Length of Conductor Pipe required: none

Projected Total Depth: 4600'

Formation at Total Depth: Mississippi

Water Source for Drilling Operations:

Well  Farm Pond  Other

DWR Permit #: \_\_\_\_\_

(Note: Apply for Permit with DWR )

Will Cores be taken?  Yes  No

If Yes, proposed zone: \_\_\_\_\_

OPERATOR: License# 32821  
Name: TRI-EX Petroleum, LP  
Address: 6051 N. Brookline, Suite 111B  
City/State/Zip: Oklahoma City, OK 73112  
Contact Person: Gary Wurdeman  
Phone: 405-767-0785

CONTRACTOR: License# 5123  
Name: Pickrell Drilling Co.

Well Drilled For:  Oil  Enh Rec  Gas  Storage  O/WO  Disposal  Seismic; # of Holes \_\_\_\_\_  Other \_\_\_\_\_  
Well Class:  Infield  Pool Ext.  Wildcat  Other \_\_\_\_\_  
Type Equipment:  Mud Rotary  Air Rotary  Cable

If OWWO: old well information as follows:

Operator: \_\_\_\_\_

Well Name: \_\_\_\_\_

Original Completion Date: \_\_\_\_\_ Original Total Depth: \_\_\_\_\_

Directional, Deviated or Horizontal wellbore?  Yes  No

If Yes, true vertical depth: \_\_\_\_\_

Bottom Hole Location: \_\_\_\_\_

KCC DKT #: \_\_\_\_\_

AFFIDAVIT

The undersigned hereby affirms that the drilling, completion and eventual plugging of this well will comply with K.S.A. 55-101, et. seq.

It is agreed that the following minimum requirements will be met:

1. Notify the appropriate district office **prior** to spudding of well;
2. A copy of the approved notice of intent to drill **shall be** posted on each drilling rig;
3. The minimum amount of surface pipe as specified below **shall be set** by circulating cement to the top; in all cases surface pipe **shall be set** through all unconsolidated materials plus a minimum of 20 feet into the underlying formation.
4. If the well is dry hole, an agreement between the operator and the district office on plug length and placement is necessary **prior to plugging**;
5. The appropriate district office will be notified before well is either plugged or production casing is cemented in;
6. If an ALTERNATE II COMPLETION, production pipe shall be cemented from below any usable water to surface within **120 days** of spud date. **In all cases, NOTIFY district office** prior to any cementing.

I hereby certify that the statements made herein are true and to the best of my knowledge and belief.

Date: 02/20/04 Signature of Operator or Agent: [Signature] Title: Partner / Engineer

For KCC Use ONLY  
API # 15 - 007 - 22809-0000  
Conductor pipe required NONE feet  
Minimum surface pipe required 200 feet per Alt. (1)  
Approved by: RJP 2-25-04  
This authorization expires: 8-25-04  
(This authorization void if drilling not started within 6 months of effective date.)  
Spud date: \_\_\_\_\_ Agent: \_\_\_\_\_

Remember to:

- File Drill Pit Application (form CDP-1) with Intent to Drill;
- File Completion Form ACO-1 within 120 days of spud date;
- File acreage attribution plat according to field proration orders;
- Notify appropriate district office 48 hours prior to workover or re-entry;
- Submit plugging report (CP-4) after plugging is completed;
- Obtain written approval before disposing or injecting salt water.

Mail to: KCC - Conservation Division, 130 S. Market - Room 2078, Wichita, Kansas 67202

6  
31  
113

FEB 23 2004

**IN ALL CASES PLOT THE INTENDED WELL ON THE PLAT BELOW**

*Plat of acreage attributable to a well in a prorated or spaced field*

CONSERVATION DIVISION  
WICHITA, KS

**If the intended well is in a prorated or spaced field, please fully complete this side of the form.** If the intended well is in a prorated or spaced field complete the plat below showing that the well will be properly located in relationship to other wells producing from the common source of supply. Please show all the wells and within 1 mile of the boundaries of the proposed acreage attribution unit for gas wells and within 1/2 mile of the boundaries of the proposed acreage attribution unit for oil wells.

API No. 15 - \_\_\_\_\_  
Operator: TRI-EX Petroleum, LP  
Lease: Chain Ranch  
Well Number: 2  
Field: Wildcat

Number of Acres attributable to well: \_\_\_\_\_  
QTR / QTR / QTR of acreage: E/2 - NW - SW

Location of Well: County: Barber  
\_\_\_\_\_ feet from (S) (N) (circle one) Line of Section  
1800  
\_\_\_\_\_ feet from (E) (W) (circle one) Line of Section  
1000  
Sec. 6 Twp. 31 S. R. 11  East  West

Is Section  Regular or \_\_\_\_\_ Irregular

**If Section is Irregular, locate well from nearest corner boundary.**

Section corner used: \_\_\_NE \_\_\_NW \_\_\_SE \_\_\_SW

**PLAT**

*(Show location of the well and shade attributable acreage for prorated or spaced wells.)*

*(Show footage to the nearest lease or unit boundary line.)*

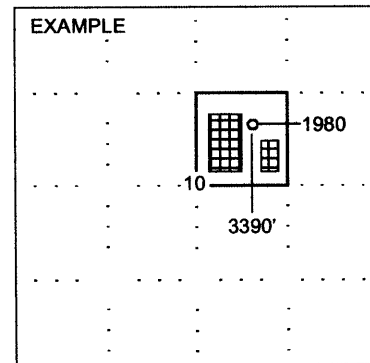
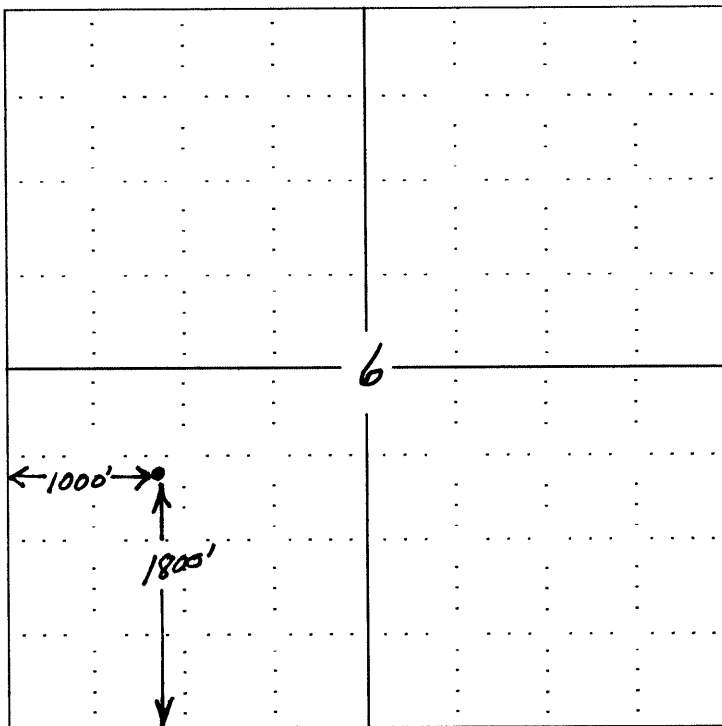

SEWARD CO.

**NOTE: In all cases locate the spot of the proposed drilling locatlon.**

**In plotting the proposed location of the well, you must show:**

1. The manner in which you are using the depicted plat by identifying section lines, i.e. 1 section, 1 section with 8 surrounding sections, 4 sections, etc.
2. The distance of the proposed drilling location from the section's south / north and east / west.
3. The distance to the nearest lease or unit boundary line.
4. If proposed location is located within a prorated or spaced field a certificate of acreage attribution plat must be attached: (CO-7 for oil wells; CG-8 for gas wells).



# KANSAS

CORPORATION COMMISSION

KATHLEEN SEBELIUS, GOVERNOR

BRIAN J. MOLINE, CHAIR

JOHN WINE, COMMISSIONER

ROBERT E. KREHBIEL, COMMISSIONER

February 25, 2004

Mr. Gary Wurdeman  
Tri-Ex Petroleum, LP  
6051 N. Brookline Ste 111B  
Oklahoma City, OK 73112

RE: Drilling Pit Application  
Chain Ranch Lease Well No. 2  
SW/4 Sec. 06-31S-11W  
Barber County, Kansas

Dear Mr. Wurdeman:

District staff has inspected the above referenced location and has determined that the reserve pit shall be constructed **without slots**, the bottom shall be flat and reasonably level, and the free fluids must be removed. The fluids are to be removed from the reserve pit as soon as the Hutchinson Salt section has been drilled through and displacement of the fluids into the reserve pit has occurred. The fluids should be removed again as soon as practical after drilling operations have ceased.

**If production casing is set all completion fluids shall be removed on a daily basis.**

The fluids should be taken to an authorized disposal well. Please call the District Office at (620) 225-8888 when the fluids have been removed. Also please file the enclosed CDP-5 form, Surface Pond Waste Transfer, within 30 days of fluid removal.

**A copy of this letter should be posted in the doghouse along with the approved Intent to Drill.**

If you have any questions or concerns please feel free to contact the undersigned at the above address.

Sincerely,



Kathleen Haynes

Environmental Protection and Remediation Department

cc: S Durrant