

OWWO

RECEIVED

For KCC Use:

KANSAS CORPORATION COMMISSION
OIL & GAS CONSERVATION DIVISION

MAR 17 2004

Form C-1
September 1999

Effective Date: _____

District # _____

SGA? Yes No

NOTICE OF INTENT TO DRILL

Must be approved by KCC five (5) days prior to commencing well

KCC WICHITA

Form must be Typed
Form must be Signed
All blanks must be Filled

Expected Spud Date April 16, 2004
month day year

Spot East
SW - NE - SE Sec. 13 Twp. 28 S. R. 06 West

OPERATOR: License# 5214

1650 feet from (S) / N (circle one) Line of Section
990 feet from (E) W (circle one) Line of Section

Name: Lario Oil & Gas Company

Is SECTION Regular Irregular?

Address: 301 South Market

(Note: Locate well on the Section Plat on reverse side)

City/State/Zip: Wichita, KS 67202

County: Kingman

Contact Person: Jay G. Schweikert

Lease Name: Clouse Well #: 4 RE/SWD

Phone: 316-265-5611

Field Name: Wildcat HEDRICK

CONTRACTOR: License# 5123

Is this a Prorated / Spaced Field? Yes No

Name: Pickrell Drilling Co., Inc.

Target Formation(s): Arbuckle

- | | | |
|--|--|--|
| Well Drilled For: | Well Class: | Type Equipment: |
| <input type="checkbox"/> Oil | <input type="checkbox"/> Enh Rec | <input checked="" type="checkbox"/> Mud Rotary |
| <input type="checkbox"/> Gas | <input type="checkbox"/> Storage | <input type="checkbox"/> Air Rotary |
| <input checked="" type="checkbox"/> OWWO | <input checked="" type="checkbox"/> Disposal | <input type="checkbox"/> Cable |
| <input type="checkbox"/> Seismic; # of Holes _____ | <input checked="" type="checkbox"/> Other | |
| <input type="checkbox"/> Other _____ | | |

Nearest Lease or unit boundary: 1650 ft

Ground Surface Elevation: 1448 feet MSL

Water well within one-quarter mile: Yes No

Public water supply well within one mile: Yes No

Depth to bottom of fresh water: 45 ft ISO

Depth to bottom of usable water: 180 ft

Surface Pipe by Alternate: X 1 2

Length of Surface Pipe Planned to be set: already set 10-3/4" @ 292 ft

Length of Conductor Pipe required: NA

Projected Total Depth: 4700 ft

Formation at Total Depth: Arbuckle

Water Source for Drilling Operations:
Well _____ Farm Pond X Other _____

DWR Permit #: _____

(Note: Apply for Permit with DWR)

Will Cores be taken? Yes No

If Yes, proposed zone: _____

If OWWO: old well information as follows:
Operator: Lario Oil & Gas Co.
Well Name: Clouse #4
Original Completion Date: 10/08/58 Original Total Depth: 3969

Directional, Deviated or Horizontal wellbore? Yes No

If Yes, true vertical depth: _____

Bottom Hole Location: _____

KCC DKT #: _____

AFFIDAVIT

The undersigned hereby affirms that the drilling, completion and eventual plugging of this well will comply with K.S.A. 55-101, et. seq.
It is agreed that the following minimum requirements will be met:

1. Notify the appropriate district office **prior** to spudding of well;
2. A copy of the approved notice of intent to drill **shall be** posted on each drilling rig;
3. The minimum amount of surface pipe as specified below **shall be set** by circulating cement to the top; in all cases surface pipe **shall be set** through all unconsolidated materials plus a minimum of 20 feet into the underlying formation.
4. If the well is dry hole, an agreement between the operator and the district office on plug length and placement is necessary **prior to plugging**;
5. The appropriate district office will be notified before well is either plugged or production casing is cemented in;
6. If an ALTERNATE II COMPLETION, production pipe shall be cemented from below any usable water to surface within **120 days** of spud date. **In all cases, NOTIFY district office** prior to any cementing.

I hereby certify that the statements made herein are true and to the best of my knowledge and belief.

Date: 3/16/04 Signature of Operator or Agent: Jay G. Schweikert Title: Operations Engineer
Jay G. Schweikert

For KCC Use ONLY

API # 15 - 095-01551-00-01

Conductor pipe required NONE feet

Minimum surface pipe required 292' set feet per Alt. (1)

Approved by: RJP 3-17-04

This authorization expires: 9-17-04
(This authorization void if drilling not started within 6 months of effective date.)

Spud date: _____ Agent: _____

- Remember to:**
- File Drill Pit Application (form CDP-1) with Intent to Drill;
 - File Completion Form ACO-1 within 120 days of spud date;
 - File acreage attribution plat according to field proration orders;
 - Notify appropriate district office 48 hours prior to workover or re-entry;
 - Submit plugging report (CP-4) after plugging is completed;
 - Obtain written approval before disposing or injecting salt water.

13
28
low

Mail to: KCC - Conservation Division, 130 S. Market - Room 2078, Wichita, Kansas 67202

IN ALL CASES PLOT THE INTENDED WELL ON THE PLAT BELOW

Plat of acreage attributable to a well in a prorated or spaced field

If the intended well is in a prorated or spaced field, please fully complete this side of the form. If the intended well is in a prorated or spaced field complete the plat below showing that the well will be properly located in relationship to other wells producing from the common source of supply. Please show all the wells and within 1 mile of the boundaries of the proposed acreage attribution unit for gas wells and within 1/2 mile of the boundaries of the proposed acreage attribution unit for oil wells.

API No. 15 - _____
 Operator: Lario Oil & Gas Company
 Lease: Clouse
 Well Number: 4 RE/SWD
 Field: Broadway
 Number of Acres attributable to well: 0
 QTR / QTR / QTR of acreage: SW - NE - SE

Location of Well: County: Kingman
 _____ 1650 feet from (S) / N (circle one) Line of Section
 _____ 990 feet from (E) / W (circle one) Line of Section
 Sec. 13 Twp. 28 S. R. 06 East West

Is Section Regular or _____ Irregular
If Section is Irregular, locate well from nearest corner boundary.
 Section corner used: ___NE ___NW ___SE ___SW

PLAT

*(Show location of the well and shade attributable acreage for prorated or spaced wells.)
 (Show footage to the nearest lease or unit boundary line.)*

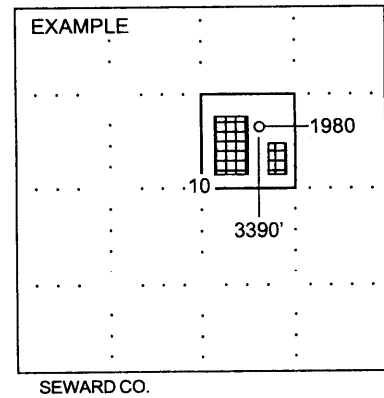
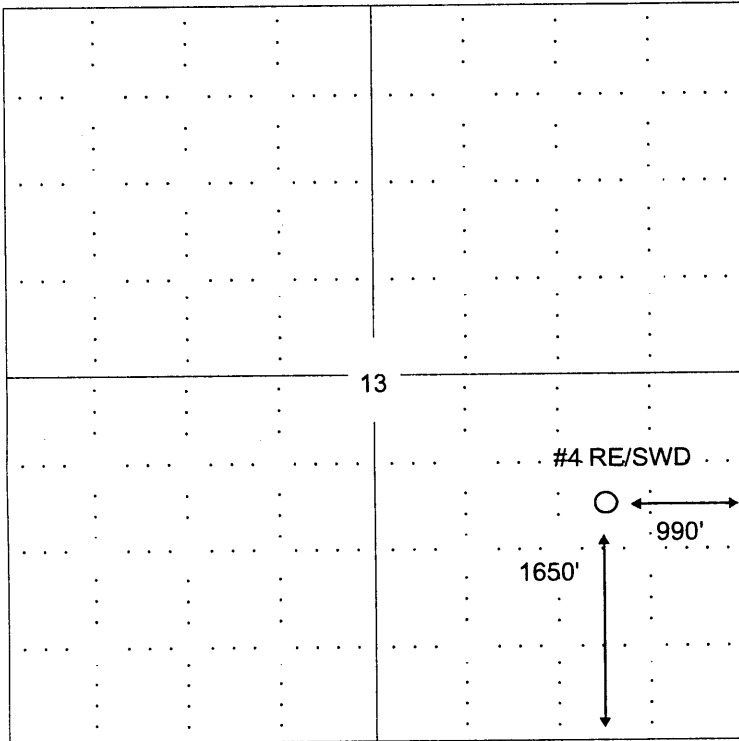

NOTE: In all cases locate the spot of the proposed drilling locaton.

In plotting the proposed location of the well, you must show:

1. The manner in which you are using the depicted plat by identifying section lines, i.e. 1 section 1 section with 8 surrounding sections, 4 sections, etc.
2. The distance of the proposed drilling location from the section's south / north and east / west.
3. The distance to the nearest lease or unit boundary line.
4. If proposed location is located within a prorated or spaced field a certificate of acreage attribution plat must be attached: (C0-7 for oil wells; CG-8 for gas wells).