

For KCC Use: 3-7-04
Effective Date: _____
District # _____
SGA? Yes No

KANSAS CORPORATION COMMISSION RECEIVED
OIL & GAS CONSERVATION DIVISION

Form C-1

December 2002

Form must be Typed

Form must be Signed

All blanks must be Filled

NOTICE OF INTENT TO DRILL

MAR 01 2004

KCC WICHITA

Must be approved by KCC five (5) days prior to commencing well

Expected Spud Date 03/23/04
month day year

Spot _____ East
C - SE - SW Sec. 20 Twp. 30 S. R. 18 West

OPERATOR: License# 5363
Name: BEREXCO INC.
Address: PO BOX 20380
City/State/Zip: WICHITA, KS 67208
Contact Person: GARY MISAK
Phone: 316-265-3311

_____ feet from N / S Line of Section
_____ feet from E / W Line of Section
Is SECTION Regular _____ Irregular?

(Note: Locate well on the Section Plat on reverse side)

CONTRACTOR: License# 5929
Name: DUKE DRILLING Co. Inc.

County: KIOWA
Lease Name: TAVES Well #: 3-20
Field Name: ALFORD

Is this a Prorated / Spaced Field? Yes No
Target Formation(s): MISSISSIPPI

Nearest Lease or unit boundary: 660 (SOUTH)
Ground Surface Elevation: 2167 feet MSL

Water well within one-quarter mile: Yes No
Public water supply well within one mile: Yes No

Depth to bottom of fresh water: 260
Depth to bottom of usable water: 280

Surface Pipe by Alternate: 1 2
Length of Surface Pipe Planned to be set: 770'

Length of Conductor Pipe required: 55'
Projected Total Depth: 5200'

Formation at Total Depth: MISSISSIPPI
Water Source for Drilling Operations:

Well Farm Pond Other _____
DWR Permit #: _____

(Note: Apply for Permit with DWR)

Will Cores be taken? Yes No
If Yes, proposed zone: _____

Well Drilled For: Well Class: Type Equipment:
 Oil Enh Rec Infield Mud Rotary
 Gas Storage Pool Ext. Air Rotary
 OWWO Disposal Wildcat Cable
 Seismic; # of Holes Other
 Other _____

If OWWO: old well information as follows:

Operator: _____
Well Name: _____
Original Completion Date: _____ Original Total Depth: _____

Directional, Deviated or Horizontal wellbore? Yes No

If Yes, true vertical depth: _____

Bottom Hole Location: _____

KCC DKT #: _____

AFFIDAVIT

The undersigned hereby affirms that the drilling, completion and eventual plugging of this well will comply with K.S.A. 55 et. seq.

It is agreed that the following minimum requirements will be met:

1. Notify the appropriate district office **prior** to spudding of well;
2. A copy of the approved notice of intent to drill **shall be** posted on each drilling rig;
3. The minimum amount of surface pipe as specified below **shall be set** by circulating cement to the top; in all cases surface pipe **shall be set** through all unconsolidated materials plus a minimum of 20 feet into the underlying formation.
4. If the well is dry hole, an agreement between the operator and the district office on plug length and placement is necessary **prior to plugging**;
5. The appropriate district office will be notified before well is either plugged or production casing is cemented in;
6. If an ALTERNATE II COMPLETION, production pipe shall be cemented from below any usable water to surface within **120 days** of spud date. Or pursuant to Appendix "B" - Eastern Kansas surface casing order #133,891-C, which applies to the KCC District 3 area, alternate II cementing must be completed within 30 days of the spud date or the well shall be plugged. **In all cases, NOTIFY district office** prior to any cementing.

I hereby certify that the statements made herein are true and to the best of my knowledge and belief.

Date: 02/26/04 Signature of Operator or Agent: Gary Misak Title: DISTRICT ENGINEER

For KCC Use ONLY

API # 15 - 097-21538-00-00
Conductor pipe required NONE feet
Minimum surface pipe required 300 feet per Alt. 1
Approved by: RJP 3-2-04
This authorization expires: 9-2-04
(This authorization void if drilling not started within 6 months of effective date.)
Spud date: _____ Agent: _____

Remember to:

- File Drill Pit Application (form CDP-1) with Intent to Drill;
- File Completion Form ACO-1 within 120 days of spud date;
- File acreage attribution plat according to field proration orders;
- Notify appropriate district office 48 hours prior to workover or re-entry;
- Submit plugging report (CP-4) after plugging is completed;
- Obtain written approval before disposing or injecting salt water.
- If this permit has expired (See: authorized expiration date) please check the box below and return to the address below.

Well Not Drilled - Permit Expired
Signature of Operator or Agent: _____
Date: _____

Mail to: KCC - Conservation Division, 130 S. Market - Room 2078, Wichita, Kansas 67202

20 30 18w

IN ALL CASES PLOT THE INTENDED WELL ON THE PLAT BELOW

Plat of acreage attributable to a well in a prorated or spaced field

If the intended well is in a prorated or spaced field, please fully complete this side of the form. If the intended well is in a prorated or spaced field complete the plat below showing that the well will be properly located in relationship to other wells producing from the common source of supply. Please show all the wells and within 1 mile of the boundaries of the proposed acreage attribution unit for gas wells and within 1/2 mile of the boundaries of the proposed acreage attribution unit for oil wells.

API No. 15 - _____
Operator: BEREXCO INC.
Lease: TAVES
Well Number: 3-20
Field: ALFORD
Number of Acres attributable to well: _____
QTR / QTR / QTR of acreage: _____

Location of Well: County: KIOWA
660 feet from N / S Line of Section
1980 feet from E / W Line of Section
Sec. 20 Twp. 30 S. R. 18 East West

Is Section: Regular or Irregular

If Section is Irregular, locate well from nearest corner boundary.
Section corner used: NE NW SE SW

PLAT

*(Show location of the well and shade attributable acreage for prorated or spaced wells.)
(Show footage to the nearest lease or unit boundary line.)*

RECEIVED

MAR 01 2004

KCC WICHITA

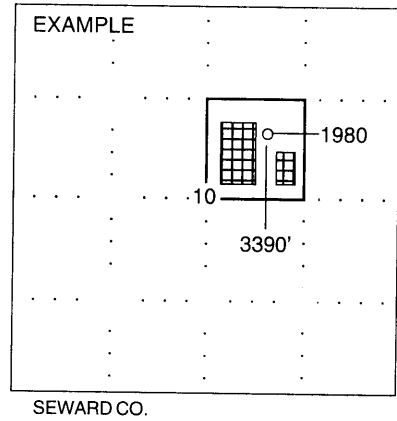
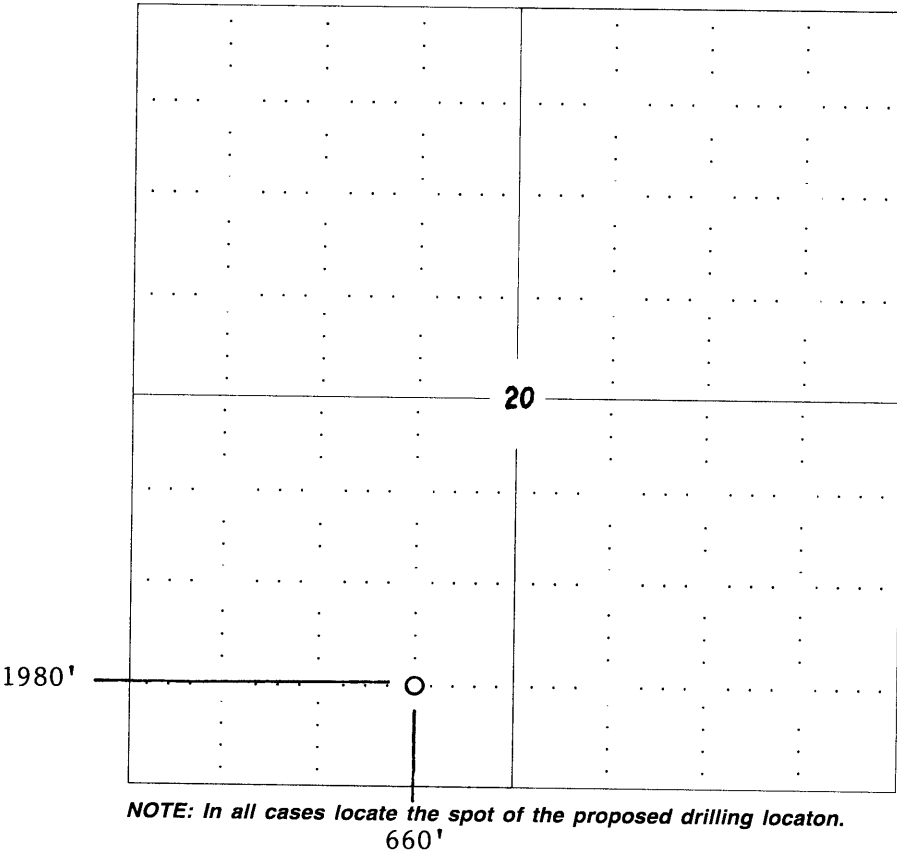

NOTE: In all cases locate the spot of the proposed drilling location.

In plotting the proposed location of the well, you must show:

1. The manner in which you are using the depicted plat by identifying section lines, i.e. 1 section, 1 section with 8 surrounding sections, 4 sections, etc.
2. The distance of the proposed drilling location from the section's south / north and east / west.
3. The distance to the nearest lease or unit boundary line.
4. If proposed location is located within a prorated or spaced field a certificate of acreage attribution plat must be attached: (CO-7 for oil wells; CG-8 for gas wells).