

PERMIT Extension

For KCC Use:

Effective Date: 10.8.03

District #

SGA? Yes No

Expected Spud Date 10/28/03 month day year

OPERATOR: License # 5447

Name: OXY USA Inc.

Address: P.O. Box 2528

City/State/Zip: Liberal, KS 67905

Contact Person: Vicki Carder

Phone: (620) 629-4242

CONTRACTOR: License # Must be lic. w/ KCC

Name: Will Advise on ACO-1

Well Drilled For: Well Class: Type Equipment:

Oil Enh Rec Infield Mud Rotary

Gas Storage Pool Ext Air Rotary

OWWO Disposal Wildcat Cable

Seismic: # of Holes Other Replacement Well

Other

If OWWO: old well information as follows:

Operator:

Well Name:

Original Completion Date: Original Total Depth:

Directional, Deviated or Horizontal wellbore? Yes No

If Yes, true vertical depth

Bottom Hole Location

KCC DKT #:

(Corrected API County Code)

AFFIDAVIT

The undersigned hereby affirms that the drilling, completion and eventual plugging of this well will comply with K.S.A. 55-101, et. Seq. It is agreed that the following minimum requirements will be met:

- 1. Notify the appropriate district office prior to spudding of well;
2. A copy of the approved notice of intent to drill shall be posted on each drilling rig;
3. The minimum amount of surface pipe as specified below shall be set by circulating cement to the top; in all cases surface pipe shall be set through all unconsolidated materials plus a minimum of 20 feet into the underlying formation.
4. If the well is dry hole, an agreement between the operator and the district office on plug length and placement is necessary prior to plugging;
5. The appropriate district office will be notified before well is either plugged or production casing is cemented in;
6. If an ALTERNATE II COMPLETION, production pipe shall be cemented from below any usable water to surface within 120 days of spud date. Or pursuant to Appendix "B" - Eastern Kansas surface casing order #133,891-C, which applies to the KCC District 3 area, alternate II cementing must be completed within 30 days of the spud date or the well shall be plugged. In all cases, NOTIFY district office prior to any cementing.

I hereby certify that the statements made herein are true and to the best of my knowledge and belief.

Date: September 22, 2003 Signature of Operator or Agent: Vicki Carder Title: Capital Project

For KCC Use ONLY

API # 15 - 067-21556-00-00

Conductor pipe required NONE feet

Minimum Surface pipe required 740 feet per Alt.

Approved by: RJP 10.3-03 / RJP 10.6-03

This authorization expires: 4.3-04 / 10-3-2004 RJP

(This authorization void if drilling not started within 6 months of effective date.)

Spud date: Agent:

Remember to:

- File Drill Pit Application (form CDP-1) with Intent to Drill;
- File Completion Form ACO-1 within 120 days of spud date;
- File acreage attribution plat according to field proaction orders;
- Notify appropriate district office 48 hours prior to workover or re-entry;
- Submit plugging report (CP-4) after plugging is completed;
- Obtain written approval before disposing or injecting salt water.
If this permit has expired (see: authorized expiration date) please check the box below and return to the address below.

Well Not Drilled - Permit Expired

Signature of Operator or Agent:

Date:

Mail to: KCC - Conservation Division, 130 S. Market - Room 2078, Wichita, Kansas 67202

Replacement Panoma Well KANSAS CORPORATION COMMISSION OIL & GAS CONSERVATION DIVISION NOTICE OF INTENT TO DRILL

Must be approved by KCC five (5) days prior to commencing work

RECEIVED CORRECTED

Form C-1

December 2002

Form must be Typed

Form must be signed

All blanks must be Filled

Spot: SE SE - NW - NW Sec. 23 Twp. 28S R. 35

1250 feet from N / S Line of Section

1250 feet from E / W Line of Section

Is SECTION Regular Irregular?

(Note: Locate well on the Section Plat on reverse side)

County: Grant

Lease Name: McCandless A Well #: 5

Field Name: Panoma Council Grove

Is this a Prorated / Spaced Field? Yes No

Target Formation(s): Council Grove

Nearest Lease or unit Boundary: 1250'

Ground Surface Elevation: 3038 feet MSL

Water well within one-quarter mile Yes No

Public water supply well within one mile: Yes No

Depth to bottom of fresh water: 435

Depth to bottom of usable water: 720

Surface Pipe by Alternate: 1 2

Length of Surface Pipe Planned to be set: 800

Length of Conductor Pipe Required:

Projected Total Depth: 3100

Formation at Total Depth: Council Grove

Water Source for Drilling Operations:

Well Farm Pond Other X

DWR Permit #

(Note: Apply for Permit with DWR)

Will Cores be Taken? Yes No

If Yes, Proposed zone:

WAS: 15-065

IS: 15067

Permit Extension Request Received 3-26-04

23 28 35

IN ALL CASES PLOT THE INTENDED WELL ON THE PLAT BELOW

Plat of acreage attributable to a well in a prorated or spaced field

If the intended well is in a prorated or spaced field, please fully complete this side of the form. If the intended well is in a prorated or spaced field complete the plat below showing that the well will be properly located in relationship to other wells producing from the common source of supply. Please show all the wells and within 1 mile of the boundaries of the proposed acreage attribution unit for gas wells and within 1/2 mile of the boundaries of the proposed acreage attribution unit for oil wells.

API No. 15 - _____
 Operator: OXY USA Inc.
 Lease: McCandless A
 Well Number: 5
 Field: Panoma Council Grove

Location of Well: County _____ Grant _____
 _____ 1250 _____ feet from N / S Line of Section
 _____ 1250 _____ feet from E / W Line of Section
 Sec. 23 Twp. 28S R. 35 East West

Number of Acres attributable to well: 640
 QTR / QTR / QTR of acreage: SE - NW - NW

Is Section Regular or Irregular

IF Section is Irregular, locate well from nearest corner boundary.

Section corner used: NE NW SE SW

PLAT

(Show location of the well and shade attributable acreage for prorated or spaced wells.)

(Show footage to the nearest lease or unit boundary line.)

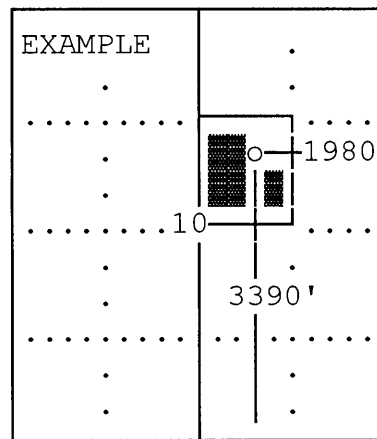
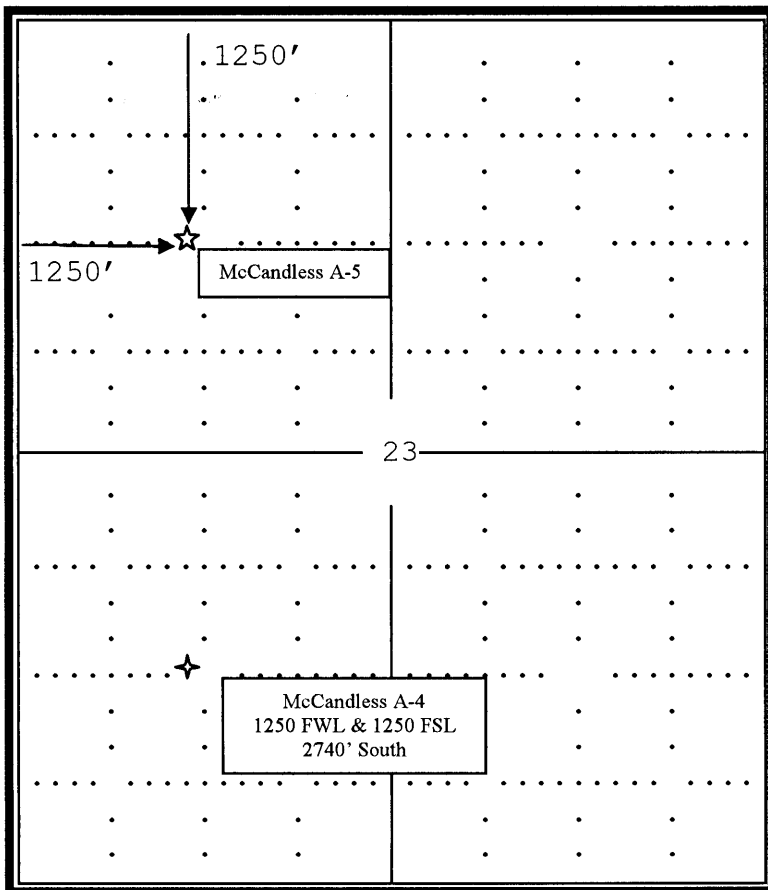

SEWARD CO.

Note: In all cases locate the spot of the proposed drilling location.

Grant County

In plotting the proposed location of the well, you must show:

1. The manner in which you are using the depicted plat by identifying section lines, i.e. 1 section, 1 section with 8 surrounding sections, 4 sections, etc.
2. The distance of the proposed drilling location from the sections south / north and east / west.
3. The distance to the nearest lease or unit boundary line.
4. If proposed location is located within a prorated or spaced field a certificate of acreage attribution plat must be attached: (CO-7 for oil wells; CG-8 for gas wells).