

Give All Information Completely
Make Required Affidavit
Mail or Deliver Report to:
Conservation Division
State Corporation Commission
800 Bitting Building
Wichita, Kansas

Norton County, Sec. 18 Twp. 1 Rge. (E) 22 (W)

Location as "NE/CNW%SW%" or footage from lines NE NE SE

Lease Owner Jones, Shelburne & Farmer, Inc.

Lease Name Keene Well No. #1

Office Address Russell, Kansas

Character of Well (completed as Oil, Gas or Dry Hole) Dry

Date well completed August 18 19 54

Application for plugging filed August 18 19 54

Application for plugging approved August 18 19 54

Plugging commenced August 18 19 54

Plugging completed August 18 19 54

Reason for abandonment of well or producing formation Never Produced

If a producing well is abandoned, date of last production _____ 19 _____

Was permission obtained from the Conservation Division or its agents before plugging was commenced? Yes

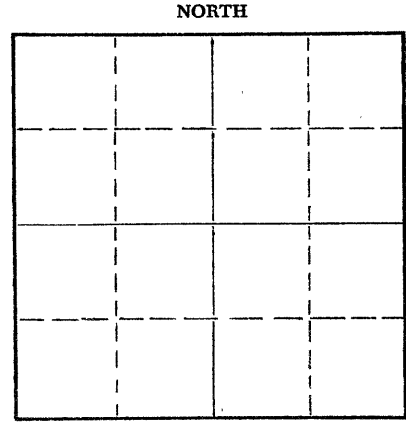

Locate well correctly on above Section Plat

Name of Conservation Agent who supervised plugging of this well Mr. Horner

Producing formation _____ Depth to top _____ Bottom _____ Total Depth of Well 3710 Feet

Show depth and thickness of all water, oil and gas formations.

OIL, GAS OR WATER RECORDS

CASING RECORD

FORMATION	CONTENT	FROM	TO	SIZE	PUT IN	PULLED OUT
				8 5/8	290	None

Describe in detail the manner in which the well was plugged, indicating where the mud fluid was placed and the method or methods used in introducing it into the hole. If cement or other plugs were used, state the character of same and depth placed, from _____ feet to _____ feet for each plug set.

1. Filled hole with heavy mud.
2. Pushed plug to 285'.
3. Dumped 1/2 sack hulls on top of plug.
4. Mixed 15 sacks cement and dumped on top of hulls.
5. Filled hole to top.
6. Pushed plug to 40'.
7. Dumped in 1/2 sack hulls.
8. Mixed 10 sack cement and filled hole to top with same.

RECEIVED
CONSERVATION DIVISION
WICHITA, KANSAS
AUG 25 1954

(If additional description is necessary, use BACK of this sheet)

Name of Plugging Contractor Jones, Shelburne & Farmer, Inc. Aug 25, 1954
Address Russell, Kansas

STATE OF Kansas, COUNTY OF Russell, ss.
John O. Farmer (employee of owner) or (owner or operator) of the above-described

well, being first duly sworn on oath, says: That I have knowledge of the facts, statements, and matters herein contained and the log of the above-described well as filed and that the same are true and correct. So help me God.

(Signature) John O. Farmer
Russell, Kansas
(Address)

SUBSCRIBED AND SWORN TO before me this 24 day of August, 1954

My commission expires 9-30-54 Peta C. King Notary Public.

PLUGGING
FILE SEC. 27, 15, 14W
BOOK PAGE 38 LINE 14

OPERATOR Jones, Shelburne & Farmer, Inc.

FORMATION RECORD

ADDRESS Russell, Kansas

Give detailed description and thickness of all formations drilled through, contents of sand, whether dry, water, oil or gas.

FARM NAME Keene WELL NO. #1 COUNTY Norton SEC. 18, TWP. 1, RGE. 22

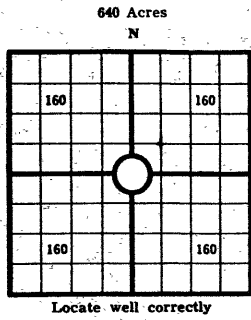

COUNTY Norton SEC. 18 TWP. 1 RGE. 22
 COMPANY OPERATING Jones, Shelburne & Farmer, Inc.
 OFFICE ADDRESS Russell, Kansas
 FARM NAME Keene WELL NO. #1
 DRILLING STARTED 8-9, 1954 DRILLING FINISHED 8/18, 1954
 DATE OF FIRST PRODUCTION _____ COMPLETED _____
 WELL LOCATED NE 1/4 NE 1/4 SE 1/4, North of South
 Line and _____ ft. East of West Line of Quarter Section
 Elevation (Relative to sea level) DERRICK FLOOR 2393 GROUND _____
 CHARACTER OF WELL (Oil, gas or dryhole) Dry

Formation	Top	Bottom	Formation	Top	Bottom
Surface	0	230			
Shale & Shells	230	715			
Shale & Sand	715	1570			
Sand	1570	1720			
Red Bed	1720	1950			
Anhydrite	1950	1980			
Shale & Shells	1980	2500			
Lime & Shale	2500	3710			

PLUGGING
 FILE SEC. 27, T. 15, R. 14
 BOOK PAGE 51 LINE 4

15-137-00118-00-00

TOPS:
 Elevation 2395 R. B
 Anhydrite 1920
 Heebner 3392
 Lansing 3434
 Granite Wash 3702
 Granite 3710
 T. D. 3710

RECEIVED
 STATE CORPORATION COMMISSION
 AUG 25 1954
 CONSERVATION DIVISION
 WICHITA, KANSAS

OIL OR GAS SANDS OR ZONES

Name	From	To	Name	From	To
1			4		
2			5		
3			6		

Perforating Record If Any

Formation	From	To	No. of Shots	Formation	From	To	Size of Shot

CASING RECORD

Amount Set						Amount Pulled		Packer Record	
Size	Wt.	Thds.	Make	Ft.	In.	Size	Length	Depth Set	Make
8 5/8				230					

Liner Record: Amount _____ Kind _____ Top _____ Bottom _____

CEMENTING AND MUDDING

Size	Amount Set		Sacks Cement	Chemical		Method of Cementing	Amount	Mudding Method	Results (See Note)
	Ft.	In.		Gal.	Make				
8 5/8	230		125						

Note: What method was used to protect sands if outer strings were pulled? _____

NOTE: Were bottom hole plugs used? _____ If so, state kind, depth set and results obtained _____

TOOLS USED

Rotary Tools were used from _____ feet to _____ feet to _____ feet, and from _____ feet to _____ feet, and from _____ feet to _____ feet.

Type Rig _____

INITIAL PRODUCTION TEST

Describe initial test: whether by flow through tubing or casing or by pumping _____

Amount of Oil Production _____ bbls. Size of choke, if any _____ Length of test _____ Water Production _____ bbls. Gravity of oil _____ Type of Pump if pump is used, describe _____

I, the undersigned, being first duly sworn upon oath, state that this well record is true, correct and complete according to the records of this office and to the best of my knowledge and belief.

John D. Farmer
 Name and title of representative of company

Subscribed and sworn to before me this 24 day of August, 1954
 My Commission expires 9-30-54
 Notary Public.