

STATE CORPORATION COMMISSION OF KANSAS
OIL & GAS CONSERVATION DIVISION
WELL COMPLETION OR RECOMPLETION FORM
ACO-1 WELL HISTORY
DESCRIPTION OF WELL AND LEASE

API NO. 15-039-20,800-00-00
County Decatur
NW SW SW Sec 17 Twp 1 Rge 26 East
West

Operator: License # 4629
Name Brito Oil Company
Address 200 E. First, #413
City/State/Zip Wichita, KS 67202

990 Ft North from Southeast Corner of Section
4950 Ft West from Southeast Corner of Section
(Note: Locate well in section plat below)

Purchaser

Lease Name Wiggins Well #

Operator Contact Person Raul Brito
Phone (316) 263-8787

Field Name

Producing Formation

Contractor: License # 5422
Name Abercrombie Drilling, Inc.

Elevation: Ground 2407 KB 2412

Wellsite Geologist
Phone

Designate Type of Completion
X New Well Re-Entry Workover
Oil SWD Temp Abd
Gas Inj Delayed Comp.
X Dry Other (Core, Water Supply etc.)

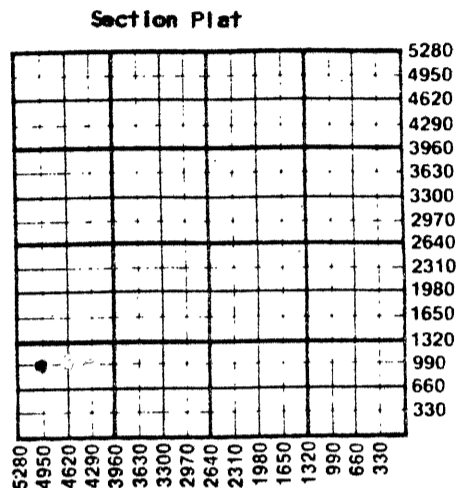

If ONWO: old well info as follows:
Operator
Well Name
Comp. Date Old Total Depth

Section Plat
WATER SUPPLY INFORMATION
Disposition of Produced Water: Disposal
Docket # Repressuring

WELL HISTORY

Drilling Method:
X Mud Rotary Air Rotary Cable
11-25-86 12-1-86 12-1-86
Spud Date Date Reached TD Completion Date
3500'
Total Depth PBTD

Questions on this portion of the ACO-1 call:
Water Resources Board (913) 296-3717
Source of Water:
Division of Water Resources Permit #
X Groundwater 1090 Ft North from Southeast Corner
(Well) 4950 Ft West from Southeast Corner of
Sec 17 Twp 1 Rge 26 East X West
Surface Water Ft North from Southeast Corner
(Stream, pond etc) Ft West from Southeast Corner
Sec Twp Rge East West
Other (explain) Dave Wilson
(purchased from city, R.W.D. #)
R.R. #1 Box 66, Danbury, NE 69206

Amount of Surface Pipe Set and Cemented at 268 feet
Multiple Stage Cementing Collar Used? Yes No
If yes, show depth set feet
If alternate 2 completion, cement circulated
from feet depth to w/ SX cmt
Cement Company Name
Invoice #

INSTRUCTIONS: This form shall be completed in triplicate and filed with the Kansas Corporation Commission, 200 Colorado Derby Building, Wichita, Kansas 67202, within 120 days of the spud date of any well. Rule 82-3-130, 82-3-107 and 82-3-106 apply. Information on side two of this form will be held confidential for a period of 12 months if requested in writing and submitted with the form. See rule 82-3-107 for confidentiality in excess of 12 months. One copy of all wireline logs and drillers time log shall be attached with this form. Submit CP-4 form with all plugged wells. Submit CP-111 form with all temporarily abandoned wells.

All requirements of the statutes, rules and regulations promulgated to regulate the oil and gas industry have been fully complied with and the statements herein are complete and correct to the best of my knowledge.

Signature

Title PRESIDENT Date 1-8-87

Subscribed and sworn to before me this 8th day of January, 1987

Notary Public Angela A. Kendall

Date Commission Expires 9-19-88

K.C.C. OFFICE USE ONLY
F Letter of Confidentiality Attached
C Wireline Log Received
C STATE CORPORATION COMMISSION
C Drillers Time Log Received
Distribution
KCC 8 1987 SWD/Rep NGPA
KGS Plug Other
CONSERVATION DIVISION (Specify)
Wichita, Kansas

ANGELA A. KENDALL
NOTARY PUBLIC
STATE OF KANSAS
My Appt. Exp. 9-19-88

Form ACO-1 (5-86)
Jan 8, 1987

Sec 18 Twp 1 Rge 26 W

SIDE TWO

Operator Name Brito Oil Company Lease Name Wiggins Well # 1

Sec. 17 Twp. 1 Rge. 26 East West County Decatur

WELL LOG

INSTRUCTIONS: Show important tops and base of formations penetrated. Detail all cores. Report all drill stem tests giving interval tested, time tool open and closed, flowing and shut-in pressures, whether shut-in pressure reached static level, hydrostatic pressures, bottom hole temperature, fluid recovery, and flow rates if gas to surface during test. Attach extra sheet if more space is needed. Attach copy of log.

Drill Stem Tests Taken Yes No
 Samples Sent to Geological Survey Yes No
 Cores Taken Yes No

Formation Description
 Log Sample

DST 1 -3143-3202: 154 MSW, 186' SW. 65-86#, 119-173#FP. 846-835#
 DST 2 3203-43: 3' Mud, 32-32#, 43-43#fp, 173-76#. DST 3 3240-85 1' osm, 21-21#, 21-21#FP, 43-323
 DST 4 3318-50: 1' Mud, 17-17#, 10-10#FP, 25-10#. DST 5 3347-80: 1' Mud, all Flows 20#, 30 -20#SIP

Name	Top	Bottom
Anhydrite	1870	
Heebner	3144	
Lansing	3191	
BKC	3392	
Granite Wash	3482	
Granite	3494	
RTD	3500	

CASING RECORD <input type="checkbox"/> New <input type="checkbox"/> Used Report all strings set-conductor, surface, intermediate, production, etc.							
Purpose of String	Size Hole Drilled	Size Casing Set (in O.D.)	Weight Lbs/Ft.	Setting Depth	Type of Cement	#Sacks Used	Type and Percent Additives
Surface	12-1/4	8-5/8	20	268	60/40 posm	x 200	2% gel, 3% ca.c.
PERFORATION RECORD				Acid, Fracture, Shot, Cement Squeeze Record			
Shots Per Foot	Specify Footage of Each Interval Perforated			(Amount and Kind of Material Used)			Depth
TUBING RECORD				Liner Run <input type="checkbox"/> Yes <input type="checkbox"/> No			
Date of First Production		Producing Method					
		<input type="checkbox"/> Flowing <input type="checkbox"/> Pumping <input type="checkbox"/> Gas Lift <input type="checkbox"/> Other (explain).....					
Estimated Production Per 24 Hours	Oil	Gas	Water	Gas-Oil Ratio	Gravity		
	Bbls	MCF	Bbls	CFPB			

METHOD OF COMPLETION

Production Interval

Disposition of gas: Vented Open Hole Perforation
 Sold Other (Specify).....
 Used on Lease Dually Completed
 Commingled

