

CARD MUST BE TYPED

State of Kansas
NOTICE OF INTENTION TO DRILL
(see rules on reverse side)

CARD MUST BE SIGNED

Starting Date: 5/10/85
month day year 4:00

API Number 15- 039-20,765-00-00

OPERATOR: License # 6875
Name Marmik Oil Co.
Address 910 16th St. #200
City/State/Zip Denver, CO 80202
Contact Person Curtis Morill
Phone 303-623-8016

C NE SW (location) Sec 15 Twp 1 S, Rge 26
1980 Ft North from Southeast Corner of Section
3300 Ft West from Southeast Corner of Section
(Note: Locate well on Section Plat on reverse side)

CONTRACTOR: License # 5381
Name Big Springs Drilling, Inc.
City/State Wichita, KS 67208

Nearest lease or unit boundary line 330 feet.
County Decatur
Lease Name Earnest Well# 1
Domestic well within 330 feet: yes no
Municipal well within one mile: yes no

Well Drilled For: Well Class: Type Equipment:
 Oil Swd Infield Mud Rotary
 Gas Inj Pool Ext. Air Rotary
 OWWO Expl Wildcat Cable

Depth to Bottom of fresh water 150 feet
Lowest usable water formation Dakota
Depth to Bottom of usable water 1500 1125 feet
Surface pipe by Alternate: 1 2
Surface pipe to be set 300 feet
Conductor pipe if any required feet
Ground surface elevation feet MSL
This Authorization Expires 11-7-85
Approved By 5-7-85 [Signature]

If OWWO: old well info as follows:

Operator
Well Name
Comp Date Old Total Depth
Projected Total Depth 3500 feet
Projected Formation at TD Pre-cambrian
Expected Producing Formations

I certify that we will comply with K.S.A. 55-101, et seq., plus eventually plugging hole to K.C.C. specifications.

Date 5/7/85 Signature of Operator or Agent [Signature] Title As Agent

**Must be filed with the K.C.C. five (5) days prior to commencing well
This card void if drilling not started within six (6) months of date received by K.C.C.**

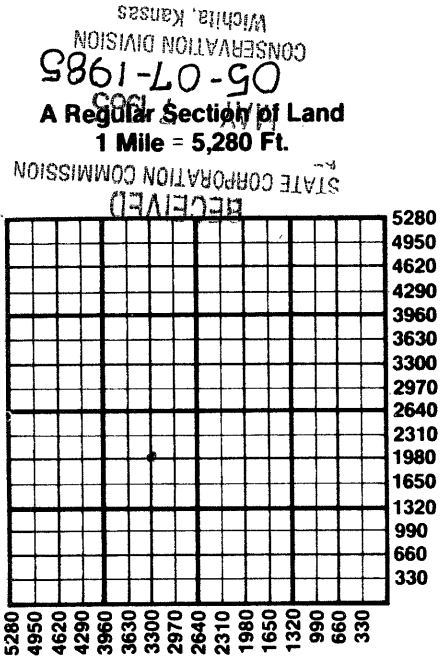

Important procedures to follow :

1. Notify District office before setting surface casing.
2. Set surface casing by circulating cement to the top.
3. File completion forms ACO-1 with K.C.C. within 90 days of well completion, following instructions on ACO-1, side 1, and including copies of wireline logs.
4. Notify District office 48 hours prior to old well workover or re-entry.
5. Prior to plugging, prepare a plugging plan, then obtain agreement from the appropriate district office for an approved plugging plan.
6. Submit plugging report (CP-4) to K.C.C. after plugging is completed.
7. Obtain an approved injection docket number before disposing of salt water.
8. Notify K.C.C. within 10 days when injection commences or terminates.
9. If an alternate 2 completion, cement in the production pipe from below any usable water to surface within 120 days of spud date.

**State Corporation Commission of Kansas
Conservation Division
200 Colorado Derby Building
Wichita, Kansas 67202
(316) 263-3238**