

KANSAS DRILLERS LOG

API No. 15 — 039 — 20,587-00-00
 County Number

S. 15 T. 1S R. 27W ^E/_W
 Loc. NW NW NE
 County Decatur

Operator
Thunderbird Drilling, Inc.

Address
P.O. Box 18407- Wichita, Kansas 67218

Well No. 1 Lease Name Huff "A"

Footage Location
 feet from (N) (S) line _____ feet from (E) (W) line _____

Principal Contractor Thunderbird Drilling, Inc. Geologist Paul Montoia

Spud Date 6/17/81 Total Depth 3470 P.B.T.D. _____

Date Completed 6/23/81 Oil Purchaser _____

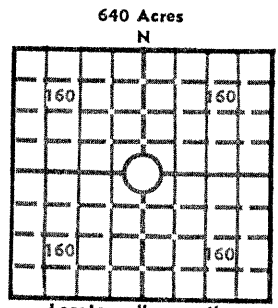

Elev.: Gr. 2554'
 DF _____ KB 2559'

CASING RECORD

Report of all strings set — surface, intermediate, production, etc.

Purpose of string	Size hole drilled	Size casing set (in O.D.)	Weight lbs/ft.	Setting depth	Type cement	Sacks	Type and percent additives
Surface	12 3/4	8 5/8"	24#	264'	com	200	2% gel, 3% cc.

LINER RECORD

PERFORATION RECORD

Top, ft.	Bottom, ft.	Sacks cement	Shots per ft.	Size & type	Depth interval

TUBING RECORD

Size	Setting depth	Packer set at

ACID, FRACTURE, SHOT, CEMENT SQUEEZE RECORD

Amount and kind of material used	Depth interval treated

RECEIVED
 STATE CORPORATION COMMISSION
 .1111 - 71981
 CONSERVATION DIVISION
 Wichita, Kansas

INITIAL PRODUCTION

Date of first production _____ Producing method (flowing, pumping, gas lift, etc.) 7-7-1981

RATE OF PRODUCTION PER 24 HOURS	Oil	Gas	Water	Gas-oil ratio
	bbls.	MCF	bbls.	CFPB

Disposition of gas (vented, used on lease or sold) _____ Producing interval (s) _____

INSTRUCTIONS: As provided in KCC Rule 82-2-125, within 90 days after completion of a well, one completed copy of this Drillers Log shall be transmitted to the State Geological Survey of Kansas, 4150 Monroe Street, Wichita, Kansas 67209. Copies of this form are available from the Conservation Division, State Corporation Commission, 3830 So. Meridian (P.O. Box 17027), Wichita, Kansas 66217. Phone AC 316-522-2206. If confidential custody is desired, please note Rule 82-2-125. Drillers Logs will be on an open file in the Oil and Gas Division, State Geological Survey of Kansas, Lawrence, Kansas 66044.

DESIGNATE TYPE OF COMP.: OIL, GAS,
DRY HOLE, SWDW, ETC.:

Operator Thunderbird Drilling, Inc.		
Well No. 1	Lease Name Huff "A"	Dry Hole
S 15 T 1S R 27W ^E _W		

WELL LOG

Show all important zones of porosity and contents thereof; cored intervals, and all drill-stem tests, including depth interval tested, cushion used, time tool open, flowing and shut-in pressures, and recoveries.

SHOW GEOLOGICAL MARKERS, LOGS RUN, OR OTHER DESCRIPTIVE INFORMATION.

FORMATION DESCRIPTION, CONTENTS, ETC.	TOP	BOTTOM	NAME	DEPTH
			<u>SMP TOPS</u>	
DST #1 /15-30-15-30, rec. 15' mud, FP 29-19# BHP 945-827#	3212	3260	Anhydrite B/Anhydrite	1950+ 609 1972+ 582
			<u>LOG TOPS</u>	
DST #2 /30-60-30-60, rec. 50' gip, 10' soxm, 15' wm, FP 77-66#, BHP 1086-1053#	3261	3320	Heebner Toronto	3210- 651 3242- 683
DST #3 /30-60-30-60, rec. 30' mw, FP 79-98# BHP 1130-1101#	3312	3400	Lansing RTD LTD	3252- 693 3470- 911 3472- 913
<u>From</u> <u>TO</u> <u>Description</u>				
0	264	Surface Hole		
264	1060	Shale		
1060	1265	Sand		
1265	1940	Shale & Sand		
1940	1972	Anhydrite		
1972	2200	Shale		
2200	2458	Shale & Sand		
2458	2849	Shale		
2849	3260	Shale & Lime		
3260	3470	Lime		
3470	R.T.D.			

USE ADDITIONAL SHEETS, IF NECESSARY, TO COMPLETE WELL RECORD.

Date Received	
	Signature Burke Krueger
	Vice-President
	Title
	July 1, 1981
	Date