

STATE CORPORATION COMMISSION OF KANSAS
OIL & GAS CONSERVATION DIVISION
WELL COMPLETION OR RECOMPLETION FORM
ACO-1 WELL HISTORY
DESCRIPTION OF WELL AND LEASE

Operator: License # 5011
Name Viking Resources
Address 217 E. William
Wichita, KS 67202-4005
City/State/Zip

Purchaser None

Operator Contact Person Jim Devlin
Phone 316-262-2502

Contractor: License # 5420
Name White and Ellis

Wellsite Geologist Jim Maloney
Phone 316-262-2502

Designate Type of Completion
 New Well Re-Entry Workover
 Oil SWD Temp Abd
 Gas Inj Delayed Comp.
 Dry Other (Core, Water Supply etc.)

If OWO: old well info as follows:
Operator
Well Name
Comp. Date Old Total Depth

WELL HISTORY

Drilling Method:
 Mud Rotary Air Rotary Cable
3-23-86 3-29-86 3-29-86
Spud Date Date Reached TD Completion Date
4170
Total Depth PBTD

Amount of Surface Pipe Set and Cemented at 292 feet
Multiple Stage Cementing Collar Used? Yes No
If yes, show depth set feet
If alternate 2 completion, cement circulated from feet depth to w/SX cmt
Cement Company Name
Invoice #

API NO. 15-153-20,653-00-00
County Rawlins
E/2. SE.. NW.. Sec.16.. Twp.1..Rge.32... East
 West
3300 Ft North from Southeast Corner of Section
2970 Ft West from Southeast Corner of Section
(Note: Locate well in section plat below)

Lease Name Wicke Well #.2
Field Name
Producing Formation
Elevation: Ground 2963 KB 2968

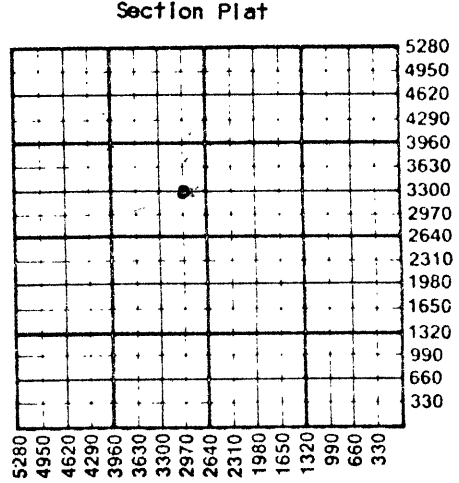

WATER SUPPLY INFORMATION
Disposition of Produced Water: Disposal
Docket # Repressuring

Questions on this portion of the ACO-1 call:
Water Resources Board (913) 296-3717
Source of Water:
Division of Water Resources Permit #
 Groundwater Ft North from Southeast Corner (Well) Ft West from Southeast Corner of Sec Twp Rge East West
 Surface Water 2730 Ft North from Southeast Corner (Stream, pond etc) 1535 Ft West from Southeast Corner Sec 18 Twp 1 Rge 32 East West
 Other (explain) (purchased from city, R.W.D. #)

INSTRUCTIONS: This form shall be completed in duplicate and filed with the Kansas Corporation Commission, 200 Colorado Derby Building, Wichita, Kansas 67202, within 90 days after completion or recompletion of any well. Rule 82-3-130 and 82-3-107 apply. Information on side two of this form will be held confidential for a period of 12 months if requested in writing and submitted with the form. See rule 82-3-107 for confidentiality in excess of 12 months. One copy of all wireline logs and drillers time log shall be attached with this form. Submit CP-4 form with all plugged wells. Submit CP-111 form with all temporarily abandoned wells.

All requirements of the statutes, rules and regulations promulgated to regulate the oil and gas industry have been fully complied with and the statements herein are complete and correct to the best of my knowledge.

Signature James B. Devlin
Title Partner - Operator Date 4-7-86

Subscribed and sworn to before me this 7th day of April 1986
Notary Public Paula R. Dunagan
Date Commission Expires March 2, 1989

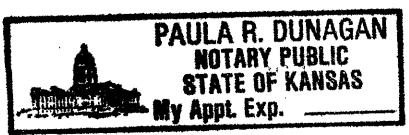

Received
4-8-1986

K.C.C. OFFICE USE ONLY
F Letter of Confidentiality Attached
C Wireline Log Received
C Drillers Timelog Received
Distribution
 KCC SWD/Rep NGPA
 KGS Plug Other
(Specify)

Operator Name **Viking Resources** Lease Name **Wicke** Well # **2**

Sec. **16** Twp. **1** Rge. **32** East West County **Rawlins**

WELL LOG

INSTRUCTIONS: Show important tops and base of formations penetrated. Detail all cores. Report all drill stem tests giving interval tested, time tool open and closed, flowing and shut-in pressures, whether shut-in pressure reached static level, hydrostatic pressures, bottom hole temperature, fluid recovery, and flow rates if gas to surface during test. Attach extra sheet if more space is needed. Attach copy of log.

Drill Stem Tests Taken Yes No
 Samples Sent to Geological Survey Yes No
 Cores Taken Yes No

Formation Description
 Log Sample

DST #1, 3916-4010, 30-30-60-60 (Partial misrun)
 Rec. 385' Mud, BHP: 1148/No final, FP; 76/97 No final
 HP: 2121/1148#, BHT: 116°

DST #2, 4050-4110, 30-30-60-60, Rec. 30' GIP, 2' Free
 Oil, 30' OCM, 60' OCM, 60' OCM, BHP: 1236/1236#,
 FP: 76/97 97/97#, BHT: 122°

Name	Top	Bottom
Anhydrite	2752 (+216)	
B. Anhydrite	2794 (+174)	
Topeka	3750 (-782)	
Deer Creek	3799 (-831)	
Oread	3854 (-886)	
LKC	3904 (-936)	
BKC	4142 (-1174)	
RTD	4170 (-1202)	

CASING RECORD <input checked="" type="checkbox"/> New <input type="checkbox"/> Used							
Report all strings set-conductor, surface, intermediate, production, etc.							
Purpose of String	Size Hole Drilled	Size Casing Set (in O.D.)	Weight Lbs/Ft.	Setting Depth	Type of Cement	#Sacks Used	Type and Percent Additives
Surface	12 1/4	8-5/8	20	292	60/40 poz	185	2% gel, 3% cc.

PERFORATION RECORD		Acid, Fracture, Shot, Cement Squeeze Record	
Shots Per Foot	Specify Footage of Each Interval Perforated	(Amount and Kind of Material Used)	Depth

TUBING RECORD			
Size	Set At	Packer at	Liner Run <input type="checkbox"/> Yes <input type="checkbox"/> No

Date of First Production	Producing Method			
	<input type="checkbox"/> Flowing <input type="checkbox"/> Pumping <input type="checkbox"/> Gas Lift <input type="checkbox"/> Other (explain).....			
Estimated Production Per 24 Hours	Oil	Gas	Water	Gas-Oil Ratio
	Bbls	MCF	Bbls	CFPB

METHOD OF COMPLETION

Production Interval

Disposition of gas: Vented Open Hole Perforation
 Sold Other (Specify)
 Used on Lease Dually Completed
 Commingled

Received
 4-8-1986

APR 8 1986

CONSERVATION DIVISION
 Wichita, Kansas