

APR 12 2004

Form must be Typed  
Form must be Signed  
All blanks must be Filled

For KCC Use:  
Effective Date: 4.19.04  
District # 1  
SGA?  Yes  No

NOTICE OF INTENT TO DRILL

Must be approved by KCC five (5) days prior to commencing

KCC WICHITA

Expected Spud Date 05 01 2004  
month day year

Spot  NE  NE  SW  SW Sec 11 Twp 27S S. R 40W  East  West

OPERATOR: License # 5952  
Name: BP AMERICA PRODUCTION COMPANY  
Address: P. O. BOX 3092, WL1, RM 3.201  
City/State/Zip: HOUSTON, TX 77253-3092  
Contact Person: SUE SELLERS  
Phone: (281) 366-2052

1250' S feet from  N / S  Line of Section  
1250' W feet from  E / W  Line of Section  
Is SECTION  Regular  Irregular?

(Note: Locate well on Section Plat on Reverse Side)

CONTRACTOR: License #: 5382  
Name: CHEYENNE DRILLING

County: STANTON  
Lease Name: HELPER Well #: 4

Field Name: HUGOTON  
Is this a Prorated/Spaced Field?  Yes  No

Target Formation(s): CHASE  
Nearest Lease or unit boundary: 1250' S

Ground Surface Elevation: 3218' feet MSL  
Water well within one-quarter mile:  yes  no

Public water supply within one mile:  yes  no  
Depth to bottom of fresh water: 320

Depth to bottom of usable water: 720  
Surface Pipe by Alternate:  1  2

Length of Surface Pipe Planned to be set: 740' min  
Length of Conductor pipe required: NONE

Projected Total Depth: 2700'  
Formation at Total Depth: CHASE

Water Source for Drilling Operations:  
Well  Farm Pond  Other

DWR Permit #: \_\_\_\_\_  
(Note: Apply for Permit with DWR )

Will Cores Be Taken?:  Yes  No  
If yes, proposed zone: \_\_\_\_\_

Well Drilled For: Well Class: Type Equipment:

- |  |                                   |   |  |
|--|-----------------------------------|---|--|
| <input type="checkbox"/> Oil                 | <input type="checkbox"/> Enh Rec  | <input checked="" type="checkbox"/> Infield | <input checked="" type="checkbox"/> Mud Rotary |
| <input checked="" type="checkbox"/> Gas      | <input type="checkbox"/> Storage  | <input type="checkbox"/> Pool Ext.          | <input type="checkbox"/> Air Rotary            |
| <input type="checkbox"/> OWWO                | <input type="checkbox"/> Disposal | <input type="checkbox"/> Wildcat            | <input type="checkbox"/> Cable                 |
| <input type="checkbox"/> Seismic; # of Holes | <input type="checkbox"/> Other    |   |  |
| <input type="checkbox"/> Other               |                                   |   |  |

If OWWO: old well information as follows:  
Operator: \_\_\_\_\_  
Well Name: \_\_\_\_\_  
Original Completion Date: \_\_\_\_\_ Original Total Depth: \_\_\_\_\_

Directional, Deviated or Horizontal wellbore?  Yes  No

If yes, true vertical depth: \_\_\_\_\_

Bottom Hole Location \_\_\_\_\_

KCC DKT # \_\_\_\_\_

AFFIDAVIT

The undersigned hereby affirms that the drilling, completion and eventual plugging of this well will comply with K.S.A. 55- 101 et, seq,  
It is agreed that the following minimum requirements will be met:

1. Notify the appropriate district office **prior** to spudding of well;
2. A copy of the approved notice of intent to drill **shall be** posted on each drilling rig;
3. The minimum amount of surface pipe as specified below **shall be set** by circulating cement to the top; in all cases surface pipe **shall be set** through all unconsolidated materials plus a minimum of 20 feet into the underlying formation;
4. If the well is dry hole, an agreement between the operator and the district office on plug length and placement is necessary **prior to plugging**;
5. The appropriate district office will be notified before well is either plugged or production casing is cemented in;
6. If an ALTERNATE II COMPLETION, production pipe shall be cemented from below any usable water to surface within **120 days** of spud date. Or pursuant to Appendix "B" - Eastern Kansas surface casing order #133,891-C, which applies to the KCC District 3 area, alternate II cementing must be completed within 30 days of the spud date or the well shall be plugged. **In all cases, NOTIFY district office** prior to any cementing.

I hereby certify that the statements made herein are true and to the best of my knowledge and belief.

Date: 03/08/04 Signature of Operator or Agent: Sue Sellers Title: REGULATORY STAFF ASSISTANT

**For KCC Use ONLY**  
 API # 15- 187-21036-00-00  
 Conductor pipe required NONE feet  
 Minimum surface pipe required 740 feet per Alt 1 2  
 Approved by: RJP 4.14.04  
 This authorization expires: 10-14-04  
 (This authorization void if drilling not started within 6 months of effective date.)  
 Spud date: \_\_\_\_\_ Agent \_\_\_\_\_

**Remember to:**  
 - File Drill Pit Application (form CDP-1) with Intent to Drill;  
 - File Completion Form ACO-1 within 120 days of spud date;  
 - File acreage attribution plat according to field proration orders;  
 - Notify appropriate district office 48 hours prior to workover or re-entry;  
 - Submit plugging report (CP-4) after plugging is completed;  
 - Obtain written approval before disposing or injecting salt water.  
 - If permit has expired (See: authorized expiration date) please check the box below and return to the address below  
 Well Not Drilled - Permit Expired  
 Signature of Operator or Agent: \_\_\_\_\_  
 Date: \_\_\_\_\_

**IN ALL CASES PLOT THE INTENDED WELL ON THE PLAT BELOW**

*Plat of acreage attributable to a well in a prorated or spaced field*

**If the intended well is in a prorated or spaced field, please fully complete this side of the form.** If the intended well is in a prorated or spaced field complete the plat below showing that the well will be properly located in relationship to other wells producing from the common source of supply. Please show all the wells within 1 mile of the boundaries of the proposed acreage attribution unit for gas wells and within 1/2 mile of the boundaries of the proposed acreage attribution unit for oil wells.

API No. 15- \_\_\_\_\_  
 Operator BP AMERICA PRODUCTION COMPANY  
 Lease HELPER  
 Well Number 4  
 Field HOGOTON/CHASE

Location of Well: County: STANTON  
 \_\_\_\_\_ 1250' S feet from  N / S  Line of Section  
 \_\_\_\_\_ 1250' W feet from  E / W  Line of Section  
 Sec 11 Twp 27S S. R. 40W  East  West

Number of Acres attributable to well: 640  
 QTR/QTR/QTR of acreage: NE - SW - SW

Is Section  Regular or  Irregular  
**If Section is irregular, locate well from nearest corner boundary.**  
 Section corner used:  NE  NW  SE  SW

**PLAT**

*(Show location of the well and shade attributable acreage for prorated or spaced wells.)  
 (Show footage to nearest lease or unit boundary line)*

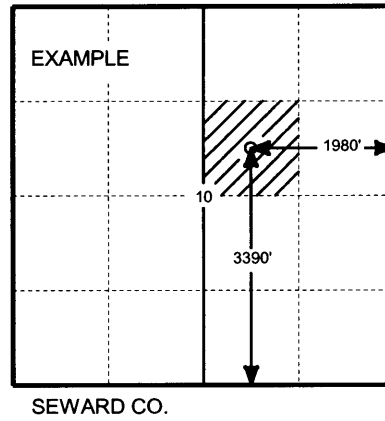
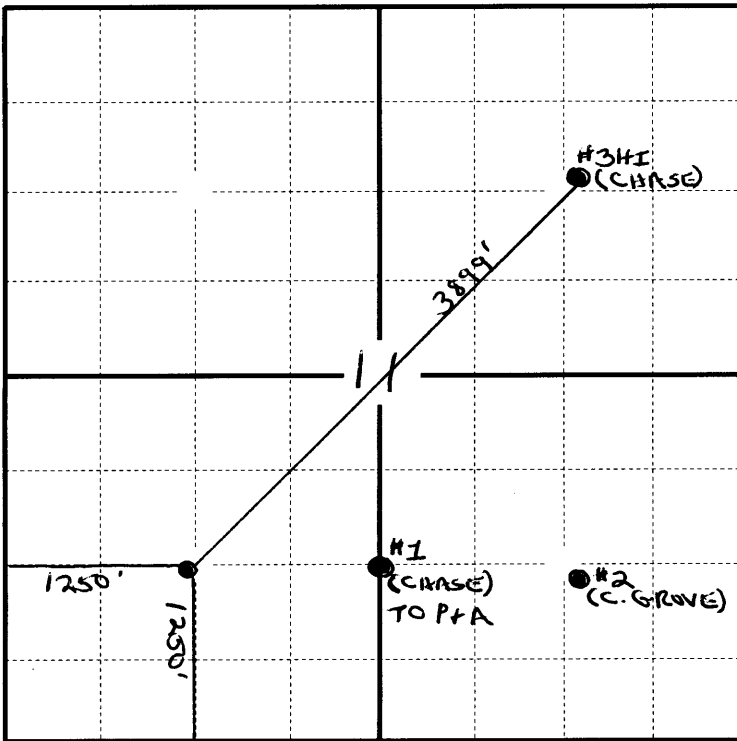

**In plotting the proposed location of the well, you must show;**

1. The manner in which you are using the depicted plat by identifying section lines, i.e. 1 section, 1 section with 8 surrounding sections, 4 sections, etc.;
2. The distance of the proposed drilling location from the section's south/north and east/west; and 3.
3. The distance to the nearest lease or unit boundary line.
4. If proposed location is located within a prorated or spaced field a certificate of acreage attribution plat must be attached: (CO-7 for oil wells; CG-8 for gas wells).