

For KCC Use: 4-25-04  
Effective Date: 3  
District # 3  
SGA? ☐ Yes ☒ No

KANSAS CORPORATION COMMISSION  
OIL & GAS CONSERVATION DIVISION  
**NOTICE OF INTENT TO DRILL**

Must be approved by KCC five (5) days prior to commencing well

RECEIVED

APR 19 2004

KCC WICHITA

Form C-1  
December 2002  
Form must be Typed  
Form must be Signed  
All blanks must be Filled

Expected Spud Date 6 7 2004  
month day year

OPERATOR: License# 32294  
Name: Osborn Energy, L.L.C.  
Address: 24850 Farley  
City/State/Zip: Bucyrus, Kansas 66013  
Contact Person: Steve Allee  
Phone: 913-533-9900

CONTRACTOR: License# 5885  
Name: Susie Glaze dba Glaze Drilling Co.

Well Drilled For: ☐ Oil ☐ Enh Rec ☒ Infield ☐ Mud Rotary  
☒ Gas ☐ Storage ☐ Pool Ext. ☒ Air Rotary  
☐ OWWO ☐ Disposal ☐ Wildcat ☐ Cable  
☐ Seismic; # of Holes ☐ Other  
☐ Other

If OWWO: old well information as follows:

Operator: \_\_\_\_\_  
Well Name: \_\_\_\_\_  
Original Completion Date: \_\_\_\_\_ Original Total Depth: \_\_\_\_\_

Directional, Deviated or Horizontal wellbore? ☐ Yes ☒ No

If Yes, true vertical depth: \_\_\_\_\_

Bottom Hole Location: \_\_\_\_\_

KCC DKT #: \_\_\_\_\_

Spot C SE NW Sec. 11 Twp. 16 S. R. 24 ☒ East ☐ West  
1980 feet from ☒ N / ☐ S Line of Section  
1980 feet from ☐ E / ☒ W Line of Section  
Is SECTION ☒ Regular ☐ Irregular?

(Note: Locate well on the Section Plat on reverse side)

County: Miami  
Lease Name: Hopkins Well #: 6-11-16-24  
Field Name: Paola-Rantoul

Is this a Prorated / Spaced Field? ☒ Yes ☐ No

Target Information(s): Cherokee

Nearest Lease or unit boundary: 660

Ground Surface Elevation: 1059 feet MSL

Water well within one-quarter mile: ☐ Yes ☒ No

Public water supply well within one mile: ☐ Yes ☒ No

Depth to bottom of fresh water: 140 +

Depth to bottom of usable water: 240 +

Surface Pipe by Alternate: ☐ 1 ☒ 2

Length of Surface Pipe Planned to be set: 20'

Length of Conductor Pipe required: None

Projected Total Depth: Cherokee

Formation at Total Depth: 750

Water Source for Drilling Operations:

☐ Well ☐ Farm Pond Other ☒

DWR Permit #: \_\_\_\_\_

(Note: Apply for Permit with DWR ☐)

Will Cores be taken? ☐ Yes ☒ No

If Yes, proposed zone: \_\_\_\_\_

**AFFIDAVIT**

The undersigned hereby affirms that the drilling, completion and eventual plugging of this well will comply with K.S.A. 55 et. seq.

It is agreed that the following minimum requirements will be met:

1. Notify the appropriate district office **prior** to spudding of well;
2. A copy of the approved notice of intent to drill **shall be** posted on each drilling rig;
3. The minimum amount of surface pipe as specified below **shall be set** by circulating cement to the top; in all cases surface pipe **shall be set** through all unconsolidated materials plus a minimum of 20 feet into the underlying formation.
4. If the well is dry hole, an agreement between the operator and the district office on plug length and placement is necessary **prior to plugging**;
5. The appropriate district office will be notified before well is either plugged or production casing is cemented in;
6. If an ALTERNATE II COMPLETION, production pipe shall be cemented from below any usable water to surface within **120 days** of spud date. Or pursuant to Appendix "B" - Eastern Kansas surface casing order #133,891-C, which applies to the KCC District 3 area, alternate II cementing must be completed within 30 days of the spud date or the well shall be plugged. **In all cases, NOTIFY district office** prior to any cementing.

I hereby certify that the statements made herein are true and to the best of my knowledge and belief.

Date: 4/16/04 Signature of Operator or Agent: R.R. Allee Title: \_\_\_\_\_

**Remember to:**

- File Drill Pit Application (form CDP-1) with Intent to Drill;
- File Completion Form ACO-1 within 120 days of spud date;
- File acreage attribution plat according to field proration orders;
- Notify appropriate district office 48 hours prior to workover or re-entry;
- Submit plugging report (CP-4) after plugging is completed;
- Obtain written approval before disposing or injecting salt water.
- If this permit has expired (See: authorized expiration date) please check the box below and return to the address below.

☐ Well Not Drilled - Permit Expired

Signature of Operator or Agent: \_\_\_\_\_

Date: \_\_\_\_\_

**For KCC Use ONLY**

API # 15 - 121-27849-00-00

Conductor pipe required NONE feet

Minimum surface pipe required 20 feet per Alt. → 2

Approved by: RJP 4-20-04

This authorization expires: 10-20-04

(This authorization void if drilling not started within 6 months of effective date.)

Spud date: \_\_\_\_\_ Agent: \_\_\_\_\_

Mail to: KCC - Conservation Division, 130 S. Market - Room 2078, Wichita, Kansas 67202

11  
16  
24

**IN ALL CASES PLOT THE INTENDED WELL ON THE PLAT BELOW***Plat of acreage attributable to a well in a prorated or spaced field*

**If the intended well is in a prorated or spaced field, please fully complete this side of the form.** If the intended well is in a prorated or spaced field complete the plat below showing that the well will be properly located in relationship to other wells producing from the common source of supply. Please show all the wells and within 1 mile of the boundaries of the proposed acreage attribution unit for gas wells and within 1/2 mile of the boundaries of the proposed acreage attribution unit for oil wells.

API No. 15 - \_\_\_\_\_

Operator: Osborn Energy, L.L.C.Lease: HopkinsWell Number: 6-11-16-24Field: Paola-Rantoul

Number of Acres attributable to well: \_\_\_\_\_

QTR / QTR / QTR of acreage: \_\_\_\_\_ - \_\_\_\_\_ - \_\_\_\_\_

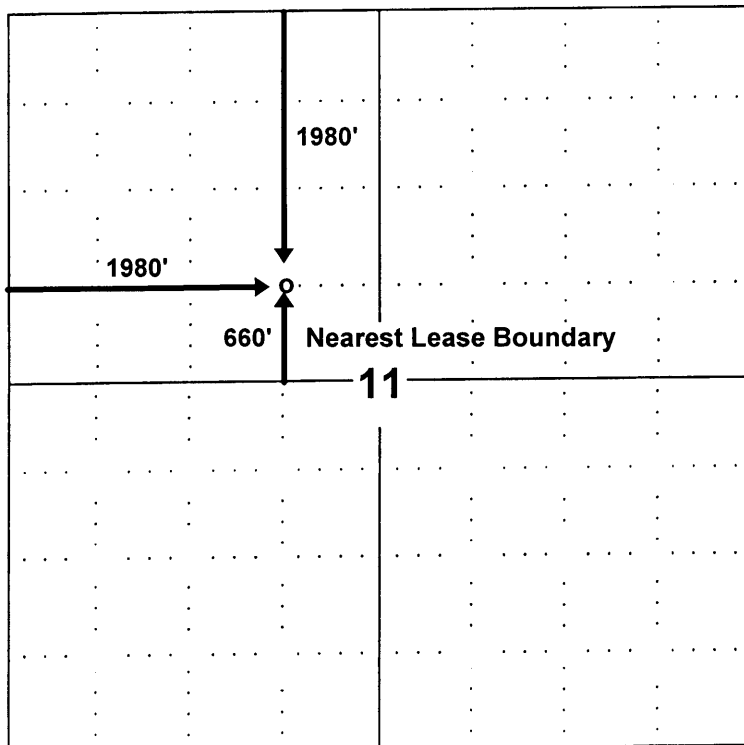
Location of Well: County: Miami\_\_\_\_\_ 1980 feet from ☒ N / ☐ S Line of Section\_\_\_\_\_ 1980 feet from ☐ E / ☒ W Line of SectionSec. 11 Twp. 16 S. R. 24 ☒ East ☐ WestIs Section: ☒ Regular or ☐ Irregular**If Section is Irregular, locate well from nearest corner boundary.**Section corner used: ☐ NE ☐ NW ☐ SE ☐ SW**PLAT***(Show location of the well and shade attributable acreage for prorated or spaced wells.)**(Show footage to the nearest lease or unit boundary line.)*

RECEIVED  
APR 19 2004  
KCC WICHITA

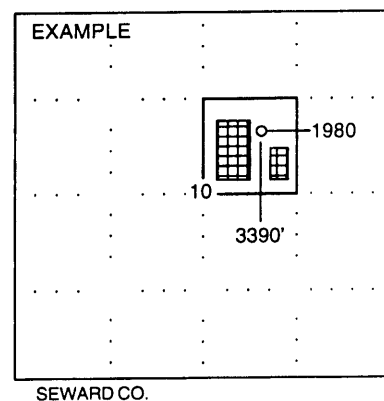
**NOTE: In all cases locate the spot of the proposed drilling location.****Miami County****In plotting the proposed location of the well, you must show:**

1. The manner in which you are using the depicted plat by identifying section lines, i.e. 1 section, 1 section with 8 surrounding sections, 4 sections, etc.
2. The distance of the proposed drilling location from the section's south / north and east / west.
3. The distance to the nearest lease or unit boundary line.
4. If proposed location is located within a prorated or spaced field a certificate of acreage attribution plat must be attached: (C0-7 for oil wells; CG-8 for gas wells).