

For KCC Use: 4-5-04  
 Effective Date: 2  
 District #: \_\_\_\_\_  
 S G A ?  Yes  No

KANSAS CORPORATION COMMISSION  
 OIL & GAS CONSERVATION DIVISION

RECEIVED

Form C-1  
 September 1999  
 Form must be Typed  
 Form must be Signed  
 All blanks must be Filled

NOTICE OF INTENT TO DRILL

MAR 31 2004

Must be approved by KCC five (5) days prior to commencing well

KCC WICHITA

Expected Spud Date April 20 2004  
 month day year

Spot \_\_\_\_\_  East  
E2 - E2 - SW Sec 5 Twp. 28 S. R. 6  West  
1320' fsl feet from S (circle one) Line of Section  
2310' fwl feet from E (circle one) Line of Section  
 Is SECTION XX Regular \_\_\_\_\_ Irregular?

OPERATOR: License# 5399  
 Name: American Energies Corporation  
 Address: 155 N. Market, Suite 710  
 City/State/Zip: Wichita, KS 67202  
 Contact Person: Alan L. DeGood, President  
 Phone: (316) 316-263-5785

(Note: Locate well on the Section Plat on reverse side)  
 County: Kingman  
 Lease Name: Kaufman Well #: 3  
 Field Name: Georgia Spur

CONTRACTOR: License# 5123  
 Name: Pickrell Drilling Company, Inc.

Is this a Prorated / Spaced Field?  Yes  No  
 Target Information(s): Mississippi

Nearest Lease or unit boundary: 330'  
 Ground Surface Elevation: 1540' ESTIMATED feet MSL

Water well within One-quarter mile:  Yes  No  
 Public water supply well within one mile:  Yes  No

Depth to bottom of fresh water: 70' 150'  
 Depth to bottom of usable water: 70' 180'

Surface Pipe by Alternate: XX 1 \_\_\_\_\_ 2 \_\_\_\_\_  
 Length of Surface Pipe Planned to be set: 250'

Length of Conductor Pipe required: None  
 Projected Total Depth: 4000'

Producing Formation Target: Mississippi  
 Water Source for Drilling Operations:  
 Well \_\_\_\_\_ Farm Pond \_\_\_\_\_ Other XX

DWR Permit #: \_\_\_\_\_  
 (Note: Apply for Permit with DWR )

Will Cores be taken?  Yes  No  
 If Yes, proposed zone: \_\_\_\_\_

Well Drilled For: Well Class: Type Equipment:  
 Oil  Enh Rec  Infield  Mud Rotary  
 Gas  Storage  Pool Ext.  Air Rotary  
 OWWO  Disposal  Wildcat  Cable  
 Seismic; # of Holes \_\_\_\_\_  Other \_\_\_\_\_  
 Other \_\_\_\_\_

If OWWO: old well information as follows:  
 Operator: \_\_\_\_\_  
 Well Name: \_\_\_\_\_  
 Original Completion Date: \_\_\_\_\_ Original Total Depth: \_\_\_\_\_

Directional, Deviated or Horizontal wellbore?  Yes  No

If Yes, true vertical depth: \_\_\_\_\_

Bottom Hole Location: \_\_\_\_\_

KCC DKT #: \_\_\_\_\_

AFFIDAVIT

The undersigned hereby affirms that the drilling, completion and eventual plugging of this well will comply with K.S.A. 55-101, et. seq.  
 It is agreed that the following minimum requirements will be met:

1. Notify the appropriate district office **prior** to spudding of well;
2. A copy of the approved notice of intent to drill **shall be posted** on each drilling rig;
3. The minimum amount of surface pipe as specified below **shall be set** by circulating cement to the top; in all cases surface pipe **shall be set** through all unconsolidated materials plus a minimum of 20 feet into the underlying formation.
4. If the well is dry hole, an agreement between the operator and the district office on plug length and placement is necessary **prior to plugging**;
5. The appropriate district office will be notified before well is either plugged or production casing is cemented in;
6. If an ALTERNATE 11 COMPLETION, production pipe shall be cemented from below any usable water to surface within **120 days** of spud date. **In all cases, NOTIFY district office** prior to any cementing.

I hereby certify that the statements made herein are true and to the best of my knowledge and belief.

Date: 03/18/04 Signature of Operator or Agent: Alan L. DeGood Title: President  
Alan L. DeGood

For KCC Use ONLY  
 API # 15 - 095-21873.00.00  
 Conductor pipe required NONE feet  
 Minimum surface pipe required 200 feet per Alt (1)  
 Approved by: RSP 3-31-04  
 This authorization expires: 10-1-04  
 (This authorization void if drilling not started within 6 months of effective date.)  
 Spud date: \_\_\_\_\_ Agent: \_\_\_\_\_

- Remember to -
- File Drill Pit Application (form CDP-1) with Intent to Drill;
  - File Completion Form ACO-1 within 120 days of spud date;
  - File acreage attribution plat according to field proration orders;
  - Notify appropriate district office 48 hours prior to workover or re-entry;
  - Submit plugging report (CP-4) after plugging is completed;
  - Obtain written approval before disposing or injecting salt water.

Mail to: KCC - Conservation Division, 130 S. Market - Room 2078, Wichita, Kansas 67202

S  
28  
Gm

**IN ALL CASES PLOT THE INTENDED WELL ON THE PLAT BELOW**

*Plat of acreage attributable to a well in a prorated or spaced field*

**If the intended well is in a prorated or spaced field, please fully complete this side of the form.** If the intended well is in a prorated or spaced field complete the plat below showing that the well will be properly located in relationship to other wells producing from the common source of supply. Please show all the wells and within 1 mile of the boundaries of the proposed acreage attribution unit for gas wells and within 1/2 mile of the boundaries of the proposed acreage attribution unit for oil wells.

API No. 15 - \_\_\_\_\_  
 Operator: American Energies Corporation  
 Lease: Kaufman  
 Well Number: 3  
 Field: Georgia Spur  
 Number of Acres attributable to well: \_\_\_\_\_  
 QTR / QTR / QTR of acreage: E2 - E2 - SW

Location of Well: County: Kingman  
 1320' fsl \_\_\_\_\_ feet from S / N (circle one) Line of Section  
 2310' fwl \_\_\_\_\_ feet from E / W (circle one) Line of Section  
 Sec 5 Twp 28 S. R. 6  East  West

Is Section XX Regular or \_\_\_\_\_ Irregular

**If Section is Irregular, locate well from nearest corner boundary.**

Section corner used: \_\_\_ NE \_\_\_ N W - S E \_\_\_ SW

**PLAT**

*(Show location of the well and shade attributable acreage for prorated or spaced wells)  
 (Show footage to the nearest lease or unit boundary fine.)*

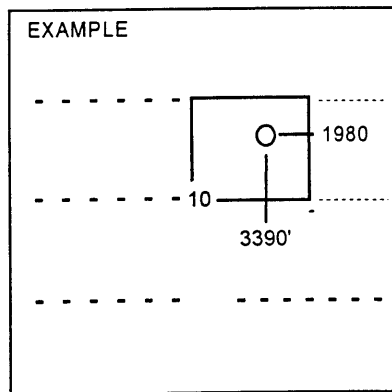
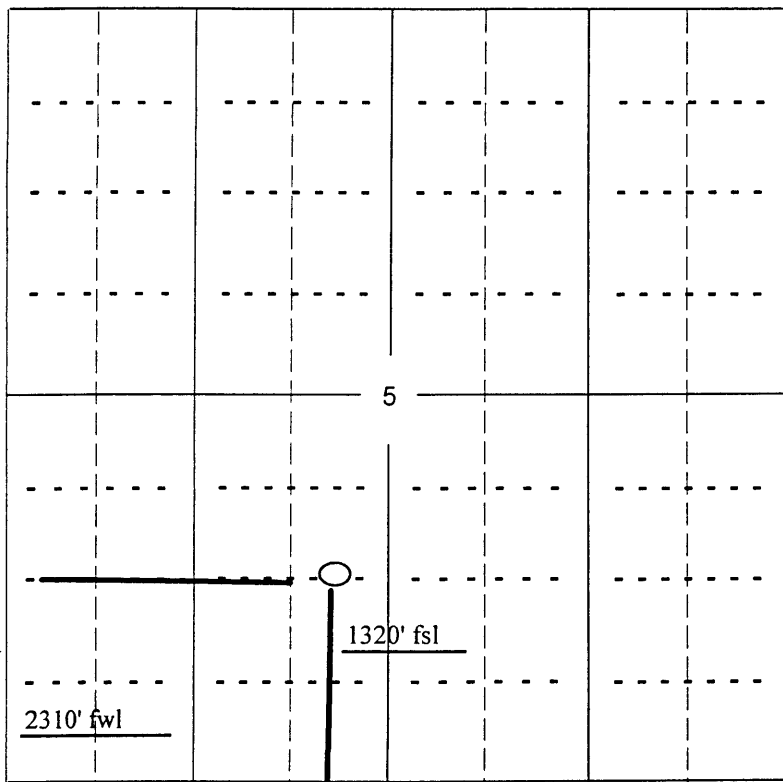

SEWARDCO.

**NOTE., In all cases locate the spot of the proposed drilling location.**

**In plotting the proposed location of the well, you must show.**

1. The manner in which you are using the depicted plat by identifying section lines, i.e. 1 section, 1 section with 8 surrounding sections, 4 sections, etc.
2. The distance of the proposed drilling location from the section's south / north and east / west.
3. The distance to the nearest lease or unit boundary line.
4. If proposed location is located within a prorated or spaced field a certificate of acreage attribution plat must be attached: (CO-7 for oil wells; CG-8 for gas wells).