

CARD MUST BE TYPED

State of Kansas

CARD MUST BE SIGNED

EFFECTIVE DATE 4.25-04

NOTICE OF INTENTION TO DRILL HUGOTON INFILL

SCA-NO

Starting Date 05 01 04 DIST 1 month day year

API Number 15- 187-21038-00-00

IS SECTION X REGULAR IRREGULAR

OPERATOR: License # 5952 Name BP AMERICA PRODUCTION COMPANY Address P. O. BOX 3092, WL1, RM 3, 201 City/State/Zip HOUSTON, TX 77253-3092 Contact Person SUE SELLERS Phone (281)366-2052

AP NE SE SE NW Sec 25 Twp 30S S. Rg 40W W 2163' N Ft. from South Line of Section 2482' W Ft. from East Line of Section

CONTRACTOR License # 5382 Name CHEYENNE DRILLING City/State

Note: Attach acreage attribution plat locating both Chase (Hugoton) wells Total number of acres attributed to unit 640

Well Drilled as: X New Recompletion OWWO Projected Total Depth 2670 feet Formation CHASE

Nearest producing well from same common source of supply 2200 feet Nearest lease or unit boundary line 2163' N feet County STANTON

If OWWO or Recompletion: old well info as follows: Operator Well Name Comp. Date Old Total Depth

Lease Name PARKS 'A' Well # 5HI Ground surface elevation 3223' feet MSL Depth to bottom of fresh water 340 Depth to bottom of usable water 560 Surface pipe by Alternate: 1 X 2 Surface pipe planned to be set 580' MIN Water Source for Drilled Operations: DWR Permit #: well farm pond X other

I certify that well will comply with K.S.A. 55-101, et seq., plus eventually plugging hole to KCC specifications.

Date 04/08/04 Signature of Operator or Agent Sue Sellers Title

REGULATORY STAFF ASSISTANT

For KCC Use:

Conductor Pipe Required NONE feet; Minimum Surface Pipe Required 580 feet per Alt 2 This Authorization Expires 10-21-04 Approved By 2594.21.04

9/95

Must be filed with K.C.C. five (5) days prior to commencing well This card void if drilling not started within six (6) months of date received by K.C.C.

RECEIVED APR 12 2004 KCC WICHITA

A Regular Section of Land 1 Mile = 5,280 Ft.

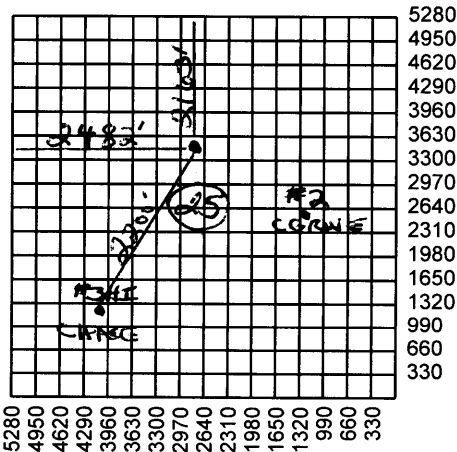

Important procedures to follow:

- 1. Notify District office before setting surface casing.
2. Set surface casing by circulating cement to the top.
3. File completion forms ACO-1 with K.C.C. within 120 days of well spud date, following instructions on ACO-1, side 1, and including copies of wireline logs.
4. Notify District office 48 hours prior to old well workover or re-entry.
5. Submit plugging report (CP-4) to K.C.C. after plugging is completed.
6. If an alternate 2 completion, cement in the production pipe from below any useable water to surface within 120 day of spud date.

State Corporation Commission of Kansas Conservation Division 130 S. Market Room 2078 Wichita, Kansas 67202-1212 (316) 337-6231