

CARD MUST BE TYPED

State of Kansas  
NOTICE OF INTENTION TO DRILL  
HUGOTON INFILL

CARD MUST BE SIGNED

EFFECTIVE DATE 4-7-04

SGA NO

Starting Date 05 month 01 day 04 year API Number 15- 187-21033-00-00  
IS SECTION  REGULAR  IRREGULAR

OPERATOR: License # 5952 Name BP AMERICA PRODUCTION COMPANY  
Address P. O. BOX 3092, WL1, RM 3.201  
City/State/Zip HOUSTON, TX 77253-3092

Ap NW NE NE NE Sec 22 Twp 28S S. Rg 40W W  
150' N Ft. from South Line of Section  
450' E Ft. from East Line of Section

Contact Person SUE SELLERS  
Phone (281)366-2052  
CONTRACTOR License # 5382 Name CHEYENNE DRILLING

RECEIVED  
KANSAS CORPORATION COMMISSION  
MAR 02 2004  
CONSERVATION DIVISION  
WICHITA, KS

Note: Attach acreage attribution plat locating both Chase (Hugoton) wells  
Total number of acres attributed to unit 640

Well Drilled as:  New  Recompletion  OWWO  
Projected Total Depth 2640 feet  
Formation CHASE

Nearest producing well from same common source of supply 2821' feet  
Nearest lease or unit boundary line \_\_\_\_\_ feet  
County STANTON

If OWWO or Recompletion: old well info as follows:  
Operator \_\_\_\_\_  
Well Name \_\_\_\_\_  
Comp. Date \_\_\_\_\_ Old Total Depth \_\_\_\_\_

Lease Name RAMEY Well # 5HI  
Ground surface elevation 3255 feet MSL  
Depth to bottom of fresh water 450  
Depth to bottom of usable water 640

Surface pipe by Alternate: 1 X 2  
Surface pipe planned to be set 660' MIN  
Water Source for Drilled Operations:  
DWR Permit #: \_\_\_\_\_ well \_\_\_\_\_ farm pond  other \_\_\_\_\_

W.L.E. GRANTED 3-30-04

I certify that well will comply with K.S.A. 55-101, et seq., plus eventually plugging hole to KCC specifications.  
Date 02/18/04 Signature of Operator or Agent Sue Sellers Title REGULATORY STAFF ASSISTANT

For KCC Use:  
Conductor Pipe Required None Minimum Surface Pipe Required 660 feet per Alt 1  
This Authorization Expires 10-3-04 Approved By RJP 4-2-04

9/95

Must be filed with K.C.C. five (5) days prior to commencing well  
This card void if drilling not started within six (6) months of date received by K.C.C.

A Regular Section of Land  
1 Mile = 5,280 Ft.

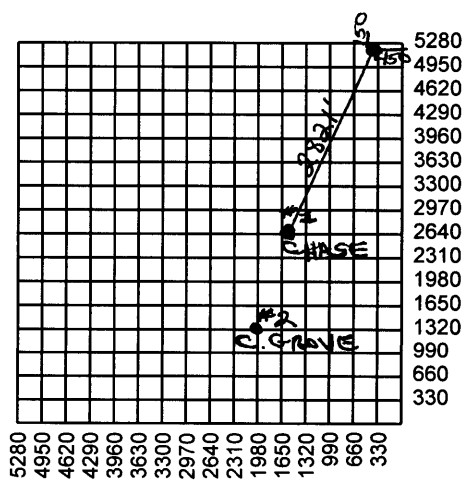

- Important procedures to follow:
1. Notify District office before setting surface casing.
  2. Set surface casing by circulating cement to the top.
  3. File completion forms ACO-1 with K.C.C. within 120 days of well spud date, following instructions on ACO-1, side 1, and including copies of wireline logs.
  4. Notify District office 48 hours prior to old well workover or re-entry.
  5. Submit plugging report (CP-4) to K.C.C. after plugging is completed.
  6. If an alternate 2 completion, cement in the production pipe from below any useable water to surface within 120 day of spud date.

State Corporation Commission of Kansas  
Conservation Division  
130 S. Market Room 2078  
Wichita, Kansas 67202-1212  
(316) 337-6231

22  
28  
403