

TO:  
STATE CORPORATION COMMISSION  
CONSERVATION DIVISION - PLUGGING  
130 SOUTH MARKET, SUITE 2078  
WICHITA, KANSAS 67202

API Well Number: 15-153-20710-00-00  
Spot: NESENW Sec/Twnshp/Rge: 24-1S-33W  
3630 feet from S Section Line, 2970 feet from E Section Line  
Lease Name: TIMM Well #: 2  
County: RAWLINS Total Vertical Depth: 4656 feet

Operator License No.: 30931  
Op Name: DAYSTAR PETROLEUM, INC.  
Address: 1321 W. 93 N.  
VALLEY CENTER, KS 67147

PROD Size: 4.5 feet: 4655 w/750 sxs cmt  
SURF Size: 8.625 feet: 321 w/170 sxs cmt

*# 151 32*

Well Type: OIL UIC Docket No: \_\_\_\_\_ Date/Time to Plug: 04/29/2004 11:00 AM  
Plug Co. License No.: 99998 Plug Co. Name: COMPANY TOOLS  
Proposal Rcvd. from: ALAN WALKER Company: DAYSTAR PETROLEUM, INC. Phone: (316) 755-3523

Proposed Plugging Method: Ordered 275 sxs 60/40 pozmix - 10% gel - 600# hulls.  
Plug through tubing.

Plugging Proposal Received By: HERB DEINES Witness Type: COMPLETE (100%)  
Date/Time Plugging Completed: 04/29/2004 1:00 PM KCC Agent: DARREL DIPMAN

**Actual Plugging Report:**

Perfs:

8 5/8" surface casing set at 321' w/170 sxs cement.  
4 1/2" production casing set at 4655' w/750 sxs cement.  
PBTD 4610'. Perforations from 3996' - 4136'.  
4 1/2" casing squeezed from 1162' - 1191' w/200 sxs cement; 2337' - 2367' w/180 sxs cement.  
Casing holes from 0' to 3000'.  
Ran tubing to 2000' - pumped 200 sxs cement and 600# hulls.  
Cement to surface.  
Connected to 4 1/2" production casing - pumped 20 sxs cement.  
Max. P.S.I. 500#. S.I.P. 500#.  
Connected to 8 5/8" surface casing - pumped 5 sxs cement.  
Max. P.S.I. 1200#. S.I.P. 0#.  
Bull-plug blew out of braden head.  
Plug complete.

RECEIVED  
MAY 06 2004  
KCC WICHITA

Remarks: ALLIED CEMENTING COMPANY-TICKET#12171.

Plugged through: TBG

District: 04

**INVOICED**

Signed

*Darrel Dipman*

(TECHNICIAN)

DATE 5-6-04  
NO. 2004061516

APR 30 2004

STATE KANS COUNTY RAWLINS RE-ISSUE 24-1S-33W  
 FIELD WILHELM (LANSING) NE SE NW  
 OPER JAY BOY OIL 3630FSL 2970FEL SEC  
 WELL 2 TIMM  
 API 15-153-20710-0000  
 SPUD 04/07/1988  
 DTD 4656 LTD FTD ARBUCKLE  
 WELL CLASS DO  
 STATUS OIL  
 COMP 05/19/1988  
 PSTD

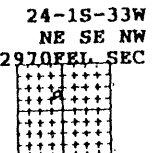

LOC 6 1/2 MI N LUDELL, KS

IP IPP 33 BOPD 2 BW EL: 2976 KB 2971 GR  
 PROD ZONE: LSG-KANS CITY 4111-4136 GROSS

CSGS: 8 5/8 @ 321 W/ 170 SACKS  
 4 1/2 @ 4655 W/ 750 SACKS  
 TBGS: 2 3/8 @ 4168  
 DRLG COMP 4/18/88 RIG REL 4/18/88  
 DSTS: DST 1 3719-3793 WABAUNSEE REC 960 FT SWTR  
 INIT OP 30M IFF 180 FFP 286  
 FINAL OP 30M IFF 402 FFP 466  
 ISIP 1093 30M FSIP 1083 30M IHP 1927  
 FHP 1822 BHT 116F  
 DST 2 3848-3908 OREAD REC 15 FT MUD  
 INIT OP 30M IFF 95 FFP 95 FINAL OP 30M IFF 105 FFP 105  
 ISIP 1156 1H FSIP 1156 1H IHP 1958 FHP 1927 BHT 120F  
 DST 3 3958-4012 LANSING REC 1 FT OIL 149 FT VSOCM  
 INIT OP 30M IFF 137 FFP 137 FINAL OP 30M IFF 148 FFP 148  
 ISIP 1083 30M FSIP 989 30M IHP 1989 FHP 1958 BHT 112F

SPL TOPS:  
 STONE CORRAL 2805 -171  
 BSE STN CORRAL 2845 -131  
 OREAD 3892 -916  
 LANSING 3948 -972  
 BSE KANSAS CITY 4239 -1263  
 CHEROKEE SH 4371 -1395  
 MISS CHERT 4562 -1586  
 ARBUCKLE 4606 -1630  
 TD 4656 -1680  
 LOG TOPS NOT RPTD

KS R2-031390 CONTINUED Copyright 1990 Petroleum Information Corporation

KCC  
 MAY 05 2004  
 HAYS, KS

KS R2-031390 JAY BOY OIL 2 TIMM

DST 4 4003-4024 LANSING REC 20' OIL 65' OCMW INIT OP 30M IFF 105 FFP 105 FINAL  
 OP 30M IFF 105 FFP 105 ISIP 1114 1H FSIP 1052 1H IHP 2094 FHP 2031 BHT 122F  
 DST 5 4022-4044 LANSING MISRUN  
 DST 6 4010-4044 LANSING REC 95 FT GOCM INIT OP 30M IFF 137 FFP 158 FINAL OP  
 30M IFF 158 FFP 169 ISIP 843 1H FSIP 832 1H IHP 2135 FHP 2031 BHT 124F  
 DST 7 4056-4100 LANSING REC 15 FT MUD INIT OP 30M IFF 105 FFP 105 FINAL  
 OP 30M IFF 105 FFP 105 ISIP 602 1H FSIP 296 1H IHP 2125 FHP 2115 BHT 124F  
 DST 8 4098-4140 LANSING REC 100 FT OIL 120 FT OCM INIT OP 30M IFF 105 FFP 137  
 FINAL OP 30M IFF 137 FFP 148 ISIP 1187 1H FSIP 1156 1H IHP 2156 FHP 1094  
 DST 9 4166-4185 LANSING REC 160 FT MUD INIT OP 30M IFF 95 FFP 116 FINAL OP 30M  
 IFF 127 FFP 127 ISIP 1270 1H FSIP 1208 1H IHP 2104 FHP 1094 BHT 126F  
 DST 10 4180-4200 LANSING REC 45 FT MUD INIT OP 30M IFF 74 FFP 74 FINAL OP  
 30M IFF 84 FFP 84 ISIP 1166 30M FSIP 1125 30M IHP 2135 FHP 2115 BHT 127F  
 DST 11 4412-4504 CHEROKEE REC 2400 FT SWTR INIT OP 30M IFF 1260 FFP 1281 FINAL  
 OP 30M IFF 1291 FFP 1291 ISIP 1291 30M FSIP 1291 30M IHP 2648 FHP 2596 BHT 136F

PERFS: LANSING-KANSAS CITY PERF 4111-4136 GROSS: 4111-4114 4134-4136  
 ACID 500 GALS 15% MCA, AGFR 4000 GALS 15% SGA 1500 GALS GEL WTR  
 LANSING-KANSAS CITY PERF 3998-4018 GROSS: 3998, 4018  
 ACID 500 GALS 15% MCA, AGFR 4000 GALS 15% SGA 1500 GALS GEL WTR  
 TSTG RESULTS NOT RPTD. PKRD OFF. NO CORES  
 OPER ADDRESS: 224 E DOUGLAS, STE 425, WICHITA, KS 67202  
 CONTR: MURFIN DRLG GEOL: DOUG DAVIS

REISSUE TO: CORRECT FORMATION @ TD, OPER ADDRESS,  
 ADD PROD CSG, TBG, SPL TOPS, DSTS, PERFS, TREATMENTS, IP  
 REPLACEMENT FOR CARD ISSUED 8/9/88