

STATE CORPORATION COMMISSION OF KANSAS
OIL & GAS CONSERVATION DIVISION
WELL COMPLETION OR RECOMPLETION FORM
ACO-1 WELL HISTORY
DESCRIPTION OF WELL AND LEASE

5

API NO. 15-153-20,658-00-00
County Rawlins
C. NW SW SW. Sec 15 Twp. 1S Rge. 33 East
990 Ft North from Southeast Corner of Section
4950 Ft West from Southeast Corner of Section
(Note: Locate well in section plat below)

Operator: License # 9800
Name Double R Oil Company
Address P.O. Box 506
City/State/Zip McCook, Neb. 69001

Lease Name Vap "A" Well # 1-5615

Purchaser Clear Creek

Field Name Drift Ext.

Operator Contact Person Roger W. Philpott
Phone (913) 626-3104

Producing Formation Lansing-Kansas City

Elevation: Ground 2911 KB 2916

Contractor: License # 6033
Name Murfin Drilling Co.

Wellsite Geologist Jim Reeves
Phone (913) 475-3325

Designate Type of Completion
 New Well Re-Entry Workover
 Oil SWD Temp Abd
 Gas Inj Delayed Comp.
 Dry Other (Core, Water Supply etc.)

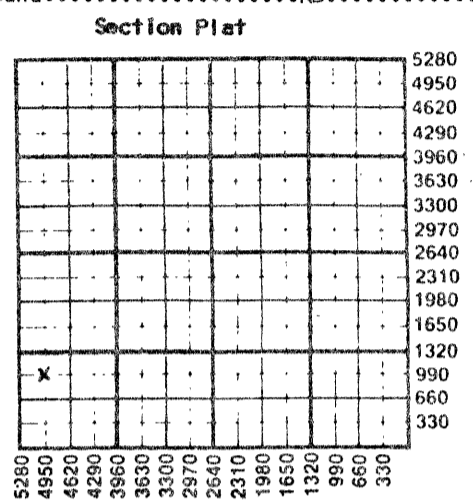

If OWNED: old well info as follows:
Operator
Well Name
Comp. Date
Old Total Depth

WATER SUPPLY INFORMATION

Disposition of Produced Water: Disposal
Docket # Repressuring

WELL HISTORY

Drilling Method:
 Mud Rotary Air Rotary Cable
7/21/86 7/27/86 8/6/86
Spud Date Date Reached TD Completion Date
4150 4150
Total Depth PBTD

Questions on this portion of the ACO-1 call:
Water Resources Board (913) 296-3717

Source of Water: T-86-275
Division of Water Resources Permit #

Groundwater 1090 Ft North from Southeast Corner
(Well) 5000 Ft West from Southeast Corner of
Sec 15 Twp 1S Rge 33 East West

Amount of Surface Pipe Set and Cemented at 289 feet
Multiple Stage Cementing Collar Used? Yes No
If yes, show depth set...feet
If alternate 2 completion, cement circulated
from...feet depth to...w/...SX cmt
Cement Company Name Halliburton
Invoice # 401 347

Surface Water...Ft North from Southeast Corner
(Stream, pond etc)...Ft West from Southeast Corner
Sec Twp Rge East West
Other (explain)
(purchased from city, R.W.D. #)

INSTRUCTIONS: This form shall be completed in triplicate and filed with the Kansas Corporation Commission, 200 Colorado Derby Building, Wichita, Kansas 67202, within 120 days of the spud date of any well. Rule 82-3-130, 82-3-107 and 82-3-106 apply. Information on side two of this form will be held confidential for a period of 12 months if requested in writing and submitted with the form. See rule 82-3-107 for confidentiality in excess of 12 months. One copy of all wireline logs and drillers time log shall be attached with this form. Submit CP-4 form with all plugged wells. Submit CP-111 form with all temporarily abandoned wells.

All requirements of the statutes, rules and regulations promulgated to regulate the oil and gas industry have been fully complied with and the statements herein are complete and correct to the best of my knowledge.

Signature [Signature]
Title Sec-Treas Date 11/3/86

K.C.C. OFFICE USE ONLY
F Letter of Confidentiality Attached
C Wireline Log Received
C Drillers Timelog Received
Distribution
 KCC SWD/Rep NGPA
 KGS Plug Other
(Specify)

Subscribed and sworn to before me this 3rd day of November 1986
Notary Public [Signature]
Date Commission Expires 10-23-1990

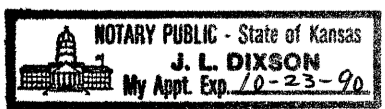

NOV 17 11-17-86

Sec 15 Twp 1S Rge 33E

Operator Name Double R Oil Co. Lease Name Vap "A" Well # 1-5615

Sec. 15 Twp. 1S Rge. 33W East West County Rawlins

WELL LOG

INSTRUCTIONS: Show important tops and base of formations penetrated. Detail all cores. Report all drill stem tests giving interval tested, time tool open and closed, flowing and shut-in pressures, whether shut-in pressure reached static level, hydrostatic pressures, bottom hole temperature, fluid recovery, and flow rates if gas to surface during test. Attach extra sheet if more space is needed. Attach copy of log.

Drill Stem Tests Taken Yes No
 Samples Sent to Geological Survey Yes No
 Cores Taken Yes No

DST #1 LKC "C" 3924-3960
 Times 20-60-60-60
 Rec 3 ft oil
 65 ft oil cut mud (15%oil-85% mud)
 30 GIP

SIP 270-269 HP 2009-2003
 FP 40-40 / 55-55

DST #2 LKC "D" 3970-4030
 Times 15-60-20-0-
 Rec 5 ft mud w/ few oil spots
 SIP 501-0 HP 2065-2043
 FP 53-53 / 55-55

Formation Description		
Name	Top	Bottom
Anhy	2755	2790
Oread	3800	
Heebner	3817	
LKC A	3861	
B	3913	
C	3948	
D	4004	
E	4046	
F	4087	

CASING RECORD New Used
 Report all strings set-conductor, surface, intermediate, production, etc.

Purpose of String	Size Hole Drilled	Size Casing Set (in O.D.)	Weight Lbs/Ft.	Setting Depth	Type of Cement	#Sacks Used	Type and Percent Additives
Surface	12 1/4	8 5/8		289	60/40 poz	200	3%cc
Production	7 7/8	4 1/2		4149	IT	275	3/4 CFR 2 1/4 D PER 7 1/2" GEL
					60/40poz	175	10% SALT

Shots Per Foot	Specify Footage of Each Interval Perforated	Acid, Fracture, Shot, Cement Squeeze Record (Amount and Kind of Material Used)	Depth
4	3948 - 3954	300 GAL MCA 500 GAL NON-E 6000 GAL SBR w/4000 GAL GELLED PAD E. 6361 OVERFLUSH. RAN 30 BALL	

TUBING RECORD	Size 2 3/8	Set At 3975	Packer at	Liner Run <input type="checkbox"/> Yes <input checked="" type="checkbox"/> No
---------------	---------------	----------------	-----------	---

Date of First Production 8/6/86	Producing Method <input type="checkbox"/> Flowing <input checked="" type="checkbox"/> Pumping <input type="checkbox"/> Gas Lift <input type="checkbox"/> Other (explain).....
------------------------------------	--

Estimated Production Per 24 Hours	Oil	Gas	Water	Gas-Oil Ratio	Gravity
	165 Bbls	MCF	- 0 - Bbls	CFPB	39

METHOD OF COMPLETION Production Interval

Disposition of gas: Vented Open Hole Perforation
 Sold Other (Specify) 3948-3954
 Used on Lease Dually Completed
 Commingled