

KANSAS DRILLERS LOG

○ **IMPORTANT**
 Kans. Geo. Survey request
 samples on this well. ○

S. 9 T. 1 R. 33 ~~W~~
 Loc. SE NW
 County Rawlins

API No. 15 — 153 — 20,170 - 0000
County Number

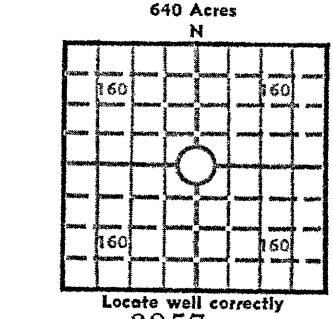

Elev.: Gr. 2957
 DF 2959 KB 2962

Operator Chief Drilling Co. & Bill J. Porter	
Address 905 Century Plaza Wichita, Kansas	
Well No. #1	Lease Name Bucy
Footage Location feet from (N) (S) line feet from (E) (W) line	
Principal Contractor Chief Drilling Co., Inc.	Geologist Don D. Strong
Spud Date 10/7/73	Total Depth 4150'
Date Completed 10/16/73	P.B.T.D.
Oil Purchaser	

CASING RECORD

Report of all strings set — surface, intermediate, production, etc.

Purpose of string	Size hole drilled	Size casing set (in O.D.)	Weight lbs/ft.	Setting depth	Type cement	Sacks	Type and percent additives
	12 1/4"	8 5/8"	28#	252'	Common Quick Set	160	

LINER RECORD

PERFORATION RECORD

Top, ft.	Bottom, ft.	Sacks cement	Shots per ft.	Size & type	Depth interval

TUBING RECORD		
Size	Setting depth	Packer set at

ACID, FRACTURE, SHOT, CEMENT SQUEEZE RECORD

Amount and kind of material used	Depth interval treated

INITIAL PRODUCTION

Date of first production		Producing method (flowing, pumping, gas lift, etc.)			
RATE OF PRODUCTION PER 24 HOURS	Oil	Gas	Water	Gas-oil ratio	
	bbbls.	MCF	bbbls.	CFPB	
Disposition of gas (vented, used on lease or sold)			Producing interval (s)		

RECEIVED
 STATE CORPORATION COMMISSION
OCT 19 1973
 CONSERVATION DIVISION
 Wichita, Kansas
10-19-73

INSTRUCTIONS: As provided in KCC Rule 82-2-125, within 90 days after completion of a well, one completed copy of this Drillers Log shall be transmitted to the State Geological Survey of Kansas, 4150 Monroe Street, Wichita, Kansas 67209. Copies of this form are available from the Conservation Division, State Corporation Commission, 3830 So. Meridian (P.O. Box 17027), Wichita, Kansas 66217. Phone AC 316-522-2206. If confidential custody is desired, please note Rule 82-2-125. Drillers Logs will be on open file in the Oil and Gas Division, State Geological Survey of Kansas, Lawrence, Kansas 66044.

Operator Chief Drilling Co., Inc. & Bill J. Porter DESIGNATE TYPE OF COMP.: OIL, GAS, DRY HOLE, SWDW, ETC.:

Well No. 1 Lease Name Bucy Dry Hole

S 9 T 1 R 33 W E

WELL LOG
 Show all important zones of porosity and contents thereof; cored intervals, and all drill-stem tests, including depth interval tested, cushion used, time tool open, flowing and shut-in pressures, and recoveries. SHOW GEOLOGICAL MARKERS, LOGS RUN, OR OTHER DESCRIPTIVE INFORMATION.

FORMATION DESCRIPTION, CONTENTS, ETC.	TOP	BOTTOM	NAME	DEPTH
DST #1 3783-3830' Oread Open 2 hour Rec. 120' muddy water w/scum of oil 1100' water IBHP: 995#/30" FBHP: 980#/45" FP: 42-605#			<u>FORMATION</u>	<u>TOPS</u>
			Anhydrite	2804+ 156
			Base Anhy.	2843+ 117
			Oread	3815- 853
			Lansing	3891- 929
			R.T.D.	4150-1188
DST #2 3906-3950' 50' zone Open 1 hour Rec. 10' oil specked mud 2' free oil IBHP: 1030#/30" FBHP: 980#/30" FP: 35-45#			<u>NO LOG</u>	
DST #3 3953-4000' 100' zone Open 1 hour Rec. 5' mud All pressures 35#				
DST #4 3998-4060' 140' zone Open 1 hour Rec. 10' mud IBHP: 375#/30" FBHP: 190#/30" FP: 40-40#				
DST #5 4048-4100' 180' zone Open 1 hour Rec. 5' mud IBHP: 177#/30" FBHP: 70#/30" FP: 40-45#				
DST #6 4093-4150' 200' zone IBHP: 1055#/30" FBHP: 945#/30" Open 1 hour FP: 45-45# Rec. 15' mud				

USE ADDITIONAL SHEETS, IF NECESSARY, TO COMPLETE WELL RECORD.

Date Received _____

 Signature
 Vice President
 Title
 October 18, 1973
 Date