

13-193-20197-00-00

STATE OF KANSAS  
STATE CORPORATION COMMISSION

Give All Information Completely  
Make Required Affidavit  
Mail or Deliver Report to:  
Conservation Division  
State Corporation Commission  
P. O. Box 17027  
Wichita, Kansas 67217  
NORTH

WELL PLUGGING RECORD

Rawlins County. Sec. 34 Twp. 1S Rge. 33 (W)

Location as "NE/CNW&SW&" or footage from lines C SE NW

Lease Owner Abercrombie Drilling, Inc.

Lease Name Wolters Well No. #1

Office Address 801 Union Center, Wichita, Kansas 67202

Character of Well (completed as Oil, Gas or Dry Hole) Dry Hole

Date well completed September 4, 1975

Application for plugging filed (verbally) September 4, 1975

Application for plugging approved (verbally) September 4, 1975

Plugging commenced September 4, 1975

Plugging completed September 4, 1975

Reason for abandonment of well or producing formation No commercial quantity of oil or gas encountered.

If a producing well is abandoned, date of last production 19

Was permission obtained from the Conservation Division or its agents before plugging was commenced? Yes

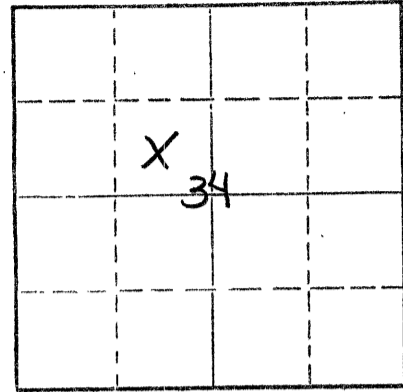

Locate well correctly on above Section Plat

Name of Conservation Agent who supervised plugging of this well Leo Massey

Producing formation Depth to top Bottom Total Depth of Well 4255' Feet

Show depth and thickness of all water, oil and gas formations.

OIL, GAS OR WATER RECORDS

CASING RECORD

FORMATION	CONTENT	FROM	TO	SIZE	PUT IN	PULLED OUT
				8 5/8"	280.67'	None

Describe in detail the manner in which the well was plugged, indicating where the mud fluid was placed and the method or methods used in introducing it into the hole. If cement or other plugs were used, state the character of same and depth placed, from feet to feet for each plug set.

1st Plug Set @ 2000' with 70 sx. cement  
2nd Plug Set @ 250' with 20 sx. cement  
3rd Plug Set @ 40' with 10 sx. cement  
Plug was down @ 8:45 p.m. September 4, 1975

RECEIVED  
STATE CORPORATION COMMISSION

SEP 11 1975

9-11-75

CONSERVATION DIVISION  
Wichita, Kansas

Name of Plugging Contractor Abercrombie Drilling, Inc.  
Address 801 Union Center, Wichita, Kansas 67202

STATE OF KANSAS COUNTY OF SEDGWICK, ss.

Jerry A. Langrehr-Exec. V.P. (employee of owner) or (owner or operator) of the above-described

well, being duly sworn on oath, says: That I have knowledge of the facts, statements, and matters herein contained and the log of the above-described well as filed and that the same are true and correct. So help me God.

(Signature) Jerry A. Langrehr

801 Union Center, Wichita, Kansas 67202 (Address)

Subscribed and sworn to before me this 10th day of September, 1975

Sandra Russell  
Sandra Russell Notary Public.

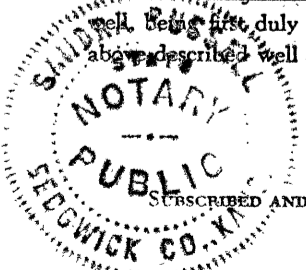

My commission expires July 21, 1979

**KANSAS DRILLERS LOG**

S. 34 T. 1S R. 33 <sup>NE</sup> <sub>W</sub>

API No. 15 — 153 — 20,197 - 00-00  
County Number

Loc. C SE NW

County Rawlins

Operator  
Abercrombie Drilling, Inc.

Address  
801 Union Center, Wichita, Kansas 67202

Well No. #1 Lease Name WOLTERS

Footage Location  
1980 feet from (N) Q line 1980 feet from (W) line

Principal Contractor Abercrombie Drilling, Inc. Geologist Jack K. Wharton

Spud Date August 28, 1975 Total Depth 4255' P.B.T.D.

Date Completed September 4, 1975 Oil Purchaser

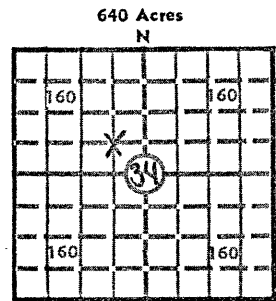

Locate well correctly  
 Elev.: Gr. 3049'

DF 3052' KB 3054'

**CASING RECORD**

Report of all strings set — surface, intermediate, production, etc.

Purpose of string	Size hole drilled	Size casing set (in O.D.)	Weight lbs/ft.	Setting depth	Type cement	Sacks	Type and percent additives
Surface	12 1/4"	8-5/8"		280.67'	Sunset Cem.	165	None

**LINER RECORD**

**PERFORATION RECORD**

Top, ft.	Bottom, ft.	Sacks cement	Shots per ft.	Size & type	Depth interval

**TUBING RECORD**

Size	Setting depth	Packer set at

**ACID, FRACTURE, SHOT, CEMENT SQUEEZE RECORD**

Amount and kind of material used	Depth interval treated

RECEIVED  
 STATE CORPORATION COMMISSION  
 SEP 11 1975  
 9-11-75  
 CONSERVATION DIVISION  
 WICHITA, KANSAS

**INITIAL PRODUCTION**

Date of first production		Producing method (flowing, pumping, gas lift, etc.)			
RATE OF PRODUCTION PER 24 HOURS	Oil	Gas	Water	Gas-oil ratio	
	bbls.	MCF	bbls.	CFPB	
Disposition of gas (vented, used on lease or sold)			Producing interval (s)		

**INSTRUCTIONS:** As provided in KCC Rule 82-2-125, within 90 days after completion of a well, one completed copy of this Drillers Log shall be transmitted to the State Geological Survey of Kansas, 4150 Monroe Street, Wichita, Kansas 67209. Copies of this form are available from the Conservation Division, State Corporation Commission, 3830 So. Meridian (P.O. Box 17027), Wichita, Kansas 66217. Phone AC 316-522-2206. If confidential custody is desired, please note Rule 82-2-125. Drillers Logs will be on open file in the Oil and Gas Division, State Geological Survey of Kansas, Lawrence, Kansas 66044.

Operator Abercrombie Drilling, Inc.		DESIGNATE TYPE OF COMP.: OIL, GAS, DRY HOLE, SWDW, ETC.:
Well No. #1	Lease Name WOLTERS	DRY HOLE
S 34 T 1S R 33 E W		

**WELL LOG**

Show all important zones of porosity and contents thereof; cored intervals, and all drill-stem tests, including depth interval tested, cushion used, time tool open, flowing and shut-in pressures, and recoveries.

SHOW GEOLOGICAL MARKERS, LOGS RUN, OR OTHER DESCRIPTIVE INFORMATION.

FORMATION DESCRIPTION, CONTENTS, ETC.	TOP	BOTTOM	NAME	DEPTH
Surface Dirt & Sand	0	240	<u>ELECTRIC LOG</u>	<u>TOPS:</u>
Shale	240	286		
Sand & Shale	286	1145	Anhydrite	2871'
Shale & Sand	1145	2706	B/Anhydrite	2909'
Shale	2706	2865	Oread	3951'
Anhydrite	2865	2908	Lansing	4008'
Shale	2908	3320	B/Kansas City	4246'
Shale & Lime	3320	3505	RTD	4255'
Lime & Shale	3505	4000	ELTD	4255'
Lime	4000	4255		
Rotary Total Depth		4255		
<p>DST #1 (4020'-4065') 30", 30", 60", 30"            Weak blow. Rec. 186' SOCM. 310' SW with            scum of oil. IFP 47-118#; IBHP 1287#;            FFP 142-272#; FBHP 1264#. (127°)            DST #2 (4064'-4120') 30", 30", 60", 45"            Weak blow inc. to good. Rec. 218' VHOCM            IFP 35-47#; IBHP 1276#; FFP 71-94#;            FBHP 1241#. (127°)            DST #3 (4106'-4155') 30", 45", 60", 45"            Strong blow. Rec. 5' free oil (33°) 30'            HOCM, 248' OCM; 248' HO muddy water;            124' MW; IFP 45-130#; IBHP 1287#; FFP            153-195#; FBHP 1253#. Temp (127°)            DST #4 (4156'-4210') 30", 30", 30", 30"            Weak blow for 10 min. Mud. IFP 35-35#;            IBHP 1322#; FFP 35-35#; FBHP 1253#.            Temp. (127°)</p>				

USE ADDITIONAL SHEETS, IF NECESSARY, TO COMPLETE WELL RECORD

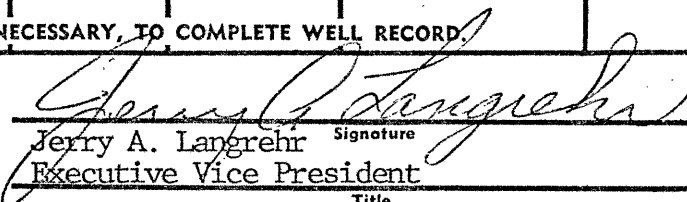
Date Received	 _____ Jerry A. Langrehr <small>Signature</small> Executive Vice President _____ <small>Title</small>
	September 8, 1975 _____ <small>Date</small>