

EFFECTIVE DATE: 5-22-90

FORM MUST BE TYPED  
FORM C-1 4/90

State of Kansas  
NOTICE OF INTENTION TO DRILL

FORM MUST BE SIGNED  
ALL BLANKS MUST BE FILLED

Must be approved by the K.C.C. five (5) days prior to commencing well

Expected Spud Date May 17 1990 C NE SE Sec 25 Twp 1 S, Rg 33 X East  
month day year

OPERATOR: License # 3602  
Name: Philpott Oil & Gas Co., Inc.  
Address: 408 Main, P.O. Box 450  
City/State/Zip: Atwood, KS 67730  
Contact Person: Roger W. Philpott  
Phone: (913) 626-3011

1980 feet from South line of Section  
660 feet from East line of Section  
(Note: Locate well on Section Plat on Reverse Side)

CONTRACTOR: License #: 5422  
Name: Abercrombie Drilling Co.

County: Rawlins  
Lease Name: Simminger "A" Well #: 1-0925  
Field Name: Unassigned

Well Drilled For: Well Class: Type Equipment:  
 Oil ... Inj ... Infield  Mud Rotary  
... Gas ... Storage ... Pool Ext. ... Air Rotary  
... OWWO ... Disposal  Wildcat ... Cable  
... Seismic; ... # of Holes

Is this a Prorated Field? ... yes  no  
Target Formation(s): Lansing-Kansas City  
Nearest lease or unit boundary: 660 ft  
Ground Surface Elevation: 3039 feet MSL

If OWWO: old well information as follows:  
Operator: \_\_\_\_\_  
Well Name: \_\_\_\_\_  
Comp. Date: \_\_\_\_\_ Old Total Depth \_\_\_\_\_

Domestic well within 330 feet: ... yes  no  
Municipal well within one mile: ... yes  no  
Depth to bottom of fresh water: 160  
Depth to bottom of usable water: 225

Directional, Deviated or Horizontal wellbore? ... yes  no  
If yes, total depth location: \_\_\_\_\_

Surface Pipe by Alternate:  1 ... 2  
Length of Surface Pipe Planned to be set: ~~250~~ 300  
Length of Conductor pipe required: \_\_\_\_\_  
Projected Total Depth: 4300  
Formation at Total Depth: Lansing-Kansas City

Water Source for Drilling Operations:  
 well ... farm pond ... other  
DWR Permit #: \_\_\_\_\_  
Will Cores Be Taken?: ... yes  no  
If yes, proposed zone: \_\_\_\_\_

**AFFIDAVIT**

The undersigned hereby affirms that the drilling, completion and eventual plugging of this well will comply with K.S.A. 55-101, et. seq.

- It is agreed that the following minimum requirements will be met:
1. The appropriate district office shall be notified before setting surface pipe;
  2. The minimum amount of surface pipe as specified above shall be set by circulating cement to the top; in all cases surface pipe shall be set through all unconsolidated materials plus a minimum of 20 feet into the underlying formation;
  3. If the well is dry, a plugging proposal shall be submitted to the district office. An agreement between the operator and the district office on plug length and placement is necessary prior to plugging;
  4. The appropriate district office will be notified before well is either plugged or production casing is cemented in;
  5. If an Alternate II completion, production pipe shall be cemented from below any usable water to surface within 120 days of spud date. In all cases, notify district office prior to any cementing.

I hereby certify that the statements made herein are true and to the best of my knowledge and belief.  
Date: 5/15/1990 Signature of Operator or Agent: [Signature] Title: President

FOR KCC USE:  
API # 15- 153-20754-00-00  
Conductor pipe required None feet  
Minimum surface pipe required 300 feet per Alt. 1  
Approved by: 200 5-17-90  
EFFECTIVE DATE: 5-22-90  
This authorization expires: 11-17-90  
(This authorization void if drilling not started within 6 months of effective date.)  
Spud date: \_\_\_\_\_ Agent: \_\_\_\_\_

MAY 17 1990  
5-17-90  
CONSERVATION DIVISION  
Wichita, Kansas

**REMEMBER TO:**

- File Drill Pit Application (form CDP-1) with Intent to Drill;
- File Completion Form ACO-1 within 120 days of spud date;
- File acreage attribution plat according to field proration orders;
- Notify appropriate district office 48 hours prior to workover or re-entry;
- Submit plugging report (CP-4) after plugging is completed;
- Obtain written approval before disposing or injecting salt water.

**PLAT OF ACREAGE ATTRIBUTABLE TO A WELL**

State Corporation Commission, Conservation Division  
200 Colorado Derby Bldg. Wichita, Kansas 67202

OPERATOR Philpott Oil & Gas Co., Inc. LOCATION OF WELL:  
 LEASE Simminger "A" 1980 feet north of SE corner  
 WELL NUMBER 1-0925 660 feet west of SE corner  
 FIELD \_\_\_\_\_ SE/4 Sec. 25 T 1s R 33 X/W  
 COUNTY Rawlins  
 NO. OF ACRES ATTRIBUTABLE TO WELL \_\_\_\_\_ IS SECTION X REGULAR \_\_\_\_\_ IRREGULAR?  
 DESCRIPTION OF ACREAGE \_\_\_\_\_ IF IRREGULAR, LOCATE WELL FROM NEAREST  
 CORNER BOUNDARY.

**NOTE:** If plat depicted is insufficient for your circumstances, you may attach your own scaled or surveyed plat.

**PLAT**

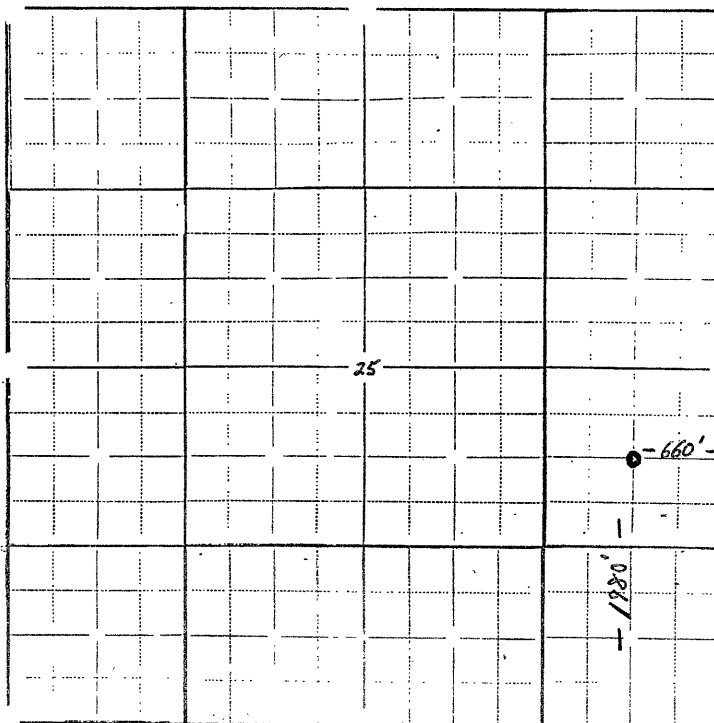

In plotting the proposed location of the well, you must show:

- 1) The manner in which you are using the depicted plat by identifying section lines, i.e. 1 section, 1 section with 8 surrounding partial sections, 4 sections, 16 sections, etc.;
- 2) the well's location relative to the location of other wells producing from the same common source of supply in adjoining drilling units, pursuant to K.A.R. 82-3-108, 82-3-207, 82-3-312, or special orders of the Commission;
- 3) the distance of the proposed drilling location from the section's east and south lines; and
- 4) the distance to the nearest lease or unit boundary line.

I hereby certify that the statements made herein are true and to the best of my knowledge and belief.

Signature of Operator or Agent Roger W. Bluff  
 Date 5/15/1990 Title President