

ORIGINAL CONFIDENTIAL 1992

SIDE ONE

STATE CORPORATION COMMISSION OF KANSAS
OIL & GAS CONSERVATION DIVISION
WELL COMPLETION FORM
ACO-1 WELL HISTORY
DESCRIPTION OF WELL AND LEASE

API NO. 15- 153-20,762-00-00 FROM CONFIDENTIAL

County Rawlins
C NW NE Sec. 20 Twp. 1S Rge. 32 East West

Operator: License # 3602

4620 Ft. North from Southeast Corner of Section

Name: Philpott Oil & Gas Co., Inc.

1980 Ft. West from Southeast Corner of Section
(NOTE: Locate well in section plat below.)

Address P. O. Box 450

Lease Name Wilhelm Unit Well # 25

City/State/Zip Atwood, KS 67730

Field Name Wilhelm

Purchaser: Clear Creek

Producing Formation Lansing Kansas City

Operator Contact Person: Roger W. Philpott

Elevation: Ground 2974' KB 2982'

Phone (913) 626-3011

Total Depth 4200' PBDT 4200'

Contractor: Name: Golden Eagle Drilling, Inc.

License: 8682

Wellsite Geologist: John A. Rundel

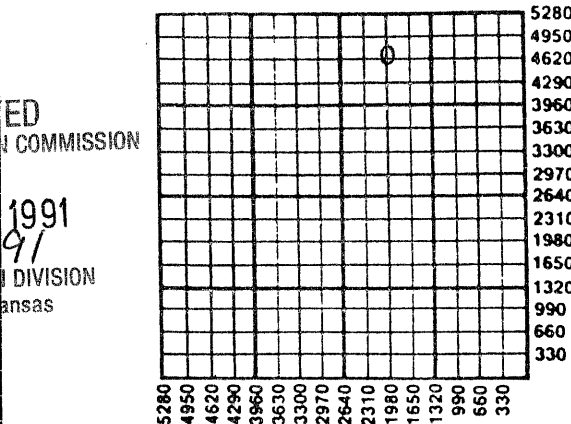

Designate Type of Completion
 New Well Re-Entry Workover
 Oil SWD Temp. Completion
 Gas Inj Delayed Completion
 Dry Other (Core, Water Supply, etc.)

RECEIVED
STATE CORPORATION COMMISSION
FEB 18 1991
OBSERVATION DIVISION
Wichita, Kansas

If ~~CMO~~ old well info as follows:
Operator: _____

Amount of Surface Pipe Set and Cemented at 292 Feet

Well Name: _____

Multiple Stage Cementing Collar Used? Yes No

Comp. Date _____ Old Total Depth _____

If yes, show depth set _____ Feet

Drilling Method:
 Mud Rotary Air Rotary Cable

If Alternate II completion, cement circulated from _____

10/24/1990 10/30/1990 12/28/1990

feet depth to _____ w/ _____ sx cmt.

Spud Date Date Reached TD Completion Date

INSTRUCTIONS: This form shall be completed in triplicate and filed with the Kansas Corporation Commission, 200 Colorado Derby Building, Wichita, Kansas 67202; within 120 days of the spud date of any well. Rule 82-3-130, 82-3-107 and 82-3-106 apply. Information on side two of this form will be held confidential for a period of 12 months if requested in writing and submitted with the form. See rule 82-3-107 for confidentiality in excess of 12 months. One copy of all wireline logs and drillers time log shall be attached with this form. ALL CEMENTING TICKETS MUST BE ATTACHED. Submit CP-4 form with all plugged wells. Submit CP-111 form with all temporarily abandoned wells. Any recompletion, workover or conversion of a well requires filing of ACO-2 within 120 days from commencement date of such work.

All requirements of the statutes, rules and regulations promulgated to regulate the oil and gas industry have been fully complied with and the statements herein are complete and correct to the best of my knowledge.

Signature [Signature]
Title President Date 2/15/1991

Subscribed and sworn to before me this 15th day of February, 1991.

Notary Public J. L. Dixon

Date Commission Expires 10-23-94

K.C.C. OFFICE USE ONLY
F Letter of Confidentiality Attached
C Wireline Log Received
C Drillers Timelog Received
Distribution
 KCC SWD/Rep NGPA
 KGS Plug Other (Specify)



CONFIDENTIAL

SIDE TWO

Operator Name Philpott Oil & Gas Co., Inc.

Lease Name Wilhelm Unit

Well # 25

Sec. 20 Twp. 1S Rge. 32

East

County Rawlins

West

INSTRUCTIONS: Show important tops and base of formations penetrated. Detail all cores. Report all drill stem tests giving interval tested, time tool open and closed, flowing and shut-in pressures, whether shut-in pressure reached static level, hydrostatic pressures, bottom hole temperature, fluid recovery, and flow rates if gas to surface during test. Attach extra sheet if more space is needed. Attach copy of log.

Drill Stem Tests Taken Yes No
(Attach Additional Sheets.)

Samples Sent to Geological Survey Yes No

Cores Taken Yes No

Electric Log Run Yes No
(Submit Copy.)

See Attached

Formation Description

Log Sample

Name Top Bottom

See Attached

CASING RECORD

New Used

Report all strings set-conductor, surface, intermediate, production, etc.

Purpose of String	Size Hole Drilled	Size Casing Set (In O.D.)	Weight Lbs./Ft.	Setting Depth	Type of Cement	# Sacks Used	Type and Percent Additives
Surface	12 1/4"	8 5/8"	19.5	292	60/40 Poz	180	3% cc, 2% gel
Production	7 7/8"	4 1/4"	10.5	4195	HDL	220	1/4# Flocele
					HLC	200	No add.
					STD	125	10% salt, 75% CRF-2

PERFORATION RECORD

Shots Per Foot Specify Footage of Each Interval Perforated

4	4116 - 4120 (4 ft)
4	4074 - 4078 (4 ft)
4	3974 - 3984 (10 ft)
4	3942 - 3945 (3 ft)
4	3950 - 3954 (4 ft)

18 bbl Salt Flush
Acid, Fracture, Shot, Cement Squeeze Record
(Amount and Kind of Material Used) Depth

300 gal. 15% Non-E Acid	4120
Retreat 1500 gal. 15% Non-E Acid	
400 gal. 15% MCA Acid	4078
Retreat 4000 gal. 15% CRA	
750 gal. 15% Non-E Acid with 18 peri balls.	3984
750 gal. 15% Non-E Acid (18 peri balls)	3954
Retreat 2000 gal 15% CRA, 1000 gal gel Liner Run pad, with 20 peri balls.	

TUBING RECORD Size 2 3/8 Set At 4141.63 Packer At None

Date of First Production 12/28/90 Producing Method Flowing Pumping Gas Lift Other (Explain)

Estimated Production Per 24 Hours	Oil	Bbls.	Gas	Mcf	Water	Bbls.	Gas-Oil Ratio	Gravity
		10				190		33.5

Disposition of Gas:

METHOD OF COMPLETION

Production Interval

Vented Sold Used on Lease
(If vented, submit ACO-18.)

Open Hole Perforation Dually Completed Commingled

Other (Specify) _____

DST #1 3955-3995 40' interval Lansing-Kansas City

RELEASED
CONFIDENTIAL
MAR 05 1992

IF 30 Min. ISI 60 Min. FF 30 Min. FSI 60 Min.

IF: weak blow building to bottom of bucket in 13 min.

FF: weak blow building to 10" in 30 min.

FROM CONFIDENTIAL

Recovery: 530' total fluid

2' clean gassy oil, gravity 36 API @ 60°F

154' slightly oil cut watery mud, 5% oil, 25% water, 70% mud.

374' muddy water with scum of oil, 80% water, 20% mud.

Pressures: IHP 1938
IFP 79-205
ISIP 358
FFP 240-266
FSIP 358
FHP 1899
BHT 120°F

DST #2 4050-4100 50' interval Lansing-Kansas City "E"

IF 30 Min. ISI 60 Min. FF 30 Min. FSI 60 Min.

IF: weak blow building to 5 1/2" in water in 30 min.

FF: fair blow building from 1/4" to 7" in water in 30 min.

Recovery: 122' total fluid, 218' gas in pipe

3' clean gassy oil, gravity 36 @ 60°F

119' mud cut gassy oil, 50% oil, 5% gas, 45% mud.

Pressures: IHP 2018
IFP 78-88
ISIP 849
FFP 104-114
FSIP 804
FHP 1974
BHT 120°F

RECEIVED
STATE CORPORATION COMMISSION2-18-1991
FEB 18 1991CONSERVATION DIVISION
Wichita, Kansas

Formation Description

ORIGINAL

RELEASED

Name	Top	Bottom
Stone Corral	2746	+ 236
Base Stone Corral	2784	+ 198
Topeka	3738	- 756
Deer Creek	3788	- 806
Oread	3844	- 862
Douglas Sand	3872	- 890
Lansing-Kansas City "A"	3891	- 909
Lansing-Kansas City "B"	3942	- 960
Lansing-Kansas City "C"	3972	- 990
Lansing-Kansas City "D"	4028	- 1046
Lansing-Kansas City "E"	4074	- 1092
Lansing-Kansas City "F"	4115	- 1133
Base Lansing-Kansas City	4167	- 1185
R.T.D.	4200	
L.T.D.	4198	

CONFIDENTIAL 5/1992
FROM CONFIDENTIAL

RECEIVED
STATE CORPORATION COMMISSION
2-18-91
FEB 18 1991

CONSERVATION DIVISION
Wichita, Kansas

PLAT AND CERTIFICATION OF ACREAGE ATTRIBUTABLE TO AN OIL WELL

State Corporation Commission, Conservation Division
200 Colorado Derby Bldg. Wichita, Kansas 67202

OPERATOR Philpott Oil & Gas Co., Inc.
LEASE NAME Wilhelm Unit
WELL NUMBER 25
FIELD Wilhelm
NUMBER OF ACRES ATTRIBUTED TO WELL 80

LOCATION OF WELL:

4620 feet north of SE corner
1980 feet west of SE corner
NE/4 Sec. 20 T. 1S R. 32 W
COUNTY Rawlins

PLAT

(Show location of well and shade attributable acreage)
(Show footage to nearest lease or unit boundary line)

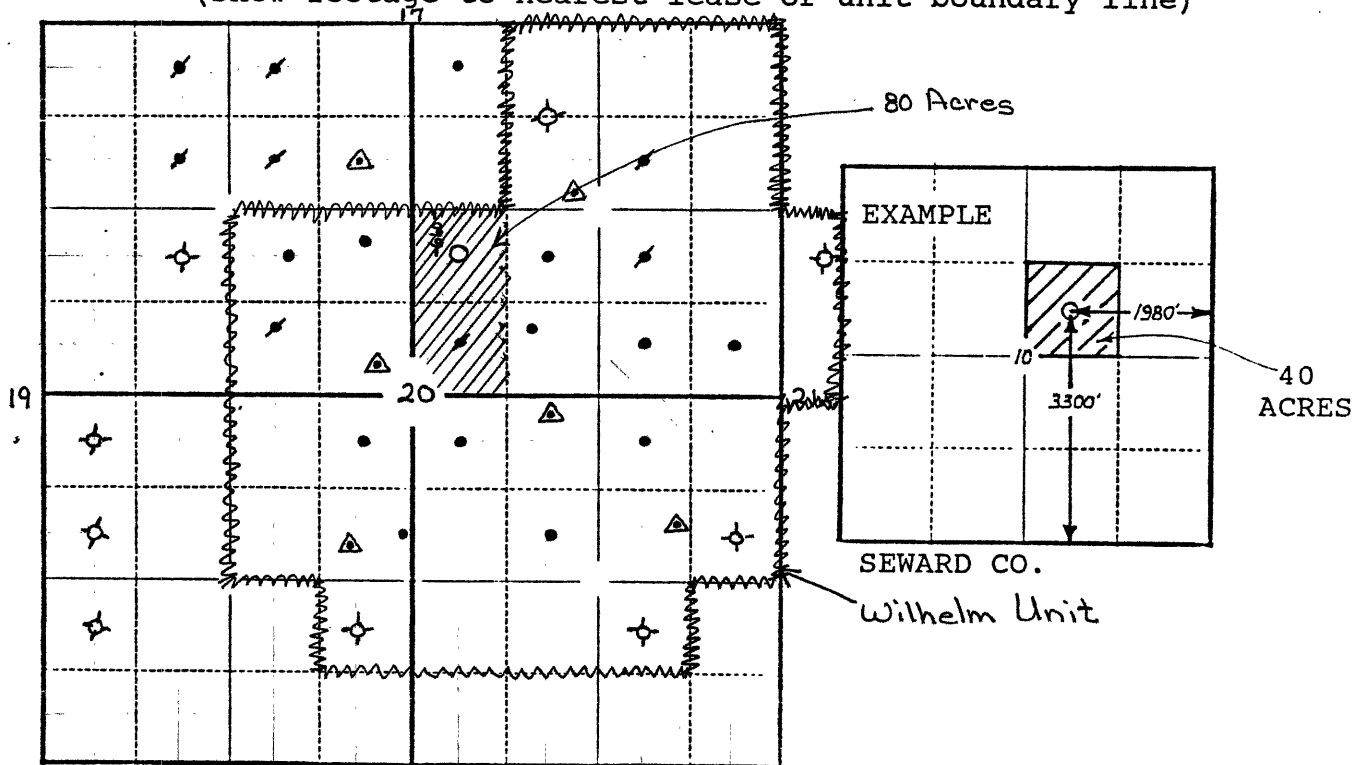

The undersigned hereby certifies that he is President
for Philpott Oil & Gas Co., Inc. (Co.), a duly authorized agent, that all
information shown hereon is true and correct to the best of his knowledge and
belief, and that all acreage claimed as attributable to the well named herein
is held by production from that well.

Subscribed and sworn to before me on this 17th day of October, 19 90

My Commission expires 10-23-90

[Signature]
Notary Public

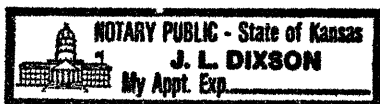

RECEIVED
STATE CORPORATION COMMISSION
(6-1989)
OCT 18 1990
10-18-90
CONSERVATION DIVISION
Wichita, Kansas



P.O. BOX 951048
DALLAS, TX 75395-1048

HALLIBURTON SERVICES

RELEASED ORIGINAL
MAY 05 1991

A Halliburton Company

INVOICE

INVOICE NO.	DATE
863543	10/25/1990

WELL LEASE NO./PLANT NAME		WELL/PLANT LOCATION		STATE	WELL/PLANT OWNER
WILHELM UNIT 25		RAWLINS		KS	PHILPOTT
SERVICE LOCATION	CONTRACTOR	JOB PURPOSE		TICKET DATE	
OBERLEN	GOLDEN EAGLE DRLG	CEMENT SURFACE CASING		10/25/1990	
ACCT NO.	CUSTOMER AGENT	VENDOR NO.	CUSTOMER P.O. NUMBER	SHIPPED VIA	FILE NO.
684689	MARK HUDSON			COMPANY TRUCK	04683

PD BY CR# 806 \$8,587.92

PHILPOTT OIL & GAS COMPANY INC
P. O. BOX 450
ATWOOD, KS 67730-0450

DIRECT CORRESPONDENCE TO **CONFIDENTIAL**
SUITE 1300
LIBERTY TOWER
100 BROADWAY AVENUE
OKLAHOMA CITY, OK 73102-0000

PRICE REF. NO.	DESCRIPTION	QUANTITY	U/M	UNIT PRICE	AMOUNT
000-117	PRICING AREA - MID CONTINENT MILEAGE	35	MI	2.35	82.25
001-016	CEMENTING CASING	292	FT	440.00	440.00
030-503	CMTG PLUG LA-11,CP-1,CP-3, TOP	8	5/8 IN	59.00	59.00
504-308	STANDARD CEMENT	108	SK	6.75	729.00 *
506-105	POZMIX A	72	SK	3.50	252.00 *
506-121	HALLIBURTON-GEL 2%	3	SK	.00	N/C *
509-406	ANHYDROUS CALCIUM CHLORIDE	6	SK	25.75	154.50 *
500-207	BULK SERVICE CHARGE	192	CFT	1.10	211.20 *
500-306	MILEAGE CMTG MAT DEL OR RETURN	284.55	TMI	.75	213.41 *
INVOICE SUBTOTAL					2,141.36
DISCOUNT-(BID)					428.27
INVOICE BID AMOUNT					1,713.09
*-KANSAS STATE SALES TAX					53.05
*-DECATUR COUNTY SALES TAX					12.49
INVOICE TOTAL - PLEASE PAY THIS AMOUNT					\$1,778.63

RECEIVED
STATE CORPORATION COMMISSION

FEB 18 1991

CONSERVATION DIVISION
Wichita, Kansas

TERMS INVOICES PAYABLE NET BY THE 20TH OF THE FOLLOWING MONTH AFTER DATE OF INVOICE. UPON CUSTOMER'S DEFAULT IN PAYMENT OF CUSTOMER'S ACCOUNT BY THE LAST DAY OF THE MONTH FOLLOWING THE MONTH IN WHICH THE INVOICE IS DATED, CUSTOMER AGREES TO PAY INTEREST THEREON AFTER DEFAULT AT THE HIGHEST LAWFUL CONTRACT RATE APPLICABLE BUT NEVER TO EXCEED 18% PER ANNUM. IN THE EVENT IT BECOMES NECESSARY TO EMPLOY AN ATTORNEY TO ENFORCE COLLECTION OF SAID ACCOUNT, CUSTOMER AGREES TO PAY ALL COLLECTION COSTS AND ATTORNEY FEES IN THE AMOUNT OF 20% OF THE AMOUNT OF THE UNPAID ACCOUNT.

*** CASH JOB ***



NOV 05 1999

P.O. BOX 951046
DALLAS, TX 75395-1046

HALLIBURTON SERVICES

A Halliburton Company

FROM ORIGINAL

INVOICE NO.	DATE
904405	10/30/1990

WELL LEASE NO./PLANT NAME		WELL/PLANT LOCATION		STATE	WELL/PLANT OWNER
WILHELM UNIT 25		RAWLINS		KS	PHILPOTT
SERVICE LOCATION		CONTRACTOR	JOB PURPOSE		TICKET DATE
OBERLIN		GOLDEN EAGLE DRLG	CEMENT PRODUCTION CASING		10/30/1990
ACCT. NO.	CUSTOMER AGENT	VENDOR NO.	CUSTOMER P.O. NUMBER	SHIPPED VIA	FILE NO.
684685	ROGER PHILPOTT			COMPANY TRUCK	04683

PD BY CK# 808 \$8,587.92

PHILPOTT OIL & GAS COMPANY INC
P. O. BOX 450
ATWOOD, KS 67730-0450

RECEIVED
STATE CORPORATION COMMISSION

DIRECT CORRESPONDENCE TO:
SUITE 1300
LIBERTY TOWER
100 BROADWAY AVENUE
OKLAHOMA CITY, OK 73102-0000

CONFIDENTIAL

PRICE REF. NO.	DESCRIPTION	QUANTITY	U/M	UNIT PRICE	AMOUNT
000-117	PRICING AREA - MID CONTINENT MILEAGE	35	MI	2.35	82.25
001-016	CEMENTING CASING	4195	FT	1,200.00	1,200.00
030-016	CEMENTING PLUG SW ALUM TOP	4	1/2 IN	32.00	32.00
12A	GUIDE SHOE - 4 1/2" BRD THD.	1	EA	83.00	83.00
24A	INSERT FLOAT VALVE - 4 1/2" BRD	1	EA	73.00	73.00
27	FILL-UP UNIT 4 1/2"-5"	1	EA	27.50	27.50
40	CENTRALIZER 4-1/2" MODEL S-4	10	EA	41.00	410.00
320	CEMENT BASKET 4 1/2"	3	EA	85.00	255.00
56	WALL CLEANER CABLE TYPE 4 1/2"	12	EA	25.50	306.00
504-308	STANDARD CEMENT	143	SK	6.75	965.25
506-105	POZMIX A	77	SK	3.50	269.75
506-121	HALLIBURTON-GEL 2%	4	BN	.00	N/C
507-277	HALLIBURTON-GEL BENTONITE	15	SK	13.75	206.25
507-285	ECONOLITE	383	LB	.90	344.70
507-210	FLOCELE	55	LB	1.30	71.50
504-308	STANDARD CEMENT	125	SK	6.75	843.75
507-145	CFR-2	88	EA	3.75	330.00
509-968	SALT	541	LB	.10	54.10
504-316	HALLIBURTON LIGHT W/STANDARD	200	SK	6.10	1,220.00
509-968	SALT	300	LB	.10	30.00
500-207	BULK SERVICE CHARGE	605	CHG	1.10	665.50
500-306	MILEAGE CMTG MAT DEL OR RETURN	914.52	TMI	.75	685.89

***** CONTINUED ON NEXT PAGE *****

TERMS INVOICES PAYABLE NET BY THE 20TH OF THE FOLLOWING MONTH AFTER DATE OF INVOICE UPON CUSTOMER'S DEFAULT IN PAYMENT OF CUSTOMER'S ACCOUNT BY THE LAST DAY OF THE MONTH FOLLOWING THE MONTH IN WHICH THE INVOICE IS DATED. CUSTOMER AGREES TO PAY INTEREST THEREON AFTER DEFAULT AT THE HIGHEST LAWFUL CONTRACT RATE APPLICABLE BUT NEVER TO EXCEED 18% PER ANNUM IN THE EVENT IT BECOMES NECESSARY TO EMPLOY AN ATTORNEY TO ENFORCE COLLECTION OF SAID ACCOUNT. CUSTOMER AGREES TO PAY ALL COLLECTION COSTS AND ATTORNEY FEES IN THE AMOUNT OF 20% OF THE AMOUNT OF THE UNPAID ACCOUNT

*** CASH JOB ***



RELEASED

REMIT TO:

P.O. BOX 951046
DALLAS, TX 75395-1046

HALLIBURTON SERVICES

10/05/1990
ORIGINAL



A Halliburton Company

FROM CONFIDENTIAL

INVOICE NO.	DATE
904405	10/30/1990
WELL/PLANT OWNER	

WELL LEASE NO./PLANT NAME		WELL/PLANT LOCATION		STATE	WELL/PLANT OWNER	
WILHELM UNIT 25		RAWLINS		KS	PHILPOTT	
SERVICE LOCATION		CONTRACTOR	JOB PURPOSE		TICKET DATE	
OBERLIN		GOLDEN EAGLE DRG	CEMENT PRODUCTION CASING		10/30/1990	
ACCT. NO.	CUSTOMER AGENT	VENDOR NO.	CUSTOMER P.O. NUMBER	SHIPPED VIA	FILE NO.	
684685	ROGER PHILPOTT			COMPANY TRUCK	04683	

PD BY CK# 808 \$8,587.92

PHILPOTT OIL & GAS COMPANY INC
P. O. BOX 450
ATWOOD, KS 67730-0450

DIRECT CORRESPONDENCE TO
SUITE 1300
LIBERTY TOWER
100 BROADWAY AVENUE
OKLAHOMA CITY, OK 73102-0000

CONFIDENTIAL

PRICE REF. NO.	DESCRIPTION	QUANTITY	U/M	UNIT PRICE	AMOUNT
	INVOICE SUBTOTAL				8,155.19
	DISCOUNT - (BID)				1,631.03
	INVOICE BID AMOUNT				6,524.16
	*- KANSAS STATE SALES TAX				230.82
	*- DECATUR COUNTY SALES TAX				54.31
	INVOICE TOTAL - PLEASE PAY THIS AMOUNT				\$6,809.29

RECEIVED
STATE CORPORATION COMMISSION

FEB 18 1991

CONSERVATION DIVISION
Wichita, Kansas

TERMS INVOICES PAYABLE NET BY THE 20TH OF THE FOLLOWING MONTH AFTER DATE OF INVOICE. UPON CUSTOMER'S DEFAULT IN PAYMENT OF CUSTOMER'S ACCOUNT BY THE LAST DAY OF THE MONTH FOLLOWING THE MONTH IN WHICH THE INVOICE IS DATED, CUSTOMER AGREES TO PAY INTEREST THEREON AFTER DEFAULT AT THE HIGHEST LAWFUL CONTRACT RATE APPLICABLE BUT NEVER TO EXCEED 18% PER ANNUM IN THE EVENT IT BECOMES NECESSARY TO EMPLOY AN ATTORNEY TO ENFORCE COLLECTION OF SAID ACCOUNT. CUSTOMER AGREES TO PAY ALL COLLECTION COSTS AND ATTORNEY FEES IN THE AMOUNT OF 20% OF THE AMOUNT OF THE UNPAID ACCOUNT.

*** CASH JOB ***