

For KCC Use: 5.26.04
Effective Date: _____
District #: 2
SGA? Yes No

KANSAS CORPORATION COMMISSION
OIL & GAS CONSERVATION DIVISION
NOTICE OF INTENT TO DRILL

RECEIVED
APR 22 2004
KCC WICHITA

Form C-1
September 1999
Form must be Typed
Form must be Signed
All blanks must be Filled

Must be approved by KCC five (5) days prior to commencing well

Expected Spud Date 5-25-2004
month day year

OPERATOR: License# 32693
Name: Hawkins Oil, L.L.C.
Address: 427 S. Boston Ave., Suite 915
City/State/Zip: Tulsa, Oklahoma 74103-4114
Contact Person: James F. Hawkins, Jr.
Phone: 918-382-7743

CONTRACTOR: License# 32701
Name: C & G Drilling

Well Drilled For:	Well Class:	Type Equipment:
<input checked="" type="checkbox"/> Oil	<input type="checkbox"/> Enh Rec	<input checked="" type="checkbox"/> Infield
<input type="checkbox"/> Gas	<input type="checkbox"/> Storage	<input type="checkbox"/> Pool Ext.
<input type="checkbox"/> OWWO	<input type="checkbox"/> Disposal	<input type="checkbox"/> Wildcat
<input type="checkbox"/> Seismic: # of Holes	<input type="checkbox"/> Other	<input type="checkbox"/> Cable
<input type="checkbox"/> Other		

If OWWO: old well information as follows:
Operator: _____
Well Name: _____
Original Completion Date: _____ Original Total Depth: _____

Directional, Deviated or Horizontal wellbore? Yes No
If Yes, true vertical depth: _____
Bottom Hole Location: _____
KCC DKT #: _____

* Lease agreement attached

AP N/2 NE NE NW
Spot
~~SE SE SE SE~~ Sec. 28 Twp. 27 S. R. 4
50 feet from S / (circle one) Line of Section
2310 feet from E / (circle one) Line of Section
Is SECTION Regular Irregular?

(Note: Locate well on the Section Plat on reverse side)

County: Butler
Lease Name: Scully Well #: 7-A
Field Name: North Augusta
Is this a Prorated Spaced Field? Yes No
Target Information(s): Arbuckle
* Nearest Lease or unit boundary: 330'
Ground Surface Elevation: 1223 feet MSL
Water well within one-quarter mile: Yes No
Public water supply well within one mile: Yes No
Depth to bottom of fresh water: 100' 160'
Depth to bottom of usable water: 180'
Surface Pipe by Alternate: 1 2
Length of Surface Pipe Planned to be set: 200'
Length of Conductor Pipe required: NA NONE
Projected Total Depth: 2340'
Producing Formation Target: Arbuckle
Water Source for Drilling Operations:
Well Farm Pond Other
DWR Permit #: _____
(Note: Apply for Permit with DWR)
Will Cores be taken? Yes No
If Yes, proposed zone: _____

AFFIDAVIT

The undersigned hereby affirms that the drilling, completion and eventual plugging of this well will comply with K.S.A. 55-101, et. seq.
It is agreed that the following minimum requirements will be met:

1. Notify the appropriate district office *prior* to spudding of well;
2. A copy of the approved notice of intent to drill *shall be posted* on each drilling rig;
3. The minimum amount of surface pipe as specified below *shall be set* by circulating cement to the top; in all cases surface pipe *shall be set* through all unconsolidated materials plus a minimum of 20 feet into the underlying formation.
4. If the well is dry hole, an agreement between the operator and the district office on plug length and placement is necessary *prior to plugging*;
5. The appropriate district office will be notified before well is either plugged or production casing is cemented in;
6. If an ALTERNATE II COMPLETION, production pipe shall be cemented from below any usable water to surface within 120 days of spud date. *In all cases, NOTIFY district office prior to any cementing.*

I hereby certify that the statements made herein are true and to the best of my knowledge and belief.

Date: 4/21/04 Signature of Operator or Agent: [Signature] Title: _____

For KCC Use ONLY
API # 15 - 015-23657.00:00
Conductor pipe required NONE feet
Minimum surface pipe required 200 feet per Alt. ①
Approved by: RJP 5.21.04
This authorization expires: 11.21.04
(This authorization void if drilling not started within 6 months of effective date.)
Spud date: _____ Agent: _____

- Remember to:
- File Drill Pit Application (form CDP-1) with Intent to Drill;
 - File Completion Form ACO-1 within 120 days of spud date;
 - File acreage attribution plat according to field proration orders;
 - Notify appropriate district office 48 hours prior to workover or re-entry;
 - Submit plugging report (CP-4) after plugging is completed;
 - Obtain written approval before disposing or injecting salt water.

Mail to: KCC - Conservation Division, 130 S. Market - Room 2078, Wichita, Kansas 67202

28 27 4E

IN ALL CASES PLOT THE INTENDED WELL ON THE PLAT BELOW

Plat of acreage attributable to a well in a prorated or spaced field

If the intended well is in a prorated or spaced field, please fully complete this side of the form. If the intended well is in a prorated or spaced field complete the plat below showing that the well will be properly located in relationship to other wells producing from the common source of supply. Please show all the wells and within 1 mile of the boundaries of the proposed acreage attribution unit for gas wells and within 1/2 mile of the boundaries of the proposed acreage attribution unit for oil wells.

API No. 15 - _____
 Operator: Hawkins Oil, L.L.C.
 Lease: Scully
 Well Number: 7A
 Field: North Augusta

Location of Well: County: Butler
 _____ 50 feet from S (N) (circle one) Line of Section
 _____ 2310 feet from E (W) (circle one) Line of Section
 Sec. 28 Twp. 27 S. R. 4 East West

Number of Acres attributable to well: _____
 QTR / QTR / QTR of acreage: _____

Is Section _____ Regular or _____ Irregular

If Section is Irregular, locate well from nearest corner boundary.
 Section corner used: NE NW SE SW

PLAT

(Show location of the well and shade attributable acreage for prorated or spaced wells.)

(Show footage to the nearest lease or unit boundary line.)

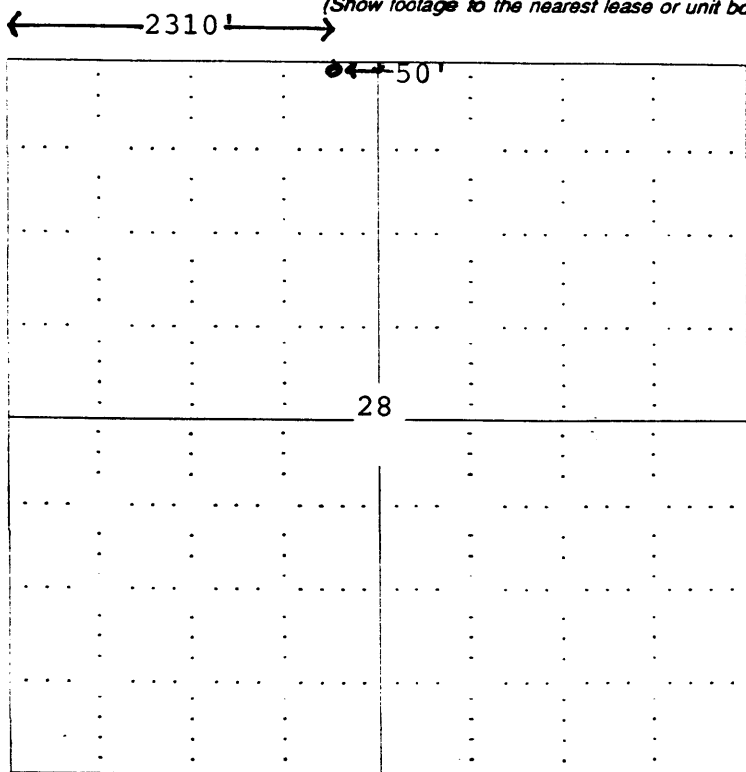

RECEIVED
 APR 22 2004
 KCC WICHITA

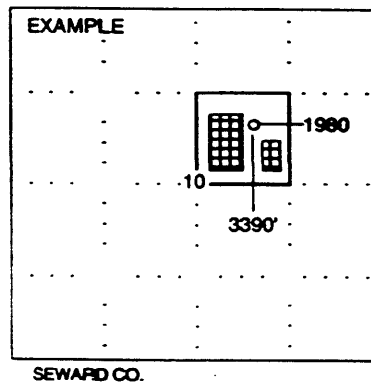

NOTE: In all cases locate the spot of the proposed drilling location.

In plotting the proposed location of the well, you must show:

1. The manner in which you are using the depicted plat by identifying section lines, i.e. 1 section, 1 section with 8 surrounding sections, 4 sections, etc.
2. The distance of the proposed drilling location from the section's south / north and east / west.
3. The distance to the nearest lease or unit boundary line.
4. If proposed location is located within a prorated or spaced field a certificate of acreage attribution plat must be attached: (CO-7 for oil wells; CG-8 for gas wells).

KANSAS

CORPORATION COMMISSION

KATHLEEN SEBELIUS, GOVERNOR
BRIAN J. MOLINE, CHAIR
JOHN WINE, COMMISSIONER
ROBERT E. KREHBIEL, COMMISSIONER

May 21, 2004

Mr. James F. Hawkins, Jr.
Hawkins Oil, LLC
427 S. Boston Ave. Ste 915
Tulsa, OK 74103-4114

RE: Drilling Pit Application
Scully Lease Well No. 7-A
SE/4 Sec. 28-27S-04W
Butler County, Kansas

Dear Mr. Hawkins:

District staff has inspected the above referenced location and has determined that the reserve pit shall be constructed **without slots**, the bottom shall be flat and reasonably level, and the free fluids must be removed. The fluids are to be removed from the reserve pit within 72 hours of drilling completion.

If production casing is set all completion fluids shall be removed on a daily basis.

The fluids should be taken to an authorized disposal well. Please call the District Office at (316) 337-6231 when the fluids have been removed. Also, please file the enclosed CDP-5 form, Surface Pond Waste Transfer within 30 days of fluid removal.

A copy of this letter should be posted in the doghouse along with the approved Intent to Drill.

If you have any questions or concerns please feel free to contact the undersigned at the above address.

Sincerely,

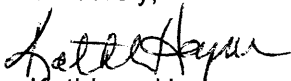

Kathleen Haynes
Environmental Protection and Remediation Department

cc: Doug Louis