

For KCC Use: Effective Date: 1-24-04  
District # \_\_\_\_\_  
SGA?  Yes  No

KANSAS CORPORATION COMMISSION  
OIL & GAS CONSERVATION DIVISION

RECEIVED  
JUL 16 2004  
KCC WICHITA

Form C-1  
September 1999  
Form must be Typed  
Form must be Signed  
All blanks must be Filled

NOTICE OF INTENT TO DRILL  
Must be approved by KCC five (5) days prior to commencing well

Expected Spud Date 07-28-04  
month day year  
OPERATOR: License# 30420  
Name: V.J.I. Natural Resources Inc.  
Address: 30-38 48th St.  
City/State/Zip: Astoria, New York 11103  
Contact Person: Jason Dinges  
Phone: 785-625-8360  
CONTRACTOR: License# 33323  
Name: Petromark

<b>Well Drilled For:</b>	<b>Well Class:</b>	<b>Type Equipment:</b>
<input checked="" type="checkbox"/> Oil	<input type="checkbox"/> Enh Rec	<input checked="" type="checkbox"/> Infield
<input checked="" type="checkbox"/> Gas	<input type="checkbox"/> Storage	<input type="checkbox"/> Pool Ext.
<input type="checkbox"/> CWD	<input type="checkbox"/> Disposal	<input type="checkbox"/> Wildcat
<input type="checkbox"/> Seismic; # of Holes _____	<input type="checkbox"/> Other _____	<input checked="" type="checkbox"/> Mud Rotary
<input type="checkbox"/> Other _____		<input type="checkbox"/> Air Rotary
		<input type="checkbox"/> Cable

If OWWO: old well information as follows:  
Operator: \_\_\_\_\_  
Well Name: \_\_\_\_\_  
Original Completion Date: \_\_\_\_\_ Original Total Depth: \_\_\_\_\_  
Directional, Deviated or Horizontal wellbore?  Yes  No  
If Yes, true vertical depth: \_\_\_\_\_  
Bottom Hole Location: \_\_\_\_\_  
KCC DKT #: \_\_\_\_\_

Spot \_\_\_\_\_ Sec. 4 Twp. 23 S. R. 17  East  West  
3300 feet from  (circle one) Line of Section  
1980 feet from  (circle one) Line of Section  
Is SECTION  Regular  Irregular?  
(Note: Locate well on the Section Plat on reverse side)  
County: Pawnee  
Lease Name: Alexander Well #: 4  
Field Name: Garfield  
Is this a Prorated / Spaced Field?  Yes  No  
Target Formation(s): Viola  
Nearest Lease or unit boundary: 660  
Ground Surface Elevation: 2075est feet MSL  
Water well within one-quarter mile:  Yes  No  
Public water supply well within one mile:  Yes  No  
Depth to bottom of fresh water: 40 150  
Depth to bottom of usable water: 600 420  
Surface Pipe by Alternate:  1  2  
Length of Surface Pipe Planned to be set: 800  
Length of Conductor Pipe required: N/A  
Projected Total Depth: 4350  
Formation at Total Depth: Viola  
Water Source for Drilling Operations:  
Well  Farm Pond \_\_\_\_\_ Other \_\_\_\_\_  
DWR Permit #: \_\_\_\_\_  
(Note: Apply for Permit with DWR )  
Will Cores be taken?  Yes  No  
If Yes, proposed zone: \_\_\_\_\_

AFFIDAVIT

The undersigned hereby affirms that the drilling, completion and eventual plugging of this well will comply with K.S.A. 55-101, et. seq.  
It is agreed that the following minimum requirements will be met:

1. Notify the appropriate district office prior to spudding of well;
2. A copy of the approved notice of intent to drill shall be posted on each drilling rig;
3. The minimum amount of surface pipe as specified below shall be set by circulating cement to the top; in all cases surface pipe shall be set through all unconsolidated materials plus a minimum of 20 feet into the underlying formation.
4. If the well is dry hole, an agreement between the operator and the district office on plug length and placement is necessary prior to plugging;
5. The appropriate district office will be notified before well is either plugged or production casing is cemented in;
6. If an ALTERNATE II COMPLETION, production pipe shall be cemented from below any usable water to surface within 120 days of spud date. In all cases, NOTIFY district office prior to any cementing.

I hereby certify that the statements made herein are true and to the best of my knowledge and belief.

Date: 07-14-04 Signature of Operator or Agent: Jason Dinges Title: Agent

For KCC Use ONLY  
API # 15 - 145-21499-00-00  
Conductor pipe required NONE feet  
Minimum surface pipe required 440 feet per Alt. 1  
Approved by: RJP 7-19-04  
This authorization expires: 1-19-05  
(This authorization void if drilling not started within 6 months of effective date.)  
Spud date: \_\_\_\_\_ Agent: \_\_\_\_\_

Remember to:

- File Drill Pit Application (form CDP-1) with Intent to Drill;
- File Completion Form ACO-1 within 120 days of spud date;
- File acreage attribution plat according to field proration orders;
- Notify appropriate district office 48 hours prior to workover or re-entry;
- Submit plugging report (CP-4) after plugging is completed;
- Obtain written approval before disposing or injecting salt water.

Mail to: KCC - Conservation Division, 130 S. Market - Room 2078, Wichita, Kansas 67202

4  
23  
173

IN ALL CASES PLOT THE INTENDED WELL ON THE PLAT BELOW

Plat of acreage attributable to a well in a prorated or spaced field

If the intended well is in a prorated or spaced field, please fully complete this side of the form. If the intended well is in a prorated or spaced field complete the plat below showing that the well will be properly located in relationship to other wells producing from the common source of supply. Please show all the wells and within 1 mile of the boundaries of the proposed acreage attribution unit for gas wells and within 1/2 mile of the boundaries of the proposed acreage attribution unit for oil wells.

API No. 15 - \_\_\_\_\_  
Operator: V.J.I. Natural Resources Inc.  
Lease: Alexander  
Well Number: 4  
Field: Garfield  
Number of Acres attributable to well: \_\_\_\_\_  
QTR / QTR / QTR of acreage: \_\_\_\_\_

Location of Well: County: Pawnee  
3300 feet from S / N (circle one) Line of Section  
1980 feet from S / W (circle one) Line of Section  
Sec. 4 Twp. 23 S. R. 17  East  West

Is Section X Regular or \_\_\_\_\_ Irregular

If Section is Irregular, locate well from nearest corner boundary.  
Section corner used: \_\_\_NE \_\_\_NW \_\_\_SE \_\_\_SW

PLAT

(Show location of the well and shade attributable acreage for prorated or spaced wells.)  
(Show footage to the nearest lease or unit boundary line.)

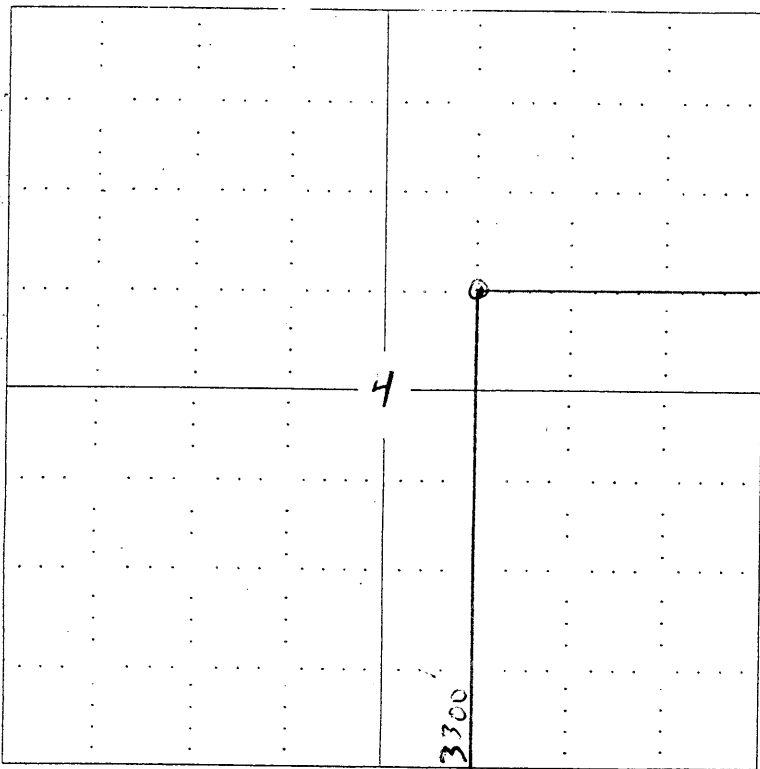

RECEIVED  
JUL 16 2004  
KCC WICHITA

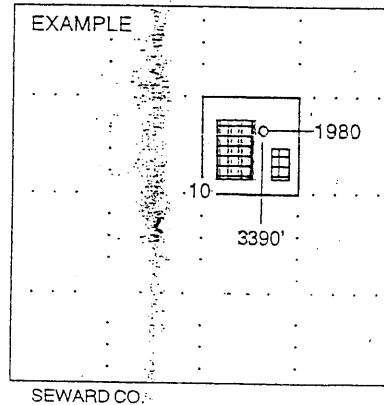

NOTE: In all cases locate the spot of the proposed drilling location.

In plotting the proposed location of the well, you must show:

1. The manner in which you are using the depicted plat by identifying section lines, i.e. 1 section, 1 section with 8 surrounding sections, 4 sections, etc.
2. The distance of the proposed drilling location from the section's south / north and east / west.
3. The distance to the nearest lease or unit boundary line.
4. If proposed location is located within a prorated or spaced field a certificate of acreage attribution plat must be attached: (CO-7 for oil wells; CG-8 for gas wells).

# KANSAS

CORPORATION COMMISSION

KATHLEEN SEBELIUS, GOVERNOR

BRIAN J. MOLINE, CHAIR

ROBERT E. KREHBIEL, COMMISSIONER

MICHAEL C. MOFFET, COMMISSIONER

July 19, 2004

Mr. Jason Dinges  
V.J.I. Natural Resources, Inc.  
30-38 48<sup>th</sup> St.  
Astoria, New York 11103

RE: Drilling Pit Application  
Alexander Lease Well No. 4  
NE/4 Sec. 04-23S-17W  
Pawnee County, Kansas

Dear Mr. Dinges:

District staff has inspected the above referenced location and has determined that the reserve pit shall be constructed **without slots**, the bottom shall be flat and reasonably level, and lined with bentonite. The free fluids must be removed. The fluids are to be removed from the reserve pit as soon as the Hutchinson Salt section has been drilled through and displacement of the fluids into the reserve pit has occurred. The fluids should be removed again as soon as practical after drilling operations have ceased.

**If production casing is set all completion fluids shall be removed on a daily basis.**

The fluids should be taken to an authorized disposal well. Please call the District Office at (620) 225-8888 when the fluids have been removed. Also please file the enclosed CDP-5 form, Surface Pond Waste Transfer, within 30 days of fluid removal.

**A copy of this letter should be posted in the doghouse along with the approved Intent to Drill.** If you have any questions or concerns please feel free to contact the undersigned at the above address.

Sincerely,



Kathy Haynes  
Environmental Protection and Remediation Department

cc: S Durrant