

STATE CORPORATION COMMISSION OF KANSAS  
OIL & GAS CONSERVATION DIVISION  
WELL COMPLETION OR RECOMPLETION FORM  
ACO-1 WELL HISTORY  
DESCRIPTION OF WELL AND LEASE

Operator: License # 5011  
Name Viking Resources  
Address 217 E. William  
Wichita, KS 67202-4005  
City/State/Zip

Purchaser None

Operator Contact Person Jim Devlin  
Phone 316-262-2502

Contractor: License # 5420  
Name White and ellis Drilling, Inc.

Wellsite Geologist Jim Maloney  
Phone 316-262-2502

Designate Type of Completion  
 New Well  Re-Entry  Workover  
 Oil  SWD  Temp Abd  
 Gas  Inj  Delayed Comp.  
 Dry  Other (Core, Water Supply etc.)

If OWO: old well info as follows:  
Operator  
Well Name  
Comp. Date Old Total Depth

WELL HISTORY

Drilling Method:  
 Mud Rotary  Air Rotary  Cable  
...6-19-85... 6-25-85... 6-25-85  
Spud Date Date Reached TD Completion Date  
...3723...  
Total Depth PBTD

Amount of Surface Pipe Set and Cemented at 260 feet  
Multiple Stage Cementing Collar Used? Yes  No  
If yes, show depth set... feet  
If alternate 2 completion, cement circulated from... feet depth to... w/... SX cmt  
Cement Company Name  
Invoice #

API NO. 15-039-20,767-0000  
County Decatur  
C... NW... NE Sec... 6 Twp... 2 Rge... 26 East  
4620 Ft North from Southeast Corner of Section  
1980 Ft West from Southeast Corner of Section  
(Note: Locate well in section plat below)

Lease Name Kelley Well # 1

Field Name

Producing Formation

Elevation: Ground 2592 KB 2597

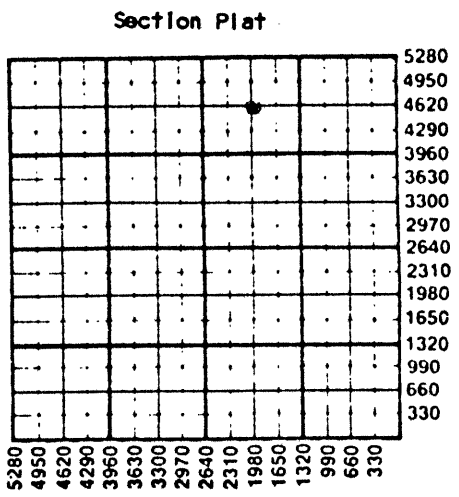

WATER SUPPLY INFORMATION  
Disposition of Produced Water:  Disposal  Repressuring  
Docket #

Questions on this portion of the ACO-1 call:  
Water Resources Board (913) 296-3717  
Source of Water:  
Division of Water Resources Permit #  
 Groundwater... Ft North from Southeast Corner (Well) ... Ft West from Southeast Corner of Sec Twp Rge East West  
 Surface Water 30 Ft North from Southeast Corner (Stream, pond etc) 5265 Ft West from Southeast Corner Sec 9 Twp 1S Rge 26 East West  
 Other (explain) (purchased from city, R.W.D. #)

INSTRUCTIONS: This form shall be completed in duplicate and filed with the Kansas Corporation Commission, 200 Colorado Derby Building, Wichita, Kansas 67202, within 90 days after completion or recompletion of any well. Rule 82-3-130 and 82-3-107 apply. Information on side two of this form will be held confidential for a period of 12 months if requested in writing and submitted with the form. See rule 82-3-107 for confidentiality in excess of 12 months. One copy of all wireline logs and drillers time log shall be attached with this form. Submit CP-4 form with all plugged wells. Submit CP-111 form with all temporarily abandoned wells.

All requirements of the statutes, rules and regulations promulgated to regulate the oil and gas industry have been fully complied with and the statements herein are complete and correct to the best of my knowledge.

Signature James B. Devlin  
Title Partner - Operator Date 1 July 1985

Subscribed and sworn to before me this 1st day of July 1985.  
Notary Public Paula R. Dunagan  
Date Commission Expires March 2, 1989

K.C.C. OFFICE USE ONLY  
F Letter of Confidentiality Attached  
C Wireline Log Received  
C Drillers Time Log Received  
Distribution  
 KCC  SWD/Rep  NGPA  
 KGS  Plug  Other  
(Specify)

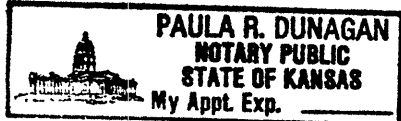

RECEIVED STATE CORPORATION COMMISSION Form ACO-1 (7-84)

NOV 1 1985  
11-1-85  
CONSERVATION DIVISION  
Wichita, Kansas

Sac Sand Rose 2011

Operator Name Viking Resources Lease Name Kelley Well # .....

Sec. 6 Twp. 2 Rge. 26  East  West County Decatur

WELL LOG

INSTRUCTIONS: Show important tops and base of formations penetrated. Detail all cores. Report all drill stem tests giving interval tested, time tool open and closed, flowing and shut-in pressures, whether shut-in pressure reached static level, hydrostatic pressures, bottom hole temperature, fluid recovery, and flow rates if gas to surface during test. Attach extra sheet if more space is needed. Attach copy of log.

Drill Stem Tests Taken  Yes  No  
 Samples Sent to Geological Survey  Yes  No  
 Cores Taken  Yes  No

Formation Description  
 Log  Sample

	Name	Top	Bottom
DST #1, 3336-3398, 30-30-60-60, Rec. 200' Watery Mud, 120' MW, BHP: 1606/1088#, FP: 90/100# 160/180# HP: 1734/1616#,	Anhydrite	2047 (+550)	
	B. Anhydrite	2071 (+526)	
	Heebner	3348 (-751)	
	Toronto	3381 (-784)	
DST #2, m 3400-3424, 30-30-30-30, Rec. 3' Mud, BHP: 50/50#, FP: 50/50# 40/40#, HP: 1685/1645#	LKC	3391 (-794)	
	BKC	3589 (-992)	
	Granite Wash	3713 (-1116)	
DST #3, 3400-3440, 30-30-60-60, Rec. 65' Drilling Mud with specks of oil, BHP: 1065/1055#, FP: 70/70# 80/80#, HP: 1711/1621#	RTD	3723 (-1126)	

CASING RECORD <input checked="" type="checkbox"/> New <input type="checkbox"/> Used Report all strings set-conductor, surface, intermediate, production, etc.							
Purpose of String	Size Hole Drilled	Size Casing Set (In O.D.)	Weight Lbs/Ft.	Setting Depth	Type of Cement	#Sacks Used	Type and Percent Additives
Surface	12 1/4	8-5/8	20	260	60/40 pozz	185	2% gal, 3% cc
PERFORATION RECORD				Acid, Fracture, Shot, Cement Squeeze Record			
Shots Per Foot	Specify Footage of Each Interval Perforated			(Amount and Kind of Material Used)		Depth	
TUBING RECORD				Liner Run <input type="checkbox"/> Yes <input type="checkbox"/> No			
Date of First Production	Producing Method <input type="checkbox"/> Flowing <input type="checkbox"/> Pumping <input type="checkbox"/> Gas Lift <input type="checkbox"/> Other (explain).....						
Estimated Production Per 24 Hours	Oil	Gas	Water	Gas-Oil Ratio		Gravity	
	Bbls	MCF	Bbls	CFPB			

METHOD OF COMPLETION

Production Interval

Disposition of gas:  Vented  Open Hole  Perforation  
 Sold  Other (Specify) .....  
 Used on Lease  Dually Completed  
 Commingled