

STATE OF KANSAS
STATE CORPORATION COMMISSION

Give All Information Completely
Make Required Affidavit
Mail or Deliver Report to:
Conservation Division
State Corporation Commission
212 North Market, Insurance Bldg.
Wichita, Kansas

15-039-30111-00-00
WELL PLUGGING RECORD

NORTH

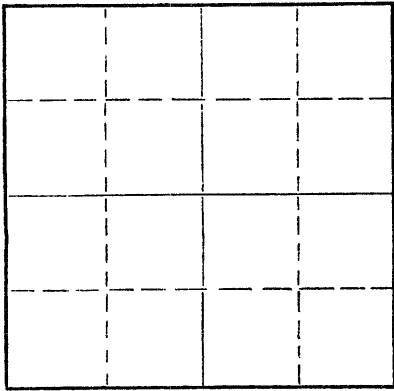

Locate well correctly on above
Section Plat

Decatur County, Sec. 2 Twp. 2 Rge. 28W (E) (W)
Location as "NE/CNW/SW" or footage from lines C NE NW
Lease Owner John O. Farmer, Inc.
Lease Name ANNA # 2 (Olive Flood) Well No. 2
Office Address Box 352, Russell, Kansas 67665
Character of Well (completed as Oil, Gas or Dry Hole) Oil
Date well completed February 19 65
Application for plugging filed March 19 75
Application for plugging approved April 1, 19 75
Plugging commenced May 22 19 75
Plugging completed May 22 19 75
Reason for abandonment of well or producing formation Depleted

If a producing well is abandoned, date of last production January 19 75
Was permission obtained from the Conservation Division or its agents before plugging was commenced? Yes

Name of Conservation Agent who supervised plugging of this well Gilbert Balthazor
Producing formation Lansing Depth to top 3440 Bottom 3640 Total Depth of Well 3640 Feet
Show depth and thickness of all water, oil and gas formations.

OIL, GAS OR WATER RECORDS

CASING RECORD

FORMATION	CONTENT	FROM	TO	SIZE	PUT IN	PULLED OUT

Describe in detail the manner in which the well was plugged, indicating where the mud fluid was placed and the method or methods used in introducing it into the hole. If cement or other plugs were used, state the character of same and depth placed, from _____ feet to _____ feet for each plug set.

Mix 3 sx. hulls; mix 70 sx. cement; mix 17 sx. Gel and
Mix 60 sx cement

RECEIVED
STATE CORPORATION COMMISSION

JUL 28 1975

7-28-75
CONSERVATION DIVISION
Wichita, Kansas

(If additional description is necessary, use BACK of this sheet)
Name of Plugging Contractor Poe Well Service
Address Oberlin, Kansas 67749

STATE OF KANSAS, COUNTY OF RUSSELL, ss.
HAROLD A. CARLSON (employee of owner) or (owner or operator) of the above-described well, being first duly sworn on oath, says: That I have knowledge of the facts, statements, and matters herein contained and the log of the above-described well as filed and that the same are true and correct. So help me God.

(Signature) Harold A. Carlson
632 East 7th, Russell, Kansas 67665
(Address)

SUBSCRIBED AND SWORN TO before me this 18th day of July, 19 75

My commission expires February 15, 1975

Helen Carlson
Notary Public.

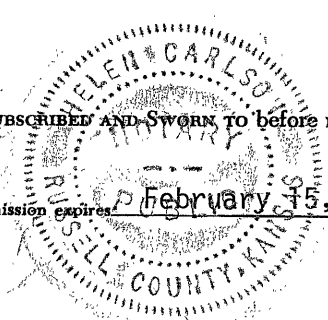

28w RGE. 2s TWP. 12 SEC. 2 COUNTY Decatur WELLS NO. 2 FARM NAME ANNA

OPERATOR JOHN O. FARMER, INC.

ADDRESS P.O. BOX 352, Russell, Kansas

FORMATION RECORD

Give detailed description and thickness of all formation drilled through, contents of sand, whether dry, water, oil or gas.

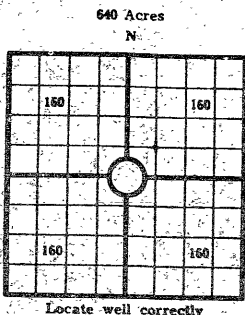

COUNTY Decatur, SEC. 12, TWP. 2s, RGE. 28w
 COMPANY OPERATING John O. Farmer, Inc.
 OFFICE ADDRESS P.O. Box 352, Russell, Kansas
 DRILLING STARTED 1/22, 1965 DRILLING FINISHED 2/4, 1965
 DATE OF FIRST PRODUCTION _____ COMPLETED _____
 WELL LOCATED C $\frac{1}{4}$ NE $\frac{1}{4}$ NW $\frac{1}{4}$, North of South
 Line and _____ ft. East of West Line of Quarter Section
 Elevation (Relative to sea level) DERRICK FLOOR 2555' GROUND, 2552'
 CHARACTER OF WELL (Oil, gas or dryhole) Oil

OIL OR GAS SANDS OR ZONES

Name	From	To	Name	From	To
1			4		
2			5		
3			6		

Perforating Record If Any

Shot Record

Formation	From	To	No. of Shots	Formation	From	To	Size of Shot

CASING RECORD

Amount Set						Amount Pulled		Packer Record	
Size	Wt.	Thds.	Make	Ft.	In.	Size	Length	Depth Set	Make

Liner Record: Amount _____ Kind _____ Top _____ Bottom _____

CEMENTING AND MUDDING

Size	Amount Set		Sacks Cement	Chemical		Method of Cementing	Amount	Mudding Method	Results (See Note)
	Ft.	In.		Gal.	Make				
8 1/2" B	118'		110 sx						
4 1/2" B	3639'		100 sx						

Note: What method was used to protect sands if outer strings were pulled? _____

NOTE: Were bottom hole plugs used? _____ If so, state kind, depth set and results obtained _____

TOOLS USED

Rotary Tools were used from 0 feet to R.T.D. Cable tools were used from _____ feet to _____ feet, and from _____ feet to _____ feet, and from _____ feet to _____ feet to _____

Type Rig Rotary

INITIAL PRODUCTION TEST

Describe initial test: whether by flow through tubing or casing or by pumping _____

Amount of Oil Production _____ bbls. Size of choke, if any _____ Length of test _____ Water

Production _____ bbls. Gravity of oil _____ Type of Pump if pump is used, describe _____

Formation	Top	Bottom	Formation	Top	Bottom
Surface		215			
Shale & Sand	215	2035			
Shale & Redbed	2035	2128			
Anhydrite	2128	2160			
Shale & Shells	2160	2390			
Shale	2390	2780			
Shale & Lime	2780	3160			
Lime & Shale	3160	3455			
Lime	3455	3530			
Lime & Shale	3530	3540			
Lime	3540	3640			
T.D.	3640'				
			Sample Tops		
			Anhydrite	2138'	
			Heebner	3396'	
			Lansing K.C.	3440'	
			Rotary T.D.	3640'	

15039-3011-00-0

RECEIVED STATE CORPORATION COMMISSION

APR 1 1975

CONSERVATION DIVISION

Wichita, Kansas
4-1-75

I, the undersigned, being first duly sworn upon oath, state that this well record is true, correct and complete according to the records of this office and to the best of my knowledge and belief.

John O. Farmer
Name and title of representative of company
President

Subscribed and sworn to before me this 8th day of February, 1965
My Commission expires 2/15/67

Helen Carlson
Notary Public
Helen Carlson