

15-039-20212-0000 R

STATE OF KANSAS  
STATE CORPORATION COMMISSION

Form CP-4

WELL PLUGGING RECORD

Give All Information Completely  
Make Required Affidavit  
Mail or Deliver Report to:  
Conservation Division  
State Corporation Commission  
212 No. Market  
Wichita, Kansas 67202

Decatur County. Sec. 24 Twp. 2S Rge. 28W (E) (W)

Location as "NE/CNW/SW" or footage from lines C SW SW

Lease Owner Ward Sauvage

Lease Name Sauvage Well No. 1

Office Address Oberlin, Kansas

Character of Well (completed as Oil, Gas or Dry Hole) Dry Hole

Date well completed June 3, 1971

Application for plugging filed June 3, 1971

Application for plugging approved June 3, 1971

Plugging commenced June 3, 1971

Plugging completed June 3, 1971

Reason for abandonment of well or producing formation Dry Hole

If a producing well is abandoned, date of last production 19

Was permission obtained from the Conservation Division or its agents before plugging was commenced? Yes

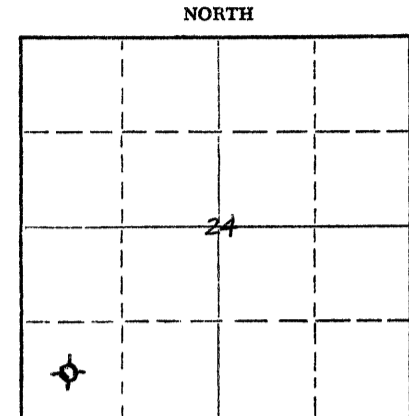

Locate well correctly on above Section Plat

Name of Conservation Agent who supervised plugging of this well

Producing formation Depth to top Bottom Total Depth of Well 3835' Feet

Show depth and thickness of all water, oil and gas formations.

OIL, GAS OR WATER RECORDS

CASING RECORD

FORMATION	CONTENT	FROM	TO	SIZE	PUT IN	PULLED OUT
		0	312'	8 5/8"	X	

Describe in detail the manner in which the well was plugged, indicating where the mud fluid was placed and the method or methods used in introducing it into the hole. If cement or other plugs were used, state the character of same and depth placed, from feet to feet for each plug set.

1st Plug at 1400'; 100 sx cement  
2nd Plug at 390'; 25 sx cement  
3rd plug at 40'; 10 sx cement  
2 sx cement in rat hole

Completed at 8:15 a.m. June 3, 1971

RECEIVED  
STATE CORPORATION COMMISSION  
JUN 14 1971  
CONSERVATION DIVISION  
Wichita, Kansas

6-14-71

(If additional description is necessary, use BACK of this sheet)

Name of Plugging Contractor Slawson Drilling Company, Inc.

Address Suite 408 One Twenty Building - Wichita, Kansas 67202

STATE OF KANSAS, COUNTY OF SEDGWICK, ss.  
MAXINE V. STARR

(employee of owner) or (owner or operator) of the above-described well being fully sworn on oath, says: That I have knowledge of the facts, statements, and matters herein contained and the log of the above described well as filed and that the same are true and correct. So help me God.

(Signature)

Maxine V. Starr

408 One Twenty Building-Wichita, Kansas

(Address)

Subscribed and sworn to before me this 11th day of June, 1971

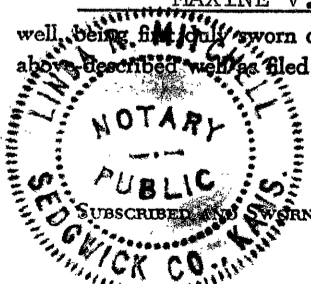

Linda R. Mitchell

Linda R. Mitchell

Notary Public.

My commission expires May 15, 1975

