

15-039-20135-00-00

STATE OF KANSAS
STATE-CORPORATION COMMISSION

Give All Information Completely
Make Required Affidavit
Mail or Deliver Report to:
Conservation Division
State Corporation Commission
212 North Market, Insurance Bldg.
Wichita, Kansas

WELL PLUGGING RECORD

NORTH

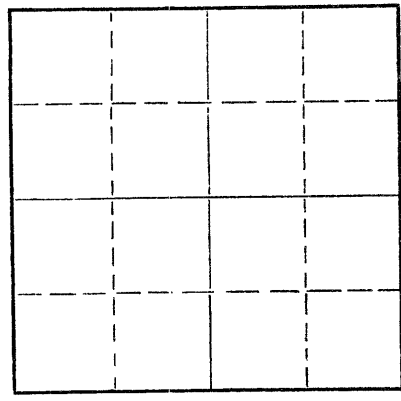

Locate well correctly on above Section Plat

Decatur County, Sec. 23 Twp. 2s Rge. 28w (E) (W)

Location as "NE/CNW/SE/SW" or footage from lines C SE, NE,
Lease Owner John O. Farmer, Inc.
Lease Name Fowler Well No. 1
Office Address Box 352, Russell, Kansas 67665
Character of Well (completed as Oil, Gas or Dry Hole) Dryhole
Date well completed 12/29, 1969
Application for plugging filed 12/29, 1969
Application for plugging approved 12/29, 1969
Plugging commenced 12/29, 1969
Plugging completed 6:00 A.M. 12/29, 1969
Reason for abandonment of well or producing formation _____

If a producing well is abandoned, date of last production _____ 19____
Was permission obtained from the Conservation Division or its agents before plugging was commenced? Yes

Name of Conservation Agent who supervised plugging of this well W. L. Nichols, Morland, Kansas
Producing formation _____ Depth to top _____ Bottom _____ Total Depth of Well 3765 Feet
Show depth and thickness of all water, oil and gas formations.

OIL, GAS OR WATER RECORDS CASING RECORD

FORMATION	CONTENT	FROM	TO	SIZE	PUT IN	PULLED OUT

Describe in detail the manner in which the well was plugged, indicating where the mud fluid was placed and the method or methods used in introducing it into the hole. If cement or other plugs were used, state the character of same and depth placed, from _____ feet to _____ feet for each plug set.

Plug # 1 1250' 100 sx. cement
Plug # 2 180' 20 sx. cement
Plug # 3 40' 10 sx. cement
Completed: 6 A.M. 12/29/69
W. L. Nichols, State Plugger

RECEIVED
STATE CORPORATION COMMISSION
JAN 5 1969
CONSERVATION DIVISION
Wichita, Kansas

(If additional description is necessary, use BACK of this sheet)
Name of Plugging Contractor John O. Farmer, Inc.
Address P.O. Box 352, Russell, Kansas 67665

STATE OF KANSAS, COUNTY OF RUSSELL, ss.
JOHN O. FARMER, president (employee of owner) or (owner or operator) of the above-described well, being first duly sworn on oath, says: That I have knowledge of the facts, statements, and matters herein contained and the log of the above-described well as filed and that the same are true and correct. So help me God.

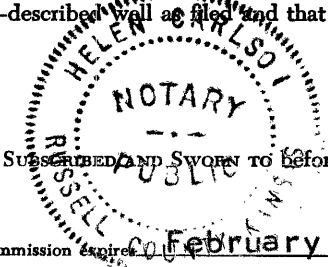

(Signature) John O. Farmer
P.O. Box 352, Russell, Kansas
(Address)

Subscribed and Sworn to before me this 30th day of December, 19 69
Helen Carlson
Helen Carlson Notary Public.

My commission expires February 15, 1971

OPERATOR John O. Farmer, Inc.

FORMATION RECORD

Give detailed description and thickness of all formation drilled through, contents of sand, whether dry, water, oil or gas.

ADDRESS Box 352, Russell, Kansas

FARM NAME Fowler WELL NO. 1 COUNTY Decatur SEC. 23 TWP. 2S RGE. 28W

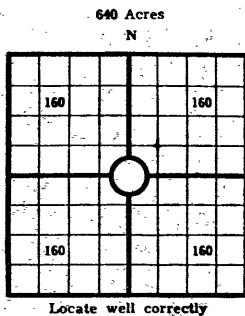

COUNTY Decatur SEC. 23 TWP. 2s RGE. 28W
 COMPANY OPERATING John O. Farmer, Inc.
 OFFICE ADDRESS Box 352, Russell, Ks.
 DRILLING STARTED 12/19/69 DRILLING FINISHED 12/29/69
 DATE OF FIRST PRODUCTION _____ COMPLETED _____
 WELL LOCATED C 1/4 SE 1/4 NE 1/4, North of South
 Line and _____ ft. East of West Line of Quarter Section
 Elevation (Relative to sea level) DERRICK FLOOR 2604 GROUND 2601
 CHARACTER OF WELL (Oil, gas or dryhole) Dryhole

OIL OR GAS SANDS OR ZONES

Name	From	To	Name	From	To
1			4		
2			5		
3			6		

Perforating Record If Any

Shot Record

Formation	From	To	No. of Shots	Formation	From	To	Size of Shot

CASING RECORD

Amount Set							Amount Pulled		Packer Record		
Size	Wt.	Thds.	Make	Ft.	In.	Ft.	In.	Size	Length	Depth Set	Make

Liner Record: Amount _____ Kind _____ Top _____ Bottom _____

CEMENTING AND MUDDING

Size	Amount Set		Sacks Cement	Chemical		Method of Cementing	Amount	Mudding Method	Results (See Note)
	Ft.	In.		Gal.	Make				
8 5/8"	173'		125	sx.	cement				

Note: What method was used to protect sands if outer strings were pulled? _____

NOTE: Were bottom hole plugs used? _____ If so, state kind, depth set and results obtained _____

TOOLS USED

Rotary Tools were used from 0 feet to R.T.D. Cable tools were used from _____ feet to _____ feet, and from _____ feet to _____ feet, and from _____ feet to _____ feet
 Type. Rig Rotary

INITIAL PRODUCTION TEST

Describe initial test: whether by flow through tubing or casing or by pumping _____

Amount of Oil Production _____ bbls. Size of choke, if any _____ Length of test _____ Water _____

Production _____ bbls. Gravity of oil _____ Type of Pump if pump is used, describe _____

Formation	Top	Bottom	Formation	Top	Bottom
Surface		173			
Shale	173	950			
Shale sand	950	1660			
Shale shells	1660	1950			
Redbed	1950	2237			
Anhydrite	2237	2270			
Shale shells	2270	2765			
Shale lime	2765	3500			
Lime shale	3500	3605			
Shale lime	3605	3765			
Rotary T.D.	3765				

RECEIVED
 STATE CORPORATION COMMISSION
 JAN 5 1969
 CONSERVATION DIVISION
 Wichita, Kansas
 RECEIVED
 STATE CORPORATION COMMISSION

Sample Tops

Sample	Tops
Anhydrite	2237'
Heebner	3506'
Lansing	3550'
Base Kansas City	3759'
Rotary T.D.	3765'

15-039-20135-00-00

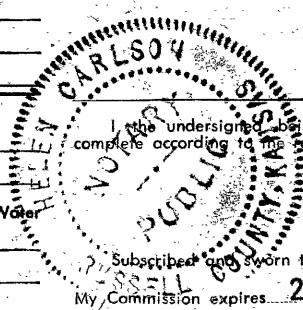

I, the undersigned, being first duly sworn upon oath, state that this well record is true, correct and complete according to the records of this office and to the best of my knowledge and belief.

John O. Farmer
 Name and title of representative of company
President
 December 30th day of 1969
Helen Carlson
 Notary Public.

Subscribed and sworn to before me this 30th day of _____ 1969
 My Commission expires 2/15/71