

STATE CORPORATION COMMISSION OF KANSAS  
OIL & GAS CONSERVATION DIVISION  
WELL COMPLETION OR RECOMPLETION FORM  
ACO-1 WELL HISTORY  
DESCRIPTION OF WELL AND LEASE

S

15-039-20,833-00-00

Operator: License # 6875  
Name Marmik Oil Company  
Address 200 N. Jefferson #500  
City/State/Zip El Dorado, AR 71730

Purchaser.....

Operator Contact Person Curtis Morrill  
Phone 501-862-8546

Contractor: License # 4083  
Name Western Kansas Drilling

Wellsite Geologist Curtis Morrill  
Phone 501-862-8546

Designate Type of Completion  
 New Well  Re-Entry  Workover

Oil  SWD  Temp Abd  
 Gas  Inj  Delayed Comp  
 Dry  Other (Core, Water Supply etc.)

If **OWWO**: old well info as follows:  
Operator .....  
Well Name .....  
Comp. Date ..... Old Total Depth.....

WELL HISTORY

Drilling Method:  
 Mud Rotary  Air Rotary  Cable  
.....9-12-88.....10-5-88.....10-6-88.....  
Spud Date Date Reached TD Completion Date  
..3945 LTD.....  
Total Depth PBTD

Amount of Surface Pipe Set and Cemented at...207 feet  
Multiple Stage Cementing Collar Used?  Yes  No  
If yes, show depth set.....feet  
If alternate 2 completion, cement circulated  
from.....feet depth to.....w/.....SX cmt  
Cement Company Name .....  
Invoice # .....  
*ALD Dgd*

API NO. 15-.....  
County Decatur  
Approx C NE 1/4 Sec 2 Twp 2 Rge 30 East  
..... West

.....4030 Ft North from Southeast Corner of Section  
.....1420 Ft West from Southeast Corner of Section  
(Note: Locate well in section plat below)

Lease Name Melba Well # 1

Field Name.....

Producing Formation.....

Elevation: Ground 2698 KB 2703

Section Plat

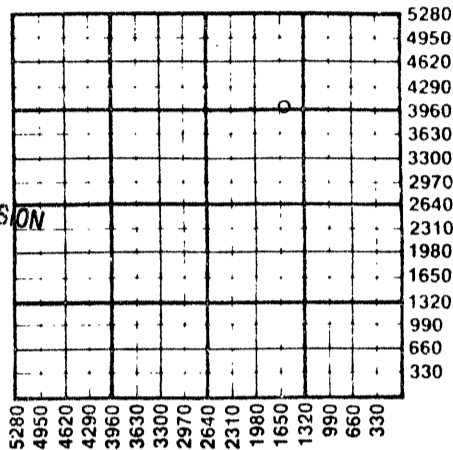

RECEIVED  
STATE CORPORATION COMMISSION  
11-02-1988  
NOV 2 1988  
CONSERVATION DIVISION  
Wichita, Kansas

WATER SUPPLY INFORMATION

Disposition of Produced Water:  Disposal  
Docket # .....  Repressuring

Questions on this portion of the ACO-1 call:

Water Resources Board (913) 296-3717

Source of Water:  
Division of Water Resources Permit #.....

Groundwater 20 Ft North from Southeast Corner  
(Well) ..20 Ft West from Southeast Corner of  
Sec 3 Twp 2S Rge 30 East  West

Surface Water.....Ft North from Southeast Corner  
(Stream, pond etc).....Ft West from Southeast Corner  
Sec Twp Rge East West

Other (explain).....  
(purchased from city, R.W.D. #)

INSTRUCTIONS: This form shall be completed in triplicate and filed with the Kansas Corporation Commission, 200 Colorado Derby Building, Wichita, Kansas 67202, within 120 days of the spud date of any well. Rule 82-3-130, 82-3-107 and 82-3-106 apply. Information on side two of this form will be held confidential for a period of 12 months if requested in writing and submitted with the form. See rule 82-3-107 for confidentiality in excess of 12 months. One copy of all wireline logs and drillers time log shall be attached with this form. Submit CP-4 form with all plugged wells. Submit CP-111 form with all temporarily abandoned wells.

All requirements of the statutes, rules and regulations promulgated to regulate the oil and gas industry have been fully complied with and the statements herein are complete and correct to the best of my knowledge.

Signature *Curtis Morrill*

Title Geologist Date 10/17/88

Subscribed and sworn to before me this 17 day of October 1988

Notary Public *Kay B. Lisco*

Date Commission Expires 2/1/91

K.C.C. OFFICE USE ONLY  
F  Letter of Confidentiality Attached  
C  Wireline Log Received  
C  Drillers Timelog Received  
Distribution  
 KCC  SWD/Rep  NGPA  
 KGS  Plug  Other  
(Specify)  
11-2-88 4

Sec. 2, Twp. 2, Rge. 30

Operator Name ..... Marmik Oil ..... Lease Name ..... Melha ..... Well # ..... 1 .....

Sec. .... 2 ..... Twp. .... 2S ..... Rge. .... 30 .....  East  West ..... County ..... Decatur .....

WELL LOG

INSTRUCTIONS: Show important tops and base of formations penetrated. Detail all cores. Report all drill stem tests giving interval tested, time tool open and closed, flowing and shut-in pressures, whether shut-in pressure reached static level, hydrostatic pressures, bottom hole temperature, fluid recovery, and flow rates if gas to surface during test. Attach extra sheet if more space is needed. Attach copy of log.

Drill Stem Tests Taken  Yes  No  
 Samples Sent to Geological Survey  Yes  No  
 Cores Taken  Yes  No

Formation Description  
 Log  Sample

Name Top Bottom

DST #1 Straddle 3549-3570  
 30-30-60-60 Rec. 180' MW  
 IFP 47-71#, FFP 83-107#, SIP 1068-1115#

Anhydrite	2460	+243
Heebner	3662	-951
Lansing	3708	-1005
BKC	3930	-1227

CASING RECORD <input checked="" type="checkbox"/> New <input type="checkbox"/> Used							
Report all strings set-conductor, surface, intermediate, production, etc.							
Purpose of String	Size Hole Drilled	Size Casing Set (in O.D.)	Weight Lbs/Ft.	Setting Depth	Type of Cement	#Sacks Used	Type and Percent Additives
Surface	12 1/4	8.5/8	24	207	60/40 pop	145	2% gel 1.3% cc
PERFORATION RECORD				Acid, Fracture, Shot, Cement Squeeze Record			
Shots Per Foot	Specify Footage of Each Interval Perforated			(Amount and Kind of Material Used)			Depth
TUBING RECORD				Liner Run	<input type="checkbox"/> Yes <input type="checkbox"/> No		
Date of First Production	Producing Method						
	<input type="checkbox"/> Flowing <input type="checkbox"/> Pumping <input type="checkbox"/> Gas Lift <input type="checkbox"/> Other (explain).....						
Estimated Production Per 24 Hours	Oil	Gas	Water	Gas-Oil Ratio	Gravity		
	Bbls	MCF	Bbls	CFPB			

METHOD OF COMPLETION

Production Interval

Disposition of gas:  Vented  Open Hole  Perforation  
 Sold  Other (Specify) .....  
 Used on Lease  Dually Completed .....  
 Commingled



15-039-20833-00-00  
 LAUGHLIN-SIMMONS & CO. OF KANSAS, INC.  
 OIL FIELD SURVEYING  
 1337 NORTH MERIDIAN, SUITE 2 WICHITA, KANSAS 67203 (316) 943-5351

KW610883  
 INVOICE NO.

MARMIK OIL COMPANY OPERATOR NO. 1 Melba FARM

Decatur COUNTY 2 S 2s 30w 1420' FEI 1250' FNI of Section LOCATION

ELEVATION: 2698 gr

MARMIK OIL COMPANY  
 200 N. Jefferson Suite 500  
 El Dorado, Arkansas 71730



AUTHORIZED BY: Curt Morrill

SCALE: 1" = 1000'

1 mile N to "TRAER"

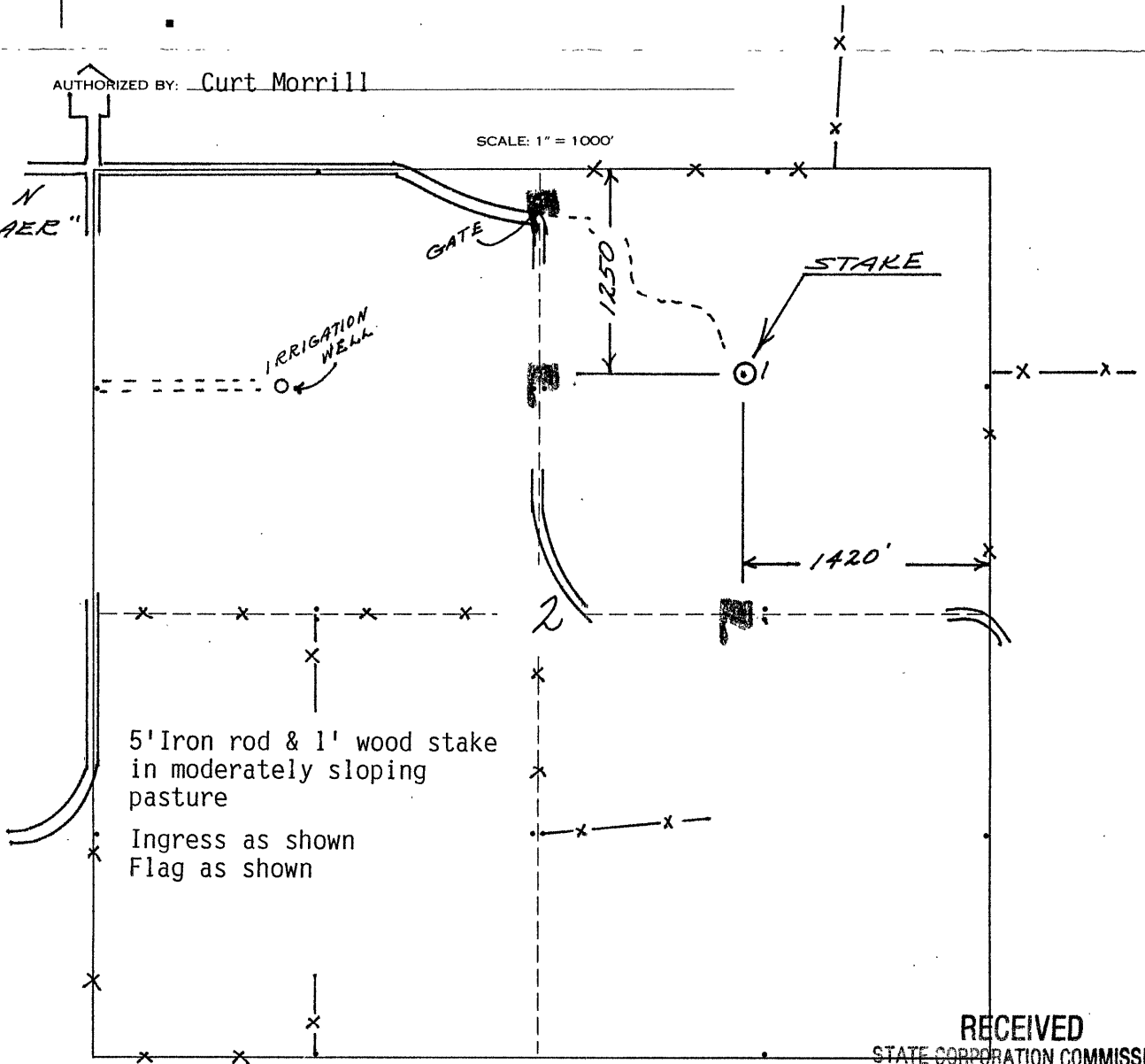

RECEIVED  
 STATE CORPORATION COMMISSION

NOV 2 1988

CONSERVATION DIVISION  
 Wichita, Kansas