

plugged 10-08-87

STATE CORPORATION COMMISSION OF KANSAS
OIL & GAS CONSERVATION DIVISION
WELL COMPLETION OR RECOMPLETION FORM
ACO-1 WELL HISTORY
DESCRIPTION OF WELL AND LEASE

API NO. 15-039-20,822-00-00
County Decatur
SW NE NE Sec. 14 Twp. 2S Rge. 30 East
..... West

Operator: License # 5363
Name Berexco, Inc.
Address 970 Fourth Financial Center
Wichita, KS 67202
City/State/Zip

4290 Ft North from Southeast Corner of Section
990 Ft West from Southeast Corner of Section
(Note: Locate well in section plat below)

Purchaser

Lease Name Mines Farms Well # 1

Operator Contact Person Evan C. Mayhew
Phone 316-265-3311

Field Name

Producing Formation

Contractor: License # 6033
Name Murfin Drilling Company

Elevation: Ground 2753 KB 2760

Wellsite Geologist
Phone

Designate Type of Completion
 New Well Re-Entry Workover
 Oil SWD Temp Abd
 Gas Inj Delayed Comp.
 Dry Other (Core, Water Supply etc.)

If OWWO: old well info as follows:
Operator
Well Name
Comp. Date Old Total Depth

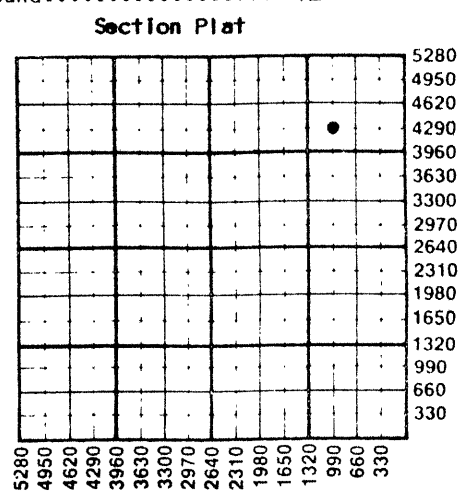

WATER SUPPLY INFORMATION
Disposition of Produced Water: Disposal
Docket # Repressuring

WELL HISTORY
Drilling Method:
 Mud Rotary Air Rotary Cable
10-2-87 10-7-87 10-8-87
Spud Date Date Reached TD Completion Date
3920' 1
Total Depth PBTD
8-5/8" @ 344'
Amount of Surface Pipe Set and Cemented at feet
Multiple Stage Cementing Collar Used? Yes No
If yes, show depth set feet
If alternate 2 completion, cement circulated from feet depth to w/SX cmt
Cement Company Name
Invoice #

Questions on this portion of the ACO-1 call:
Water Resources Board (913) 296-3717
Source of Water: Hauled.
Division of Water Resources Permit #
 Groundwater Ft North from Southeast Corner (Well) Ft West from Southeast Corner of Sec Twp Rge East West
 Surface Water Ft North from Southeast Corner (Stream, pond etc) Ft West from Southeast Corner Sec Twp Rge East West
 Other (explain) Hauled (purchased from city, R.W.D. #)

INSTRUCTIONS: This form shall be completed in triplicate and filed with the Kansas Corporation Commission, 200 Colorado Derby Building, Wichita, Kansas 67202, within 120 days of the spud date of any well. Rule 82-3-130, 82-3-107 and 82-3-106 apply. Information on side two of this form will be held confidential for a period of 12 months if requested in writing and submitted with the form. See rule 82-3-107 for confidentiality in excess of 12 months. One copy of all wireline logs and drillers time log shall be attached with this form. Submit CP-4 form with all plugged wells. Submit CP-111 form with all temporarily abandoned wells.

All requirements of the statutes, rules and regulations promulgated to regulate the oil and gas industry have been fully complied with and the statements herein are complete and correct to the best of my knowledge.

Signature Evan C. Mayhew
Title Engineer Date 11-23-87

K.C.C. OFFICE USE ONLY
 Letter of Confidentiality Attached
 Wireline Log Received
 Drillers Timelog Received
Distribution
 KCC SWD/Rep NGPA
 KGS Plug Other (Specify)

Subscribed and sworn to before me this 23 day of Nov. 1987.
Notary Public
Date Commission Expires 3-20-90

Sec. 14 Twp. 2S Rge. 30E

Amerdel

SIDE TWO

Operator Name Berexco, Inc. Lease Name Mines Farms Well # 1

Sec 14 Twp 2S Rge 30 East West County Decatur

RELEASED

MAR 07 1990

3-7-90

FROM CONFIDENTIAL

WELL LOG

INSTRUCTIONS: Show important tops and base of formations penetrated. Detail all cores. Report all drill stem tests giving interval tested, time tool open and closed, flowing and shut-in pressures, whether shut-in pressure reached static level, hydrostatic pressures, bottom hole temperature, fluid recovery, and flow rates if gas to surface during test. Attach extra sheet if more space is needed. Attach copy of log.

Drill Stem Tests Taken [X] Yes [] No
Samples Sent to Geological Survey [] Yes [] No
Cores Taken [] Yes [X] No

Formation Description [X] Log [] Sample

Name Top Bottom

DST #1 - 3741-3780, 60 (60) 60 (60). Rec. 180' WCM w/SSO. FP's 42-53, 74-85. IBHP 191, FBHP 191.

Anhydrite 2491 (+269)
B/Anhydrite 2523 (+237)
Heebner 3695 (-935)
Lansing 3741 (-981)
LTD 3919

DST #2 - 3788-3840, 45 (45) 45 (45). Rec. 60' mud w/SSO. FP's 42-42, 63-63. IBHP 520, FBHP 489.

DST #3 - 3863-3920, 45 (30) 30 (30). Rec. 60' mud. FP's 42-42, 42-42. IBHP 73, FBHP 42.

CASING RECORD, PERFORATION RECORD, TUBING RECORD, Date of First Production, Producing Method, Estimated Production Per 24 Hours, METHOD OF COMPLETION, Production Interval

Disposition of gas: [] Vented [] Open Hole [] Perforation
[] Sold [] Other (Specify)
[] Used on Lease [] Dually Completed [] Commingled

Handwritten notes and stamps at the bottom right of the page.