

For KCC Use: 7.27.04
 Effective Date: 4
 District # _____
 SGA? Yes No

KANSAS CORPORATION COMMISSION
 OIL & GAS CONSERVATION DIVISION
NOTICE OF INTENT TO DRILL

Form C-1
 September 1999
Form must be Typed
Form must be Signed
All blanks must be Filled

Must be approved by KCC five (5) days prior to commencing well

Expected Spud Date August 1 2004
month day year

Spot NE SW - SW Sec. 22 Twp. 3 S. R. 41 East West

OPERATOR: License# 33019
 Name: Rosewood Resources, Inc.
 Address: 2711 N. Haskell Ave. - Suite 2800, LB #22
 City/State/Zip: Dallas, Texas 75204
 Contact Person: Jenni Trietsch
 Phone: 214-756-6607

948 feet from S / N (circle one) Line of Section
1183 feet from E / W (circle one) Line of Section

Is SECTION Regular Irregular?

(Note: Locate well on the Section Plat on reverse side)

CONTRACTOR: License# 8273
 Name: Excell Drilling Co.

County: Cheyenne
 Lease Name: Isernhagen Well #: 1-22
 Field Name: Cherry Creek

Is this a Prorated / Spaced Field? Yes No

Target Formation(s): Niobrara
 Nearest Lease or unit boundary: 948'

Well Drilled For:	Well Class:	Type Equipment:
<input type="checkbox"/> Oil	<input type="checkbox"/> Enh Rec	<input type="checkbox"/> Infield
<input checked="" type="checkbox"/> Gas	<input type="checkbox"/> Storage	<input checked="" type="checkbox"/> Mud Rotary
<input type="checkbox"/> OWWO	<input type="checkbox"/> Disposal	<input type="checkbox"/> Air Rotary
<input type="checkbox"/> Seismic;	<input type="checkbox"/> # of Holes	<input type="checkbox"/> Cable
<input type="checkbox"/> Other	<input type="checkbox"/> Wildcat	
	<input type="checkbox"/> Other	

Ground Surface Elevation: 3486' feet MSL

Water well within one-quarter mile: Yes No

Public water supply well within one mile: Yes No

Depth to bottom of fresh water: 445' 130'

Depth to bottom of usable water: 445' 130'

Surface Pipe by Alternate: xxx 1 2

Length of Surface Pipe Planned to be set: 200'

Length of Conductor Pipe required: None

Projected Total Depth: 1,700'

Formation at Total Depth: Niobrara

Water Source for Drilling Operations:

Well _____ Farm Pond _____ Other xxx

DWR Permit #: _____

(Note: Apply for Permit with DWR)

Will Cores be taken? Yes No

If Yes, proposed zone: _____

If OWWO: old well information as follows:

Operator: _____

Well Name: _____

Original Completion Date: _____ Original Total Depth: _____

Directional, Deviated or Horizontal wellbore? Yes No

If Yes, true vertical depth: RECEIVED

Bottom Hole Location: KANSAS CORPORATION COMMISSION

KCC DKT #: JUL 22 2004

CONSERVATION DIVISION
 WICHITA, KS

AFFIDAVIT

The undersigned hereby affirms that the drilling, completion and eventual plugging of this well will comply with K.S.A. 55-101, et. seq.
 It is agreed that the following minimum requirements will be met:

1. Notify the appropriate district office **prior** to spudding of well;
2. A copy of the approved notice of intent to drill **shall be** posted on each drilling rig;
3. The minimum amount of surface pipe as specified below **shall be set** by circulating cement to the top; in all cases surface pipe **shall be set** through all unconsolidated materials plus a minimum of 20 feet into the underlying formation.
4. If the well is dry hole, an agreement between the operator and the district office on plug length and placement is necessary **prior to plugging**;
5. The appropriate district office will be notified before well is either plugged or production casing is cemented in;
6. If an ALTERNATE II COMPLETION, production pipe shall be cemented from below any usable water to surface within **120 days** of spud date. **In all cases, NOTIFY district office** prior to any cementing.

I hereby certify that the statements made herein are true and to the best of my knowledge and belief.

Date: July 21, 2004 Signature of Operator or Agent: Jenni Trietsch Title: Senior Accountant

For KCC Use ONLY	
API # 15 -	<u>023-20586-00-00</u>
Conductor pipe required _____ feet	<u>NONE</u>
Minimum surface pipe required _____ feet per Alt. ①	<u>180</u>
Approved by:	<u>RJP 7.22.04</u>
This authorization expires:	<u>1-22-05</u>
<small>(This authorization void if drilling not started within 6 months of effective date.)</small>	
Spud date: _____	Agent: _____

Remember to:

- File Drill Pit Application (form CDP-1) with Intent to Drill;
- File Completion Form ACO-1 within 120 days of spud date;
- File acreage attribution plat according to field proration orders;
- Notify appropriate district office 48 hours prior to workover or re-entry;
- Submit plugging report (CP-4) after plugging is completed;
- Obtain written approval before disposing or injecting salt water.

22
3
4/w

IN ALL CASES PLOT THE INTENDED WELL ON THE PLAT BELOW

Plat of acreage attributable to a well in a prorated or spaced field

If the intended well is in a prorated or spaced field, please fully complete this side of the form. If the intended well is in a prorated or spaced field complete the plat below showing that the well will be properly located in relationship to other wells producing from the common source of supply. Please show all the wells and within 1 mile of the boundaries of the proposed acreage attribution unit for gas wells and within 1/2 mile of the boundaries of the proposed acreage attribution unit for oil wells.

API No. 15 - _____
Operator: Rosewood Resources, Inc.
Lease: Isernhagen
Well Number: 1-22
Field: Cherry Creek

Number of Acres attributable to well: 160
QTR / QTR / QTR of acreage: NE - SW - SW

Location of Well: County: Cheyenne
948 feet from S / N (circle one) Line of Section
1183 feet from E W (circle one) Line of Section
Sec. 22 Twp. 3 S. R. 41 East West

Is Section Regular or Irregular

If Section is Irregular, locate well from nearest corner boundary.
Section corner used: NE NW SE SW

PLAT

*(Show location of the well and shade attributable acreage for prorated or spaced wells.)
(Show footage to the nearest lease or unit boundary line.)*

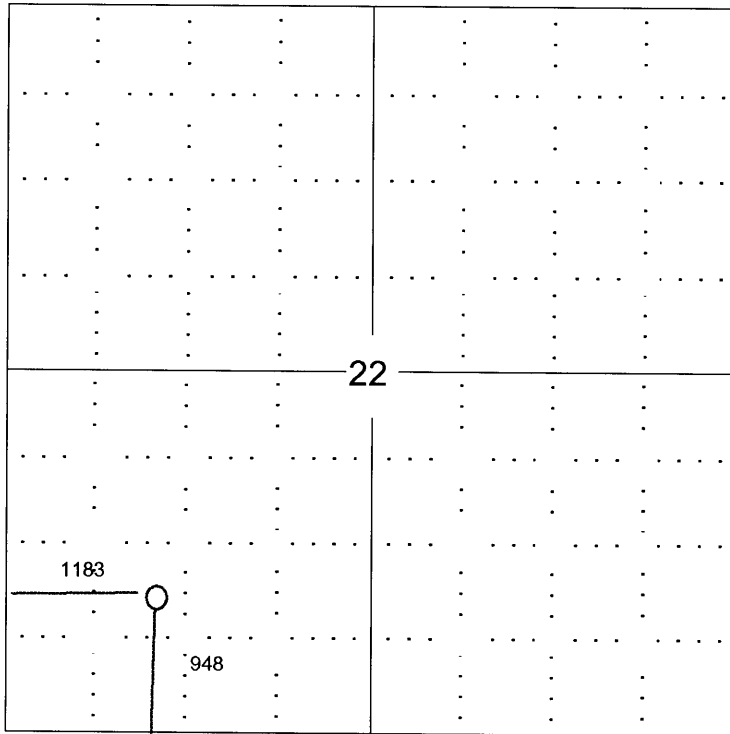

RECEIVED
KANSAS CORPORATION COMMISSION
JUL 22 2004
CONSERVATION DIVISION
WICHITA, KS

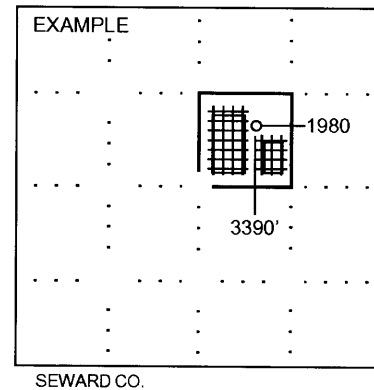

NOTE: In all cases locate the spot of the proposed drilling location.

In plotting the proposed location of the well, you must show:

1. The manner in which you are using the depicted plat by identifying section lines, i.e. 1 section, 1 section with 8 surrounding sections, 4 sections, etc.
2. The distance of the proposed drilling location from the section's south / north and east / west.
3. The distance to the nearest lease or unit boundary line.
4. If proposed location is located within a prorated or spaced field a certificate of acreage attribution plat must be attached: (C0-7 for oil wells; CG-8 for gas wells).