

CARD MUST BE TYPED

State of Kansas

CARD MUST BE SIGNED

NOTICE OF INTENTION TO DRILL

(see rules on reverse side)

Starting Date 12 - 25 - 86
month day year

API Number 15— 023-20,247-00-00

OPERATOR: License # 4528
Name Paul Prijatel
Address 201 W. 8th St. Suite 450
City/State/Zip Pueblo, Colorado 81003
Contact Person Paul Prijatel
Phone (303) 544-2111

SW SE NW Sec. 21 Twp. 2 S, Rg. 37 West
2970 Ft. from South Line of Section
3530 Ft. from East Line of Section

(Note: Locate well on Section Plat on reverse side)

CONTRACTOR: License #
Name unknown
City/State

Nearest lease or unit boundary line 330 feet
County Cheyenne
Lease Name Edie Well # 12-6

Well Drilled For: Well Class: Type Equipment:
 Oil SWD Infield Mud Rotary
 Gas Inj Pool Ext. Air Rotary
 OWWO Expl Wildcat Cable

Ground surface elevation 3335 feet MSL
Domestic well within 330 feet: yes no
Municipal well within one mile: yes no
Surface pipe by Alternate: 1 2

IF OWWO: old well info as follows:
Operator
Well Name
Comp Date Old Total Depth

Depth to bottom of fresh water 300 # 240
Depth to bottom of usable water 350 # 300
Surface pipe planned to be set 350 #
Projected Total Depth 4800 feet
Formation Cherokee

I certify that well will comply with K.S.A. 55-101, et seq., plus eventually plugging hole to KCC specifications.
cementing will be done immediately upon setting production casing.
Date 12/19/86 Signature of Operator or Agent Paul Prijatel Title Geologist

For KCC Use:
Conductor Pipe Required feet; Minimum Surface Pipe Required 300 feet per Alt. ①
This Authorization Expires 6-22-87 Approved By 12-22-86

Must be filed with the K.C.C. five (5) days prior to commencing well
This card void if drilling not started within six (6) months of date received by K.C.C.

Important procedures to follow:

1. Notify District office before setting surface casing.
2. Set surface casing by circulating cement to the top.
3. File completion forms ACO-1 with K.C.C. within 90 days of well completion, following instructions on ACO-1, side 1, and including copies of wireline logs.
4. Notify District office 48 hours prior to old well workover or re-entry.
5. Prior to filing Intent, prepare a proposed plugging plan in case well is D & A, then obtain approval of plan when calling district office prior to setting surface pipe.
6. Submit plugging report (CP-4) to K. C. C. after plugging is completed.
7. Obtain an approved injection docket number before disposing of salt water.
8. Notify K.C.C. within 10 days when injection commences or terminates.
9. If an alternate 2 completion, cement in the production pipe from below any usable water to surface within 120 days of spud date.

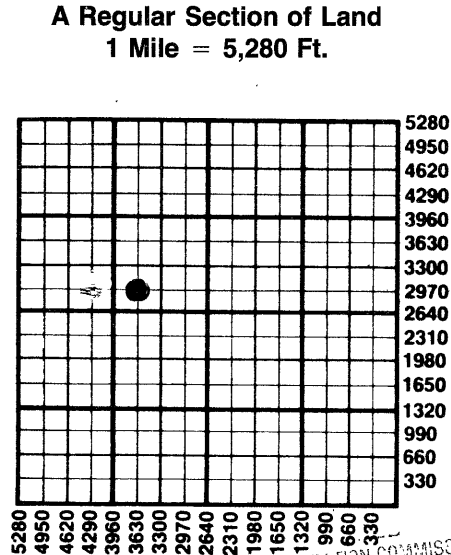

DEC 17 1985
CONSERVATION DIVISION
Wichita, Kansas

DEC 2
12-22-86
CONSERVATION DIVISION
Wichita, Kansas

State Corporation Commission of Kansas
Conservation Division
200 Colorado Derby Building
Wichita, Kansas 67202
(316) 263-3238