

STATE OF KANSAS
STATE CORPORATION COMMISSION
CONSERVATION DIVISION
500 INSURANCE BUILDING
212 NORTH MARKET
WICHITA 2, KANSAS

RECEIVED
STATE CORPORATION COMMISSION

MAY 27 1960

CONSERVATION DIVISION
Wichita, Kansas

5-27-60

WELL PLUGGING APPLICATION FORM
File One Copy

15-023-00029-00-00

Lease Owner (Applicant) JOHN O. FARMER, INC.
Address Russell, Kansas

Lease (Farm Name) PUGH Well No. 1

Well Location SE NE Sec. 30 Twp. 2 S Rge. (E) (W) 39W

County Cheyenne Field Name (If any) _____

Total Depth 5162 Oil Well _____ Gas Well _____ Input Well _____ SWD Well _____ D & A X

Was well log filed with application? yes If not, explain: _____

Date and hour plugging is desired to begin 5/24/60 8:00 PM

Plugging of the well will be done in accordance with the Rules and Regulations of the State Corporation Commission.

Name of the person on the lease in charge of well owner Dale Buchheister
Address Plainville, Kansas

Plugging Contractor JOHN O. FARMER, INC. License No. _____
Address Russell, Kansas

Invoice covering assessment for plugging this well should be sent to _____
John O. Farmer, Inc. Address P.O. Box 352, Russell, Kansas

and payment will be guaranteed by applicant.

Signed: John O. Farmer
Applicant or Acting Agent

Date: May 26, 1960

ADDRESS Russell, Kansas

Give detailed description and thickness of all formation drilled through, contents of sand, whether dry, water, oil or gas.

39W
28
30
30
Cheyenne
1
COUNTY
WELL NO. 1
PUGH

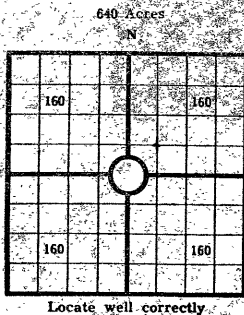

COUNTY Cheyenne SEC. 30 TWP. 28 RGE. 39W
 COMPANY OPERATING JOHN O. FARMER, INC. FARM NAME PUGH #1
 OFFICE ADDRESS Russell, Kansas
 DRILLING STARTED 5/10 19 60 DRILLING FINISHED 5/24 19 60
 DATE OF FIRST PRODUCTION COMPLETED
 WELL LOCATED 1/4 SE 1/4 NE 1/4, North of South
 Line and _____ ft. East of West Line of Quarter Section
 Elevation (Relative to sea level) DERRICK FLOOR 3229 GROUND 3226
 CHARACTER OF WELL (Oil, gas or dryhole) Dry

Formation	Top	Bottom	Formation	Top	Bottom
Sand & shale	0	60			
Shale	60	1550	ELEVATION:	RB	3231
Shale & shells	1550	2040	TOPS:		
Sand	2040	2150			
Shale & sand	2150	2270	sample	log	
Shale & shells	2270	2790	Anhydrite		3124
Shale & lime	2790	2915	Chase		3310
Shale & shells & redbed	2915	3305	Waubunsee		3760
Shale & lime	3305	4060	Howard	3941	3936
Lime & shale	4060	4930	Topeka	3990	3978
Mississippi	4930	4960	Lansing	4150	4140
Lime & shale	4960	5055	B/KO	4445	4441
Miss lime	5055	5095	Marmaton		4452
Arbuckle	5095	5161	Cherokee	4624	4616
Drillers T.D.		5161	Mississippi	4925	4919
			Arbuckle	5090	5095
			Wollex T.D.		5162

OIL OR GAS SANDS OR ZONES

Name	From	To	Name	From	To
1			4		
2			5		
3			6		

Perforating Record If Any

Shot Record

Formation	From	To	No. of Shots	Formation	From	To	Size of Shot

CASING RECORD

Amount Set				Amount Pulled				Packer Record			
Size	Wt.	Thds.	Make	Ft.	In.	Ft.	In.	Size	Length	Depth Set	Make
8-5/8				193							

Liner Record: Amount _____ Kind _____ Top _____ Bottom _____

CEMENTING AND MUDDING

Size	Amount Set	Sacks	Chemical		Method of	Amount	Mudding	Results
Ft.	Ft.	Cement	Gal.	Make	Cementing		Method	(See Note)
8-5/8	193	150						

Note: What method was used to protect sands if outer strings were pulled?

NOTE: Were bottom hole plugs used? If so, state kind, depth set and results obtained

TOOLS USED

Rotary Tools were used from _____ feet to _____ Cable tools were used from _____ feet to _____ feet, and from _____ feet to _____ feet, and from _____ feet to _____ feet to _____

Type Rig _____

INITIAL PRODUCTION TEST

Describe initial test: whether by flow through tubing or casing or by pumping _____

Amount of Oil Production _____ bbls. Size of choke, if any _____ Length of test _____ Water

Production _____ bbls. Gravity of oil _____ Type of Pump if pump is used, describe _____

RECEIVED
 STATE CORPORATION COMMISSION
 MAY 27 1960
 CONSERVATION DIVISION
 Wichita, Kansas

15-023-00029-00-00

I, the undersigned, being first duly sworn upon oath, state that this well record is true, correct and complete according to the records of this office and to the best of my knowledge and belief.

John O. Farmer, Inc.
 Name and title of representative of company

Subscribed and sworn to before me this 26th day of May, 19 60

My Commission expires 10/11/62 *Lucille Kennedy*
Notary Public.



15-023-00029-00-00

State Corporation Commission

CONSERVATION DIVISION

(Oil, Gas and Water)

500 Insurance Bldg. 212 N. Market

WICHITA, KANSAS

JEWEL M. OGDEN, Director

GEORGE DOCKING Governor
HARRY G. WILES Chairman
MARION BEATTY Commissioner
RICHARD C. BYRD Commissioner
RAYMOND B. HARVEY Secretary
J. ROBERT WILSON Counsel

WELL PLUGGING AUTHORITY

June 1, 1960

Well No. 1
Lease Pugh
Description SE NE 30-2-39W
County Cheyenne

John O. Farmer Inc.
Russell, Kansas

Gentlemen:

This is your authority to plug the above subject well in accordance with the Rules and Regulations of the State Corporation Commission.

This authority is void after 90 days from the above date.

Very truly yours,

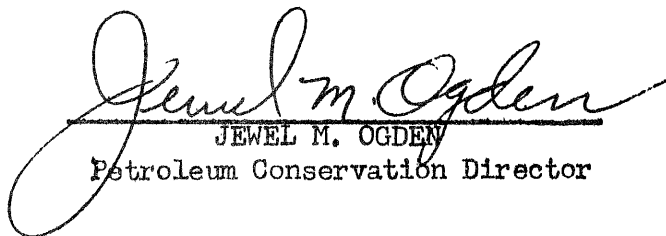
JEWEL M. OGDEN
Petroleum Conservation Director

Mr. Fabricius
is hereby assigned to supervise the plugging of the above named well.

In the event you need any further information regarding this well feel free to write or call me at any time.

J. Lewis Brock
Western Kansas Field Supervisor
P. O. Box 569
Great Bend, Kansas
Phone: GL-33022