

STATE OF KANSAS  
STATE CORPORATION COMMISSION  
CONSERVATION DIVISION  
500 INSURANCE BUILDING  
212 NORTH MARKET  
WICHITA 2, KANSAS

Form CP-1

RECEIVED  
STATE CORPORATION COMMISSION

MAY 26 1965  
5-26-65  
CONSERVATION DIVISION  
Wichita, Kansas

15-023-30024-00-00 WELL PLUGGING APPLICATION FORM  
File One Copy

Lease Owner (Applicant) JOHN O. FARMER, INC.  
Address P.O. Box 352, Russell, Kansas

Lease (Farm Name) Kehlbeck Well No. 1

Well Location C SE NE Sec. 20 Twp. 2s Rge. 37w (E) (W)

County Cheyenne Field Name (If any)

Total Depth 5100' Oil Well Gas Well Input Well SWD Well D & A X

Was well log filed with application? Yes If not, explain:

Date and hour plugging is desired to begin Completed: 6 P.M. 5/22/65

Plugging of the well will be done in accordance with the Rules and Regulations of the State Corporation Commission.

Name of the person on the lease in charge of well owner Dale Buchheister  
209 N. Washington Address Plainville, Kansas

Plugging Contractor John O. Farmer, Inc. License No.  
Address P.O. Box 352, Russell, Kansas

Invoice covering assessment for plugging this well should be sent to John O. Farmer, Inc.  
P.O. Box 352 Address Russell, Kansas

and payment will be guaranteed by applicant.

Signed: John O. Farmer  
Applicant or Acting Agent  
President

Date: May 25, 1965

OPERATOR John O. Farmer, Inc.

FORMATION RECORD

ADDRESS P.O. Box 352, Russell, Kansas

Give detailed description and thickness of all formation drilled through, contents of sand, whether dry, water, oil or gas.

WELL NO. 1 COUNTY Cheyenne SEC. 20 TWP 2S RGE. 37W

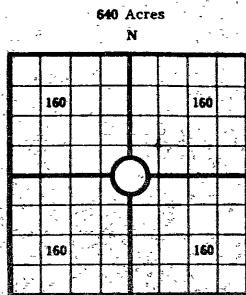

COUNTY Cheyenne SEC. 20 TWP 2s RGE. 37W  
 COMPANY OPERATING John O. Farmer, Inc.  
 OFFICE ADDRESS P.O. Box 352, Russell, Kansas  
 DRILLING STARTED 5/9, 1965 DRILLING FINISHED 5/22, 1965  
 DATE OF FIRST PRODUCTION \_\_\_\_\_ COMPLETED \_\_\_\_\_  
 WELL LOCATED C 1/4 SE 1/4 NE 1/4, North of South  
 Line and \_\_\_\_\_ ft. East of West Line of Quarter Section  
 Elevation (Relative to sea level) DERRICK FLOOR 3373 GROUND, 3370  
 CHARACTER OF WELL (Oil, gas or dryhole) Dryhole

OIL OR GAS SANDS OR ZONES

Name	From	To	Name	From	To
1			4		
2			5		
3			6		

Perforating Record If Any

Shot Record

Formation	From	To	No. of Shots	Formation	From	To	Size of Shot

CASING RECORD

Amount Set						Amount Pulled		Packer Record			
Size	Wt.	Thds.	Make	Ft.	In.	Ft.	In.	Size	Length	Depth Set	Make

Liner Record: Amount \_\_\_\_\_ Kind \_\_\_\_\_ Top \_\_\_\_\_ Bottom \_\_\_\_\_

CEMENTING AND MUDDING

Size	Amount Set		Sacks Cement	Chemical		Method of Cementing	Amount	Mudding Method	Results (See Note)
	Ft.	In.		Gal.	Make				
8 5/8"	263		150	sx.					

Note: What method was used to protect sands if outer strings were pulled?

NOTE: Were bottom hole plugs used? \_\_\_\_\_ If so, state kind, depth set and results obtained \_\_\_\_\_

TOOLS USED

Rotary Tools were used from 0 feet to R.T.D. Cable tools were used from \_\_\_\_\_ feet to \_\_\_\_\_ feet, and from \_\_\_\_\_ feet to \_\_\_\_\_ feet, and from \_\_\_\_\_ feet to \_\_\_\_\_ feet  
 Type Rig Rotary

INITIAL PRODUCTION TEST

Describe initial test: whether by flow through tubing or casing or by pumping \_\_\_\_\_

Amount of Oil Production \_\_\_\_\_ bbls. Size of choke, if any \_\_\_\_\_ Length of test \_\_\_\_\_ Water Production \_\_\_\_\_ bbls. Gravity of oil \_\_\_\_\_ Type of Pump if pump is used, describe \_\_\_\_\_

Formation	Top	Bottom	Formation	Top	Bottom
Shale & Sand	-0-	267			
Shale	267	1620			
Shale & Sand	1620	3020			
Shale & Shells	3020	3120			
Anhydrite	3120	3135			
Redbed	3135	3268			
Shale & Shells	3268	3505			
Shale & Lime	3505	3785			
Lime & Shale	3785	4920			
Shale & Lime	4920	5040			
Lime, Shale & Chert	5040	5060			
Mississippi	5060	5100			
Total Depth	5100				

Log Tops:

Oread 4235'  
 Lansing 4308'  
 B/ Kansas City 4608'  
 Fort Scott 4720'  
 Cherokee 4770'  
 Mississippi 5008'  
 Log T.D. 5100'

15-023-30024-00-00

RECEIVED  
 STATE CORPORATION COMMISSION  
 MAY 26 1965  
 CONSERVATION DIVISION  
 WICHITA, KANSAS

I, the undersigned, being first duly sworn upon oath state that this well record is true, correct and complete according to the records of this office and to the best of my knowledge and belief.

John O. Farmer  
 Name and title of representative of company  
 President

Subscribed and sworn to before me this 25th day of May, 1965

My Commission expires 2/15/67  
Helen Carlson  
 Notary Public

FARM NAME KEHLBECK

State of Kansas



15-023-30024-00-00

WM. H. AVERY Governor  
 WILLIAM L. MITCHELL Chairman  
 JAMES O. GREENLEAF Commissioner  
 HARRY G. WILES Commissioner  
 RAYMOND B. HARVEY Secretary  
 E. EDWARD JOHNSON Gen. Counsel

## State Corporation Commission

## CONSERVATION DIVISION

(Oil, Gas and Water)  
 500 Insurance Bldg. 212 N. Market  
 WICHITA, KANSAS 67202

May 26, 1965

WELL PLUGGING AUTHORITY

Well No.	1
Lease	Kehlbeck
Description	C SE NE 20-2-37W
County	Cheyenne
Total Depth	5100'
Plugging Contractor	Co. Tools

John O. Farmer Inc.  
 P. O. Box 352  
 Russell, Kansas

Gentlemen:

This is your authority to plug the above subject well in accordance with the Rules and Regulations of the State Corporation Commission.

This authority is void after 90 days from the above date.

Very truly yours,

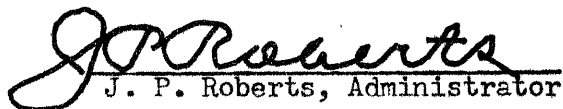
  
 J. P. Roberts, Administrator

Mr. W. L. Nichols Morland, Kansas  
 is hereby assigned to supervise the plugging of the above named well.