

ORIGINAL

STATE CORPORATION COMMISSION OF KANSAS
OIL & GAS CONSERVATION DIVISION
WELL COMPLETION FORM
ACD-1 WELL HISTORY
DESCRIPTION OF WELL AND LEASE

API NO. 15- 153-20,795-00-00

County Rawlins

SW SW NE NE Sec. 6 Twp. 2S Rge. 34 X ^E _W

2310' Feet from SW (circle one) Line of Section

2310' Feet from EW (circle one) Line of Section

Footages Calculated from Nearest Outside Section Corner:
NE SE, NW or SW (circle one)

Lease Name Skolout Well # 1

Field Name Wildcat

Producing Formation LKC

Elevation: Ground 3172' KB 2177'

Total Depth 4445' PBTD _____

Amount of Surface Pipe Set and Cemented at 287 Feet

Multiple Stage Cementing Collar Used? _____ Yes _____ No

If yes, show depth set _____ Feet

If Alternate II completion, cement circulated from _____

feet depth to _____ w/ _____ sx cmt.

Drilling Fluid Management Plan DFA 4-13-93
(Data must be collected from the Reserve Pit)

Chloride content 1000 ppm Fluid volume _____ bbls

Dewatering method used evaporation

Location of fluid disposal if hauled offsite: _____

Operator Name _____

Lease Name _____ License No. _____

Quarter _____ Sec. _____ Twp. _____ S Rng. _____ E/W

County _____ Docket No. _____

Operator: License # 6875

Name: Marmik Oil Company

Address 200 N. Jefferson, Suite 500

City/State/Zip El Dorado, AR 78730

Purchaser: _____

Operator Contact Person: Curtis G. Morrill

Phone (501) 862-8546

Contractor: Name: Abercrombie RTD, Inc.

License: 30684

Wellsite Geologist: _____

Designate Type of Completion

New Well Re-Entry Workover

Oil SWD SOW Temp. Abu.

Gas ENHR SIGW

Dry Other (Core, WSW, Expl., Cathodic, etc)

If Workover/Re-Entry: old well info as follows:

Operator: N/A

Well Name: _____

Comp. Date _____ Old Total Depth _____

Deepening Re-perf. Conv. to Inj/SWD

Plug Back PBTD

Commingled Docket No. _____

Dual Completion Docket No. _____

Other (SWD or Inj?) Docket No. _____

2-2-93 2-12-93

Spud Date 2-2-93 Date Reached TD 2-12-93 Completion Date _____

INSTRUCTIONS: An original and two copies of this form shall be filed with the Kansas Corporation Commission, 200 Colorado Derby Building, Wichita, Kansas 67202, within 120 days of the spud date, recompletion, workover or conversion of a well. Rule 82-3-130, 82-3-106 and 82-3-107 apply. Information on side two of this form will be held confidential for a period of 12 months if requested in writing and submitted with the form (see rule 82-3-107 for confidentiality in excess of 12 months). One copy of all wireline logs and geologist well report shall be attached with this form. ALL CEMENTING TICKETS MUST BE ATTACHED. Submit CP-4 form with all plugged wells. Submit CP-111 form with all temporarily abandoned wells.

All requirements of the statutes, rules and regulations promulgated to regulate the oil and gas industry have been fully complied with and the statements herein are complete and correct to the best of my knowledge.

Signature Curtis Morrill

Title Geologist Date 3/3/93

Subscribed and sworn to before me this 3 day of March 19 93.

Notary Public Kay B. Reser

Date Commission Expires February 2, 2001

K.C.C. OFFICE USE ONLY

Center of Confidentiality Attached

Wireline Log Received

Geologist Report Received

Distribution

SWD/Rep NGPA

Plug Other (Specify)

RECEIVED
STATE CORPORATION COMMISSION
APR 5 1993
04-05-1993
CONSERVATION DIVISION
Wichita, Kansas

Operator Name Marmik Oil Company Lease Name Skolout Well # #1
 Sec. 6 Twp. 2S Rge. 34 East County Rawlins
 West

INSTRUCTIONS: Show important tops and base of formations penetrated. Detail all cores. Report all drill stem tests giving interval tested, time well open and closed, flowing and shut-in pressures, whether shut-in pressure reached static level, hydrostatic pressures, bottom hole temperature, fluid recovery, and flow rates if gas to surface during test. Attach extra sheet if more space is needed. Attach copy of log.

Drill Stem Tests Taken Yes No
 (Attach Additional Sheets.)
 Samples Sent to Geological Survey Yes No
 Cores Taken Yes No
 Electric Log Run Yes No
 (Submit Copy.)

Log Formation (Top), Depth and Datums Sample
 Name Top Datum
 Anhydrite 3028 +147
 Base 3065 +110
 Heebner 4068 -893
 Lansing 4115 -940

List All E.Logs Run: Rad. Guard, Comp. Den/Neut.

DST #1 3867-3922 30-30-60-30, Rec. 80' MW with SO
 120' MW (200' total fluid)
 IFP 26-66#, FFP 68-115#, SIP 1088-970#

CASING RECORD <input type="checkbox"/> New <input type="checkbox"/> Used							
Report all strings set-conductor, surface, intermediate, production, etc.							
Purpose of String	Size Hole Drilled	Size Casing Set (In O.D.)	Weight Lbs./Ft.	Setting Depth	Type of Cement	# Sacks Used	Type and Percent Additives
Surface	12 1/4"	8 5/8"	20#	287'	60-40 poxmix	205	3% cc 2% gel

ADDITIONAL CEMENTING/SQUEEZE RECORD				
Purpose:	Depth Top Bottom	Type of Cement	#Sacks Used	Type and Percent Additives
<input type="checkbox"/> Perforate				
<input type="checkbox"/> Protect Casing				
<input type="checkbox"/> Plug Back TD				
<input type="checkbox"/> Plug Off Zone				

Shots Per Foot	PERFORATION RECORD - Bridge Plugs Set/Type		Acid, Fracture, Shot, Cement Squeeze Record	
	Specify Footage of Each Interval Perforated		(Amount and Kind of Material Used)	Depth

TUBING RECORD		Size	Set At	Packer At	Liner Run <input type="checkbox"/> Yes <input type="checkbox"/> No
Date of First, Resumed Production, SWD or Inj.		Producing Method <input type="checkbox"/> Flowing <input type="checkbox"/> Pumping <input type="checkbox"/> Gas Lift <input type="checkbox"/> Other (Explain)			
Estimated Production Per 24 Hours	Oil Bbls.	Gas Mcf	Water Bbls.	Gas-Oil Ratio	Gravity

Disposition of Gas: Vented Sold Used on Lease (If vented, submit ACO-18.)

METHOD OF COMPLETION Open Hole Perf. Dually Comp. Commingled Other (Specify) _____

Production Interval _____

TRILOBITE TESTING, L.L.C. ORIGINAL

P.O. Box 362 • Hays, Kansas 67601

Drill-Stem Test Data 15-153-20795-00-00

Well Name SKOLOUT #1 Test No. 1 Date 2/9/93
Company MARMIK OIL COMPANY Zone TOPEKA
Address 200 N JEFFERSON #500 EL DORADO ARK 71730 Elevation 3177
Co. Rep./Geo. CURTIS MORRILL Cont. ABERC DRLG RIG #4 Est. Ft. of Pay _____
Location: Sec. 6 Twp. 2S Rge. 34W Co. RAWLINS State KS

Interval Tested 3867-3922 Drill Pipe Size 4.5" XH
Anchor Length 55 Wt. Pipe I.D. - 2.7 Ft. Run 630
Top Packer Depth 3862-3867 Drill Collar - 2.25 Ft. Run 60
Bottom Packer Depth 3922 Mud Wt. 9 lb/Gal.
Total Depth 3990 Viscosity 44 Filtrate 10.2

Tool Open @ 8:27 PM Initial Blow WEAK TO FAIR BLOW - SLOW INCREASE TO 5.5" IN WATER

Final Blow WEAK TO FAIR BLOW - SLOW INCREASE TO 4.5" IN WATER

Recovery - Total Feet 200 Flush Tool? NO

Rec. 80 Feet of MUDDY WATER W/ FEW OIL SPECKS-80%WTR/20%MUD
Rec. 120 Feet of MUDDY WATER-88%WTR/12%MUD
Rec. _____ Feet of THIN LAYER OF CLEAR OIL AT TOP OF TOOL
Rec. _____ Feet of _____
Rec. _____ Feet of _____

BHT 116 °F Gravity _____ °API @ _____ °F Corrected Gravity _____ °API
RW 0.22 @ 66 °F Chlorides 56000 ppm Recovery Chlorides 1000 ppm System

(A) Initial Hydrostatic Mud 1905.6 PSI AK1 Recorder No. 10248 Range 4400

(B) First Initial Flow Pressure 26.4 PSI @ (depth) 3882 w / Clock No. 30410

(C) First Final Flow Pressure 66.3 PSI AK1 Recorder No. 13278 Range 4400

(D) Initial Shut-in Pressure 1088.7 PSI @ (depth) 3917 w / Clock No. 22993

(E) Second Initial Flow Pressure 68.5 PSI AK1 Recorder No. 13224 Range 4350

(F) Second Final Flow Pressure 115.6 PSI @ (depth) 3987 w / Clock No. 27785

(G) Final Shut-in Pressure 970.4 PSI Initial Opening 30 Final Flow 60

(H) Final Hydrostatic Mud 1811.2 PSI Initial Shut-in 30 Final Shut-in 30

Our Representative GARY PEVOTEAUX

ORIGINAL

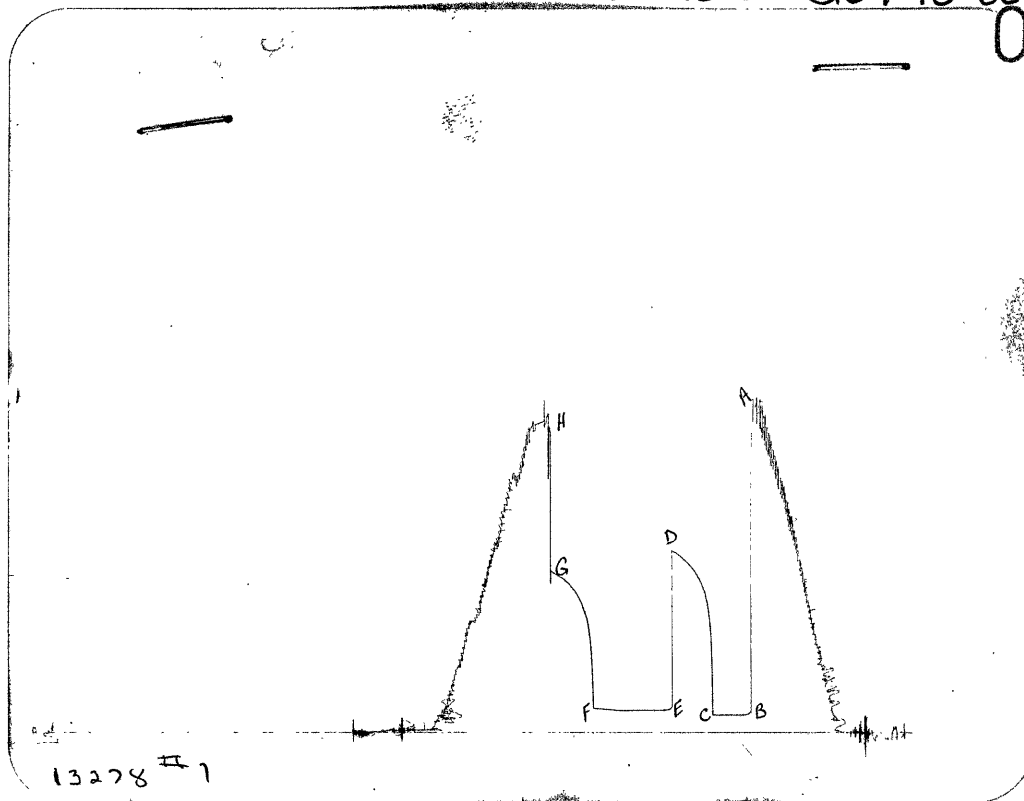

This is an actual photograph of recorder chart

	FIELD READING	OFFICE READING
(A) INITIAL HYDROSTATIC MUD	1898	1905.6
(B) FIRST INITIAL FLOW PRESSURE	25	26.4
(C) FIRST FINAL FLOW PRESSURE	64	66.3
(D) INITIAL CLOSED-IN PRESSURE	1086	1088.7
(E) SECOND INITIAL FLOW PRESSURE	66	68.5
(F) SECOND FINAL FLOW PRESSURE	112	115.6
(G) FINAL CLOSED-IN PRESSURE	975	970.4
(H) FINAL HYDROSTATIC MUD	1808	1811.2

ORIGINAL

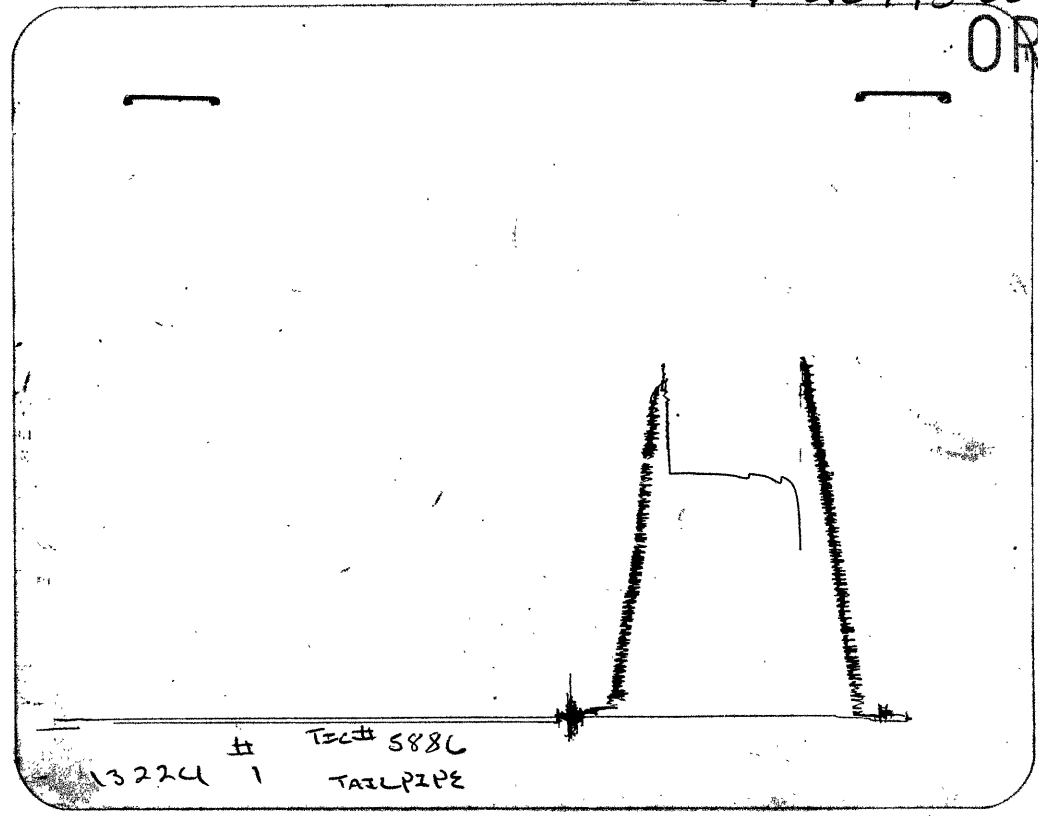

This is an actual photograph of recorder chart

FIELD	OFFICE
READING	READING

- (A) INITIAL HYDROSTATIC MUD
- (B) FIRST INITIAL FLOW PRESSURE
- (C) FIRST FINAL FLOW PRESSURE
- (D) INITIAL CLOSED-IN PRESSURE
- (E) SECOND INITIAL FLOW PRESSURE
- (F) SECOND FINAL FLOW PRESSURE
- (G) FINAL CLOSED-IN PRESSURE
- (H) FINAL HYDROSTATIC MUD

TRILOBITE TESTING L.L.C.

P.O. Box 362 • Hays, Kansas 67601

ORIGINAL

15-153-20795-00-00

Test Ticket

No 5886

Well Name & No. SKOLOUT #1 Test No. 1 Date 2-9-93
 Company MARMIK OIL COMPANY Zone Tested TOPEKA
 Address 300 N. JEFFERSON SUITE 500 EL DORADO ARKANSAS Elevation 3177 K.B.
 Co. Rep./Geo. CURTIS MORRILL cont. ABERCROMBIE DRUG #4 Est. Ft. of Pay _____
 Location: Sec. 6 Twp. 2^S Rge. 34^W Co. RAWLINS State Ks.
 No. of Copies _____ Distribution Sheet _____ Yes _____ No _____ Turnkey _____ Yes _____ No _____ Evaluation _____

Interval Tested 3867 - 3922' Drill Pipe Size 4 1/2" X.H.
 Anchor Length 55' Top Choke — 1" Bottom Choke — 3/4"
 Top Packer Depth 3862 & 3867' Hole Size — 7 7/8" Rubber Size — 6 3/4"
 Bottom Packer Depth 3922' Wt. Pipe I.D. — 2.7 Ft. Run 630'
 Total Depth 3990' Drill Collar — 2.25 Ft. Run 60'
 Mud Wt. 9.0 lb/gal. Viscosity 44 Filtrate 10.2 cc.
 Tool Open @ 8:27 P.M. Initial Blow Weak to fair blow. (slow increase to 5 1/2" in H₂O)
 Final Blow Weak to fair blow. (slow increase to 4 1/2" in H₂O)

Recovery — Total Feet	Feet of Gas in Pipe	Flush Tool?
<u>200'</u>	<u>Trace</u>	<u>No</u>
Rec. <u>80</u> Feet Of <u>M.W. @ a few oil specks</u>	% gas _____ % oil <u>80</u> % water <u>20</u> % mud _____	
Rec. <u>120</u> Feet Of <u>M.W.</u>	% gas _____ % oil <u>88</u> % water <u>12</u> % mud _____	
Rec. _____ Feet Of <u>Thin layer of clean</u>	% gas _____ % oil _____ % water _____ % mud _____	
Rec. _____ Feet Of <u>oil @ top of tool</u>	% gas _____ % oil _____ % water _____ % mud _____	
Rec. _____ Feet Of _____	% gas _____ % oil _____ % water _____ % mud _____	

BHT 116 °F Gravity N.A. °API @ _____ °F Corrected Gravity N.A. °API
 RW 0.22 @ 66 °F chlorides 56,000 ppm Recovery Chlorides 1,000 ppm System

(A) Initial Hydrostatic Mud 1898 PSI Ak1 Recorder No. 10248 Range 4400
 (B) First Initial Flow Pressure 25 PSI @ (depth) 3882' w/Clock No. 30410
 (C) First Final Flow Pressure 64 PSI AK1 Recorder No. 13278 Range 4400
 (D) Initial Shut-In Pressure 1086 PSI @ (depth) 3917' w/Clock No. 22993
 (E) Second Initial Flow Pressure 66 PSI TAPE PIPE AK1 Recorder No. 13224 Range 4350
 (F) Second Final Flow Pressure 112 PSI @ (depth) 3987' w/Clock No. 27785 18HR.
 (G) Final Shut-In Pressure 975 PSI Initial Opening 30 Test 600⁰⁰
 (H) Final Hydrostatic Mud 1808 PSI Initial Shut-In 30 Jars 200⁰⁰

TRILOBITE TESTING L.L.C. SHALL NOT BE LIABLE FOR DAMAGE OF ANY KIND OF THE PROPERTY OR PERSONNEL OF THE ONE FOR WHOM A TEST IS MADE, OR FOR ANY LOSS SUFFERED OR SUSTAINED, DIRECTLY OR INDIRECTLY, THROUGH THE USE OF ITS EQUIPMENT, OR ITS STATEMENTS OR OPINION CONCERNING THE RESULTS OF ANY TEST. TOOLS LOST OR DAMAGED IN THE HOLE SHALL BE PAID FOR AT COST BY THE PARTY FOR WHOM THE TEST IS MADE.

Final Flow 60 Safety Joint 50⁰⁰
 Final Shut-In 30 Straddle 250⁰⁰
 Circ. Sub _____
 Sampler _____

Approved By _____
 Our Representative Cory Proctor

Extra Packer 150⁰⁰
 Other _____
 TOTAL PRICE \$ 1,250⁰⁰

TELEPHONE:

AREA CODE 913 483-2627

ALLIED CEMENTING COMPANY, INC.

P. O. BOX 31
RUSSELL, KANSAS 67665

ORIGINAL

15-153-20795 - 00-00

TO: Marmik Oil Company
200 N. Jefferson #500
El Dorado, Arkansas 71730

INVOICE NO. 63441
PURCHASE ORDER NO. _____
LEASE NAME Skolout #1
DATE Feb. 3, 1993

SERVICE AND MATERIALS AS FOLLOWS:

Common 123 sks @\$6.35	\$ 781.05	
Pozmix 82 sks. @\$2.65	217.30	
Chloride 6 sks @\$21.00	<u>126.00</u>	\$ 1,124.35
Handling 205 sks @\$1.00	205.00	
Mileage (40) @\$0.04¢ per sk per mi	328.00	
Surface	380.00	
Mi @\$2.00 pmp. trk.	80.00	
1 plug	<u>42.00</u>	<u>1,035.00</u>

If account CURRENT 20% discount will be allowed ONLY if paid within 30 days from date of invoice.

Total \$ 2,159.35

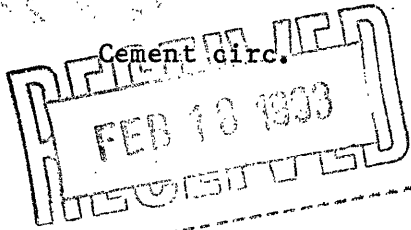

THANK YOU

All Prices Are Net, Payable 30 Days Following Date of Invoice. 1½% Charged Thereafter.

RECEIVED
STATE CORPORATION COMMISSION

APR - 5 1993

CONSERVATION DIVISION

ORIGINAL

913-483-2627; Russell, Kansas

Phone 316-793-5861, Great Bend, Kansas

Phone Plainville 913-434-2812

Phone Ness City 913-798-3843

15-153-20795-00-00

ALLIED CEMENTING CO., INC.

5236

Home Office P. O. Box 31

Russell, Kansas 67665

New

Date	2-11-93	Sec.	6	Fwp.	2	Range	34	Called Out	4:00pm	On Location	9:00am	Job Start	10:30pm	Finish	2am
Lease	Skolent	Well No.	1	Location	Atwood	4N-6W-2N-2W-Sin			County	Rawlins	State	KS			
Contractor	Aber Oily #4 RTD														
Type Job	PTA														
Hole Size	7 7/8		T.D.	4445											
Csg.			Depth												
Tbg. Size			Depth												
Drill Pipe	4 1/2 16.6		Depth	3030											
Tool			Depth												
Cement Left in Csg.			Shoe Joint												
Press Max.			Minimum												
Meas Line			Displace												
Perf.															

Owner Marmik

To Allied Cementing Co., Inc.
You are hereby requested to rent cementing equipment and furnish cementer and helper to assist owner or contractor to do work as listed.

Charge To Marmik

Street 200 N. Jefferson, Suite 500

City El Dorado State Arkansas 71730

The above was done to satisfaction and supervision of owner agent or contractor.

Purchase Order No.

X Harold Moley

CEMENT

Amount Ordered 190 sk 60/40 626.61 2 sk Celloflake

Consisting of

Common	114 sk	Q	6.85	780.90
Poz. Mix	76 sk	Q	3.00	228.00
Gel.	7 sk	Q	7.00	49.00
Chloride				
Quickset				
Celloflake	2 sk	Q	25.00	50.00

Sales Tax

Handling 1.00 per sk 190.00

Mileage 4¢ per sk/mile 43 mile 326.80

Sub Total

4643.70

Total

Floating Equipment

RECEIVED
STATE CORPORATION COMMISSION

APR - 5 1993

CONSERVATION DIVISION
Missouri Kansas

EQUIPMENT

Orkey No.	Cementer	Fitz
Pumptrk 300	Helper	Terry
No.	Cementer	
Pumptrk	Helper	
	Driver	Steve
Bulktrk 212		
Bulktrk	Driver	

DEPTH of Job 3030

Reference:	1 8 5/8 Dry Hole Plug	21.00
	Pumptruck	525.00
	2.25 per mile	96.75
	Sub Total	642.75
	Tax	
	Total	

Remarks:

25 sk @ 3030

100 sk @ 2270

40 sk @ 330

10 sk @ 40

15 sk @ Rathole

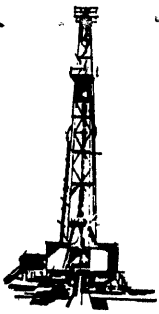

AMERICAN ELEVATIONS, Inc.

WICHITA 316-262-3311

P.O. BOX 56

HAYS 913-625-4275

HAYS, KANSAS 67601



Marmik Oil Company

1

Skolout

(OPERATOR)

(NO)

(LEASE)

Rawlins

Ks.

6

2s

34w

SW SW NE

(COUNTY)

(STATE)

S

T

R

(LOCATION)

Curtis Morrill

1-4-93

(AUTHORIZED BY)

(DATE)



1 mi. to St. Johns Church

Good rd.

Scale: 1" = 1000'

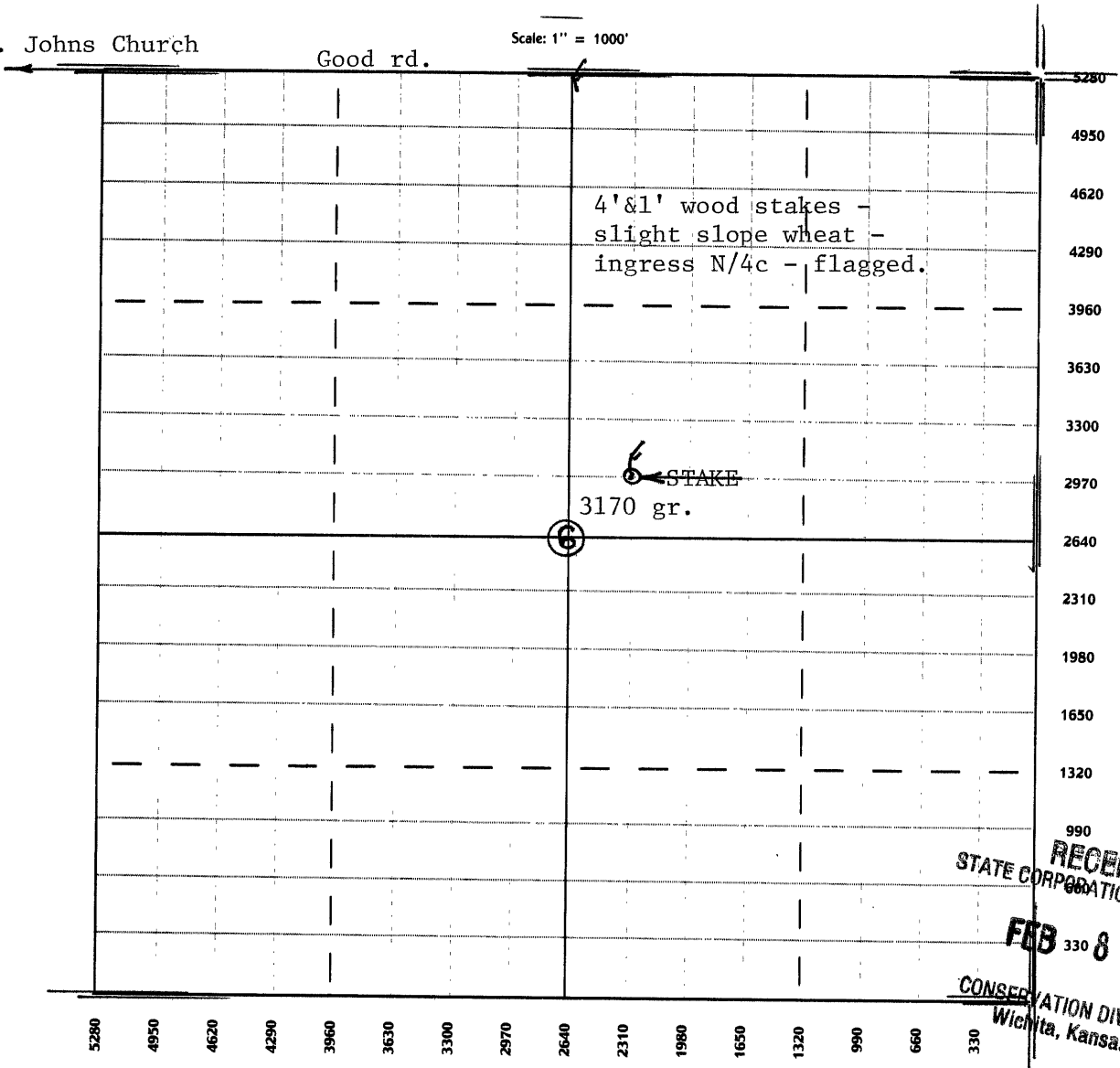

RECEIVED
STATE CORPORATION COMMISSION

FEB 8 1993

CONSERVATION DIVISION
Wichita, Kansas

EDB #36

FOR KCC USE:

EFFECTIVE DATE: 1-30-93
DISTRICT # 4
SGA7 Yes No

Rawlins 795

FORM MUST BE TYPE
FORM MUST BE SIGNED
BLANK MUST BE FILLED

Must be approved by the K.C.C. five (5) days prior to commencing well

Expected Spud Date 2 2 93
month day year

SW SW NE Sec 6 Twp 2 S. Rg 34 Eas

prf < OK No
my ch

alt I

OPERATOR: License # 6875
Name: Marmik Oil Company
Address: 200 N. Jefferson, Suite 500
City/State/Zip: El Dorado, Arkansas 71730
Contact Person: Curtis G. Morrill
Phone: (501) 862-8546

2310 feet from South / (North) line of Section
2310 feet from (East) / West line of Section

IS SECTION REGULAR X IRREGULAR?

(NOTE: Locate well on the Section Plat on Reverse Side
County: Rawlins

CONTRACTOR: License # 5422
Name: Abercrombie Drilling

Lease Name: Skolout Well # 1
Field Name: Wildcat

Is this a Prorated/Spaced Field? yes X no

Target Formation(s): LKC

Nearest lease or unit boundary: 330'

Ground Surface Elevation: 3172. Est feet MS

Water well within one-quarter mile: yes X no

Public water supply well within one mile: yes X no

Depth to bottom of fresh water: 120'

Depth to bottom of usable water: 225'

Surface Pipe by Alternate: X 1

Length of Surface Pipe Planned to be set: 275.2

Length of Conductor pipe required:

Projected Total Depth: 4450

Formation at Total Depth: PENN

Water Source for Drilling Operations:
... well X farm pond ... other

DWR Permit #:

Will Cores Be Taken? yes X no

If yes, proposed zone:

Well Drilled For:	Well Class:	Type Equipment:
<input checked="" type="checkbox"/> Oil	Enh Rec	Infield
<input type="checkbox"/> Gas	Storage	Pool Ext.
<input type="checkbox"/> CWVO	Disposal	Wildcat
<input type="checkbox"/> Seismic;	# of Holes	Other
<input type="checkbox"/> Other		

If CWVO: old well information as follows:
Operator:
Well Name:
Comp. Date: Old Total Depth

Directional, Deviated or Horizontal wellbore? yes X no
If yes, true vertical depth:
Bottom Hole Location:

Harold Maley AFFIDAVIT Hauling

The undersigned hereby affirms that the drilling, completion and eventual plugging of this well will comply with K.S.A. 55-101, et. seq.
It is agreed that the following minimum requirements will be met:

1. Notify the appropriate district office prior to spudding of well;
2. A copy of the approved notice of intent to drill shall be posted on each drilling rig;
3. The minimum amount of surface pipe as specified below shall be set by circulating cement to the top; in all cases surface pipe shall be set through all unconsolidated materials plus a minimum of 20 feet into the underlying formation;
4. If the well is dry hole, an agreement between the operator and the district office on plug length and placement is necessary prior to plugging;
5. The appropriate district office will be notified before well is either plugged or production casing is cemented in;
6. IF AN ALTERNATE II COMPLETION, PRODUCTION PIPE SHALL BE CEMENTED FROM BELOW ANY USABLE WATER TO SURFACE WITHIN 120 DAYS OF SPUD DATE. IN ALL CASES, NOTIFY DISTRICT OFFICE PRIOR TO ANY CEMENTING.

I hereby certify that the statements made herein are true and to the best of my knowledge and belief.
Date: 1-22-93 Signature of Operator or Agent: Curtis Morrill Title: Geologist

KCC
JAN 26 1993
HAYS, KS

FOR KCC USE:
API # 15-153 - 20795-00-00
Conductor _____ feet
Minimum surface pipe required 415 feet per Alt. X
Approved by: CB 1-25-93
This authorization expires 7-25-93
(This authorization void if drilling not started within 6 months of effective date)
Signature: E.A.D.
Date: 2-2-93

RECEIVED
STATE CORPORATION COMMISSION
FEB 24 1993
RECEIVED
STATE CORPORATION COMMISSION
CONSERVATION DIVISION
Wichita, Kansas
JAN 25 1993
CONSERVATION DIVISION
WICHITA, KANSAS

- REMEMBER TO:
- File Drilling Pit Application (form CP-1) with Intent to Drill;
 - File Completion Form ACO-1 within 20 days of spud date;
 - File acreage contribution plan according to field preparation orders;
 - Notify appropriate district office 48 hours prior to workover or re-entry;
 - Submit plugging report (CP-4) after plugging is completed;
 - Obtain written approval before disposing or injecting salt water.

Mail to: Conservation Division, 206 Colorado Derby Building, 202 W. First St., Wichita, Kansas 67202-1286.