

STATE OF KANSAS  
STATE CORPORATION COMMISSION  
CONSERVATION DIVISION  
200 Colorado Derby Building  
Wichita, Kansas 67202

Rev. 12/14/82  
FORM CP-1

RECEIVED  
STATE CORPORATION COMMISSION

FEB 08 1984  
2-8-84  
CONSERVATION DIVISION  
Wichita, Kansas

15-137-00572-00-00

WELL PLUGGING APPLICATION FORM

File One Copy

API NUMBER July 2, 1954 (of this well)  
(This must be listed; if no API# was issued, please note drilling completion date.)

LEASE OPERATOR John O. Farmer, Inc. OPERATORS LICENSE NO. 5135

ADDRESS P.O. Box 352, Russell, KS 67665 PHONE # (913) 483-3144

LEASE (FARM NAME) Mindrup WELL NO. #7

WELL LOCATION C NW/4 SEC. 31 TWP. 3S RGE. 23W (~~XXX~~(W))

COUNTY Norton TOTAL DEPTH 3685' FIELD NAME Norton

check one:

OIL WELL  GAS WELL  INPUT WELL  SWD WELL  D&A

IS WELL LOG ATTACHED TO THIS APPLICATION AS REQUIRED? Yes IS ACO-1 FILED? No - Well  
(If not, explain) Drilled Prior  
to Inception of

DATE AND HOUR PLUGGING IS DESIRED TO BEGIN 9:00 A.M., 2-13-84 ACO-1

PLUGGING OF THIS WELL WILL BE DONE IN ACCORDANCE WITH K.S.A. 55-128 OF THE RULES AND REGULATIONS OF THE STATE CORPORATION COMMISSION.

NAME OF COMPANY REPRESENTATIVE AUTHORIZED TO BE IN CHARGE OF PLUGGING OPERATIONS:

Lawrence Eichman ADDRESS R. R. 1, Plainville, KS 67663

PHONE # (913) 434-2444

PLUGGING CONTRACTOR John O. Farmer, Inc. LICENSE NO. 5135

ADDRESS P.O. Box 352, Russell, KS 67665 PHONE # (913) 483-3144

INVOICE COVERING ASSESSMENT FOR PLUGGING THIS WELL SHOULD BE SENT TO:

NAME John O. Farmer, Inc.

ADDRESS P.O. Box 352, Russell, KS 67665 PHONE # (913) 483-3144

AND PAYMENT WILL BE GUARANTEED BY APPLICANT OR ACTING AGENT.

SIGNED: John O. Farmer, Inc.  
(Applicant or Acting Agent)

DATE: February 7, 1984

OPERATOR Jones, Shelburne & Farmer, Inc.

FORMATION RECORD

ADDRESS Russell, Kansas

Give detailed description and thickness of all formations drilled through, contents of sand, whether dry, water, oil or gas.

WELL NO. 7 COUNTY 7 TWP. 3 SBC. 31 TWR. 3 RGE. 23

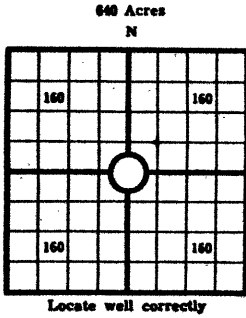

COUNTY Norton SEC 31 TWR 3 RGE 23  
 COMPANY OPERATING Jones, Shelburne & Farmer, Inc.  
 OFFICE ADDRESS Russell, Kansas  
 FARM NAME Midway WELL NO. 7  
 DRILLING STARTED 6-23-54 DRILLING FINISHED 7-2-54  
 DATE OF FIRST PRODUCTION \_\_\_\_\_ COMPLETED \_\_\_\_\_  
 WELL LOCATED 8 1/4 1/4 North of South  
 Line and \_\_\_\_\_ ft. East of West Line of Quarter Section  
 Elevation (Relative to sea level) DERRICK FLOOR 2562 GROUND \_\_\_\_\_  
 CHARACTER OF WELL (Oil, gas or dryhole) Oil

OIL OR GAS SANDS OR ZONES

Name	From	To	Name	From	To
1			4		
2			5		
3			6		

Perforating Record if Any

Shot Record

Formation	From	To	No. of Shots	Formation	From	To	Size of Shot

CASING RECORD

Amount Set							Amount Pulled		Packer Record		
Size	Wt.	Thds.	Make	Ft.	In.	Ft.	In.	Size	Length	Depth Set	Make
8 5/8				290							
5 1/2				362							

Liner Record: Amount \_\_\_\_\_ Kind \_\_\_\_\_ Top \_\_\_\_\_ Bottom \_\_\_\_\_

CEMENTING AND MUDDING

Size	Amount Set		Sacks Cement	Chemical		Method of Cementing	Amount	Mudding Method	Results (See Note)
	Ft.	In.		Gal.	Make				
5 1/2	362		175						

Note: What method was used to protect sands if outer strings were pulled? \_\_\_\_\_

NOTE: Were bottom hole plugs used? \_\_\_\_\_ If so, state kind, depth set and results obtained \_\_\_\_\_

TOOLS USED

Rotary Tools were used from \_\_\_\_\_ feet to \_\_\_\_\_ feet. Cable tools were used from \_\_\_\_\_ feet to \_\_\_\_\_ feet, and from \_\_\_\_\_ feet to \_\_\_\_\_ feet, and from \_\_\_\_\_ feet to \_\_\_\_\_ feet.

Type Rig \_\_\_\_\_

INITIAL PRODUCTION TEST

Describe initial test: whether by flow through tubing or casing or by pumping \_\_\_\_\_

Amount of Oil Production \_\_\_\_\_ bbls. Size of choke, if any \_\_\_\_\_ Length of test \_\_\_\_\_ Water

Production \_\_\_\_\_ bbls. Gravity of oil \_\_\_\_\_ Type of Pump if pump is used, describe \_\_\_\_\_

Formation	Top	Bottom	Formation	Top	Bottom
Shale & sand	0	256			
Shale, sand shells	256	1500			
Shale & shells	2500	1590			
Sand	1590	1700			
Shale shells red bed	1700	1949			
Anhydrite	1949	1980			
Shale & shells	1980	2100			
Shale & lime	2100	2700			
Lime & shale	2700	2800			
Shale & lime	2800	2950			
Lime & shale	2950	3045			
Shale & lime	3045	3160			
Lime & shale	3160	3300			
Shale & lime	3300	3400			
Lime & shale	3400	3575			
Shale & lime	3575	3630			
Lime & shale	3630	3681			
Artuckle	3681	3685			

15-137-00572-00-00

RECEIVED  
STATE CORPORATION COMMISSION

FEB 08 1984 2-8-84

CONSERVATION DIVISION  
Wichita, Kansas

TOPS:

Elevation 256  
 Heibner 1590  
 Lansing 312  
 Artuckle 3681  
 T. D. 3685

I, the undersigned, being first duly sworn upon oath, state that this well record is true, correct and complete according to the records of this office and to the best of my knowledge and belief.

John Farmer  
 Name and title of representative of company

Subscribed and sworn to before me this 7th day of July, 1954  
 My Commission expires April 15, 1956  
Francis J. Smyth  
 Notary Public

State of Kansas



15-137-00572-00-00

GOVERNOR  
COMMISSIONER  
EXECUTIVE SECRETARY  
GENERAL COUNSEL

GOVERNOR  
COMMISSIONER  
EXECUTIVE SECRETARY  
GENERAL COUNSEL

State Corporation Commission

CONSERVATION DIVISION

(Oil, Gas and Water)  
200 Colorado Derby Building  
202 West 1st Street  
WICHITA, KANSAS 67202-1286

THIS NOTICE

MAY 09 1984

EXPIRES

February 9, 1984

WELL PLUGGING NOTICE

Mindrup #7  
C-NW/4  
Sec. 31-3-23W  
Norton County

John O. Farmer, Inc.  
P.O. Box 352  
Russell, Ks. 67665

Gentlemen:

This is your notice to plug the above subject well in accordance with the Rules and Regulations of the State Corporation Commission.

This notice is void after ninety (90) days from the above date.

Yours very truly,

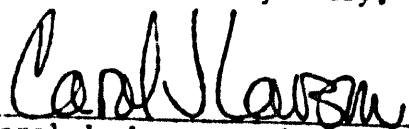
  
Carol J. Larson, Administrator

Please submit your proposal for plugging the above captioned well to

DIST. #6 1014 Cody Hays, Ks. 67601

seven days prior to plugging the well (KAR-82-3-113)