

STATE OF KANSAS
STATE CORPORATION COMMISSION
CONSERVATION DIVISION
211 NORTH BROADWAY
WICHITA, KANSAS

15-137-00730-00-00

WELL PLUGGING APPLICATION FORM
File One Copy

Lease Owner Jones, Shelburne & Farmer, Inc. Address 370 W. Wichita Ave. Russell, Kansas
(Applicant)

Lease (Farm Name) Carr - Sneed Well No. #2

Well Location C N/2 SW Sec. 31 Twp. 3 Rge. 23 () (W) X

County Norton Field Name (if any) Norton

Total Depth 3737 Oil Gas Dry Hole

Was well log filed with application? Yes If not, explain: _____

Date and hour plugging is desired to begin Soon

Plugging of the well will be done in accordance with the Rules and Regulations of
the State Corporation Commission.

Name of the person on the lease in charge of well for owner _____

Harold A. Carlson Address 370 W. Wichita Ave., Russell, Kansas

Plugging Contractor Jones, Shelburne & Farmer, Inc.

Plugging Contractor's License No. _____

Address 370 West Wichita Avenue, Russell, Kansas

Invoice covering assessment for plugging this well should be sent to _____

Jones, Shelburne & Farmer, Inc. Address 370 W. Wichita Ave., Russell, Kansas

and payment will be guaranteed by applicant.

John W. Farmer
Applicant or Acting Agent

STATE CORPORATION COMMISSION
SEP 16 1957
CONSERVATION DIVISION
Wichita, Kansas
9-16-57

Date September 12, 1957

PLUGGING
FILE SEC. 31 T. 3 R. 23 W
BOOK PAGE 45 LINE 24

OPERATOR Jones, Shelburne & Farmer, Inc.

FORMATION RECORD

Give detailed description and thickness of all formation drilled through, contents of sand, whether dry, water, oil or gas.

ADDRESS Russell, Kansas

EARM NAME Carry-Sneed WELL NO. 2 COUNTY Norton SEC. 31 TWP. 3 RGE. 23

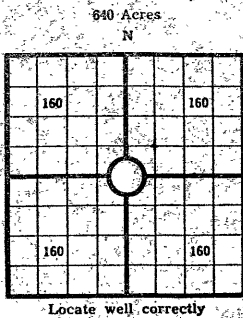

COUNTY Norton, SEC. 31, TWP. 3, RGE. 23
 COMPANY OPERATING Jones, Shelburne & Farmer, Inc.
 OFFICE ADDRESS Russell, Kansas
 DRILLING STARTED 11/15/53 DRILLING FINISHED 11/27/53
 DATE OF FIRST PRODUCTION 12/7/53 COMPLETED _____
 WELL LOCATED C 1/4 N/2 x SW 1/4, North of South
 Line and _____ ft. East of West Line of Quarter Section
 Elevation (Relative to sea level) DERRICK FLOOR 2413 GROUND, _____
 CHARACTER OF WELL (Oil, gas or dryhole) Oil

OIL OR GAS SANDS OR ZONES

Name	From	To	Name	From	To
1			4		
2			5		
3			6		

Perforating Record If Any

Shot Record

Formation	From	To	No. of Shots	Formation	From	To	Size of Shot

CASING RECORD

Amount Set							Amount Pulled		Packer Record		
Size	Wt.	Thds.	Make	Ft.	In.	Ft.	In.	Size	Length	Depth Set	Make
8/58				280							
5 1/2				3735							

Liner Record: Amount _____ Kind _____ Top _____ Bottom _____

CEMENTING AND MUDDING

Size	Amount Set		Sacks Cement	Chemical		Method of Cementing	Amount	Mudding Method	Results (See Note)
	Ft.	In.		Gal.	Make				
8 5/8	280		125						
5 1/2	3735								

Note: What method was used to protect sands if outer strings were pulled? _____

NOTE: Were bottom hole plugs used? _____ If so, state kind, depth set and results obtained _____

TOOLS USED

Rotary Tools were used from _____ feet to _____ Cable tools were used from _____ feet to _____ feet, and from _____ feet to _____ feet, and from _____ feet to _____ feet to _____

Type Rig _____

INITIAL PRODUCTION TEST

Describe initial test: whether by flow through tubing or casing or by pumping _____

Amount of Oil Production _____ bbls. Size of choke, if any _____ Length of test _____ Water _____

Production _____ bbls. Gravity of oil _____ Type of Pump if pump is used, describe _____

Formation	Top	Bottom	Formation	Top	Bottom
Shale	0	280			
Shale, Shells & sand	280	800			
Shale & Shells	800	1425			
Shale & Shells	1425	1640			
Sand	1640	1750			
Shale & Shells	1750	1825			
Red Bed & Shale & Shells	1825	1994			
Anhydrite	1994	2025			
Shale & Shells	2025	2310			
Lime & Shale	2310	3737			
Total Depth		3737			
Set 5 1/2"		3735			

15-137-00730-00-00
 9-16-59

PLUGGING
 FILE SEC. 31 T. 3 R. 23W
 BOOK PAGE 45 LINE 24

TOPS:

Elevation	2413 R.B.
Anhydrite	1994
Heebner	3445
Toronto	3471
Lansing	3484
Base of K. C.	3676
Arbuckle	3734
Total Depth	3737
Set 5 1/2"	3735

I, the undersigned, being first duly sworn upon oath, state that this well record is true, correct and complete according to the records of this office and to the best of my knowledge and belief.

Paul J. Farmer
 Name and title of representative of company
 Subscribed and sworn to before me this _____ day of _____, 19____

My Commission expires _____ Notary Public.



STATE OF KANSAS
STATE CORPORATION COMMISSION
CONSERVATION DIVISION
211 NORTH BROADWAY
WICHITA, KANSAS
September 16, 1957

15-137-00730-00-00

Well No.	2
Lease	Carr-Sneed
Description	C N/2 SW 31-3-23W
County	Horton
File No.	15-24

Jones, Shelburne & Farmer, Inc.
370 West Wichita
Russell, Kansas

Gentlemen:

This letter is your authority to plug the above subject well, in accordance with the Rules and Regulations of the State Corporation Commission. When you are ready to plug this well, please contact our District Plugging Supervisor, Mr. Eldon Petty, Box 326, Hays, Kansas

Very truly yours,

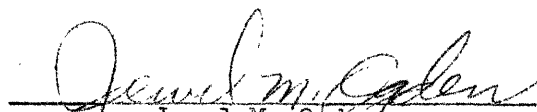

Jewel M. Ogden
Director of Conservation Division

cc:
District Plugging Supervisor