

FOR KCC USE:

EFFECTIVE DATE: 5-21-93

DISTRICT # 4

35A7... Yes  No

State of Kansas

NOTICE OF INTENTION TO DRILL

Must be approved by the K.C.C. five (5) days prior to commencing well

FORM C-1 7/91

FORM MUST BE TYPED

FORM MUST BE SIGNED

ALL BLANKS MUST BE FILLED

Expected Spud Date 5 24 93  
month day year

Spot  SW SW SE Sec. 5 Twp. 3S Rg. 26W East West

OPERATOR: License # 4767  
Name: Ritchie Exploration, Inc.  
Address: 125 N. Market, Suite 1000  
City/State/Zip: Wichita, KS 67202  
Contact Person: Jeff Christian  
Phone: (316) 267-4375

330 feet from South North line of Section  
 2310 feet from East West line of Section  
IS SECTION  REGULAR  IRREGULAR

(NOTE: Locate well on the Section Plat on Reverse Side)  
County: Decatur

Lease Name: Hix Farms Well #: I  
Field Name: unknown

Is this a Prorated/Spaced Field? ... yes  no

Target Formation(s): L/KC

Nearest lease or unit boundary: 2603 330' feet HSL

Water well within one-quarter mile: ... yes  no

Public water supply well within one mile: ... yes  no

Depth to bottom of fresh water: 155

Depth to bottom of usable water: 1350

Surface Pipe by Alternate: ... 1  2

Length of Surface Pipe Planned to be set: 240

Length of Conductor pipe required: None

Projected Total Depth: 3800

Formation at Total Depth: B/KC

Water Source for Drilling Operations:  
... well  farm pond  other

DWR Permit #: \_\_\_\_\_

Will Cores Be Taken?: ... yes  no

If yes, proposed zone: \_\_\_\_\_

CONTRACTOR: License #: 30606  
Name: Murfin Drilling Co.

Well Drilled For:	Well Class:	Type Equipment:
<input checked="" type="checkbox"/> Oil	... Enh Rec	... Infield
... Gas	... Storage	<input checked="" type="checkbox"/> Mud Rotary
... OUVVO	... Disposal	... Pool Ext.
... Seismic;	... # of Holes	... Wildcat
... Other	... Other	... Air Rotary
		... Cable

If OUVVO: old well information as follows:  
Operator: \_\_\_\_\_  
Well Name: \_\_\_\_\_  
Comp. Date: \_\_\_\_\_ Old Total Depth \_\_\_\_\_

Directional, Deviated or Horizontal wellbore? ... yes  no

If yes, true vertical depth: \_\_\_\_\_

Bottom Hole Location: \_\_\_\_\_

AFFIDAVIT

The undersigned hereby affirms that the drilling, completion and eventual plugging of this well will comply with K.S.A. 55-101, et. seq.

It is agreed that the following minimum requirements will be met:

1. Notify the appropriate district office prior to spudding of well;
2. A copy of the approved notice of intent to drill shall be posted on each drilling rig;
3. The minimum amount of surface pipe as specified below shall be set by circulating cement to the top; in all cases surface pipe shall be set through all unconsolidated materials plus a minimum of 20 feet into the underlying formation;
4. If the well is dry hole, an agreement between the operator and the district office on plug length and placement is necessary prior to plugging;
5. The appropriate district office will be notified before well is either plugged or production casing is cemented in;
6. IF AN ALTERNATE II COMPLETION, PRODUCTION PIPE SHALL BE CEMENTED FROM BELOW ANY USABLE WATER TO SURFACE WITHIN 120 DAYS OF SPUD DATE. IN ALL CASES, NOTIFY DISTRICT OFFICE PRIOR TO ANY CEMENTING.

I hereby certify that the statements made herein are true and to the best of my knowledge and belief.

Date: 5-17-93 Signature of Operator or Agent: Jeff Christian Title: Geologist

FOR KCC USE:  
 API # 15- 039-20889-00-00  
 Conductor pipe required None feet  
 Minimum surface pipe required 240 feet per Alt.  2  
 Approved by: CB 5-26-93  
 This authorization expires: 11-26-93  
 (This authorization void if drilling not started within 6 months of effective date.)  
 Spud date: \_\_\_\_\_ Agent: \_\_\_\_\_

REMEMBER TO:

- File Drill Pit Application (form CDP-1) with Intent to Drill;
- File Completion Form ACD-1 within 120 days of spud date;
- File acreage attribution plat according to field proration orders;
- Notify appropriate district office 48 hours prior to workover or re-entry;
- Submit plugging report (CP-4) after plugging is completed;
- Obtain written approval before disposing or injecting salt water.

Mail to: Conservation Division, 200 Colorado Derby Building, 202 W. First St., Wichita, Kansas 67202-1286.

RECEIVED  
 STATE CORPORATION COMMISSION  
5-26-93  
 MAY 26 1993  
 CONSERVATION DIVISION  
 Wichita, Kansas  
 16

IN ALL CASES PLOT THE INTENDED WELL ON THE PLAT BELOW

PLAT OF ACREAGE ATTRIBUTABLE TO A WELL IN A PRORATED OR SPACED FIELD

If the intended well is in a prorated or spaced field, please fully complete this side of the form. If the intended well is in a prorated or spaced field complete the plat below showing that the well will be properly located in relationship to other wells producing from the common source of supply. Please show all the wells within 1 mile of the boundaries of the proposed acreage attribution unit for gas wells and within 1/2 mile of the boundaries of the proposed acreage attribution unit for oil wells.

API NO. 15- \_\_\_\_\_  
 OPERATOR \_\_\_\_\_  
 LEASE \_\_\_\_\_  
 WELL NUMBER \_\_\_\_\_  
 FIELD \_\_\_\_\_

LOCATION OF WELL: COUNTY \_\_\_\_\_  
 \_\_\_\_\_ feet from south/north line of section  
 \_\_\_\_\_ feet from east/west line of section  
 SECTION \_\_\_\_\_ TWP \_\_\_\_\_ RG \_\_\_\_\_

NUMBER OF ACRES ATTRIBUTABLE TO WELL \_\_\_\_\_  
 QTR/QTR/QTR OF ACREAGE \_\_\_\_\_

IS SECTION \_\_\_\_\_ REGULAR or \_\_\_\_\_ IRREGULAR  
IF SECTION IS IRREGULAR, LOCATE WELL FROM NEAREST CORNER BOUNDARY.

Section corner used: \_\_\_\_\_ NE \_\_\_\_\_ NW \_\_\_\_\_ SE \_\_\_\_\_ SW

**PLAT**

(Show location of the well and shade attributable acreage for prorated or spaced wells.)  
 (Show footage to the nearest lease or unit boundary line.)

R26W

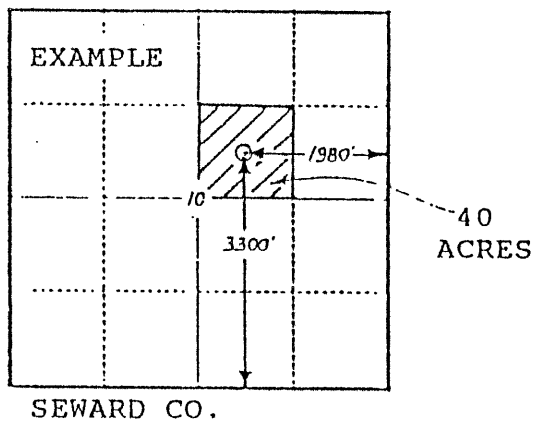
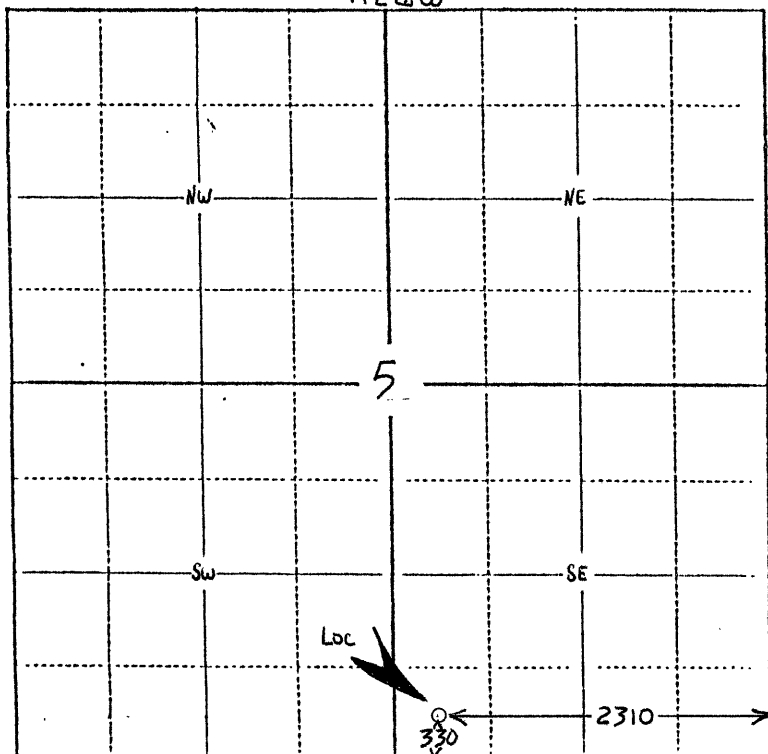

In plotting the proposed location of the well, you must show:

- 1) The manner in which you are using the depicted plat by identifying section lines, i.e. 1 section, 1 section with 8 surrounding sections, 4 sections, etc.;
- 2) the distance of the proposed drilling location from the section's south/north and east/west lines; and
- 3) the distance to the nearest lease or unit boundary line.