

For KCC Use: 8.14.04  
 Effective Date: \_\_\_\_\_  
 District # 1  
 SGA?  Yes  No

KANSAS CORPORATION COMMISSION  
 OIL & GAS CONSERVATION DIVISION

Form C-1  
 December 2002  
**Form must be Typed**  
**Form must be Signed**  
**All blanks must be Filled**

**NOTICE OF INTENT TO DRILL**

Must be approved by KCC five (5) days prior to commencing well

\*Revised location 25/1 KCC  
 C Per of 8.9.04

Expected Spud Date August 10, 2004  
 month day year

Spot 100' E. of  
 SW NE SE Sec. 17 Twp. 30 S. R. 13  
 East  
 West

OPERATOR: License# 5056  
 Name: F.G. Holl Company, L.L.C.  
 Address: 9431 E. Central, Suite #100  
 City/State/Zip: Wichita, Kansas 67206-2543  
 Contact Person: Franklin R. Greenbaum  
 Phone: (316) 684-8481

1650 feet from  N /  S Line of Section  
890 feet from  E /  W Line of Section

Is SECTION  Regular  Irregular?

(Note: Locate well on the Section Plat on reverse side)

CONTRACTOR: License# 5929  
 Name: Duke Drilling Company, Inc., Rig #1

County: Barber  
 Lease Name: LEMON TRUST "A" Well #: 1-17  
 Field Name: Sawyer South Extension

Is this a Prorated / Spaced Field?  Yes  No

Target Information(s): LKC, Marmaton, Mississippian & Viola

Nearest Lease or unit boundary: 990' 890'

Ground Surface Elevation: 1836 feet MSL

Water well within one-quarter mile:  Yes  No

Public water supply well within one mile:  Yes  No

Depth to bottom of fresh water: 400 150

Depth to bottom of usable water: 180'

Surface Pipe by Alternate:  1  2

Length of Surface Pipe Planned to be set: 950'

Length of Conductor Pipe required: None

Projected Total Depth: 4800'

Formation at Total Depth: Arbuckle

Water Source for Drilling Operations:

Well  Farm Pond  Other \_\_\_\_\_

DWR Permit #: (Contractor will apply)

(Note: Apply for Permit with DWR )

Will Cores be taken?  Yes  No

If Yes, proposed zone: \_\_\_\_\_

<b>Well/Drilled For:</b>	<b>Well Class:</b>	<b>Type Equipment:</b>
<input checked="" type="checkbox"/> Oil	<input type="checkbox"/> Enh Rec	<input checked="" type="checkbox"/> Mud Rotary
<input checked="" type="checkbox"/> Gas	<input type="checkbox"/> Storage	<input type="checkbox"/> Air Rotary
<input type="checkbox"/> OWWO	<input type="checkbox"/> Disposal	<input type="checkbox"/> Cable
<input type="checkbox"/> Seismic; # of Holes _____	<input type="checkbox"/> Wildcat	
<input type="checkbox"/> Other _____	<input type="checkbox"/> Other _____	

If OWWO: old well information as follows:

Operator: \_\_\_\_\_

Well Name: \_\_\_\_\_

Original Completion Date: \_\_\_\_\_ Original Total Depth: \_\_\_\_\_

Directional, Deviated or Horizontal wellbore?  Yes  No

If Yes, true vertical depth: \_\_\_\_\_

Bottom Hole Location: \_\_\_\_\_

KCC DKT #: \_\_\_\_\_

RECEIVED  
 KANSAS CORPORATION COMMISSION  
 AUG 06 2004

**AFFIDAVIT**

The undersigned hereby affirms that the drilling, completion and eventual plugging of this well will comply with K.S.A. 55 et. seq.

It is agreed that the following minimum requirements will be met:

1. Notify the appropriate district office **prior** to spudding of well;
2. A copy of the approved notice of intent to drill **shall be** posted on each drilling rig;
3. The minimum amount of surface pipe as specified below **shall be set** by circulating cement to the top; in all cases surface pipe **shall be set** through all unconsolidated materials plus a minimum of 20 feet into the underlying formation.
4. If the well is dry hole, an agreement between the operator and the district office on plug length and placement is necessary **prior to plugging**;
5. The appropriate district office will be notified before well is either plugged or production casing is cemented in;
6. If an ALTERNATE II COMPLETION, production pipe shall be cemented from below any usable water to surface within **120 days** of spud date. Or pursuant to Appendix "B" - Eastern Kansas surface casing order #133,891-C, which applies to the KCC District 3 area, alternate II cementing must be completed within 30 days of the spud date or the well shall be plugged. **In all cases, NOTIFY district office** prior to any cementing.

I hereby certify that the statements made herein are true and to the best of my knowledge and belief.

Date: 08/06/2004 Signature of Operator or Agent: Margery Nage Title: Managing Member

**For KCC Use ONLY**  
 API # 15 - 007-22847-00-00  
 Conductor pipe required NONE feet  
 Minimum surface pipe required 200 feet per Alt. 1  
 Approved by: RJP 8.9.04  
 This authorization expires: 2.9.05  
 (This authorization void if drilling not started within 6 months of effective date.)  
 Spud date: \_\_\_\_\_ Agent: \_\_\_\_\_

**Remember to:**

- File Drill Pit Application (form CDP-1) with Intent to Drill;
- File Completion Form ACO-1 within 120 days of spud date;
- File acreage attribution plat according to field proration orders;
- Notify appropriate district office 48 hours prior to workover or re-entry;
- Submit plugging report (CP-4) after plugging is completed;
- Obtain written approval before disposing or injecting salt water.
- If this permit has expired (See: authorized expiration date) please check the box below and return to the address below.

**Well Not Drilled - Permit Expired**

Signature of Operator or Agent: \_\_\_\_\_

Date: \_\_\_\_\_

Mail to: KCC - Conservation Division, 130 S. Market - Room 2078, Wichita, Kansas 67202

17  
30  
13W

**IN ALL CASES PLOT THE INTENDED WELL ON THE PLAT BELOW**

*Plat of acreage attributable to a well in a prorated or spaced field*

**If the intended well is in a prorated or spaced field, please fully complete this side of the form.** If the intended well is in a prorated or spaced field complete the plat below showing that the well will be properly located in relationship to other wells producing from the common source of supply. Please show all the wells and within 1 mile of the boundaries of the proposed acreage attribution unit for gas wells and within 1/2 mile of the boundaries of the proposed acreage attribution unit for oil wells.

API No. 15 - \_\_\_\_\_  
 Operator: F.G. Holl Company, L.L.C.  
 Lease: LEMON TRUST "A"  
 Well Number: 1-17  
 Field: Sawyer South Extension  
 Number of Acres attributable to well: \_\_\_\_\_  
 QTR / QTR / QTR of acreage: SW - NE - SE

Location of Well: County: Barber  
 \_\_\_\_\_ 1650 feet from  N /  S Line of Section  
 \_\_\_\_\_ 890 feet from  E /  W Line of Section  
 Sec. 17 Twp. 30 S. R. 13  East  West

Is Section:  Regular or  Irregular

**If Section is Irregular, locate well from nearest corner boundary.**

Section corner used:  NE  NW  SE  SW

**PLAT**

*(Show location of the well and shade attributable acreage for prorated or spaced wells.)  
 (Show footage to the nearest lease or unit boundary line.)*

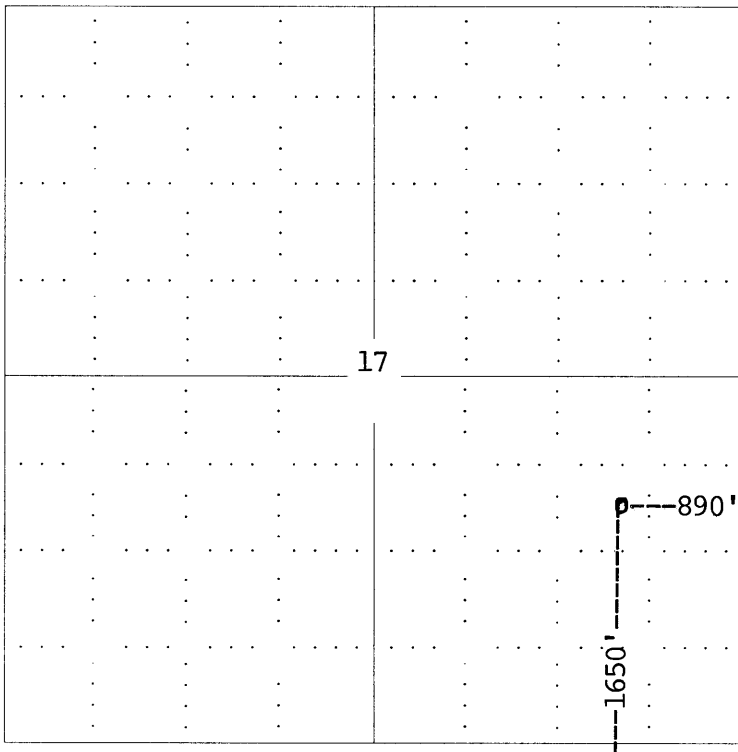

RECEIVED  
 KANSAS CORPORATION COMMISSION  
**AUG 06 2004**  
 CONSERVATION DIVISION  
 WICHITA, KS

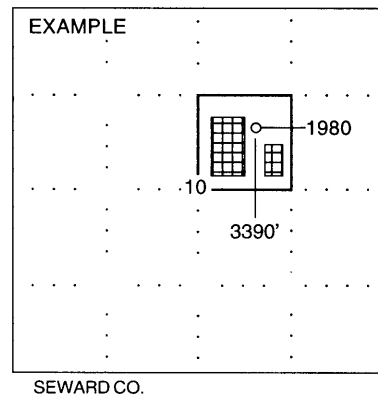

**NOTE: In all cases locate the spot of the proposed drilling location.**

**In plotting the proposed location of the well, you must show:**

1. The manner in which you are using the depicted plat by identifying section lines, i.e. 1 section, 1 section with 8 surrounding sections, 4 sections, etc.
2. The distance of the proposed drilling location from the section's south / north and east / west.
3. The distance to the nearest lease or unit boundary line.
4. If proposed location is located within a prorated or spaced field a certificate of acreage attribution plat must be attached: (CO-7 for oil wells; CG-8 for gas wells).

# KANSAS

CORPORATION COMMISSION

KATHLEEN SEBELIUS, GOVERNOR  
BRIAN J. MOLINE, CHAIR  
ROBERT E. KREHBIEL, COMMISSIONER  
MICHAEL C. MOFFET, COMMISSIONER

August 6, 2004

Franklin R Greenbaum  
F.G. Holl Company, LLC  
9431 E Central, Ste 100  
Wichita KS 67206-2543

Re: Drilling Pit Application  
Lemon Trust A Lease Well No. 1-17  
SE/4 17-30S-13W  
Barber County, Kansas

Dear Mr. Greenbaum:

District staff has inspected the above referenced location and has determined that the reserve pit shall be constructed **without slots**, the bottom shall be flat and reasonably level and the free fluids must be removed. The fluids are to be removed from the reserve pit as soon as the Hutchinson Salt section has been drilled through and displacement of the fluids into the reserve pit has occurred. The fluids should be removed again as soon as practical after drilling operations have ceased.

**If production casing is set all completion fluids shall be removed on a daily basis.**

The fluids should be taken to an authorized disposal well. Please call the District Office at (620) 225-8888 when the fluids have been removed. Also, please file the enclosed Surface Pond Waste Transfer, form CDP-5, within 30 days of fluid removal.

**A copy of this letter should be posted in the doghouse along with the approved Intent to Drill.** If you have any questions or concerns please feel free to contact the undersigned at the above address.

Sincerely,



Jonelle Rains, Supervisor  
Department of Environmental Protection and Remediation

cc: Steve Durrant  
File