

FIRST CORRECTED

OIL & GAS CONSERVATION DIVISION

Effective Date: 4-5-04
District #: 2
S G A ? Yes No

Form must be Typed
Form must be Signed
All blanks must be Filled

NOTICE OF INTENT TO DRILL MAR 31 2004

Must be approved by KCC five (5) days prior to commencing well

CORRECTED LOCATION

KCC WICHITA

Expected Spud Date April 20 2004

Spot 125' N and 120' W of E2 - E2 - SW Sec 5 Twp. 28 S. R. 6

OPERATOR: License# 5399
Name: American Energies Corporation
Address: 155 N. Market, Suite 710
City/State/Zip: Wichita, KS 67202
Contact Person: Alan L. DeGood, President
Phone: (316) 316-263-5785

1445' feet from S (circle one) Line of Section
2190' feet from E (circle one) Line of Section
Is SECTION XX Regular Irregular?

CONTRACTOR: License# 5123
Name: Pickrell Drilling Company, Inc.

(Note: Locate well on the Section Plat on reverse side)
County: Kingman
Lease Name: Kaufman Well #: 3
Field Name: Georgia Spur

Well Drilled For: Oil, Gas, OWWO, Seismic, Other
Well Class: Infield, Pool Ext., Wildcat, Other
Type Equipment: Mud Rotary, Air Rotary, Cable

Is this a Prorated / Spaced Field? Yes No
Target Information(s): Mississippi
Nearest Lease or unit boundary: 330'
Ground Surface Elevation: 1540' ESTIMATED feet MSL
Water well within One-quarter mile: Yes No
Public water supply well within one mile: Yes No
Depth to bottom of fresh water: 70' 150'
Depth to bottom of usable water: 70' 120'

If OWWO: old well information as follows:
Operator:
Well Name:
Original Completion Date: Original Total Depth:

Surface Pipe by Alternate: XX
Length of Surface Pipe Planned to be set: 250'
Length of Conductor Pipe required: None
Projected Total Depth: 4000'
Producing Formation Target: Mississippi
Water Source for Drilling Operations: Well Farm Pond Other XX
DWR Permit #:
(Note: Apply for Permit with DWR)

Directional, Deviated or Horizontal wellbore? Yes No
If Yes, true vertical depth:
Bottom Hole Location:
KCC DKT #:

Will Cores be taken? Yes No
If Yes, proposed zone:

* WAS: 1320' FSL, 2310' FWL E1/2E/2 SW
IS: 1445' FSL, 2190' FWL AP 1/25' N & 120' W AFFIDAVIT
of E1/2E/2 SW

The undersigned hereby affirms that the drilling, completion and eventual plugging of this well will comply with K.S.A. 55-101, et. seq.
It is agreed that the following minimum requirements will be met:

- 1. Notify the appropriate district office prior to spudding of well;
2. A copy of the approved notice of intent to drill shall be posted on each drilling rig;
3. The minimum amount of surface pipe as specified below shall be set by circulating cement to the top; in all cases surface pipe shall be set through all unconsolidated materials plus a minimum of 20 feet into the underlying formation.
4. If the well is dry hole, an agreement between the operator and the district office on plug length and placement is necessary prior to plugging;
5. The appropriate district office will be notified before well is either plugged or production casing is cemented in;
6. If an ALTERNATE 11 COMPLETION, production pipe shall be cemented from below any usable water to surface within 120 days of spud date. In all cases, NOTIFY district office prior to any cementing.

I hereby certify that the statements made herein are true and to the best of my knowledge and belief.

Date: 03/18/04 Signature of Operator or Agent: Alan L. DeGood Title: President

For KCC Use ONLY
API # 15 - 095-21873-00-00
Conductor pipe required NONE feet
Minimum surface pipe required 200 feet per Alt 1
Approved by: RJP 3-31-04 / RJP 9-3-04
This authorization expires: 10-1-04
(This authorization void if drilling not started within 6 months of effective date.)
Spud date: Agent:

- Remember to -
File Drill Pit Application (form CDP-1) with Intent to Drill;
File Completion Form ACO-1 within 120 days of spud date;
File acreage attribution plat according to field proration orders;
Notify appropriate district office 48 hours prior to workover or re-entry;
Submit plugging report (CP-4) after plugging is completed;
Obtain written approval before disposing or injecting salt water.

Mail to: KCC - Conservation Division, 130 S. Market - Room 2078, Wichita, Kansas 67202
RECEIVED
MAY 18 2004

Plat of acreage attributable to a well in a prorated or spaced field

If the intended well is in a prorated or spaced field, please fully complete this side of the form. If the intended well is in a prorated or spaced field complete the plat below showing that the well will be properly located in relationship to other wells producing from the common source of supply. Please show all the wells and within 1 mile of the boundaries of the proposed acreage attribution unit for gas wells and within 1/2 mile of the boundaries of the proposed acreage attribution unit for oil wells.

API No. 15 - 095-21873-00-00
 Operator: American Energies Corporation
 Lease: Kaufman
 Well Number: 3
 Field: Georgia Spur
 Number of Acres attributable to well: _____
 QTR / QTR / QTR of acreage: 125' N and 120' W E2 - E2 - SW

Location of Well: County: Kingman
 1445' _____ feet from (S) / (N) (circle one) Line of Section
 2190' _____ feet from (E) / (W) (circle one) Line of Section
 Sec 5 Twp 28 S. R. 6 East West
 Is Section XX Regular or _____ Irregular
 If Section is Irregular, locate well from nearest corner boundary.
 Section corner used: ___ NE ___ NW - SE ___ SW

PLAT

*(Show location of the well and shade attributable acreage for prorated or spaced wells)
 (Show footage to the nearest lease or unit boundary.)*

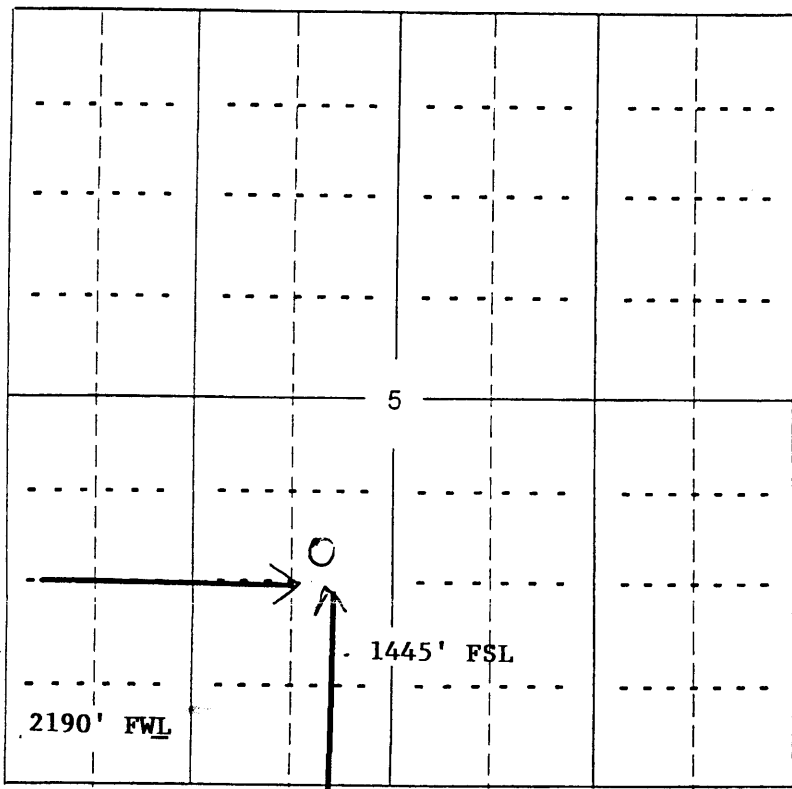

**RECEIVED
 MAY 18 2004
 KCC WICHITA**

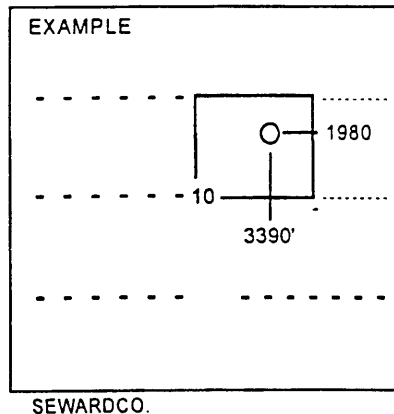

NOTE., In all cases locate the spot of the proposed drilling location.

In plotting the proposed location of the well, you must show.

1. The manner in which you are using the depicted plat by identifying section lines, i.e. 1 section, 1 section with 8 surrounding sections, 4 sections, etc.
2. The distance of the proposed drilling location from the section's south / north and east / west. The distance to the nearest lease or unit boundary line.
3. If proposed location is located within a prorated or spaced field a certificate of acreage attribution plat must be attached: (CO-7 for oil wells; CG-8 for gas wells).