

For KCC Use: 8-29-04  
Effective Date: 2  
District # \_\_\_\_\_  
SGA?  Yes  No

KANSAS CORPORATION COMMISSION  
OIL & GAS CONSERVATION DIVISION

**FIRST  
CORRECTED**

Form C-1  
December 2002  
Form must be Typed  
Form must be Signed  
All blanks must be Filled

**NOTICE OF INTENT TO DRILL**

Must be approved by KCC five (5) days prior to commencing well

**AMENDED TO CHANGE LOCATION**

Expected Spud Date September, 11, 2004  
month day year

Spot  East  
S2 - SW - NW Sec. 12 Twp. 28 S. R. 05  West  
\_\_\_\_\_ feet from  N /  S Line of Section  
2970  
\_\_\_\_\_ feet from  E /  W Line of Section  
660

OPERATOR: License# 5214  
Name: Lario Oil & Gas Co.  
Address: 301 South Market  
City/State/Zip: Wichita, KS 67202  
Contact Person: Jay G. Schweikert  
Phone: 316-265-5611

(Note: Locate well on the Section Plat on reverse side)  
County: Kingman  
Lease Name: Casley A Well #: 1-12  
Field Name: Vinita

CONTRACTOR: License# 5929  
Name: Duke Drilling Co., Inc

Is this a Prorated / Spaced Field?  Yes  No

Well Drilled For:  Oil  Enh Rec  Gas  Storage  OWWO  Seismic; # of Holes  Other  
Well Class:  Infield  Pool Ext.  Wildcat  Other  
Type Equipment:  Mud Rotary  Air Rotary  Cable

Target Formation(s): Mississippian

Nearest Lease or unit boundary: 330 ft

Ground Surface Elevation: 1395 feet MSL

Water well within one-quarter mile:  Yes  No

Public water supply well within one mile:  Yes  No

Depth to bottom of fresh water: 150 - 151 ft.

Depth to bottom of usable water: 180 ft.

Surface Pipe by Alternate:  1  2

Length of Surface Pipe Planned to be set: 280 ft.

Length of Conductor Pipe required: None

Projected Total Depth: 4100 ft.

Formation at Total Depth: Mississippian

Water Source for Drilling Operations:

Well  Farm Pond Other \_\_\_\_\_

DWR Permit #: \_\_\_\_\_

(Note: Apply for Permit with DWR )

Will Cores be taken?  Yes  No

If Yes, proposed zone: \_\_\_\_\_

If OWWO: old well information as follows:  
Operator: \_\_\_\_\_  
Well Name: \_\_\_\_\_  
Original Completion Date: \_\_\_\_\_ Original Total Depth: \_\_\_\_\_

Directional, Deviated or Horizontal wellbore?  Yes  No

If Yes, true vertical depth: \_\_\_\_\_

Bottom Hole Location: \_\_\_\_\_

KCC DKT #: \_\_\_\_\_

\* WAS: 1980' FNL, 990' FWL, E/2 SWNW  
FS: 2970' FSL, 660' FWL, S/2 SWNW

**AFFIDAVIT**

The undersigned hereby affirms that the drilling, completion and eventual plugging of this well will comply with K.S.A. 55 et. seq.

It is agreed that the following minimum requirements will be met:

1. Notify the appropriate district office **prior** to spudding of well;
2. A copy of the approved notice of intent to drill **shall be** posted on each drilling rig;
3. The minimum amount of surface pipe as specified below **shall be set** by circulating cement to the top; in all cases surface pipe **shall be set** through all unconsolidated materials plus a minimum of 20 feet into the underlying formation.
4. If the well is dry hole, an agreement between the operator and the district office on plug length and placement is necessary **prior to plugging**;
5. The appropriate district office will be notified before well is either plugged or production casing is cemented in;
6. If an ALTERNATE II COMPLETION, production pipe shall be cemented from below any usable water to surface within **120 days** of spud date.  
Or pursuant to Appendix "B" - Eastern Kansas surface casing order #133,891-C, which applies to the KCC District 3 area, alternate II cementing must be completed within 30 days of the spud date or the well shall be plugged. **In all cases, NOTIFY district office** prior to any cementing.

I hereby certify that the statements made herein are true and to the best of my knowledge and belief.

Date: 9/03/04 Signature of Operator or Agent: Jay G. Schweikert Title: Operations Engineer

**Remember to:**

- File Drill Pit Application (form CDP-1) with Intent to Drill;
- File Completion Form ACO-1 within 120 days of spud date;
- File acreage attribution plat according to field proration orders;
- Notify appropriate district office 48 hours prior to workover or re-entry;
- Submit plugging report (CP-4) after plugging is completed;
- Obtain written approval before disposing or injecting salt water.
- If this permit has expired (See: authorized expiration date) please check the box below and return to the address below.

Well Not Drilled - Permit Expired

Signature of Operator or Agent: \_\_\_\_\_

Date: \_\_\_\_\_

**For KCC Use ONLY**

API # 15 - 095-21904-00-00

Conductor pipe required NONE feet

Minimum surface pipe required 200 feet per Alt. ①

Approved by: RJPB-24-04 / RJP9-7-04

This authorization expires: 2-24-05

(This authorization void if drilling not started within 6 months of effective date.)

Spud date: \_\_\_\_\_ Agent: \_\_\_\_\_

Mail to: KCC - Conservation Division, 130 S. Market - Room 2078, Wichita, Kansas 67202

RECEIVED

SEP 07 2004

KCC WICHITA

12  
28  
50

**IN ALL CASES PLOT THE INTENDED WELL ON THE PLAT BELOW**

*Plat of acreage attributable to a well in a prorated or spaced field*

If the intended well is in a prorated or spaced field, please fully complete this side of the form. If the intended well is in a prorated or spaced field complete the plat below showing that the well will be properly located in relationship to other wells producing from the common source of supply. Please show all the wells and within 1 mile of the boundaries of the proposed acreage attribution unit for gas wells and within 1/2 mile of the boundaries of the proposed acreage attribution unit for oil wells.

API No. 15 - 095-21904-00-00  
 Operator: Lario Oil & Gas Co.  
 Lease: Casley A  
 Well Number: 1-12  
 Field: Vinita  
 Number of Acres attributable to well: 80  
 QTR / QTR / QTR of acreage: S2 - SW - NW

Location of Well: County: Kingman  
2970 feet from  N /  S Line of Section  
660 feet from  E /  W Line of Section  
 Sec. 12 Twp. 28 S. R. 05  East  West

Is Section:  Regular or  Irregular

If Section is Irregular, locate well from nearest corner boundary.

Section corner used:  NE  NW  SE  SW

**CORRECTED**

**PLAT**

(Show location of the well and shade attributable acreage for prorated or spaced wells.)  
 (Show footage to the nearest lease or unit boundary line.)

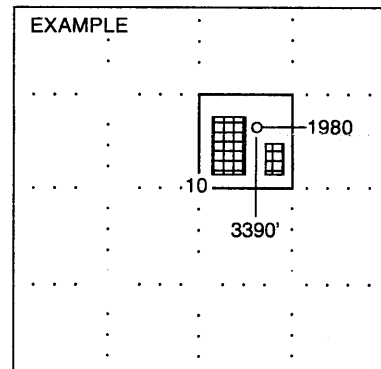
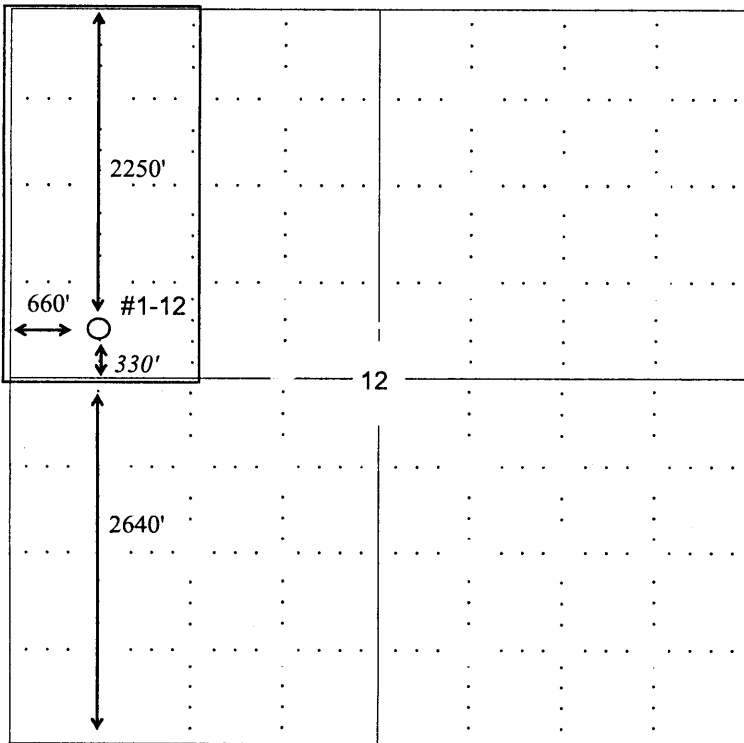

SEWARD CO.

**NOTE: In all cases locate the spot of the proposed drilling locaton.**

**In plotting the proposed location of the well, you must show:**

1. The manner in which you are using the depicted plat by identifying section lines, i.e. 1 section, 1 section with 8 surrounding sections, 4 sections, etc.
2. The distance of the proposed drilling location from the section's south / north and east / west.
3. The distance to the nearest lease or unit boundary line.
4. If proposed location is located within a prorated or spaced field a certificate of acreage attribution plat must be attached: (CO-7 for oil wells; CG-8 for gas wells).