

15-137-00519-00-00

(Drilled Prior to Inception of

STATE OF KANSAS
STATE CORPORATION COMMISSION
200 Colorado Derby Building
Wichita, Kansas 67202

WELL PLUGGING RECORD
K.A.R.-82-3-117

API NUMBER API#) 11-25-54

LEASE NAME Schoen "A"

WELL NUMBER #7

SPOT LOCATION C W/2 NE

SEC. 35 TWP. 3S RGE. 24 ~~XXXX~~ (W)

COUNTY Norton

Date Well Completed 11-25-54

Plugging Commenced 12-2-84 12:30 P.M.

Plugging Completed 12-2-84 2:30 P.M.

TYPE OR PRINT
NOTICE: Fill out completely
and return to Cons. Div.
office within 30 days.

LEASE OPERATOR John O. Farmer, Inc.

ADDRESS P.O. Box 352, Russell, KS 67665

PHONE # (913) 483-3144 OPERATORS LICENSE NO. 5135

Character of Well Oil
(Oil, Gas, D&A, SWD, Input, Water Supply Well)

Did you notify the KCC/KDHE Joint District Office prior to plugging this well? Yes

Which KCC/KDHE Joint Office did you notify? District #6

Is ACO-1 filed? No If not, is well log attached? Yes

Producing formation Reagan Sand Depth to top 3780' bottom 3785' T.D. 3785'

Show depth and thickness of all water, oil and gas formations.

OIL, GAS OR WATER RECORDS | CASING RECORD

Formation	Content	From	To	Size	Put in	Pulled out
Reagan Sand	oil & water	3780'	85'	8-5/8"	299'	-0-
				5-1/2"	3782'	-0-

Describe in detail the manner in which the well was plugged, indicating where the mud fluid was placed and the method or methods used in introducing it into the hole. If cement or other plugs were used state, the character of same and depth placed, from feet to feet each set. Plugged down 5-1/2" casing with 275 sks. cement w/4 sks. hulls; plugged down 8-5/8" casing with 100 sks. cement w/2 sks. hulls

(If additional description is necessary, use BACK of this form.)

Name of Plugging Contractor John O. Farmer, Inc. License No. 5135
Address P.O. Box 352, Russell, KS 67665

RECEIVED
STATE CORPORATION COMMISSION

STATE OF Kansas COUNTY OF Russell, ss.

DEC 14 1984
12-14-84

John O. Farmer III (operator) of above-described well, being first duly sworn on oath, says: I have knowledge of the facts, statements, and matters herein contained and the log of the above-described well as filed that the same are true and correct. So help me God.

(Signature) John O. Farmer III

(Address) P.O. Box 352, Russell, KS 67665



SUBSCRIBED AND SWORN TO before me this 13th day of December, 1984

Margaret A. Schulte
Notary Public
Margaret A. Schulte

My Commission expires: January 27, 1985

OPERATOR Jones, Shelburne & Farmer, Inc.

FORMATION RECORD

ADDRESS Russell, Kansas

Give detailed description and thickness of all formations drilled through, contents of sand, whether dry, water, oil or gas.

FARM NAME Schoen A WELL NO. 7 COUNTY Norton SEC. 35, TWP. 3, RGE. 24

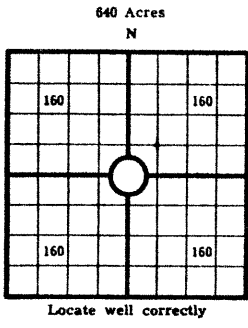

COUNTY Norton SEC. 35 TWP. 3 RGE. 24
 COMPANY OPERATING Jones, Shelburne & Farmer, Inc.
 OFFICE ADDRESS Russell, Kansas
 FARM NAME Schoen A WELL NO. 7
 DRILLING STARTED 11-17 54 DRILLING FINISHED 11-25 54
 DATE OF FIRST PRODUCTION _____ COMPLETED _____
 WELL LOCATED 0 W 1/2 NW 1/4 _____ North of South
 Line and _____ ft. East of West Line of Quarter Section
 Elevation (Relative to sea level) DERRICK FLOOR 2462 GROUND _____
 CHARACTER OF WELL (Oil, gas or dryhole) oil

Formation	Top	Bottom	Formation	Top	Bottom
Shale & sand	0	295			
Shale & shells	295	865			
Shale & sand	865	1670			
Sand	1670	1790			
Shale & redbnd	1790	1890			
Shale & shells	1890	2035			
Anhydrite	2035	2065			
Shale & shells	2065	2425			
Shale & lime	2425	2570			
Lime & shale	2570	3645			
Shale & lime	3645	3720			
Lime & shale	3720	3785			

RECEIVED
 STATE CORPORATION COMMISSION
 DEC 14 1954
 CONSERVATION DIVISION
 Wichita, Kansas

TOPS:
 Elev 2464
 Heebner 3481
 Toronto 3505
 Lansing 3519
 Sand 3780
 T.D. 3785

15-137-00519-00-00

OIL OR GAS SANDS OR ZONES

Name	From	To	Name	From	To
1			4		
2			5		
3			6		

Perforating Record if Any

Shot Record

Formation	From	To	No. of Shots	Formation	From	To	Size of Shot

CASING RECORD

Amount Set								Amount Pulled		Packer Record	
Size	Wt.	Thds.	Make	Ft.	In.	Ft.	In.	Size	Length	Depth Set	Make
8 5/8				296							
5 1/2				3782							

Liner Record: Amount _____ Kind _____ Top _____ Bottom _____

CEMENTING AND MUDDING

Size	Amount Set		Sacks Cement	Chemical		Method of Cementing	Amount	Mudding Method	Results (See Note)
	Ft.	In.		Gal.	Make				
8 5/8	296		125						
5 1/2	3782		75						

Note: What method was used to protect sands if outer strings were pulled? _____

NOTE: Were bottom hole plugs used? _____ If so, state kind, depth set and results obtained _____

TOOLS USED

Rotary Tools were used from _____ feet to _____ feet. Cable tools were used from _____ feet to _____ feet, and from _____ feet to _____ feet, and from _____ feet to _____ feet.

Type Rig _____

INITIAL PRODUCTION TEST

Describe initial test: whether by flow through tubing or casing or by pumping _____

Amount of Oil Production _____ bbls. Size of choke, if any _____ Length of test _____ Water Production _____ bbls. Gravity of oil _____ Type of Pump or pump is used, describe _____

I, the undersigned, being first duly sworn upon oath, state that this well record is true, correct and complete according to the records of this office and to the best of my knowledge and belief.

Name and title of representative of company

Subscribed and sworn to before me this 6th day of December 19 54
 My Commission expires July 14, 1958 Bonnie Pratt
 Notary Public.

ADDRESS Russell, Kansas

Give detailed description and thickness of all formations drilled through, contents of sand, whether dry, water, oil or gas.

WELL NO. COUNTY SEC. TWP. RGE. FARM NAME

640 Acres
N

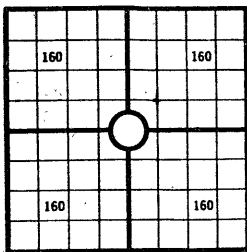

Locate well correctly

COUNTY Johnson SEC 35 TWP 9 RGE 24
 COMPANY OPERATING John J. Halbur & Partner, Inc.
 OFFICE ADDRESS Russell, Kansas
 FARM NAME W-117 WELL NO. 7
 DRILLING STARTED 19 DRILLING FINISHED 19
 DATE OF FIRST PRODUCTION _____ COMPLETED _____
 WELL LOCATED 1/4 1/4 1/4 North of South
 Line and _____ ft. East of West Line of Quarter Section
 Elevation (Relative to sea level) DERRICK FLOOR _____ GROUND _____
 CHARACTER OF WELL (Oil, gas or dryhole) _____

OIL OR GAS SANDS OR ZONES

Name	From	To	Name	From	To
1			4		
2			5		
3			6		

Perforating Record If Any

Shot Record

Formation	From	To	No. of Shots	Formation	From	To	Size of Shot

CASING RECORD

Amount Set								Amount Pulled		Packer Record	
Size	Wt.	Thds.	Make	Ft.	In.	Ft.	In.	Size	Length	Depth Set	Make
8 5/8											
5 1/2											

Liner Record: Amount _____ Kind _____ Top _____ Bottom _____

CEMENTING AND MUDDING

Size	Amount Set		Sacks Cement	Chemical		Method of Cementing	Amount	Mudding Method	Results (See Note)
	Ft.	In.		Gal.	Make				
8 5/8									
5 1/2									

Note: What method was used to protect sands if outer strings were pulled? _____

NOTE: Were bottom hole plugs used? _____ If so, state kind, depth set and results obtained _____

TOOLS USED

Rotary Tools were used from _____ feet to _____ feet to _____ feet, and from _____ feet to _____ feet, and from _____ feet to _____ feet.

Type Rig _____

INITIAL PRODUCTION TEST

Describe initial test: whether by flow through tubing or casing or by pumping _____

Amount of Oil Production _____ bbls. Size of choke, if any _____ Length of test _____ Water

Production _____ bbls. Gravity of oil _____ Type of Pump if pump is used, describe _____

Formation	Top	Bottom	Formation	Top	Bottom
Shale & sand	0	205			
Shale & shells	205	208			
Shale & sand	208	209			
Sand	1070	1070			
Shale & redbed	1740	1740			
Shale & shells	1800	1800			
Shale	1800	1800			
Shale & shells	1800	1800			
Shale & lime	1800	1800			
Shale & shale	1800	1800			
Shale & lime	1800	1800			
Shale & shale	1800	1800			

Flow 2400
 Meter 3131
 Torque 5505
 Logging 5515
 Sand 3700
 2.00 5705

15-137-00519-00-00

RECEIVED
 STATE CORPORATION COMMISSION

OCT 30 1984

CONSERVATION DIVISION
 Wichita, Kansas

I, the undersigned, being first duly sworn upon oath, state that this well record is true, correct and complete according to the records of this office and to the best of my knowledge and belief.

John J. Halbur
 Name and title of representative of company

Subscribed and sworn to before me this _____ day of _____ 19____
 My Commission expires _____
Bonnie Pratt
 Notary Public