

15-137-00299-00-00

STATE OF KANSAS
STATE CORPORATION COMMISSION
200 Colorado Derby Building
Wichita, Kansas 67202

WELL PLUGGING RECORD
K.A.R.-82-3-117

Drilling Completed
May, 1953

API NUMBER _____

LEASE NAME Lawson "A"

WELL NUMBER #1

2970 Ft. from S Section Line

2970 Ft. from E Section Line

SEC. 36 TWP. 3S RGE. 24 ~~XXXX~~ (W)

COUNTY Norton

Date Well Completed 5-7-53

Plugging Commenced 2:50 P.M.
5-12-88

Plugging Completed 4:00 P.M.
5-12-88

TYPE OR PRINT
NOTICE: Fill out completely
and return to Cons. Div.
office within 30 days.

LEASE OPERATOR John O. Farmer, Inc.

ADDRESS P.O. Box 352, Russell, KS 67665

PHONE#(913) 483-3144 OPERATORS LICENSE NO. 5135

Character of Well Oil

(Oil, Gas, D&A, SWD, Input, Water Supply Well)

The plugging proposal was approved on May 7, 1988 (date)

by Dennis Hamel (KCC District Agent's Name).

Is ACO-1 filed? No If not, is well log attached? Yes

Producing Formation Arbuckle Depth to Top 3778' Bottom 3790' T.D. 3790'

Show depth and thickness of all water, oil and gas formations.

OIL, GAS OR WATER RECORDS

CASING RECORD

Formation	Content	From	To	Size	Put In	Pulled out
Arbuckle	Oil	3778'	90'	8-5/8"	170'	-0-
				5-1/2"	3779'	-0-

Describe in detail the manner in which the well was plugged, indicating where the mud fluid was placed and the method or methods used in introducing it into the hole. If cement or other plugs were used, state the character of same and depth placed, from feet to feet each set.

Down the 5-1/2" casing @ 1000# maximum pressure. Mixed 4 sks. hulls w/125 sks. cement and shut in @ 900#.

Down annulus (8-5/8" casing) @ 200# maximum pressure. Mixed 1 sk. hulls w/75 sks. cement and shut in @ 150#.

The casing was perforated 3 shots @ 1350' prior (If additional description is necessary, use BACK of this form.) to cementing.

Name of Plugging Contractor John O. Farmer, Inc. License No. 5135

Address P.O. Box 352, Russell, KS 67665

STATE OF Kansas COUNTY OF Russell, ss.

John O. Farmer III

above-described well, being first duly sworn on oath, says: That I have knowledge of the facts, statements, and matters herein contained, and the log of the above-described well as filed that the same are true and correct, so help me God.

(Signature) John O. Farmer III

(Address) P.O. Box 352, Russell, KS 67665

SUBSCRIBED AND SWORN TO before me this 26th day of May, 19 88

RECEIVED
STATE CORPORATION COMMISSION
CONSERVATION DIVISION
Wichita, Kansas

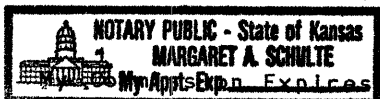

January 27, 1989

Margaret A. Schulte
Notary Public

Margaret A. Schulte

ADDRESS Russell, Kansas

Give detailed description and thickness of all formations drilled through, contents of sand, whether dry, water, oil or gas.

FARM NAME LAWSON WELL NO. 1 COUNTY NORTON SEC. 36 TWP. 3 RGE. 24

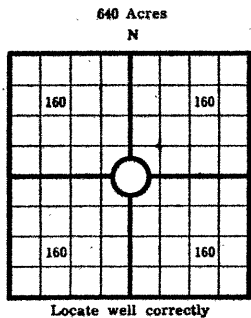

COUNTY Norton SEC. 36 TWP. 3 RGE. 24
 COMPANY OPERATING Jones, Shelburne & Farmer, Inc.
 OFFICE ADDRESS Russell, Kansas
 FARM NAME Lawson WELL NO. 1
 DRILLING STARTED 4-27-53 DRILLING FINISHED 5-7-53
 DATE OF FIRST PRODUCTION _____ COMPLETED _____
 WELL LOCATED SE 1/4 SE 1/4 NW 1/4, North of South
 Line and _____ ft. East of West Line of Quarter Section
 Elevation (Relative to sea level) DERRICK FLOOR 2469 AROUND _____
 CHARACTER OF WELL (Oil, gas or dryhole) Oil

Formation	Top	Bottom	Formation	Top	Bottom
Soil clay-shale	0	152			
Shale-shells	152	925			
Shale-shells-sand	925	1550			
Shale-shells	1550	1680			
Sand	1680	1805			
Shale-redbed	1805	2050			
Anhydrite	2050	2085			
Shale-shells	2085	2770			
Shale-lime	2770	3210			
Lime-shale	3210	3790			

OIL OR GAS SANDS OR ZONES

Name	From	To	Name	From	To
1			4		
2			5		
3			6		

Perforating Record If Any				Shot Record			
Formation	From	To	No. of Shots	Formation	From	To	Size of Shot

CASING RECORD

Amount Set								Amount Pulled		Packer Record	
Size	Wt.	Thds.	Make	Ft.	In.	Ft.	In.	Size	Length	Depth Set	Make
8 5/8	24	8	smls	170				none			
5 1/2				3779							

Liner Record: Amount _____ Kind _____ Top _____ Bottom _____

CEMENTING AND MUDDING

Size	Amount Set		Sacks Cement	Chemical		Method of Cementing	Amount	Mudding Method	Results (See Note)
	Ft.	In.		Gal.	Make				
8 5/8	170		135						
5 1/2	3779		100						

Note: What method was used to protect sands if outer strings were pulled? _____

NOTE: Were bottom hole plugs used? _____ If so, state kind, depth set and results obtained _____

TOOLS USED
 Rotary Tools were used from _____ feet to _____ Cable tools were used from _____ feet to _____
 _____ feet, and from _____ feet to _____ feet, and from _____ feet to _____
 Type Rig _____

INITIAL PRODUCTION TEST
 Describe initial test: whether by flow through tubing or casing or by pumping _____
 Amount of Oil Production _____ bbls. Size of choke, if any _____ Length of test _____ Water
 Production _____ bbls. Gravity of oil _____ Type of Pump if pump is used, describe _____

TOPS:

Elevation 2469 R. B.
 Heebner 3491
 Toronto 3515
 Lansing 3532
 Arbuckle 3778
 T. D. 3790

RECEIVED
 STATE CORPORATION COMMISSION

MAY 27 1953

5-27-53
 CONSERVATION DIVISION
 Wichita, Kansas

15-137-00299-00-00

I, the undersigned, being first duly sworn upon oath, state that this well record is true, correct and complete according to the records of this office and to the best of my knowledge and belief.

Paul Farmer
 Name and title of representative of company
Vice-President

Subscribed and sworn to before me this 15th day of May, 1953
 My Commission expires April 23, 1956 Connie Perryhill
 Notary Public.

Lawson #1

15-137-00299-00-00

OPERATOR: JONES, SHELBURNE & FARMER
FARM NAME: LAWSON
ROTARY COMMENCED: APRIL 29, 1953
ROTARY COMPLETED: May 9, 1953

NORTON COUNTY

Sec. 36 Twp. 3 Range 24

0-152	Soil Clay - Shale
152-652	Shale- Shells
652-925	Shale-Shells
925-1550	Shale-Shells-Sand
1550-1680	Shale-Shells
1680-1805	Sand
1805-2050	Shale-Red Bed
2050-2060	Anhydrite
2060-2085	"
2085-2395	Shale-Shells
2395-2590	Shale-Shells
2590-2770	" "
2770-2975	Shale-Lime
2975-3075	" "
3075-3210	" "
3210-3335	Lime-Shale
3335-3470	" "
3470-3526	" "
3526-3562	" "
3562-3615	" "
3615-3675	" "
3675-3735	" "
3735-3773	" "
3773-3790	T. D.

RECEIVED
STATE CORPORATION COMMISSION
MAY 27 1953
527-88
CONSERVATION DIVISION
Wichita, Kansas

Certificate

State of Kansas
County of Decatur

I hereby certify that the foregoing is to the best of my knowledge and belief a full, true correct drilling log as shown by the daily drilling reports in connection with the aforesaid well.

Opal Savage
For Savage-Dunn Drilling Co.

Subscribed and sworn before me, the undersigned, a notary public
this-----day of -----1953
My commission expires-----

RECEIVED
STATE CORPORATION COMMISSION

MAY 27 1988

5-27-88

CONSERVATION DIVISION
Wichita, Kansas